

SIGMA^{LT} Control

HAND-HELD QUICK-START GUIDE

KEY:

LOAD SELECTION

- Decrease Load
- Increase Load
- 0** Manual Load Entry
- OK
- Apply Load
- Reject Load

NAVIGATION

- Next Screen
- Down Screen
- Back Screen
- Network Overview
- Network Search
- Settings
- Status - Load Off
- Status - Load On
- Status - Warning
- Status - Error

1: 0/100 kW Single Load Bank Control

OTHER SYMBOLS

- #1** Load Bank ID (Network view only)
- USB Found



WARNING!

READ THE LOAD BANK MANUAL BEFORE USE AND TAKE SPECIAL NOTE OF ALL SAFETY WARNINGS.

KEEP PEOPLE WELL AWAY. CLOSE ALL DOORS. ENSURE CABLES AND EARTHING ARE ADEQUATE. ENSURE A 4M GAP IS BETWEEN LOAD BANKS TO PREVENT HOT AIR RECIRCULATION. RISKS INCLUDE FIRE AND BURNS FROM THE HOT AIR OUTLET AND ELECTRIC SHOCK.

LOAD CONTROL

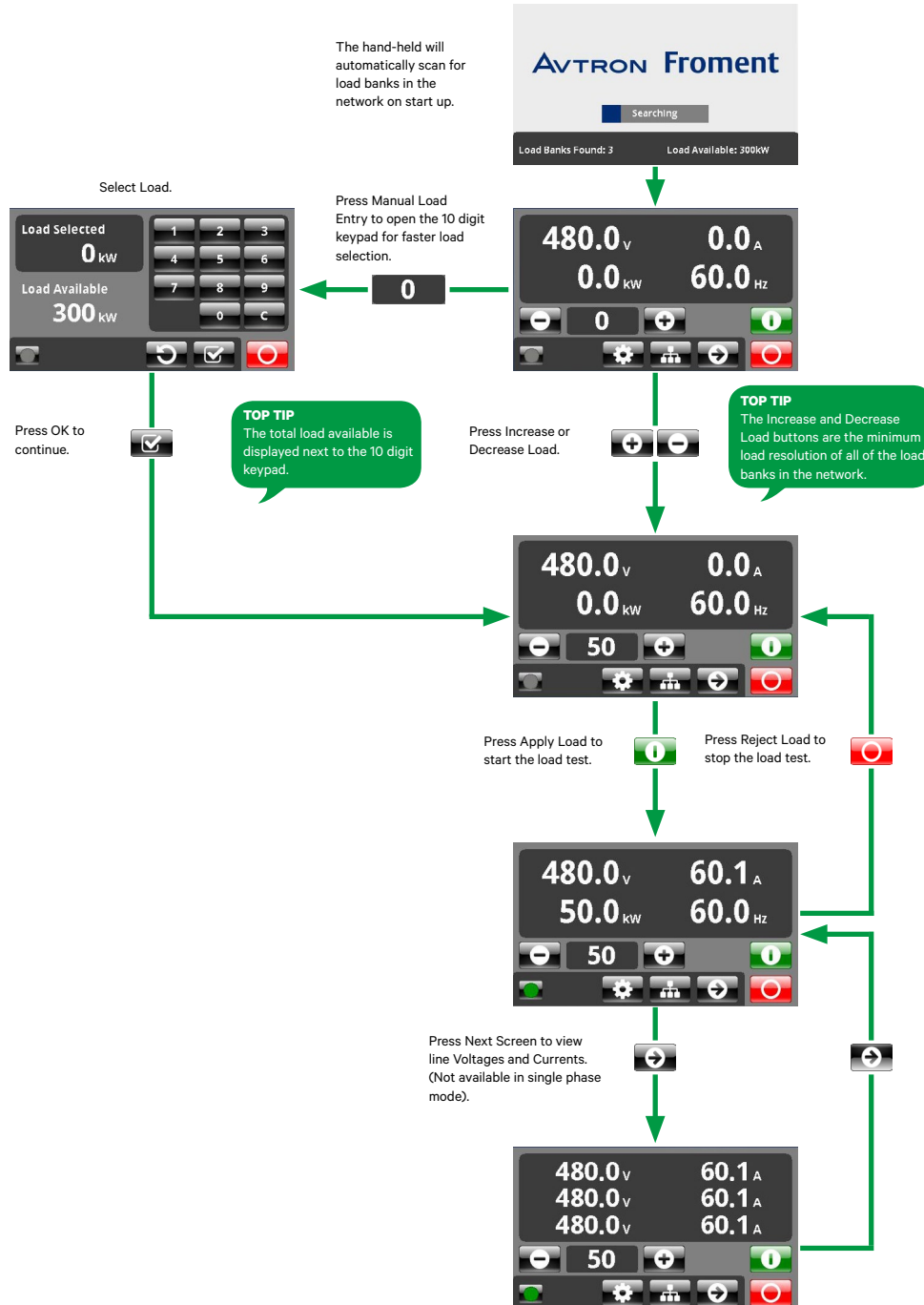

DATA LOGGING

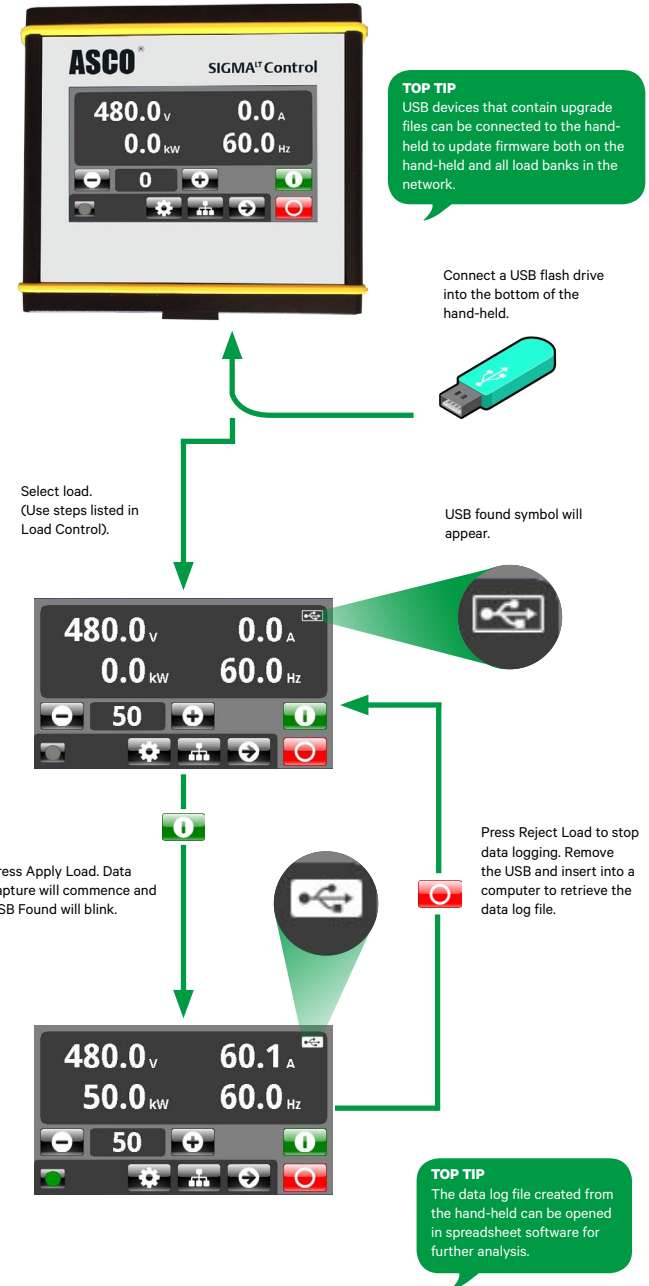

LOAD BANKS IN A NETWORK

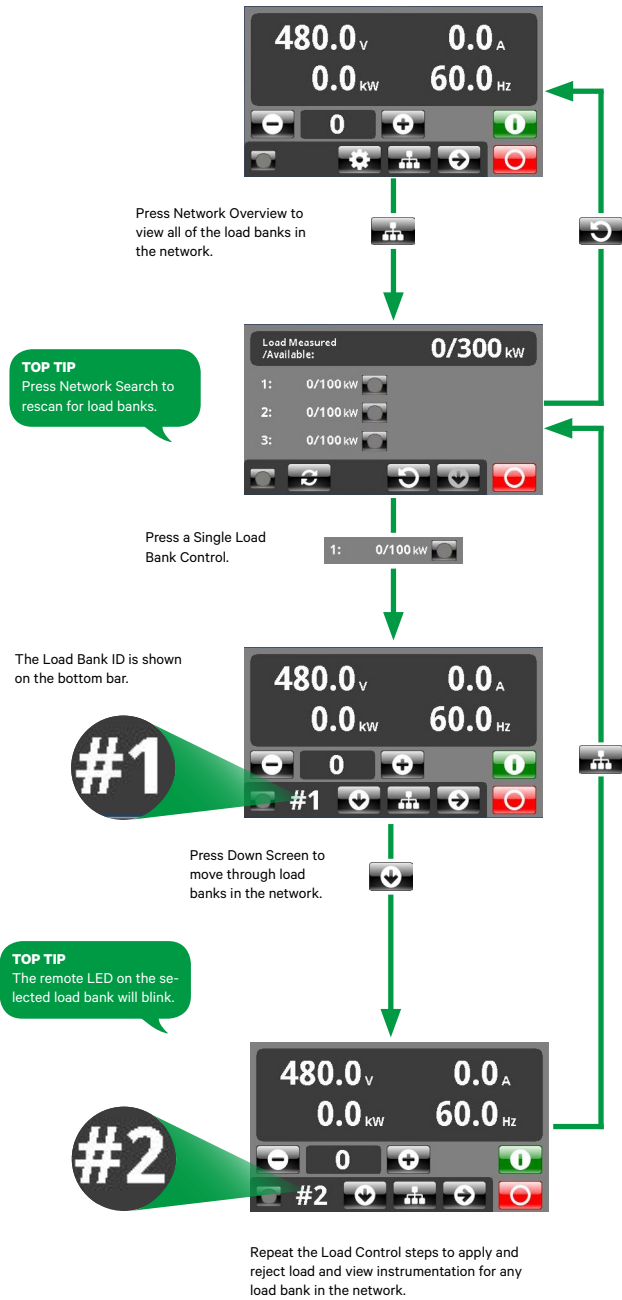

STATUS

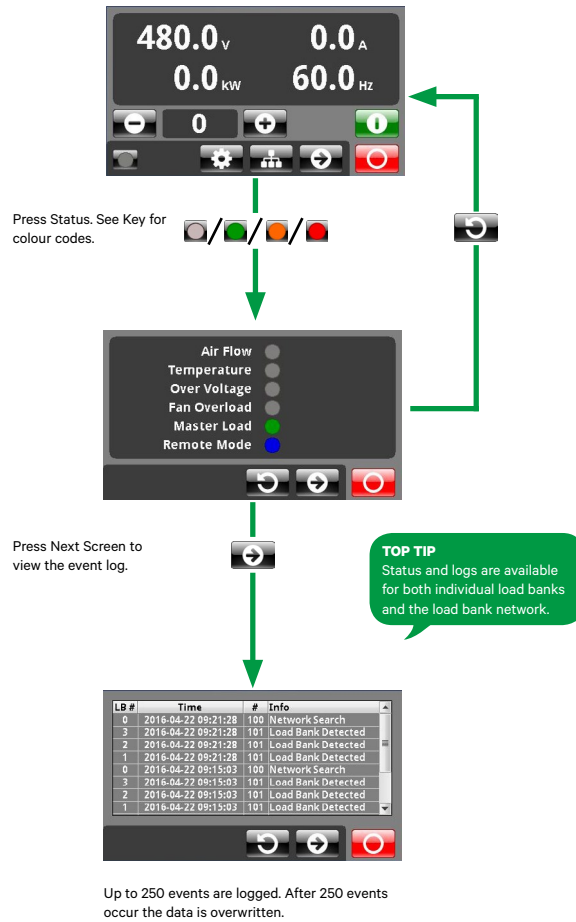

SETTINGS

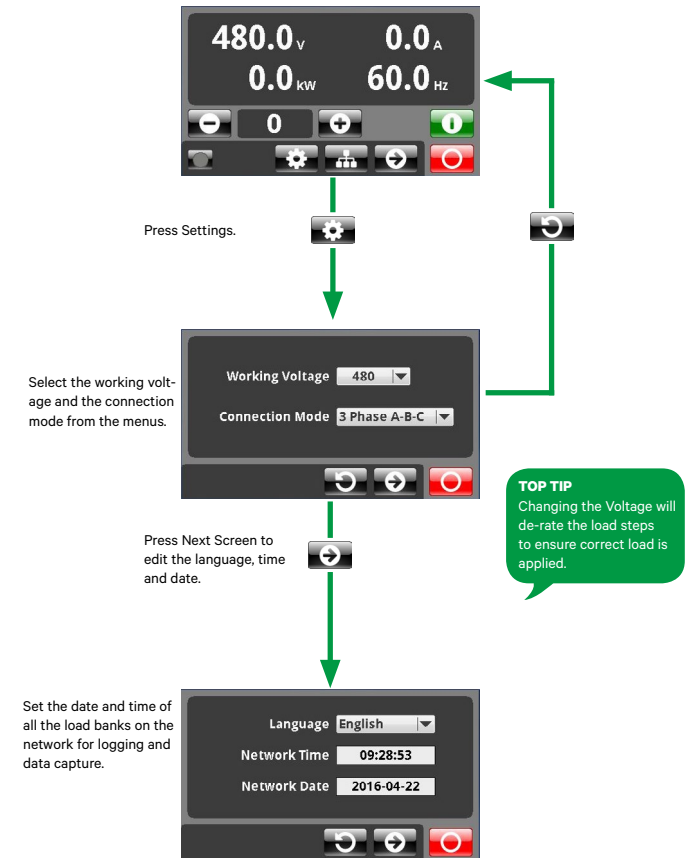

ERRORS

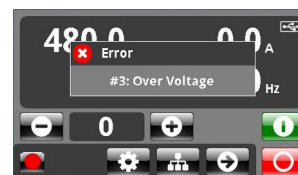

A message will appear if an error occurs. Press the screen to acknowledge. The load bank with the error will be removed from the network until it is cleared. For more information about errors view the load bank manual.

ASCO®

The ASCO and ASCO Power Technologies marks are owned by Emerson Electric Co. or its affiliates and utilized herein under license.
©2017 ASCO Power Technologies. All Rights Reserved.
Publication No. 5052

Froment is a brand of ASCO Power Technologies.
Cliffe Road, Easton-on-the-Hill, Stamford, PE9 3NP, UK
www.froment.co.uk | sales@froment.co.uk | +44 (0) 1780 480033