

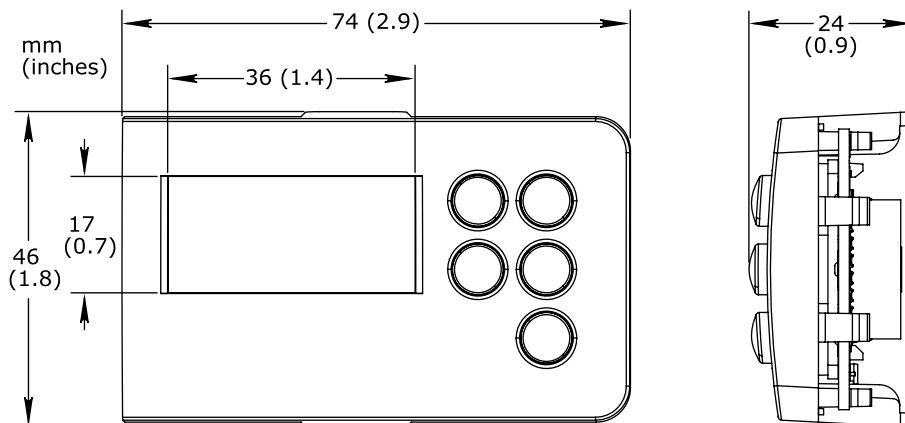

MP-C Display

Dimensions

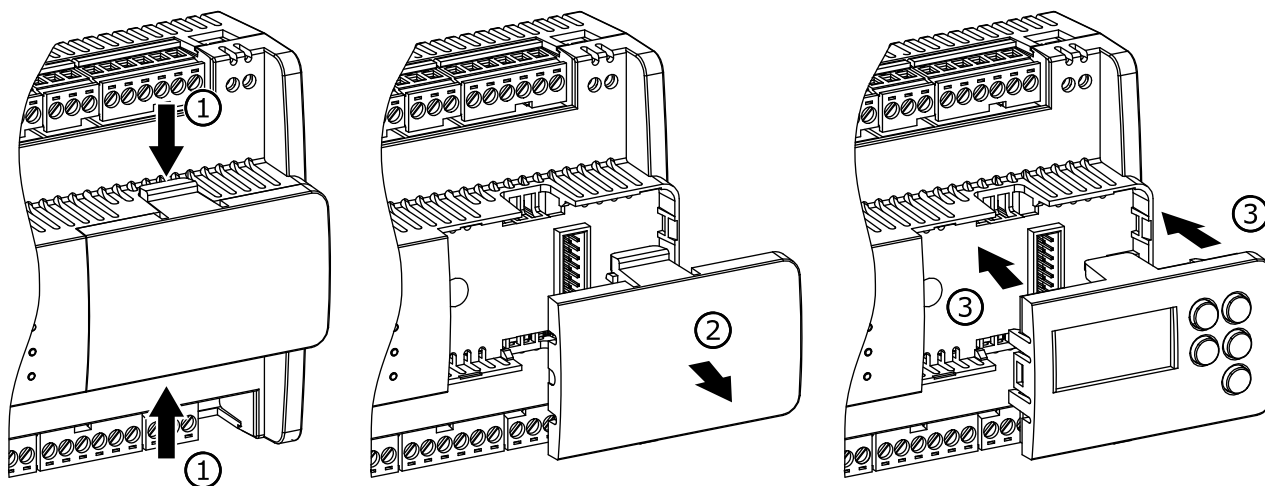

Installing the Module



 Caution: Take proper grounding precautions before handling the display module to prevent damage from electrostatic discharge.

 Caution: Disconnect power before installing the display module. Failure to follow these instructions can result in equipment damage.

 Caution: Do not try to remove the display module as it may damage the enclosure and the module. Once installed, the display module cannot be removed.

Part Numbers

Product	Part number
MP-C DISPLAY	SXWMPCDSP10001

Specifications

DC input

Power consumption

max. 0.15 W (45 mA at 3.3 V)

Operation environment

Ambient temperature, operating

-30 to +60 °C (-22 to +140 °F)

Humidity

Maximum 95 % RH non-condensing

Mechanical

Plastic flame rating

UL94-5VB

Weight

0.035 kg (0.077 lb)

Regulatory compliance

EMC, safety, and environment

FCC CFR 47 Part 15 Class B, ICES-003 Class B, RCM, CE - EMCD 2014/30/EU, WEEE 2012/19/EU, RoHS 2011/65/EU, China RoHS SJ/T 11364-2014, UL 916 Listed products for the United States and Canada, Energy Management Equipment Accessory (UL file E80146.)

部件名称 (Part Name)	有害物质 (Hazardous Substances)					
	铅 (Pb)	汞 (Hg)	镉 (Cd)	六价铬 (Cr (VI))	多溴联苯 (PBB)	多溴二苯醚 (PBDE)
塑料部件 (Plastic Parts)	○	○	○	○	○	○
电子件 (Electronics)	X	○	○	○	○	○

本表格依据 SJ/T11364 的规定编制。(This table is made according to SJ/T 11364.)

○: 表示该有害物质在该部件所有均质材料中的含量均在 GB/T 26572 规定的限量要求以下。

(Indicates that the concentration of hazardous substance in all of the homogeneous materials for this part is below the limit as stipulated in GB/T 26572.)

X: 表示该有害物质至少在该部件的某一均质材料中的含量超出 GB/T 26572 规定的限量要求。

(Indicates that the concentration of hazardous substance in at least one of the homogeneous materials used for this part is above the limit as stipulated in GB/T 26572.)

