

## Inventory

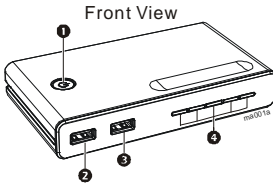

Front View



User Manual

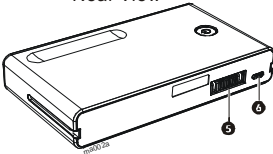

Rear View

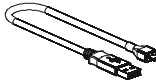

USB cable

- 1 POWER button
- 2 1.0A USB port
- 3 2.4A USB port
- 4 Capacity Indicator LEDs
- 5 UPS connector (for use with BGE50ML-JP only)
- 6 Micro-USB input

## Safety and General Information



Read this user manual carefully before using the product, and keep it for future reference.

- Do not short circuit this device. To avoid short circuit, keep the device away from any metal objects (e.g., hair clips and keys).
- It is normal that the battery will feel warm during heavy use.
- Use this device as instructed to avoid electric shock; do not disassemble.
- This unit is not user repairable; contact APC for tech support related issues.
- CAUTION  
RISK OF FIRE AND BURNS.  
Do not open, crush, heat above 40°C or incinerate. Follow manufacturer's instructions.
- During normal usage keep the device out in the open to allow excess heat to dissipate.
- Charge M12USWH-JP for 2.5 hours before initial use.
- Keep the USB output port and micro-USB input port clean and free of obstruction.

Failure to follow these instructions can result in equipment damage.

## Charge USB Devices

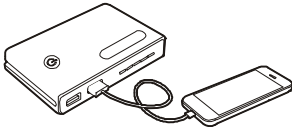

Charge devices using the original USB cable that comes with the unit, or another USB charging cable.

Connect the mobile power pack with the device to be charged and press the POWER button for about 1 second.

Device	M12USWH-JP
Smartphone	5x
Tablet	~ 1x

Note: The charge times in this table are approximate figures.

## Charge the Power Pack

Use the included charging cable to connect the USB output port of a USB charger or PC to the micro-USB input port on the power pack. (Note: some PCs in sleep mode do not provide output power to the USB port)

### By USB charger

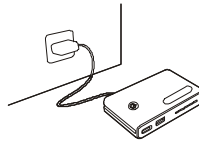

### By PC

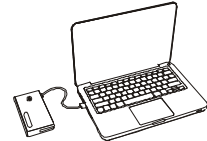

## LED Status Indicators

To check the remaining battery charge of this device in standby mode, press the POWER button for about 1 second. The battery capacity display will display how much battery power is remaining

Indicator	81-100% 61-80% 41-60% 21-40% 0-20%			
Status	Battery Full	Battery charging	Battery inserted into the UPS	Fault detected on USB ports
Mobile Power Pack LEDs	All 5 LEDs illuminate green	LEDs indicate charge level. Top LED flashes.	One LED illuminates green from bottom to top	All 5 LEDs flash green

## Using the mobile power pack with a UPS

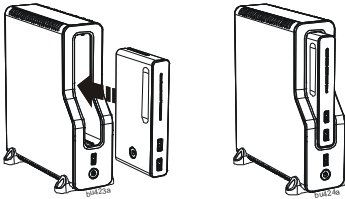

This mobile power pack can be plugged into the APC Back-UPS Connect BGE50ML-JP to provide AC power backup for low power networking equipment and also DC power via USB. The fastest way to charge the mobile power pack is to charge it inside the UPS where it will fully charge the battery in 2.5 hours. Simply insert the battery into the opening in the front of the UPS. The battery can only go in one direction, with the LEDs on top and USB ports on the bottom. When plugged in the mobile power pack charges much faster than when using the standard micro-USB input. To remove the mobile power pack, simply pull the battery out.

## Troubleshooting

Problem and Possible Cause	Solution
<b>The mobile power pack cannot be charged.</b>	
The PC is in sleep mode.	Wake PC from sleep mode.
The temperature is outside of the recommended temperature range for use.	Stop using the mobile power pack until it is within the correct temperature range.
The charging cable is malfunctioning.	Carefully check if the charging cable is functioning. Clean the micro-USB port in case there is an obstruction.
<b>The mobile power pack cannot charge some devices.</b>	
The mobile power pack is not powered on.	Press the POWER button on the mobile power pack.
The remaining capacity of the mobile power pack is low.	Charge the mobile power pack.
The mobile power pack's automatic load detection has detected no load and has powered off the unit.	Press the POWER button on the mobile power pack.
The mobile power pack does not recognize or detect the devices connected to it.	Remove connected devices. Turn the unit on, reconnecting each device one at a time. Some devices may require a dedicated charging cable. The cable included with this device is a standard data cable.
The mobile device has overloaded the USB port or a short circuit has occurred in the mobile device connected to the mobile power pack.	When the USB port encounters an error such as overload or a short, the mobile power pack will flash all LEDs. If the error is not removed the mobile power pack will enter into safe mode after 30 seconds. To deactivate safe mode, disconnect all devices from the mobile power pack press the POWER button or connect the mobile power pack to a USB charger as if charging.
The life of the mobile power pack has expired or a fault has been detected.	In the case where a system fault has been detected, contact your local APC by Schneider Electric dealer or authorized APC by Schneider Electric service agency.

## Specifications

Type	Lithium-ion battery
Capacity	11400mAh
Rating	41.2 Wh
Input current (Maximum)	micro-USB: 2.1A
Rated input voltage	5V dc
Output current	USB1: 2.4A, USB2: 1.0A
Output voltage	5V
Capacity indicator light	5 level LEDs
Capacity indicator brightness levels	50% in the UPS. As mobile power pack 100% after pressing the POWER button. 10% after 20 seconds when charging a device or being charged.
Charging time	2.5 hours (UPS), 8 hours (micro-USB)
Dimensions (L x W x H)	13.0 x 7.4 x 2.2 cm
Weight	267 g
Operating temperature	0°C - 40°C
Smart Charging (2.4A port only)	Maximum output depends on the client device.

\*1 The two (2) USB ports combined have a maximum output of 3.4A. If two (2) devices together draw more than 3.4A, overload protection circuits will trigger and disable output.

## APC by Schneider Electric IT Customer Support

<http://www.schneider-electric.com/jp>  
**Club APC warranty registration site:** <https://clubapc.jp/>

## Battery Recycling Information



Always dispose of used or spent batteries properly.

Return the spent battery to an appropriate facility for proper disposal and recycling.

## Warranty

Schneider Electric IT (SEIT) warrants its products to be free from defects in materials and workmanship for a period of three (3) years from the date of purchase. SEIT obligation under this warranty is limited to repairing or replacing, at its sole discretion, any such defective products. This warranty does not apply to battery wear from use, equipment that has been damaged by accident, negligence or misapplication or has been altered or modified in any way. SEIT standard procedure is to replace the original unit with a factory reconditioned unit. Customers who must have the original unit back due to the assignment of asset tags and set depreciation schedules must declare such a need at first contact with an SEIT Technical Support representative. SEIT will ship the replacement unit once the defective unit has been received by the repair department, or cross ship upon the receipt of a valid credit card number. The customer pays for shipping the unit to SEIT. SEIT pays ground freight transportation costs to ship the replacement unit to the customer. For full warranty information refer to [www.apc.com](http://www.apc.com).