

Application

The AV-823 long stem adapter kit enables mounting of Schneider Electric Forta M400, M800, M1500, and MG900 SR U-Bolt style series actuators to Schneider Electric VG210/VG310 series valves.

▼ **WARNING**

Depressurize the valve before removing the existing actuator and linkage and check integrity of the valve stem and plug by moving the stem up and down. If the valve stem and plug have been damaged, stem may blow out under pressure and cause injury and equipment damage.

▼ **CAUTION**

Do not remove the gland packing bonnet from the valve.

Applicable Literature

- Valve Catalogue, VACAT
- Data Sheets: M400: 03-2060, M800: 03-2063, M1500: 03-3264, M900 SR: 03-00240
- Instructions: NSR: 02-00012, SR: 02-00011

Tools Needed

- 5/16" (8mm) spanner
- (11mm) or adjustable spanner / grips

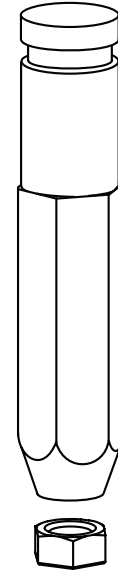

Installation

Remove the components from the bag and install the jam nut (1) all the way to the bottom of the valve stem threads. Install the stem extension (2) until it makes contact with the jam nut and tighten using 5/16" (8mm) spanner and 7/16" (11mm) spanner.

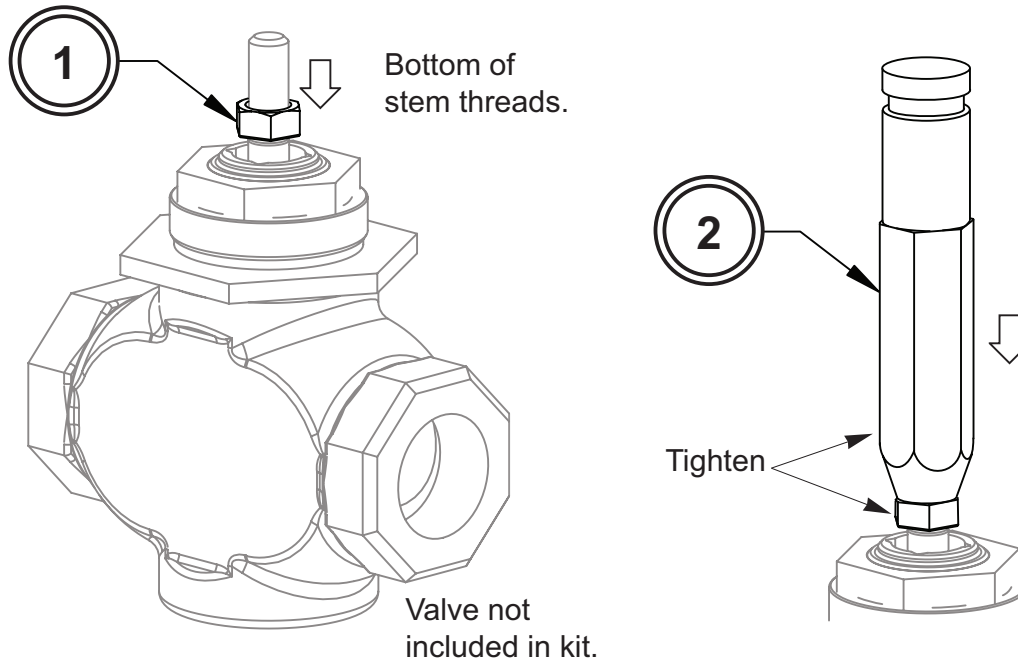

After the AV-823 long stem adaptor is installed, install the selected actuator according to the actuator installation instructions.

Copyright 2013, Schneider Electric. All brand names, trademarks and registered trademarks are the property of their respective owners. Information contained within this document is subject to change without notice. All rights reserved.

Americas

One High Street
NorthAndoverMA01845
Tel.+1800-225-0962
www.schneider-electric.com/buildings

Asia Pacific

13th Floor, East Wing, Warwick House,
Taikoo Place, 979 Kings Road,
Quarry Bay, Hong Kong, SAR
Tel +852 2980 8528

EMEA

Jägershillgatan 18
Malmö SE-213 75, Sweden
Tel.: +46 40 386 850

Schneider
 **Electric**