

## Adapter Kit Schneider Electric Actuators to 1/2” and 3/4” Johnson VG7000 Valves Installation Instructions

### Application

The AV-801 adapter kit enables mounting of Schneider Electric MK-2690 Series pneumatic actuators and Mx51-710x Schneider Electric SmartX Actuators onto 1/2” and 3/4” Johnson Controls VG7000 Series valve bodies using the appropriate Schneider Electric valve linkage.

Table-1 on page 2 lists the Johnson VG7000 Series valves compatible with the AV-801 adapter, kit, and Table-2 lists the compatible Schneider Electric actuators and linkages.

**Caution:** Other Johnson valves require different kits for their specific bonnet configuration.

#### Warning:

- The AV-801 adapter kit is to be used **only** with the Schneider Electric actuators shown in Table-2. The use of other actuators is not acceptable due to valve stem force limitations.
- Depressurize valve before removing existing actuator and linkage and check integrity of valve stem and plug by moving stem up and down. If valve stem and plug have been damaged, stem may blow out under pressure and cause injury and equipment damage.

### Instructions

1. Slide the Actuator Locking Nut onto Adapter with the threads up as shown in Figure-1.
2. Thread the Adapter onto valve bonnet all the way and tighten firmly as shown in Figure-1.

**Note:** This makes the body with the Adapter the equivalent of an Schneider Electric VB-7xxx valve body

3. Install the selected Schneider Electric actuator (and linkage if required) the same as you would on an Schneider Electric valve. Refer to Table- 2 on page 2 for required linkages and actuator installation documentation.

**Note:** There is no need to rotate the actuator at installation. Orient the actuator first and then tighten the Actuator Locking Nut into the actuator.

4. Check operation.

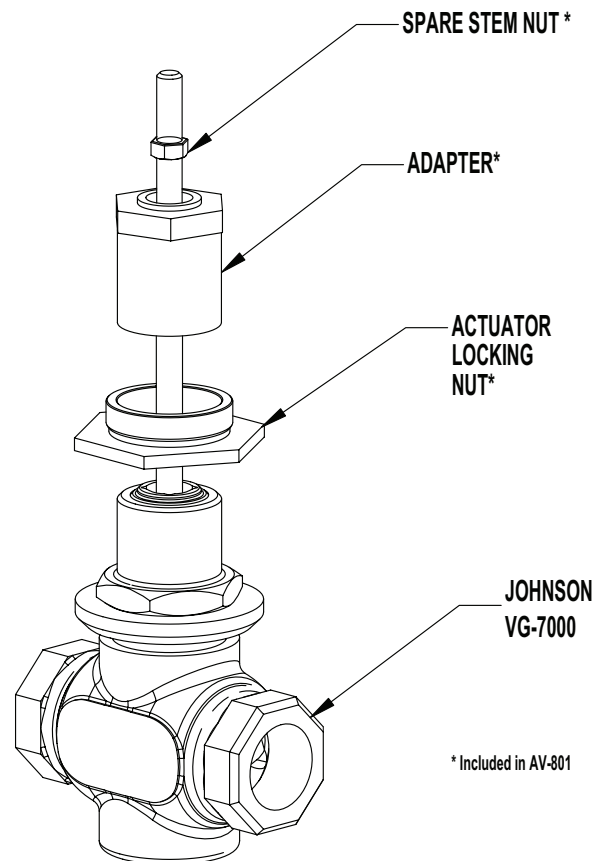
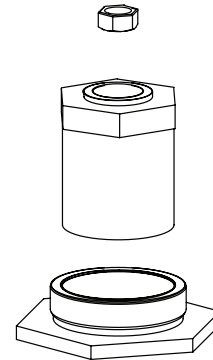

\* Included in AV-801

Figure-1

**Table - 1: Compatible Johnson Controls Bronze Valve Bodies**

|   |
|---|
| VG7xxxCT 1/2" Two-Way and Three-Way valves <sup>a</sup> |
| VG7xxxET 1/2" Two-Way and Three-Way valves <sup>a</sup> |
| VG7xxxGT 1/2" Two-Way and Three-Way valves <sup>a</sup> |
| VG7xxxLT 3/4" Two-Way and Three-Way valves <sup>a</sup> |

<sup>a</sup>The xxx characters in the part number field denote various body types, end connections, trim, and flow characteristics.

**Table - 2: Compatible Schneider Electric Actuators and Linkages**

| Schneider Electric Actuator Family <sup>a</sup> | Description  | Required Schneider Electric Valve Linkage |                            | Actuator General Instructions Sheet |
|---|--|---|----------------------------|-------------------------------------|
|   |  | Part No.                                  | General Instructions Sheet |                                     |
| MK-2690 <sup>b</sup>                            | 6 Square Inch Pneumatic<br>3-7, 5-10, 8-13 psig.   | AV-7400                                   | F-26236                    | F-13893                             |
| MA51-710x<br>MF51-710x<br>MS51-710x             | SmartX Actuator (Linear - 105 lb.)<br>2-position, floating, proportional Vdc,<br>proportional mAdc | None<br>(Included in actuator)            |                            | F-27169                             |

<sup>a</sup>Use only these Schneider Electric actuators. See Warning on page 1. Consult actuator General Instructions Sheet for complete actuator specifications.

<sup>b</sup>AK-42309-500 positive positioner may also be used (see F-22909 General Instructions or F-27383 Schneider Electric Pneumatic Products catalog for further information).

## Maintenance Parts

All valve body maintenance parts must be obtained from the valve manufacturer, Johnson Controls.

Actuator and linkage maintenance parts may be obtained from Schneider Electric. Consult the actuator General Instructions sheets in Table-2 for further information.