

Pneumatic Actuator Valve Linkage Kit for MK-2690 and 3/4" Stroke Valves General Instructions

Application

The AV-7800 valve linkage kit is used to field assemble MK-2690 pneumatic actuators to 1/2" through 2" installed competitor valve bodies that have 3/4" strokes.

Note:

- The AV-7800 kit requires an AV-810 or AV-817 adapter kit.
- The AV-7800 kit is not for shorter stroke valves.
- MK-2690 close off ratings are found in the valve catalog listed in "Applicable Literature" below.

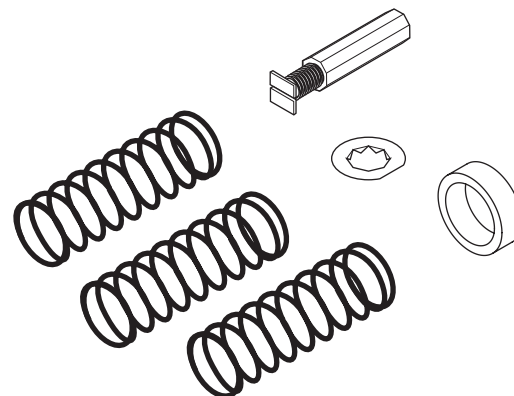

Features

- Stainless steel springs are provided for control signal applications of:
 - 3 to 7
 - 5 to 10
 - 7 to 12 psig.
- Kit fits valve bodies with appropriate AV-8xx series adapter kits.

Stainless Steel Spring Range

Spring Color	Description
Green	For 3 to 7 psig (21 to 48 kPa)
White	For 5 to 10 psig (34 to 69 kPa)
Red	For 7 to 12 psig (48 to 83 kPa)

Applicable Literature

- *Valve Catalog*, F-27414
- *Pneumatic Products Catalog*, F-27383
- *MK-2690 Pneumatic Valve Actuator General Instructions*, F-13893
- *AV-810 Linkage Adapter Kit for Honeywell Valves*, F-27433
- *AV-817 Linkage Adapter Kit for Robertshaw Valves*, F-27447

INSTALLATION

Inspection

Inspect the package for missing parts. Return any damaged products.

Requirements

- Tools:
 - Screwdriver appropriate for slotted spring compression screw (not provided)
 - Tape
 - Light oil or grease
- Training: Installer must be a qualified, experienced technician

Caution:

Avoid locations where excessive moisture, corrosive fumes, or vibration are present. Do not insulate piping above the actuator mounting nut preventing proper drainage.

- Do not install the actuator below the center line of the valve. For steam applications mount the actuators above the valve body at 45° from vertical.
- Check for adequate space for the installed actuator.

Linkage Kit Installation

The AV-7800 linkage kit used with the MK-2690 actuator on 3/4" stroke valve bodies and requires no stem height setting.

Caution:

It is essential that the proper AV-8xx adapter be used for the valve body on which the linkage is being installed to ensure proper actuator operation and close off.

Procedure

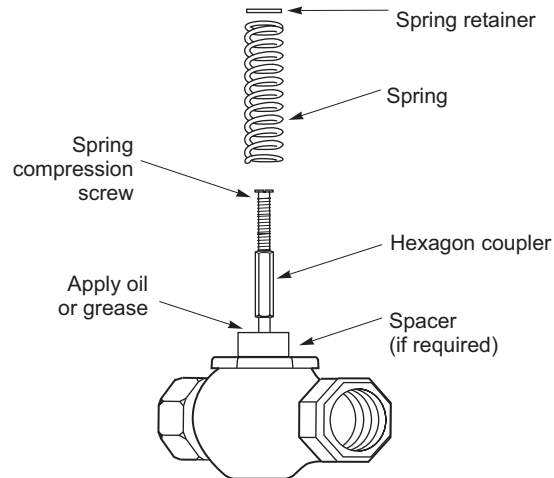

Figure-1 Assembly of AV-7800 Linkage Kit onto a Valve Body.

1. If the valve bonnet has a flat top, put a thin coat of oil or grease on the flat surface to ease screw tightening.
If the valve type is a Honewell V501 with a cone-top packing cap, add the spacer and then apply the oil or grease on top of the spacer.
2. Start the hexagon coupler onto the stem approximately one turn.
3. Pull the stem up fully.
4. Place the spring over the stem and hexagon coupler.

5. Insert the compression screw into the spring retainer indent and hold together with a small piece of tape.
6. Pull the spring down (if needed) with one hand and start the compression screw and the retainer into the hexagon coupler with other hand.
Engage further by rotating the spring assembly by hand.
7. Install the selected AV-8xx adapter over the spring to center it and tighten lightly.
8. Remove the tape and use a screwdriver to turn the spring compression screw until it is firmly seated.
9. Tap the side of the spring to center the top in the spring retainer.
10. Screw the actuator onto the AV-8xx adapter firmly.
If space limits the actuator, loosen the set screws and then screw the adapter into the actuator.
11. Rotate the actuator and adapter together to the desired position.
12. Tighten the set screws with the wrench provided in the AV-8xx adapter kit.
13. Confirm operation according to system requirements.

MAINTENANCE

The actuator linkage kit requires no maintenance.

Field Repair

None. Kit parts are not sold individually.

