

Inventory

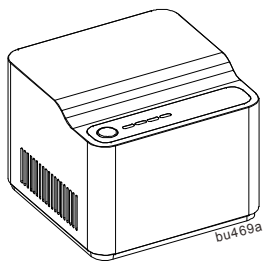

TIPS x 2
packs

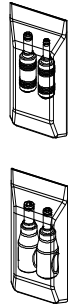

Pack	Description on bag
Brand: AT&T	Model number: 5031NV, 5168NV, 5268AC, NVG589, NVG599.

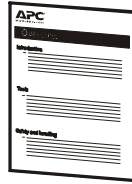

User Manual

Pack	Description on bag
Brand: AT&T	Model number: BGW210-700.

Safety and General Information

Inspect the package contents upon receipt. Notify the carrier and dealer if there is any damage.

SAVE THESE INSTRUCTIONS - This section contains important instructions that should be followed during installation and maintenance of the UPS and batteries. Failure to follow these instructions can result in equipment damage.

⚠ DANGER

HAZARD OF ELECTRIC SHOCK, EXPLOSION, OR ARC FLASH

- This UPS is intended for indoor use only.
- Do not operate this UPS in direct sunlight, in contact with fluids, or where there is excessive dust or humidity.
- Connect the UPS power cable directly to a wall outlet.
- Do not short circuit this battery. To avoid short circuit, keep the battery away from any metal objects (e.g., hair clips and keys).
- Use this battery as instructed to avoid electric shock; do not disassemble.
- This battery is not user repairable; contact APC for tech support related issues.
- Do not heat this battery or throw it into a fire.
- Keep this battery away from high temperature, wet, or dusty environments.
- During normal usage keep the battery out in the open to allow excess heat to dissipate.

Failure to follow these instructions will result in death or serious injury.

NOTICE

RISK OF EQUIPMENT DAMAGE

- This UPS is designed for low power devices less than 38.4 Watts. When the UPS is on battery, the CP12142LI will shut down automatically to protect itself once the load on the UPS is greater than 38.4 Watts.
- Be sure the air vents on the UPS are not blocked. Allow adequate space for proper ventilation.
- The battery typically lasts for three to five years. Environmental factors impact battery life. Elevated ambient temperatures, poor quality DC power, and frequent short duration discharges will shorten battery life.

Failure to follow these instructions can result in equipment damage.

Getting Started

Select transformer tips based on router model indicated on the plastic bag. Tip with Green ring plugs into CP12142LI, and tip with black ring plugs into router. Plug the router power adapter into CP12142LI, then plug in the CP12142LI power cable into the router.

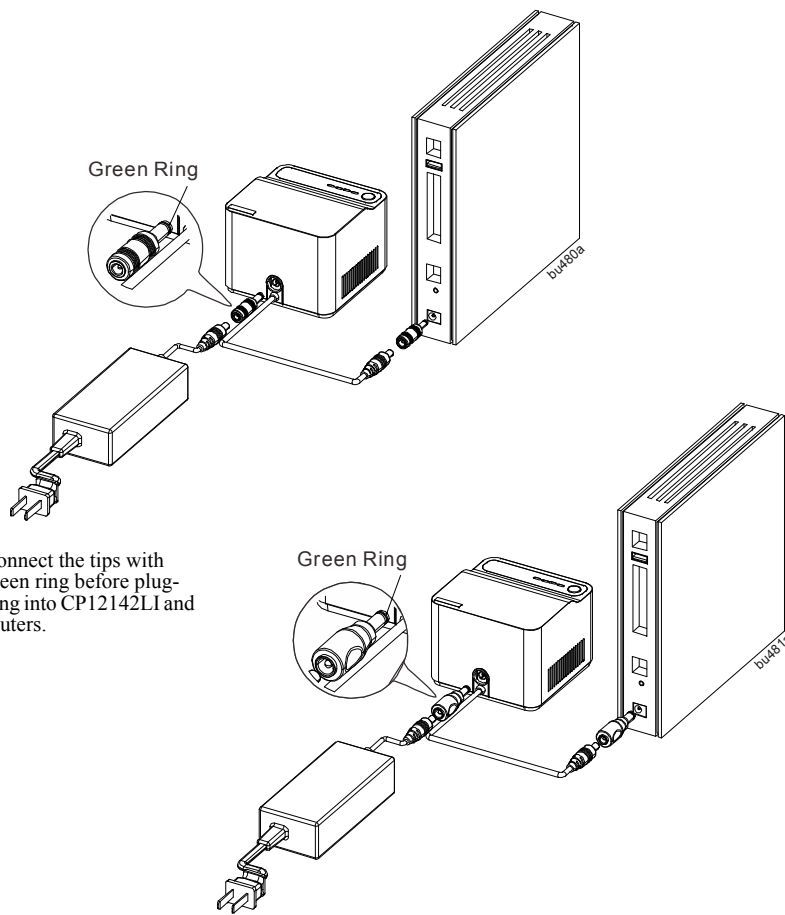

Connect the tips with green ring before plugging into CP12142LI and routers.

Wall Mount Installation

- Use 2 screws with 9/64" (3.5 mm) in thread diameter and not larger than 9/32" (7mm) in head diameter. (Screws are not provided.)
- Orient the UPS to the desired location. Mount screws directly starting with the bottom pair.

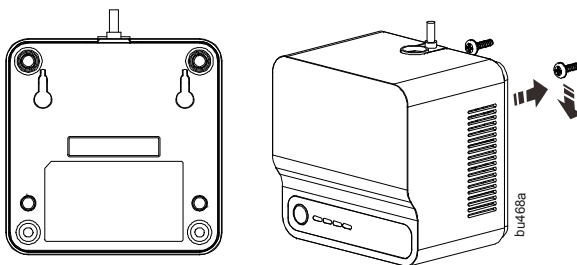

Mute Low Battery Alarm

To change the setting make sure the UPS is on. Press and hold the POWER button. Releasing the POWER button after hearing the 3rd short beep will toggle the low battery alarm mute function. The UPS will emit a short double beep to confirm that the low battery alarm has been disabled. If the UPS emits a 1- second beep it indicates that the low battery alarm is audible.

Note: The default setting of the low battery alarm is audible.

Using the UPS

Press the POWER button located in front of the UPS. The POWER button LED will illuminate and a single short beep will be audible to indicate that the UPS is turning on.

Battery Charge and Capacity Information

- Charge battery in the UPS for 24 hours prior to initial use. The battery will charge while the UPS is on and as long as there is DC power to the UPS.
- Do not expect full battery runtime capability during the initial charge period.
- To charge the battery, connect the CP12142LI to the AC adapter of the router. The LEDs will flash to indicate the battery capacity.
- UPS runtime information is available on the APC Web site, www.apc.com.

Power Status Indicators

Indicator	76-100%	51-75%	26-50%	0-25%	<10%
Status	Battery Full	Battery charging	Battery or UPS Fault detected	Battery Low	Battery Self Test
Battery Capacity LEDs	All 4 LEDs illuminate	LEDs indicate charge level. Top LED flashes.	All 4 LEDs flash	Bottom LED flashing when capacity is less than 10%	All LEDs flash sequentially

UPS Status Indicators

Event	LED Indication	Audible Indicator On
On Battery	The Power Button LED flashes green.	Not applicable
Low Battery alarm The UPS is supplying battery power and the battery is near a total discharge state.	The Power Button LED flashes green.	The UPS emits 2 short beeps every 30 seconds.
Overload Shutdown While on battery power an overload condition has occurred while the UPS is operating on battery power.	None	Constant tone
Adapter Input lower than Output	The Power Button LED flashes green	
Battery Self Test Fail	The Power Button LED flashes green, all battery capacity LEDs flash	
Battery Replacement Needed	All battery capacity LEDs flash	

UPS Specifications

Input	Voltage	12 Vdc ± 5%
	Maximum Current	3.5 A
Output	Voltage	12 Vdc ± 5%
	Current	3.2 A
User Interface	Power button	On / Off
	Power button LED	Green - ON (on-line and discharging)
	Buzzer	Beeper - Fault detected
	Capacity indicator	4 LEDs (25% increment per LED)
Battery / Operation	Protection	OVP, UVP, OTP, UTP
	Recharge time	24 hours
Environmental	Operating Temperature	32° F to 113° F (0° C to 45° C)
	Operating Relative Humidity	0 to 95% non-condensing humidity
	Operating Elevation	0 to 10,000 ft (0 to 3000 m)
	Storage Temperature	-4° F to 122° F (-20° C to 50° C)
	Storage Relative Humidity	0 to 95% non-condensing humidity
Physical	Storage Elevation	0 to 50,000 ft (0 to 15000 m)
	Dimensions (L x W x H)	2.9 x 3.8 x 3.8 in (74.2 x 96 x 96 mm)
Conformance	Net Weight	1.65 lb (750 g)
	Agency approvals	ECOC, CE, FCC part 15 Subpart B, CISPR 22/32 Class B, EN60950

Warranty

Schneider Electric IT (SEIT) warrants its products to be free from defects in materials and workmanship for a period of two (2) years from the date of purchase. SEIT obligation under this warranty is limited to repairing or replacing, at its sole discretion, any such defective products. This warranty does not apply to battery wear from use, equipment that has been damaged by accident, negligence or misapplication or has been altered or modified in any way. SEIT standard procedure is to replace the original unit with a factory reconditioned unit. Customers who must have the original unit back due to the assignment of asset tags and set depreciation schedules must declare such a need at first contact with an SEIT Technical Support representative. SEIT will ship the replacement unit once the defective unit has been received by the repair department, or cross ship upon the receipt of a valid credit card number. The customer pays for shipping the unit to SEIT. SEIT pays ground freight transportation costs to ship the replacement unit to the customer. For full warranty information refer to www.apc.com.

Service

If the unit requires service, do not return it to the dealer. Follow these steps:

- Review the *Troubleshooting* section of the manual to eliminate common problems.
- If the problem persists, contact Schneider Electric IT (SEIT) Customer Support through the APC by Schneider Electric Web site, www.apc.com.
 - Note the model number and serial number and the date of purchase. The model and serial numbers are located on the rear panel of the unit and are available through the LCD interface on select models.
 - Call SEIT Customer Support and a technician will attempt to solve the problem over the phone. If this is not possible, the technician will issue a Returned Material Authorization Number (RMA#).
 - If the unit is under warranty, it will be repaired or replaced at no cost.
 - Service procedures and returns may vary internationally. Refer to the APC by Schneider Electric Web site for country specific instructions.
- Pack the unit properly to avoid damage in transit. Never use foam beads for packaging. Damage sustained in transit is not covered under warranty.
- Before shipping, always disconnect all battery modules in a UPS or external battery pack.**
- Write the RMA# provided by Customer Support on the outside of the package.
- Return the unit by insured, prepaid carrier to the address provided by Customer Support

APC by Schneider Electric IT Customer Support Worldwide

For country specific customer support, go to the APC by Schneider Electric Web site, www.apc.com.