

Addendum Smart-UPS[™] C 1000/1500 TW 120 Vac Tower/Rack-Mount 2U

Overview

This addendum provides corrections to the Operation Manuals for Smart-UPS[™] C 1000TW/1500TW 120V Tower and Rack-Mount 2U models.

Feature Reference Guide

Rear panel features of SMC1000TW and SMC1500TWTower models

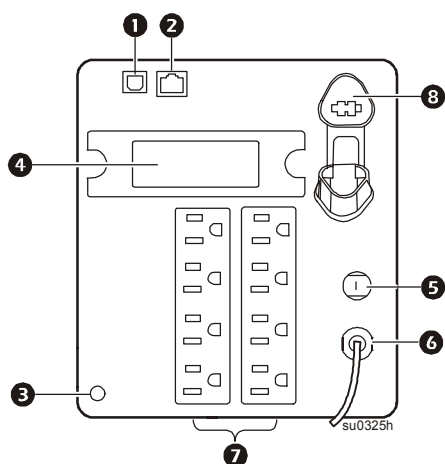

1	USB port
2	Serial data port
3	Chassis ground screw
4	SmartSlot for optional NMC accessory card
5	Circuit breaker/Overload protection
6	UPS input
7	Outlets
8	Battery connector

Rear panel features of SMC1000-RM2UTW Rack-Mount model

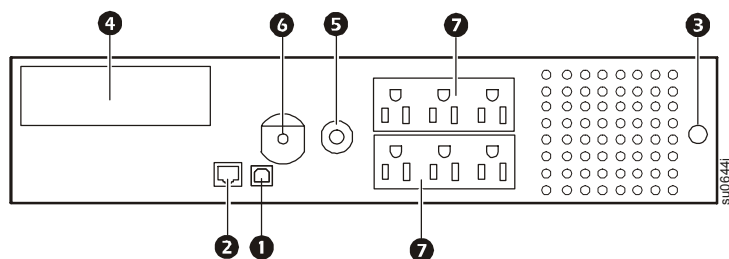

Rear panel features of SMC1500-RM2UTW Rack-Mount model

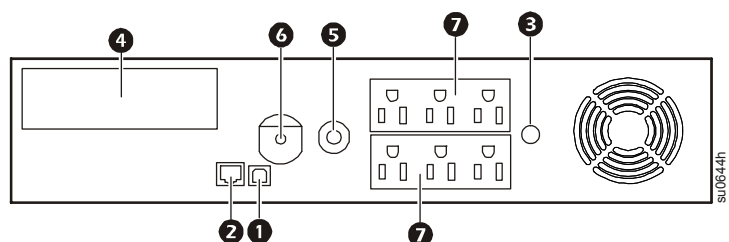

Customer support and warranty information is available at the APC by Schneider Electric Web site, www.apc.com.