



**APPLICATION GUIDE**  
**Intermediate Switch**

**CAT. NO.**  
E8231MF

**Pieno**

Thank you for choosing **Schneider Electric** Pieno's electronic accessories. To ensure proper application of our products, please read through the following information before installation and use .

This application guide applies to the following products.

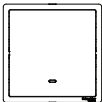

**Cat.no.**

E8231MF

**Description**

20A-16AX 250V 1 Gang Intermediate Switch  
with Fluorescent Locator

## SPECIFICATIONS

Rated Voltage	: 250V~
Rated Current	: 20A-16AX
Dimension	: 87mm x 87mm
Mounting Centre	: 60.3mm
Compliance	: GB 16915.1, IEC 60669-1, BSEN 60669-1, MSIEC 60669-1, SS 227-1

## IMPORTANT NOTE

1. The products must be installed by qualified electricians.
2. Please check your local wiring regulations before installation.
3. Safekeeping the faceplate to prevent damage during product installation.
4. Turn off the power supply when you clean the product. Use a soft, slightly-moistened cloth or tissue paper to wipe off the dust and dirt on the surface. Clean with much diluted detergent if necessary but avoid using corrosive chemicals.

## WIRING DIAGRAMS

E8231MF

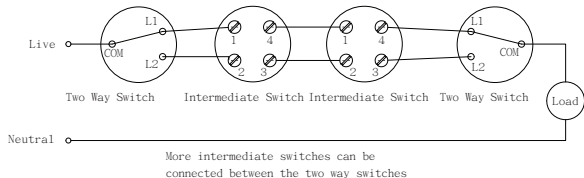

## MOUNTING INSTRUCTION

1. Connect the wires to the terminals (recommend to leave 10-12mm bare metal wire) and tighten the terminal screws.
2. Screw the grid plate onto the wall box.
3. Snap the faceplate onto the grid plate.

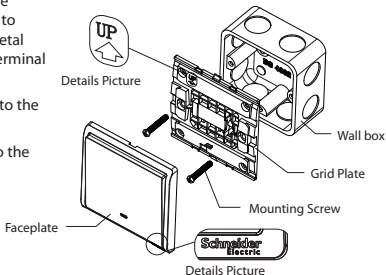

Insert a screwdriver into the clip lock, and twist the screwdriver to remove the faceplate.

