



APPLICATION GUIDE
5W Volume Control, 8Ω

CAT. NO.
E8231VC_5

Pieno

Thank you for choosing **Schneider Electric Pieno's** electronic accessories. To ensure proper application of our products, please read through the following information before installation and use.

This application guide applies to the following products.

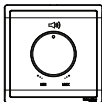

Cat. no.

E8231VC_5

Description

5W Volume Control, 8 Ω

SPECIFICATIONS

Rated Voltage	: 24V DC
Rated Power	: 5W
Dimension	: 87mm x 87mm
Mounting Centre	: 60.3 mm

IMPORTANT NOTE

1. The products must be installed by qualified electricians.
2. Please check your local wiring regulations before installation.
3. Safekeeping the faceplate to prevent damage during product installation.
4. Turn off the power supply when you clean the product. Use a soft, slightly-moistened cloth or tissue paper to wipe off the dust and dirt on the surface. Clean with much diluted detergent if necessary but avoid using corrosive chemicals.

WIRING DIAGRAMS

E8231VC_5

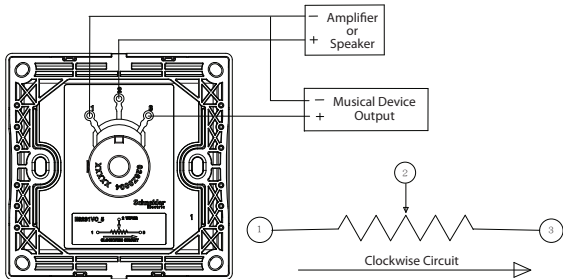

MOUNTING INSTRUCTION

1. Connect the wires to the terminals (recommend to leave 10-12mm bare metal wire) and tighten the terminal screws.
2. Screw the grid plate onto the wall box.
3. Snap the faceplate onto the grid plate.

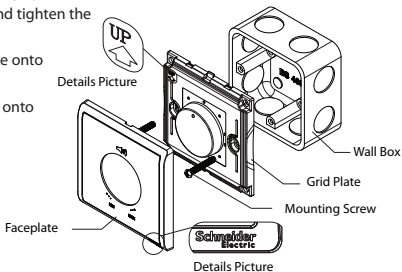

Insert a screwdriver into the clip lock, and twist the screwdriver to remove the faceplate.

