

**[EN] - Instructions for use**

Code LSS100100

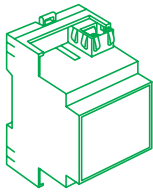

**homeLYnk**  
Logic controller



KNX/Modbus/BACnet/IP



**Connections and operating elements**

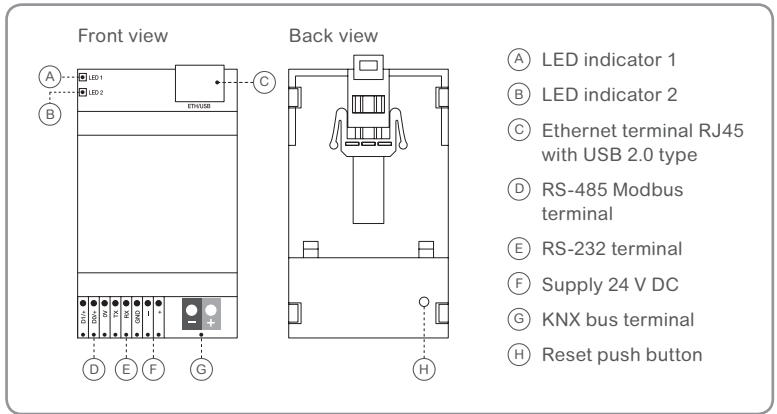

**For your safety**



**Danger**

Risk of fatal injury due to electrical current.

Any work on the device should only be carried out by qualified electricians. Please observe the country specific regulations as well as the relevant KNX guidelines.



**Danger**

The homeLYnk must be supplied via a SELV and low power circuit (LPS) certified power supply, according to the IEC 60950-1.

**Mounting the homeLYnk**



**Warning**

Risk of death from electric shock.

Mishandling of the device may cause damage. Safety clearance must be adhered to in accordance with IEC 60664-1. There must be at least 4 mm between the individual cores of the 230 V supply cable and the KNX bus cable.

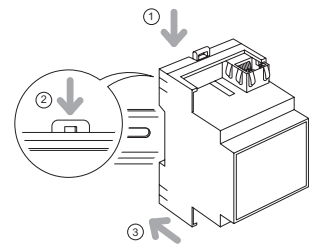
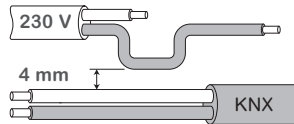

- ① Place the device into the DIN rail (see picture)
- ② Press down the DIN rail lock
- ③ Wire the device of the desired application accordingly and connect the power supply at the end

**Getting to know**

The homeLYnk is the easiest way to visualise and program complex logic in KNX and Modbus networks.

Applications:

- > Logical functions
- > WEB SCADA visualization for PC and touch-devices
- > Cross-standard gateway between KNX and Modbus RTU/TCP
- > BACnet Server
- > Integration with third party devices over RS-232 (IR, AV)
- > Scheduling
- > Camera streaming
- > Data logger with trends

**Technical data**

Supply voltage	24 V DC	<b>Terminal</b>	
Power consumption	2 W	KNX bus	Bus connecting terminal 2 x 0.8 mm
LED indicator 1	Green LED (CPU load)	Power supply	Clamp, 0.5 mm <sup>2</sup> –1.5 mm <sup>2</sup>
LED indicator 2	Green LED (Operation) or Red LED (Reset)	Serial	Clamp, 0.5 mm <sup>2</sup> –1.5 mm <sup>2</sup>
Interface	1x KNX 1x10BaseT/100BaseTX 1x RS-485 (incl. polarization resistors 47 kΩ, no termination) 1x RS-232 1x USB2.0 1x Reset push button	Operation	-5°C to +45°C
		Environment	Can be used at elevations up to 2000 m above sea level (MSL)
		Max. humidity	93%, no condensation
		Dimension (HxWxD)	90 x 52 x 58 mm

**Network configuration**

**Default IP configuration**

Login name:	admin
Password:	admin
IP address on LAN	192.168.0.10
Networks mask on LAN	255.255.255.0

Please read the homeLYnk product manual carefully for advice on how to configure and program the device properly. This product manual is available at Schneider Electric front office in your country.

www.schneider-electric.com

**Status LED**

Procedure		LED 1 status	LED 2 status
Operating device		Blinking Green proportionally to CPU load	Green steady ON
Rebooting device	<b>Press RESET &lt; 10sec</b>	Steady Red	Steady Red
Temporary settings of default IP	<b>Press RESET &gt; 10 sec</b> To exit temporary settings <b>Press RESET &lt; 10 sec</b> or Select system config -> <b>System -&gt; Reboot</b>	Blinking Red	Blinking Red
Factory settings of default IP passwords & project deleted	<b>Press RESET &gt; 10 sec + Release</b> <b>+ Press RESET &gt; 10 sec</b>	Flashing Red	Flashing Red

If you have any technical questions, please contact the customer care center for your country.