

FD6Q RG-6 Quad Shield Connector Installation Instructions

Preparing RG-6 Cable for a Connector

Step 1: Cut the cable squarely across the end with the 60-0558-000 cable cutters. Open the jaws of the 490RIO00400 RG-6 installation tool, and set the cable in the trough with the cable end placed against the stop.

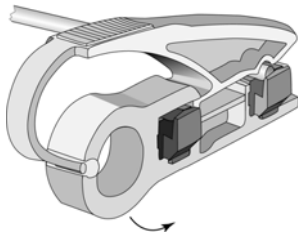

Parts Required: FD6Q cassette with 10 connectors
P/N MA-0329-001

Tools Required: Cable cutters, P/N 60-0558-000
RG-6 installation tool, P/N 490RIO00400
Crimp tool, P/N 60-0544-000
7/16 inch open-end wrench

Note: If you are using dual or messenger cable, remove the rib before preparing the cable.

Step 2: Release the handle and let the spring hold the tool on the cable. Rotate the stripper with your index finger on the handle until the tool turns freely. Let the spring provide the cutting pressure.

Note: Adjust the number of rotations so that the second blade cuts as little of the braid as possible. When the cracking noise stops, the first blade has cut through the shields.

Step 3: If the cable is not fully stripped, you may squeeze the jaws of the tool together with your thumb and forefinger. Using light pressure, make one or two revolutions of the tool around the cable until the tool cuts through the cable jacket.

Step 4: Open the jaws and remove the cable. Twist off the cable dielectric and jacket by hand. Remove any long braid strands remaining around the prepared cable end. (Long braid strands may indicate that a new blade pack is needed.) Remove any dielectric on the exposed center conductor.

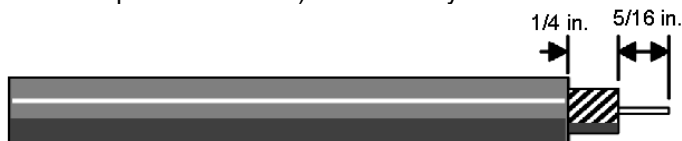

Step 5:



- 1 Fold all of the braid over the jacket.
- 2 Avoid tearing the inner cable foil.

Once this cable preparation procedure is completed, you are ready to install RG-6 connectors and/or adapters on the cable.

Installing FD6Q Connectors on Quad Shield RG-6 Cable

Note: Use an FD6Q connector from an MA-0329-001 cassette on the RG-6 quad shield cable prepared according to the procedure described on the previous page.

Step 1: Place the cable against the side of the FD6Q connector, aligning the end of the jacket with the bottom of the crimp ring. Mark the cable jacket at the top of the crimp ring.

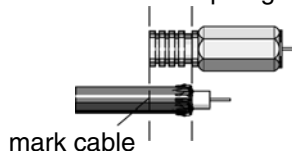

Step 2: Using a twisting motion, push the cable firmly into the end of the FD6Q connector in the MA-0329-001 cassette until the cable mark lines up with the end of the crimp ring.

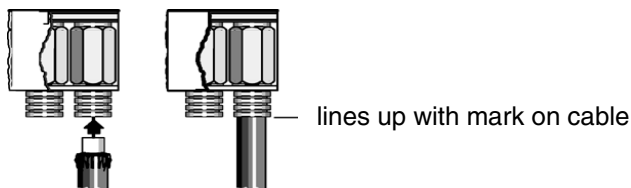

Step 3: Remove the FD6Q connector by sliding it out of the side of the cassette.

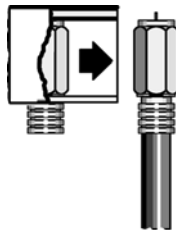

Step 4: Align the 60-0544-000 crimp tool on the FD6Q connector, and apply a .360 in. crimp.

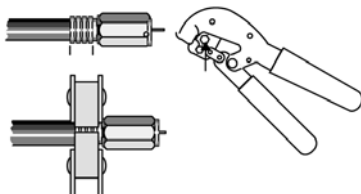

Step 5: Pull on the FD6Q connector to make sure that the crimp is snug. The connector should not fall off.

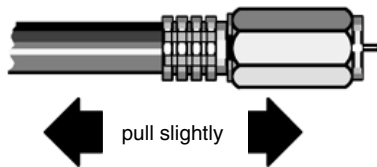

Step 6: Install the FD6Q connector on the cable port of the RIO drop adapter, tap, or other cable hardware device using a 7/16 inch open-end wrench.

Note: Finger tightening is not sufficient. Required torque is 0.8...1.2 N•m (7.1...10.6 lbf-in).

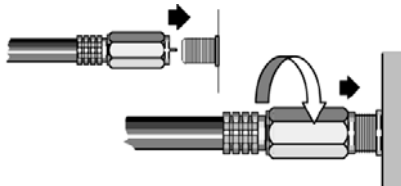

www.schneider-electric.com

Printed in