

Circularity Profile

Mobyia Original -SOLAR LANTERN



Potential disassembly risks

The Circularity profile provides information about preparation for re-use and treatment. It identifies the relevant EEE components and materials as well as their location. Safety instructions for product dismantling and depollution are provided into the User manual or maintenance guide.

End of Life Instructions

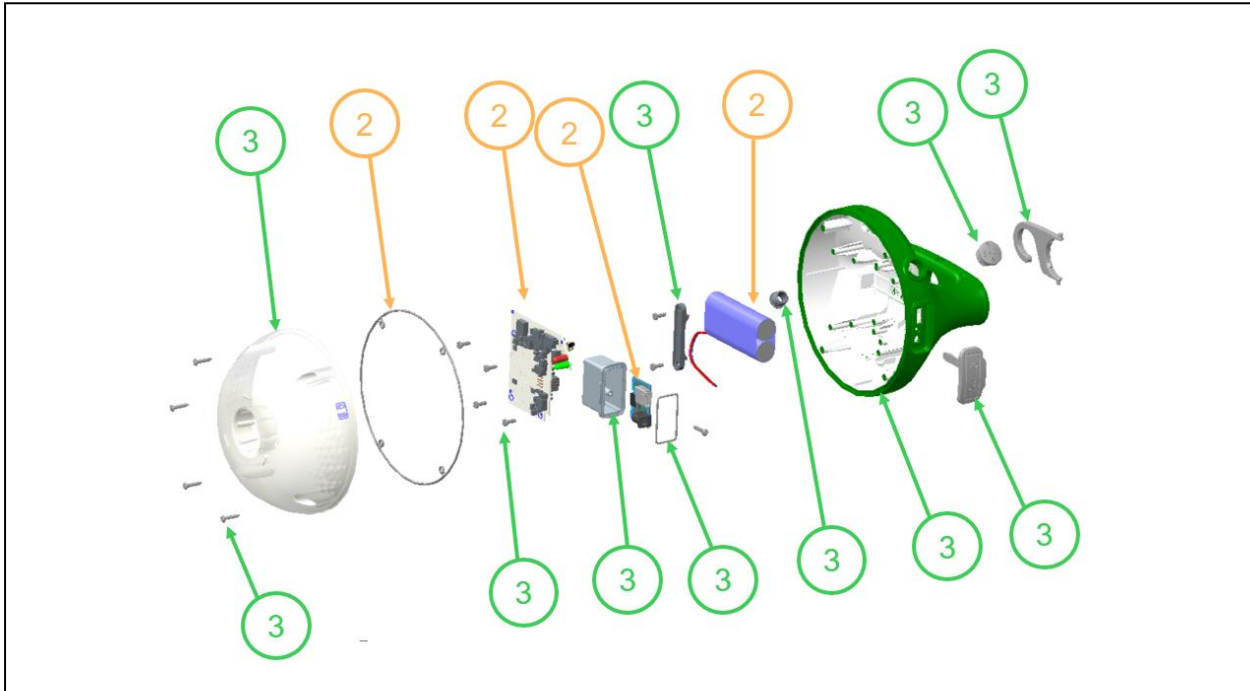

Recommendation	Number on drawing	Component / Material	Weight (in g)	Comment
Potential hazards	1			No Potential Hazards
To be depolluted	2	Electronic Board (Communication) > 10cm ²	60.7583 g	
To be depolluted	2	Other battery	81 g	
To be dismantled	3	Plastic Cover, Screw & Handle	874.75 g	
Other				



Product description

Manufacturer identification	Schneider Electric Industries SAS
Brand name	Schneider Electric
Product function	Mobyia Original is a portable solar LED lighting system providing safe, green and reliable access to energy with multiple mounting options will conveniently lights up your surroundings and charges your basic mobile phone.
Product reference	AEP-LOR01-S1000
Additional similar product references	AEP-LOR01-S1000
Total representative product mass	1010 g
Representative product dimensions	142mm x 155mm x 152mm
Accessories	0
Date of information release	11/2019



Additional information

Legal information	The product family must be disposed according to the legislation of the country. This document is intended for use by end of life recyclers or treatment facilities. It provides the basic information to assure an appropriate end of life treatment for the components and materials of the product.	
Recyclability potential	53%	Based on "ECO'DEEE recyclability and recoverability calculation method" (version V1, 20 Sep. 2008 presented to the French Agency for Environment and Energy Management: ADEME).

Schneider Electric Industries SAS

Country Customer Care Center
<http://www.schneider-electric.com/contact>

35, rue Joseph Monier

CS 30323

F- 92506 Rueil Malmaison Cedex

RCS Nanterre 954 503 439

Capital social 896 313 776 €

www.schneider-electric.com

ENVEOLI1911011_V1

Published by Schneider Electric

© 2019 - Schneider Electric – All rights reserved

11/2019