

# Product End of Life Instructions

## Head Lamp

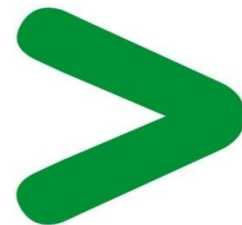

 **End of Life Instructions**

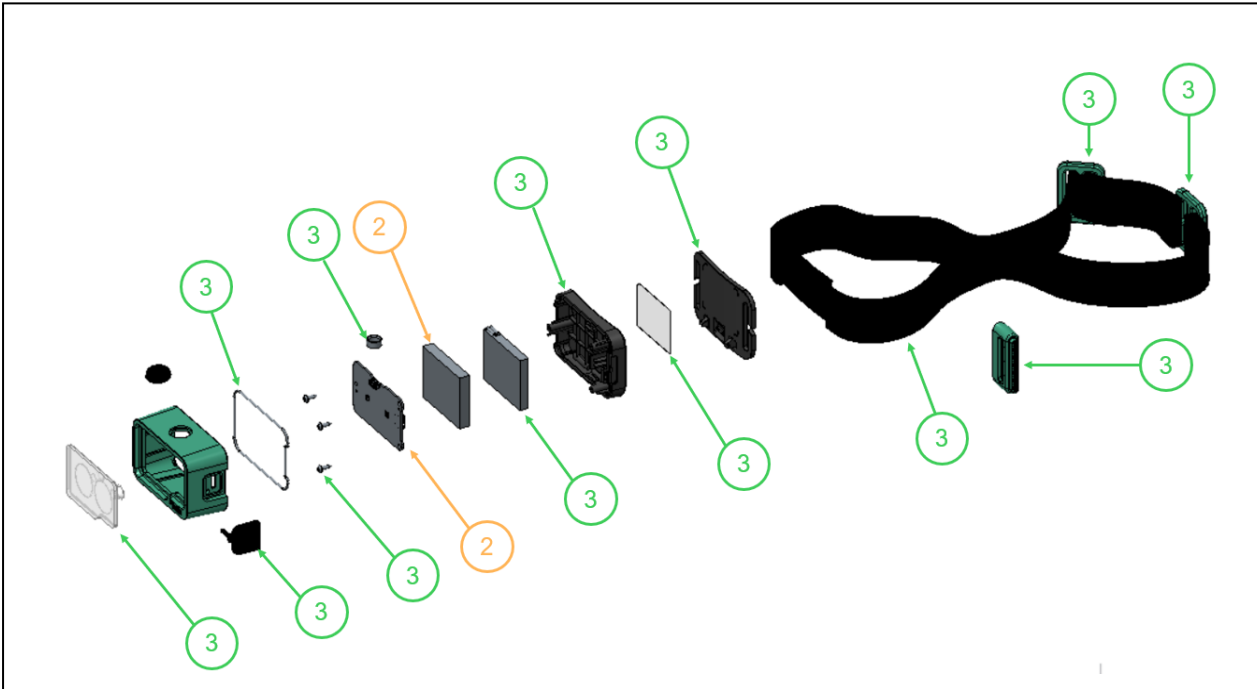

Recommendation	Number on drawing	Component / Material	Weight (in g)	Comment
Potential hazards	1			No Potential hazards
To be depolluted	2	Electronic Board (Communication) > 10cm <sup>2</sup>	6.24 g	
To be depolluted	2	Other battery	10 g	
To be dismantled	3	Plastics and Metals	62.7 g	
Other				

 **Product description**

Manufacturer identification	Schneider Electric Industries SAS
Brand name	Schneider Electric
Product function	Mobiya Front Headlamp comes with 2 color lights- Red and White. White light ensures enough light to carry essential activities, Red light emits light to see, while at the same keeping your eyes adjusted to the darkness. RED flash (strobe) light is perfect while walking and cycling to ensure you are seen during dusk and dark hours and also which can be conveniently worn and mounted in varied positions for applications like camping, hiking, cooking, reading, cycling, gardening etc..
Product reference	AEP-LF01-S1000
Additional similar product references	AEP-LF01-S1000
Total representative product mass	74.53 g
Representative product dimensions	H 56 mm x L 295 mm x D 36 mm
Date of information release	09/2019



## Additional information

<b>Legal information</b>	This product family is in the scope of European Union directive 2012/19/EU on Waste Electrical and Electronic Equipment (WEEE). The product family must be disposed according to the legislation of the country. This document is intended for use by end of life recyclers or treatment facilities. It provides the basic information to assure an appropriate end of life treatment for the components and materials of the product.	
<b>Recyclability potential</b>	<b>33%</b>	Based on “ECO'DEEEE recyclability and recoverability calculation method” (version V1, 20 Sep. 2008 presented to the French Agency for Environment and Energy Management: ADEME).

Schneider Electric Industries SAS

Country Customer Care Center  
<http://www.schneider-electric.com/contact>

35, rue Joseph Monier

CS 30323

F- 92506 Rueil Malmaison Cedex

RCS Nanterre 954 503 439

Capital social 896 313 776 €

[www.schneider-electric.com](http://www.schneider-electric.com)

ENVEOLI1909002\_V1

Published by Schneider Electric

© 2019 - Schneider Electric – All rights reserved

09/2019