

# Product End of Life Instructions

## WATSN63/4H





## End of Life Instructions

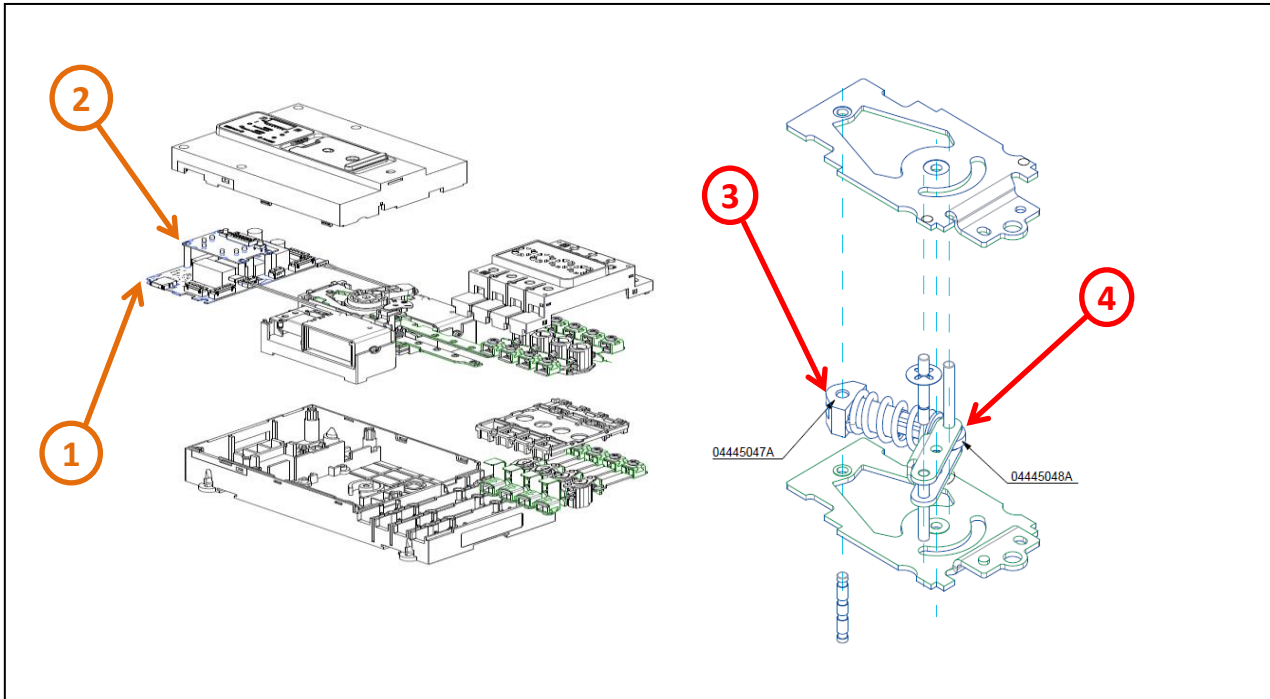

Recommendation	Number on drawing	Component / Material	Weight (in g)	Comment
To be depolluted	1,2	Electronic Board (Communication) > 10cm <sup>2</sup>	101.37	2 PCBA, Including all soldering parts
Potential hazards	3,4	PA6 GF30 FR(17)	4.74	Plastic with Br FR



## Product description

Manufacturer identification	Schneider Electric Industries SAS
Brand name	Schneider electric
Product function	WATSN63/4H is transfer switching equipment (TSE) which to be used in power systems for transferring a load supply between a normal and an alternate source with a supply interruption during transfer.
Product reference	NH00634
Total representative product mass	2699.3 g
Representative product dimensions	240mm x 138mm x 95mm
Accessories	No
Date of information release	08/2020



## Additional information

Legal information	This product family is in the scope of European Union directive 2012/19/EU on Waste Electrical and Electronic Equipment (WEEE). The product family must be disposed according to the legislation of the country. This document is intended for use by end of life recyclers or treatment facilities. It provides the basic information to assure an appropriate end of life treatment for the components and materials of the product.	
In case of special transportation: transportation method	No	
Recyclability potential	<b>62%</b>	Based on "ECO'DEEE recyclability and recoverability calculation method" (version V1, 20 Sep. 2008 presented to the French Agency for Environment and Energy Management: ADEME).

Schneider Electric Industries SAS  
 Country Customer Care Center  
<http://www.schneider-electric.com/contact>  
 35, rue Joseph Monier  
 CS 30323  
 F- 92506 Rueil Malmaison Cedex  
 RCS Nanterre 954 503 439  
 Capital social 896 313 776 €  
[www.schneider-electric.com](http://www.schneider-electric.com)

Published by Schneider Electric

ENVEOLI2007006\_V1

© 2019 - Schneider Electric – All rights reserved

08/2020