

# Product End-of-Life Instructions

**Exiway Smartled maintained**

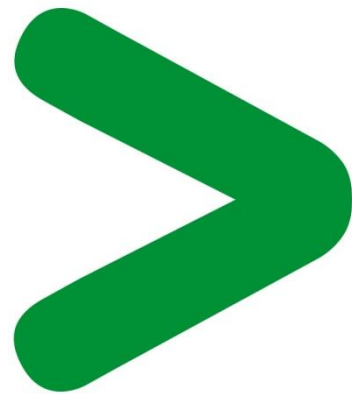

# Product End-of-Life Instructions – EoLI

## Product overview

**Product Range:** Exiway Smartled non maintained

**Marketing Model/Name:** EXIWAY-SMARTLED IP65 ACT.L/700SA/1NMH ref. OVA48314

This document covers all the product of the Exiway Smartled maintained range: OVA48100, OVA48102, OVA48303, OVA48304, OVA48306, OVA48314, OVA48315

**Size:** H x L x D in mm = 127 x 300 x 45.5

**Weight** in g:       **570 without batteries**  
                              **from 710 to 880 with batteries**

## Purpose

The product family must be disposed according to the legislation of the country. This document is intended for use by end of life recyclers or treatment facilities. It provides the basic information to assure an appropriate end of life treatment for the components and materials of the product.

## Note:

This product family is in the scope of European Union directive 2012/19/EU on Waste Electrical and Electronic Equipment (WEEE).

## Operations recommended for the end of life treatment

There are several steps to process the products at the end of life so as to recover components, materials or energy :

**Reuse → Separation for special treatment → Other dismantling → Shredding**

## Product End-of-Life Instructions – EoLI

The components of the products that optimize the recycling performances are listed, identified and located hereunder.

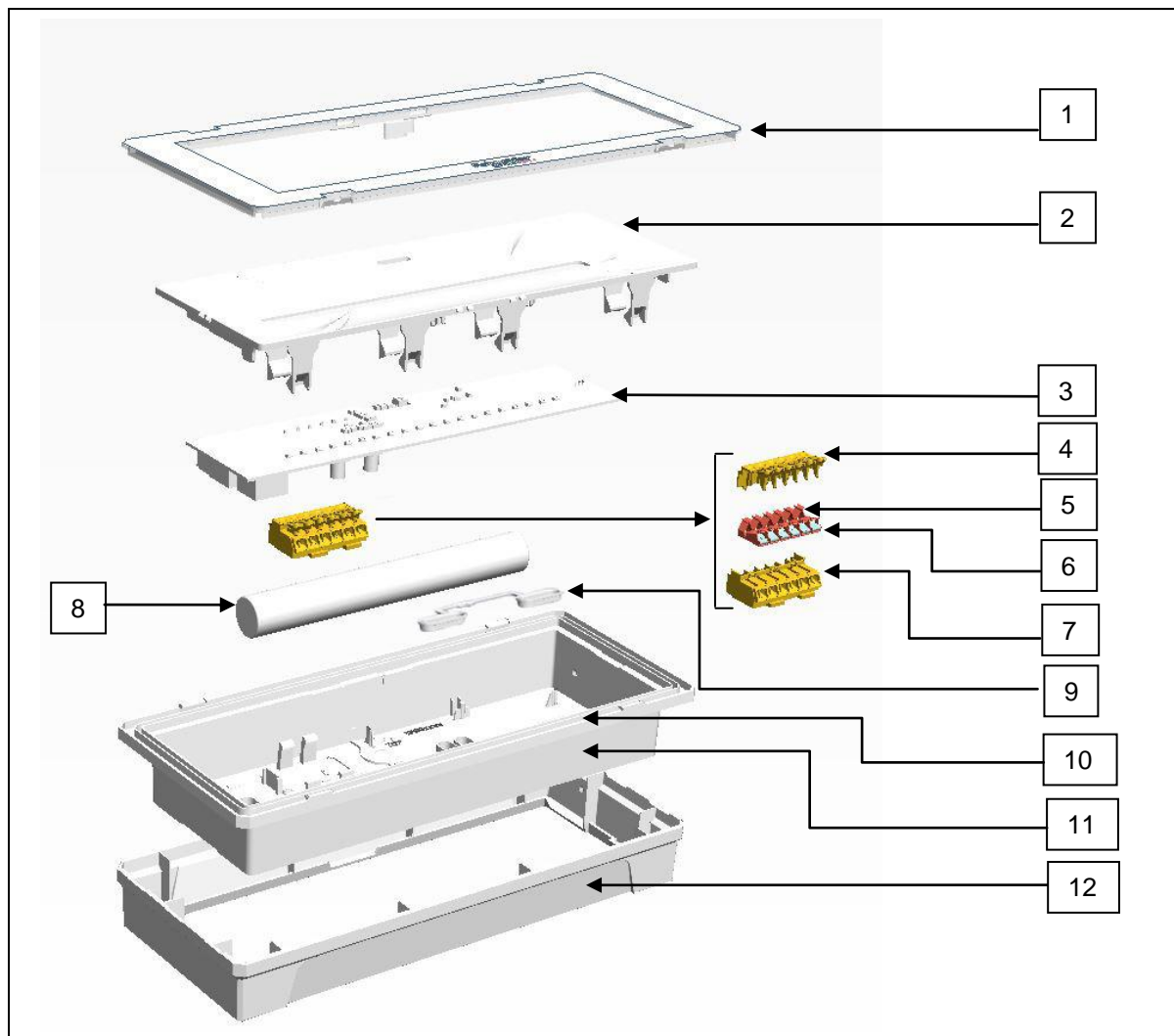

| Recommendation    | Number on drawing | Components         | Weight (in g) | Comment |
|-------------------|-------------------|--------------------|---------------|---------|
| Shredding         | 5                 | contacts           | 9             | BRASS   |
|                   | 6                 | spring             | 1,8           | STEEL   |
|                   | 9                 | cap                | 2,4           | PE      |
|                   | 10                | sealing ring       | 1,6           | SEBS    |
|                   |                   |                    |               |         |
| Special treatment | 3                 | electronic card    | 78            |         |
|                   | 8                 | battery            | 312           |         |
| Other dismantling | 1                 | Transparent screen | 109           | PC      |
|                   | 2                 | reflector          | 74            | PC      |
|                   | 4                 | connector          | 2,7           | PA      |
|                   | 7                 | connector          | 4,7           | PA      |
|                   | 11                | body               | 179           | PC+SEBS |
|                   | 12                | frame              | 98            | PC      |

EoLI achieved with Schneider-Electric TT03 V5 procedure

### Schneider Electric Industries SAS

35, rue Joseph Monier  
CS 30323  
F- 92506 Rueil Malmaison Cedex  
RCS Nanterre 954 503 439  
Capital social 896 313 776 €

[www.schneider-electric.com](http://www.schneider-electric.com)