

# Product End-of-Life Instructions

## ALTIVAR PROCESS

### Product Range

Altivar Process – Ranges: 7.5 to 11 kW – 3 PH – 400/480 V – IP12 and 55 to 7.5 kW – 3 PH – 200/240 V – IP21

### Marketing Model

Altivar 630 – 7.5 kW / 400-480 V / 3-ph rating / IP21 (ref. ATV630U75N4)

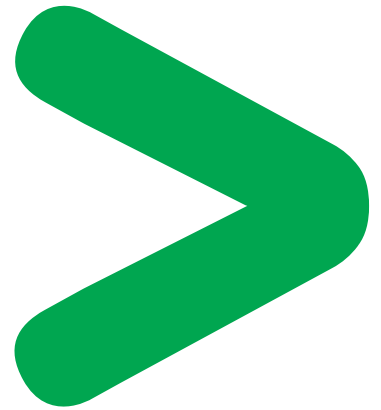

### Size in mm:

H x L x D : 395 x 168 x 232

### Weight in g:

9.6 to 11.1 for the product range.

11124 for ATV630U75N4 including packaging and batteries (weight of the battery is 3)



## Operations recommended for the end of life treatment

There are several steps to process the products at the end of life so as to recover components, materials or energy :

Reuse ⇒ Separation for special treatment ⇒ Other Dismantling ⇒ Shredding

**CAUTION:** This product contains electrolytic capacitors which may cause electrical shock during the end of life treatment process. **BEFORE SERVICING, REMOVE ALL POWER, WAIT 15 MINUTES.**

The components of the products that optimize the recycling performances are listed, identified and located hereunder.

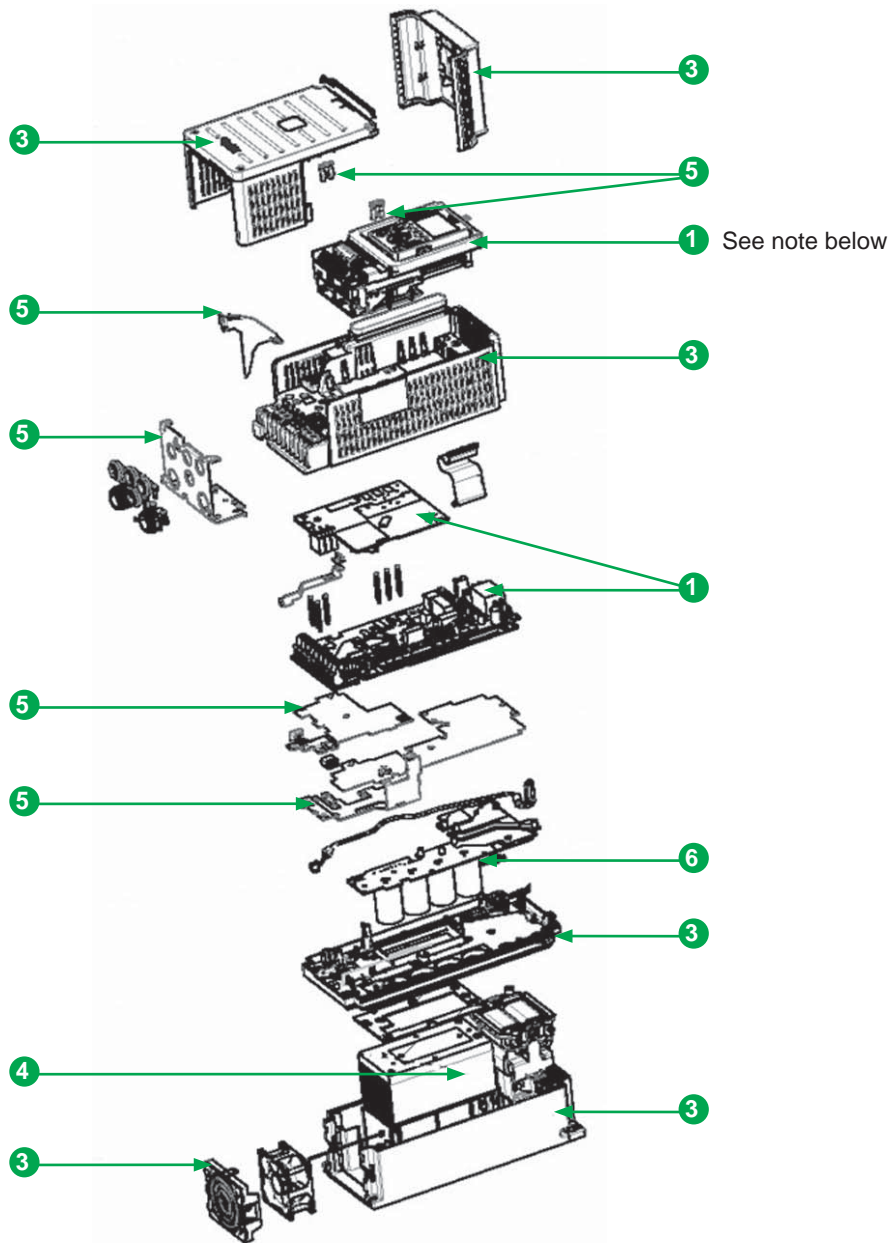

Note:



Recommendation	Number on drawing	Components	Weight (g)	Comment
Operating hazards	6	Electrolytic capacitors	90	–
Special treatment	1	Printed Circuit Board Assembly (PCBA) or power components	1379	PCBAs are included
	2	Manganese Dioxide Lithium Coin Battery	3	The battery is located inside the Keypad
Other dismantling	3	Plastic part	2077	PC FR, Housing, Chassis
	4	Aluminium	1212	Heatsink
	5	Steel	339	Bars

**Schneider Electric Industries SAS**

35, rue Joseph Monier  
CS30323  
F - 92506 Rueil Malmaison Cedex

RCS Nanterre 954 503 439  
Capital social 896 313 776 €  
www.schneider-electric.com

The version of the Guide used to create the document: End of Life Instruction Drafting Guide of Schneider Electric version V1.

Publication : Schneider Electric