

Product End-of-Life Instructions

TeSys D

LC1D40A, LC1D50A, LC1D65A

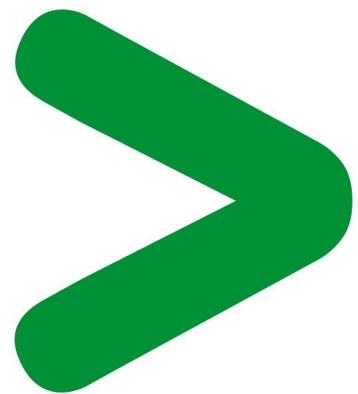

Product End-of-Life Instructions – EoLI

Product overview

Product Range: TeSys D (LC1D40A, LC1D50A, LC1D65A)

Marketing Model/Name: GDP: 0BXJ 0BXK 0BXL 0BXM 0BXN 0BXP 0BXQ 0BXR
0BXS 0BXT 0BXZ 0BY0 0BY1 0BY2 0BY3 0BY4 0BY9 0BYA 0BYB 0BYC 0BYD
0BYE 0BYF 0BYG 0BYH 0BYJ 0BYK 0BYL 0BYQ 0BYR 0BYS 0BYT 0BYU 0BYV
0U2F 0WD5 0WD6 0WD7 0WD9 1327 1328 1392 1393 1394 1395 1504 1881
1999 2604 2605 2712 2714 2859 2897 2899 3510 3518 4677 4679 4681
4825 4833 4834 4835 4836 4837 4842 4845 4850 4851 4906 4908 4916
4917 4919 4921 4925 4927 4929 4947 4948 4949 4950 5213 7606

Size: H x L x D in mm = **118 x 55 x 117**

Weight in g:

Between 175.6 and 230.6

Purpose

The product family must be disposed according to the legislation of the country. This document is intended for use by end of life recyclers or treatment facilities. It provides the basic information to assure an appropriate end of life treatment for the components and materials of the product.

Note:

This product family is in the scope of European Union directive 2012/19/EU on Waste Electrical and Electronic Equipment (WEEE).

Operations recommended for the end of life treatment

There are several steps to process the products at the end of life so as to recover components, materials or energy :

Reuse → Separation for special treatment → Other dismantling → Shredding

CAUTION: The product contains plastic parts with brominated FR are recommended to be treated separately during the End of Life operations.

Product End-of-Life Instructions – EoLI

The components of the products that optimize the recycling performances are listed, identified and located hereunder.

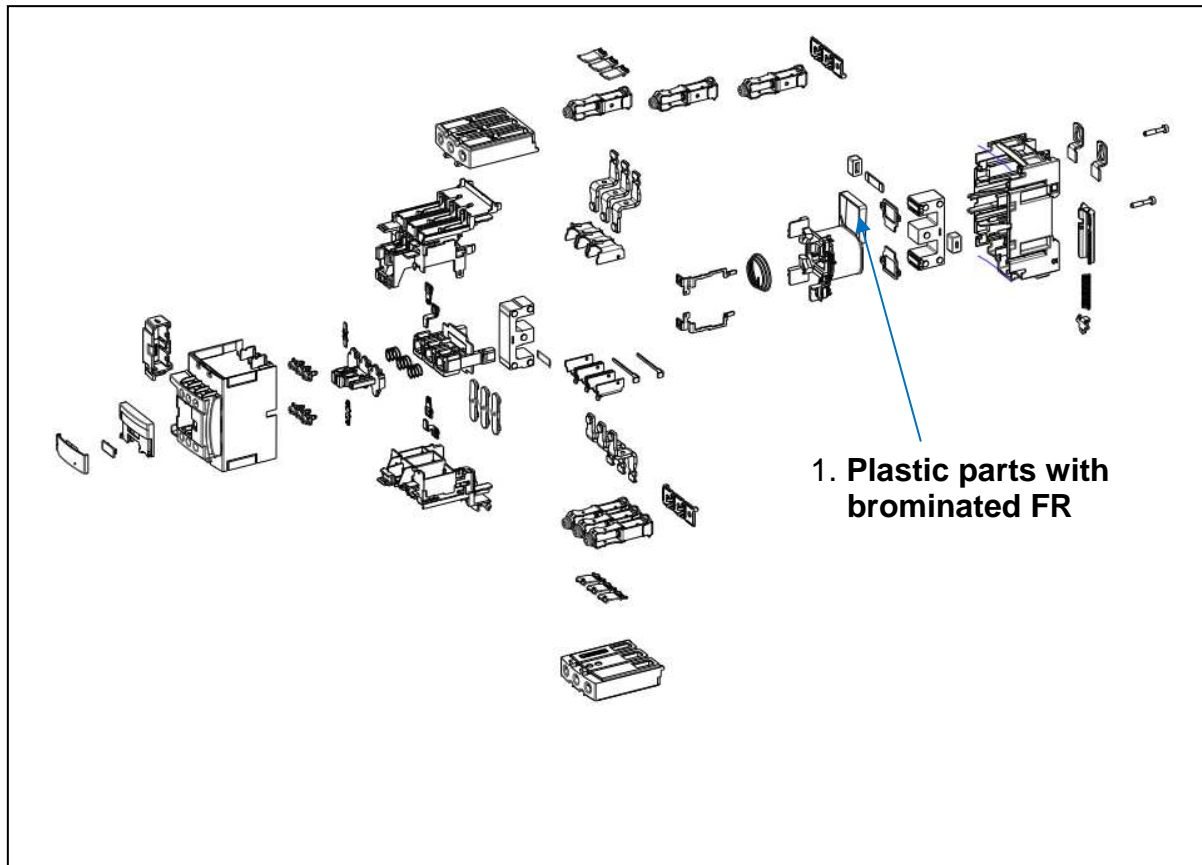

Recommendation	Number on drawing	Components	Weight (in g)	Comment
Special treatment	1	Plastic parts with brominated FR	17.8	

EoLI achieved with Schneider-Electric TT03 V5 procedure

Schneider Electric Industries SAS

35, rue Joseph Monier
 CS 30323
 F- 92506 Rueil Malmaison Cedex
 RCS Nanterre 954 503 439
 Capital social 896 313 776 €

www.schneider-electric.com