

Product End-of-Life Instructions

Product End-of-life Instructions

Emergency Lighting Exiway one / Exiway plus.



Marketing Model/Name:

EXIWAY-ONE IP65 ACT.24/600/1NC OVA38687

Covered subrange: OVA38687, OVA34330, OVA38686, OVA34325, OVA38685, OVA34310, OVA34317, OVA38670, OVA38647, OVA38673, OVA38652, OVA38632, OVA38671, OVA34324, OVA38648, OVA38649, OVA34316, OVA34306, OVA38620, OVA38630, OVA38631, OVA38672, OVA38651, OVA38650, OVA38860, OVA38861, OVA34429, OVA38820, OVA38850, OVA38834, OVA38848, OVA38851, OVA38832, OVA34409, OVA34424, OVA38835, OVA34416, OVA38821, OVA34423, OVA38849, OVA34405, OVA34415, OVA38833, OVA38813

Size H x L X D in mm:

Exiway One: 160 x 377 x 76

Exiway Plus: 164 x 373 x 73

Weight in mm:

Between n 800 and 970 without battery

Between 1200 and 1635 with batteries

Schneider
Electric

Product End-of-life Instruction

Purpose

The product family must be disposed according to the legislation of the country. This document is intended for use by end of life recyclers or treatment facilities. It provides the basic information to assure an appropriate end of life treatment for the components and materials of the product.

Note

This product family is in the scope of EU directive 2002/96/EC, Waste Electrical and Electronic Equipment (WEEE).

Operations recommended for the end of life treatment

There are several steps to process the products at the end of life so as to recover components, materials or energy: Reuse → Depollution → Dismantling → Shredding.

The components of the products that are recommended to be depolluted (according to the WEEE 2002/96/EC list) or that are recommended to be reused or dismantled so as to improve the material recovery or that lead to some hazard are listed, identified and located hereunder.

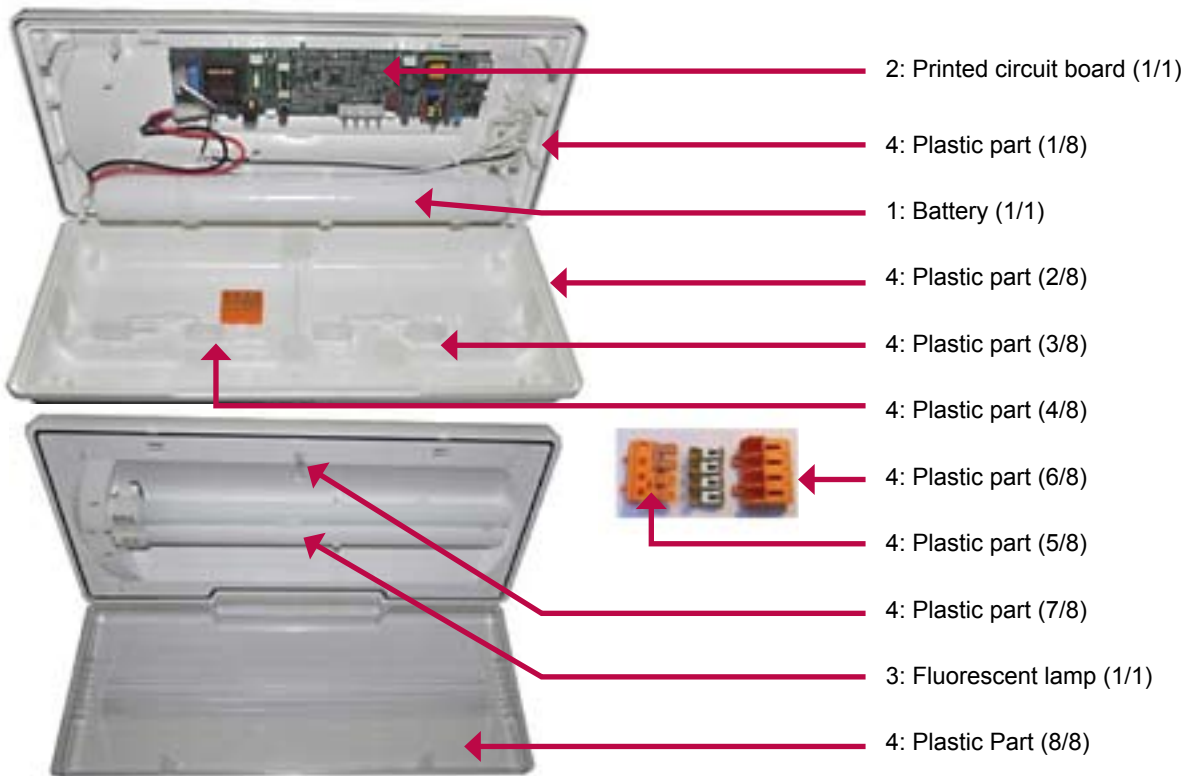

Number on drawing	Components	Weight (g)	Comment
Components listed for depollution			
1	Batteries	668 g	1 part
2	Printed circuit board	125 g	1 part
3	Fluorescent lamp	82 g	1 part
Components listed for dismantling operation which improves the recycling performance			
4	Plastic parts	730 g	8 parts

Schneider Electric Industries SAS
 35 rue Joseph Monier
 92500 Rueil-Malmaison
 France

www.schneider-electric.com

The version of the Buide used to create the document: End of Life Instruction Drafting Guide of Schneider Electric version V2.
 Publication date: 12/2010