

1

2

3

4

A

A

B

B

C

C

D

D

E

E

F

F

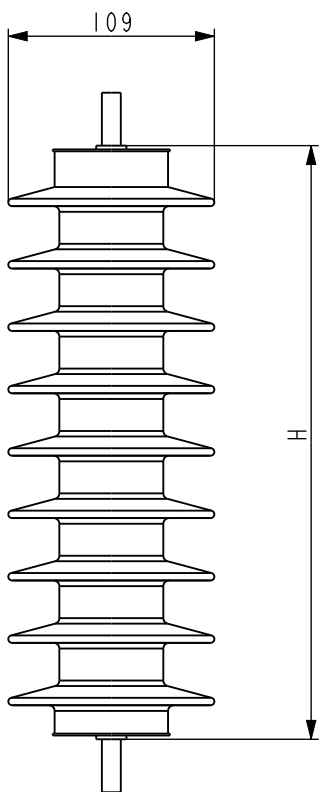

RATED VOLTGE (Ur) kv	CONTINUOUS OPERATING VOLTAGE (Uc) kv	CREEPAGE DISTANCE mm	HEIGHT FROM BASE TO CAP (H) mm	INSULATOIN WITHSTAND VALUES			MINIMUM MOUTING(2)	
				1.2/50 BIL (kV cr)	SWITCHING IMPULSE (kV cr)	POWER FREQUINCY 1MIN.WET WITHSTAND (kv rms)	PHASE TO PHASE mm	PHASE TO GROUND mm
12kv	10.2kv	391	173	100	60	40	124	89
12kv	10.2kv	782mm	310mm	165	100	70	124	89
15kv	12.7kv	782mm	310mm	165	100	70	157	122
21kv	17kv	782mm	310mm	165	100	70	193	157
30kv	24.4kv	1173mm	447mm	230	140	105	249	213
36kv	29kv	1173mm	447mm	230	140	105	249	213
36kv	29kv	1565mm	584mm	310	180	140	249	213

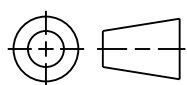

Scale:
0.063

Technical Specification:
ISO 8015

Units of measure :
mm



Document Description:
SURGE ARRESTER BRITECH OHIO BRASS PVI-LP

Document Number:
PHA9292602

Doc. Rev.
00

Sheet:
1 / 1

The information is highly confidential and is the exclusive property of Schneider Electric copyright reserved. This drawing must not be used for any purpose other than that expressly permitted in writing by the owners and must not be disclosed or reproduced in any way without permission from the owners in writing. This drawing must be returned to the owners when the purpose has ceased.

State:

Provisional