

Product End-of-Life Instructions

Lexium 32-40A AC servo drive

Product Range

Lexium 32-40A AC servo drive

Marketing Model

LXM32MC10N4, LXM32MD85N4

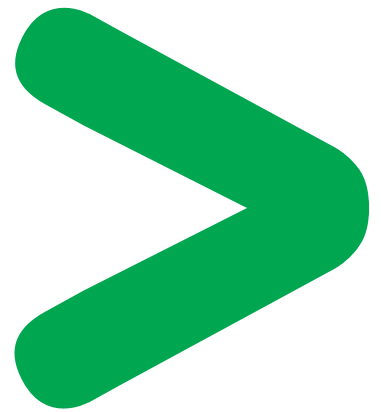

Size in mm:

H x L x D : 385 x 180 x 240

Weight (excluding packaging) in g:

10750



Schneider
Electric

Operations recommended for the end of life treatment

There are several steps to process the products at the end of life so as to recover components, materials or energy :

Reuse ⇒ Separation for special treatment ⇒ Other Dismantling ⇒ Shredding

The components of the products that optimize the recycling performances are listed, identified and located hereunder.

This product contains printed circuit boards which are recommended to be treated separately during the End of Life operations.

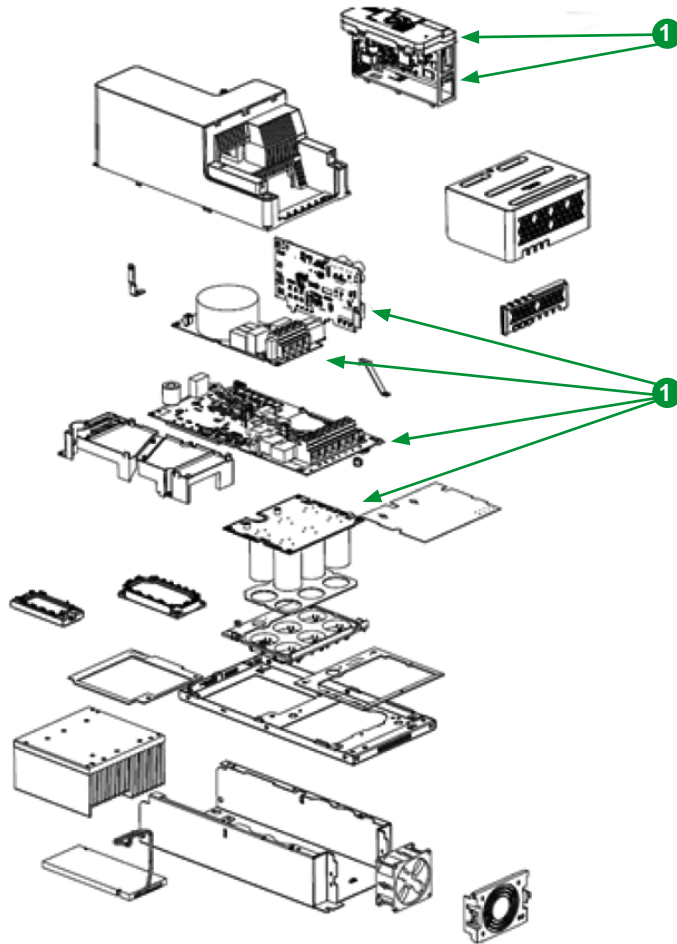

Recommendation	Number on drawing	Components	Weight (g)	Comment
Special treatment	1	PCBAs	3208	6 PCBAs

Schneider Electric Industries SAS

35, rue Joseph Monier
CS30323
F - 92506 Rueil Malmaison Cedex

RCS Nanterre 954 503 439
Capital social 896 313 776 €
www.schneider-electric.com

The version of the Guide used to create the document: End of Life Instruction Drafting Guide of Schneider Electric version V3.

Publication : Schneider Electric