

Product End of Life Instructions

Acti9 C120H 3P C 100A MCB

Acti9



Schneider
Electric



End of Life Instructions

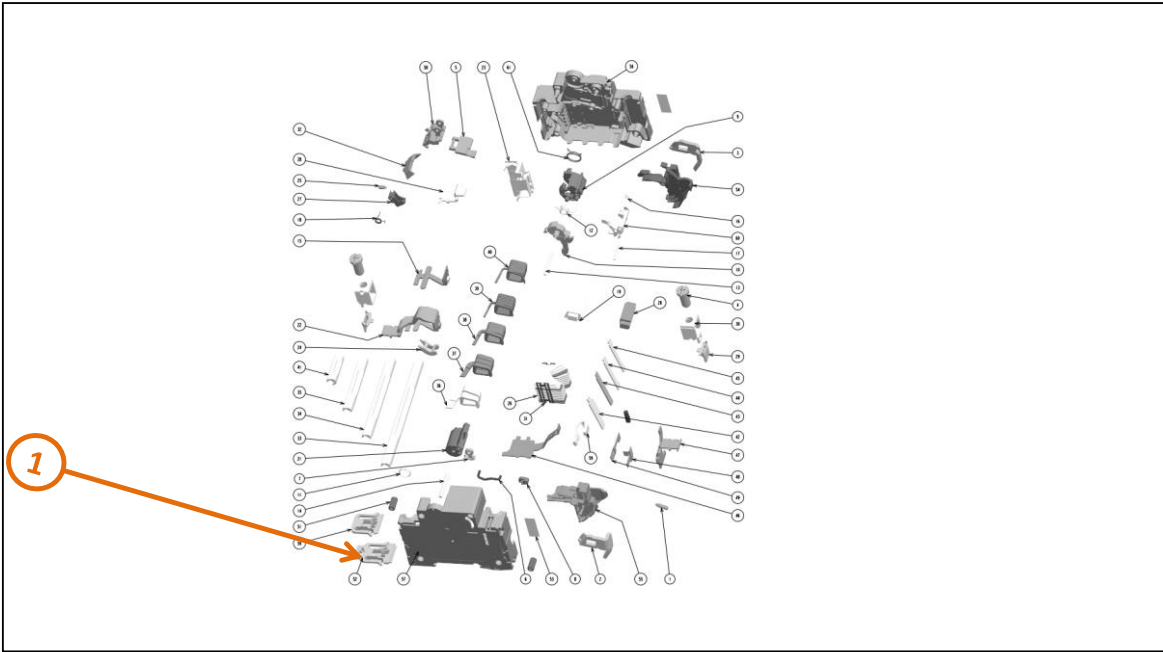

Recommendation	Number on drawing	Component / Material	Weight (in g)	Comment
To be depolluted	1	PAA with brominated flame retardants	4.2	Plastic with brominate FR



Product description

Manufacturer identification	Schneider Electric Industries SAS
Brand name	Schneider Electric
Product function	The main function of this product is to provide overload protection and short circuit protection in low voltage power
Product reference	A9N19818
Additional similar product references	A9I47292 A9I47391 A9I47392 A9I48163 A9I48180 A9I48191 A9I48192 A9I48263 A9I48280 A9I48291 A9I48292 A9I48363 A9I48380 A9I48391 A9I48392 A9I48463 A9I48480 A9I48491 A9I48492 A9I49163 A9I49180 A9I49191 A9I49192 A9I49263 A9I49280 A9I49291 A9I49292 A9I49363 A9I49380 A9I49391 A9I49392 A9I49463
Total representative product mass	615 g
Representative product dimensions	81mm x 73mm x 81mm
Accessories	No
Date of information release	2023/12/01

Additional information

Legal information	This product family is in the scope of European Union directive 2012/19/EU on Waste Electrical and Electronic Equipment (WEEE). The product family must be disposed according to the legislation of the country. This document is intended for use by end of life recyclers or treatment facilities. It provides the basic information to assure an appropriate end of life treatment for the components and materials of the product.	
In case of special transportation: transportation method	No	
Recyclability potential	60%	Recyclability rate has been calculated based on REEECY'LAB tool developed by Ecosystem, for components/materials not covered by the tool, data from the "ECO'DEEE recyclability and recoverability calculation method" was taken. If no data was found a conservative assumption was used (0% recyclability).

Schneider Electric Industries SAS
Country Customer Care Center
<http://www.schneider-electric.com/contact>
35, rue Joseph Monier
CS 30323
F- 92500 Rueil Malmaison Cedex
RCS Nanterre 954 503 439
Capital social 896 313 776 €

www.se.com

ENVEOLI2309008_V1

Published by Schneider Electric

© 2023 - Schneider Electric – All rights reserved

2023/12/01