

# Product End of Life Instructions

## EXW-SMARTBEAM-FR IP42\* ACT/D3 L6V/SA/3LFP





## Potential disassembly risks



## End of Life Instructions

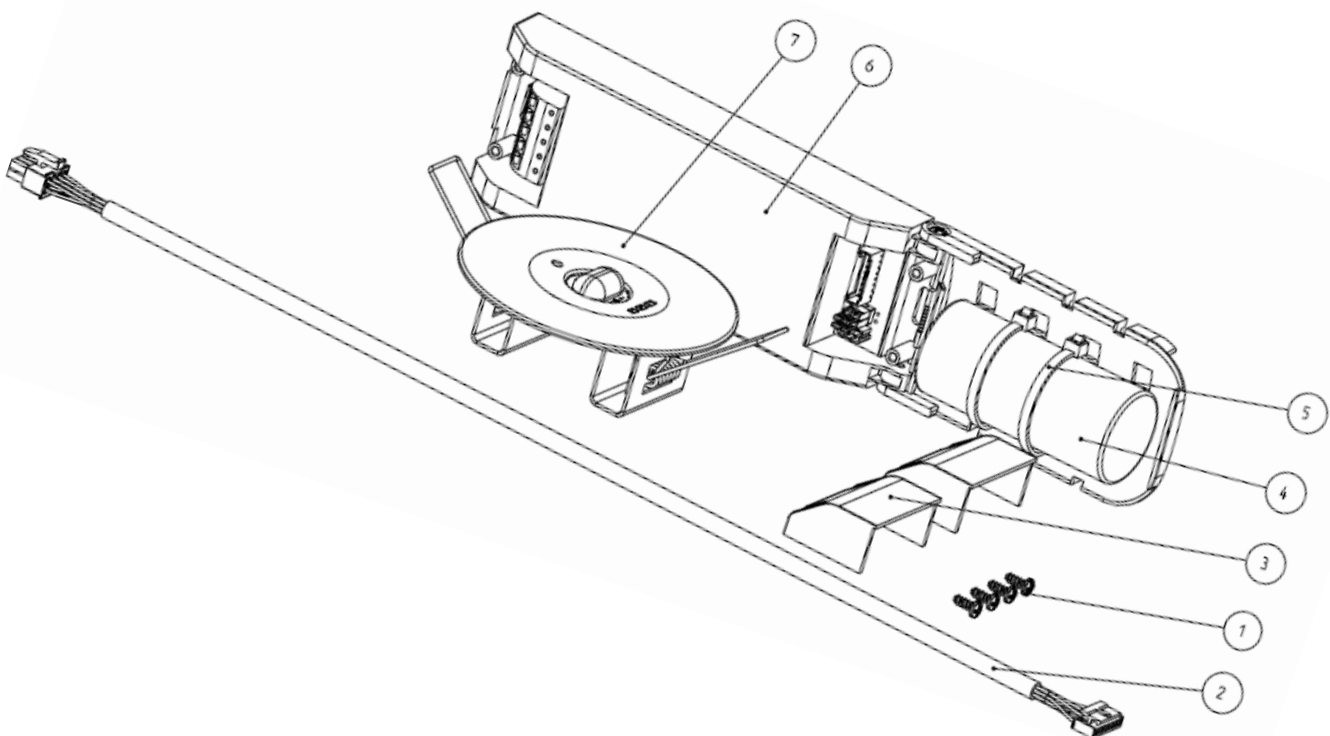

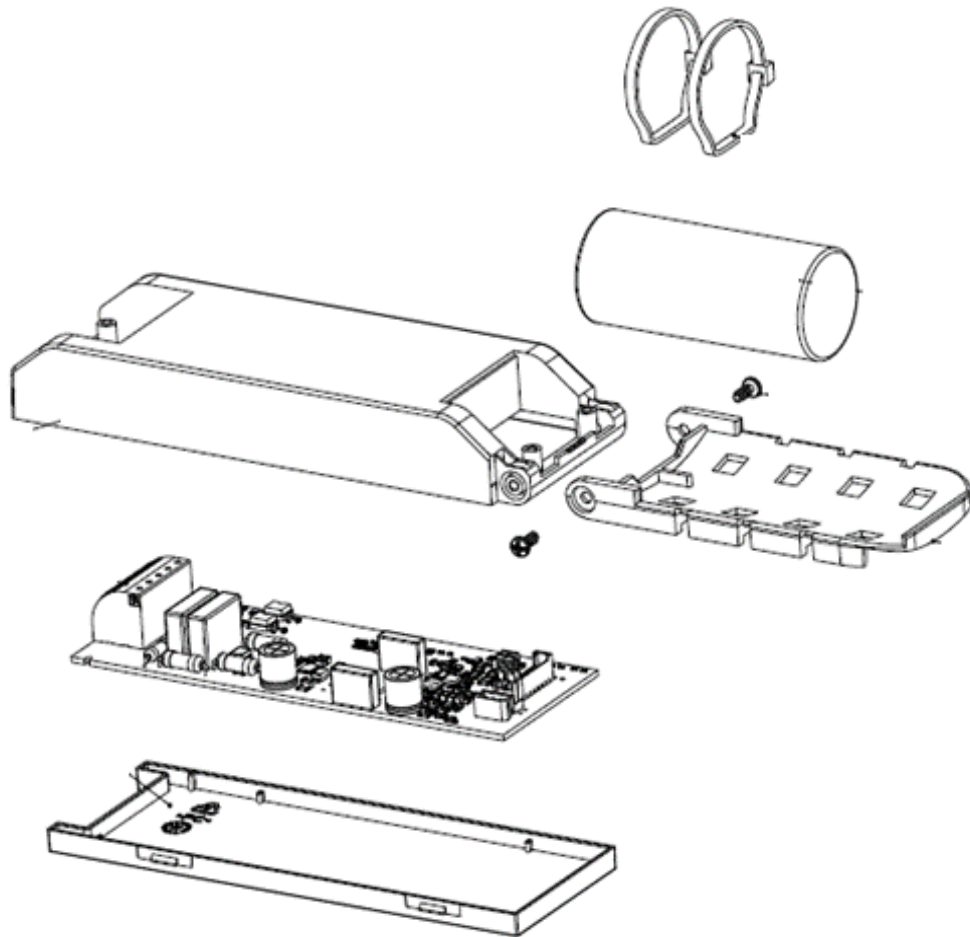

Recommendation	Number on drawing	Component / Material	Weight (in g)	Comment
To be depolluted	1	Steel (Screws)	0.5	
To be depolluted	2	Electronic component (Lens supply cable)	18	
To be dismantled	3	PC (Coverage)	17	
To be depolluted	4	Battery Lithium iron phosphate (LiFePO4) (BATT.LFP11FR26650 3,2V3,2AH+N LCF3)	92	
To be dismantled	5	PC(Cable tie)	1	
To be dismantled	6	PC (Body)	65	
To be depolluted	7	Lens	1.5	

## Product description

Manufacturer identification	Schneider Electric Industries SAS
Brand name	Schneider Electric
Product function	Maintained and Non Maintained emergency luminaire (EN 60598-2-22) Luminaire in which the emergency lighting lamps are energized at all times when normal or emergency lighting is required
Product reference	OVA48954
Additional similar product references	OVA48952   OVA48953   OVA48954   OVA48955   OVA48956
Total representative product mass	300 g
Representative product dimensions	90 x 32 x 165 mm
Date of information release	03/2023

## Additional information

Legal information	This product family is in the scope of European Union directive 2012/19/EU on Waste Electrical and Electronic Equipment (WEEE). The product family must be disposed according to the legislation of the country. This document is intended for use by end of life recyclers or treatment facilities. It provides the basic information to assure an appropriate end of life treatment for the components and materials of the product.	
Recyclability potential	70%	Recyclability rate has been calculated based on REEECY'LAB tool developed by Ecosystem, for components/materials not covered by the tool, data from the "ECO'DEEE recyclability and recoverability calculation method" was taken. If no data was found a conservative assumption was used (0% recyclability).

Schneider Electric Industries SAS

Country Customer Care Center  
<http://www.schneider-electric.com/contact>

35, rue Joseph Monier

CS 30323

F- 92500 Rueil Malmaison Cedex

RCS Nanterre 954 503 439

Capital social 896 313 776 €

[www.se.com](http://www.se.com)

Published by Schneider Electric

ENVEOLI2207008\_V1

© 2022 - Schneider Electric – All rights reserved

03/2023