

Product End of Life Instructions

TeSys Deca 3 pole contactor 150 A

TeSys Deca





End of Life Instructions

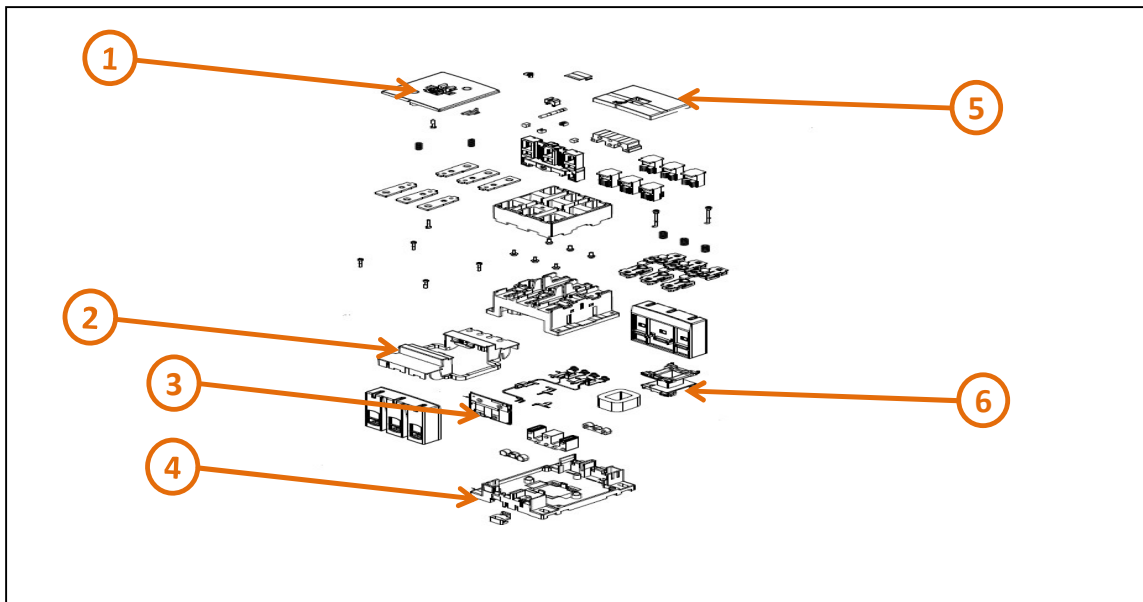

Recommendation	Number on drawing	Component / Material	Weight (in g)	Comment
To be depolluted	1,2,4,5	PC, ABS-PC, PA, PA6, HDPE, SAN with brominated flame retardants	300.686	
To be depolluted	3	Other plastic parts with brominated flame retardants	16	
To be depolluted	6	Other plastic parts with brominated flame retardants	146.5	

Product description

Manufacturer identification	Schneider Electric Industries SAS
Brand name	Schneider Electric
Product function	The main purpose of the product is to switch on and off electrical power supply of a downstream installation with an electrical and/or mechanical control.
Product reference	LC1D15000M7C
Additional similar product references	LC1D11500**C; LC1D15000**C; LC1D17000**C; (**by coil voltage code
Total representative product mass	2500 g
Representative product dimensions	158mm x 120mm x 136mm
Accessories	No
Date of information release	2023/09/13

Additional information

Legal information	This product family is in the scope of European Union directive 2012/19/EU on Waste Electrical and Electronic Equipment (WEEE). The product family must be disposed according to the legislation of the country. This document is intended for use by end of life recyclers or treatment facilities. It provides the basic information to assure an appropriate end of life treatment for the components and materials of the product.	
In case of special transportation: transportation method	No	
Recyclability potential	54%	Recyclability rate has been calculated based on REEECY'LAB tool developed by Ecosystem, for components/materials not covered by the tool, data from the "ECO' DEEE recyclability and recoverability calculation method" was taken. If no data was found a conservative assumption was used (0% recyclability).

Schneider Electric Industries SAS
 Country Customer Care Center
<http://www.schneider-electric.com/contact>
 35, rue Joseph Monier
 CS 30323
 F- 92500 Rueil Malmaison Cedex
 RCS Nanterre 954 503 439
 Capital social 896 313 776 €

www.se.com

ENVEOLI2204009_V2

Published by Schneider Electric

© 2023 - Schneider Electric – All rights reserved

2023/09/13