

Product End of Life Instructions

Unica KNX Touch Unit





End of Life Instructions

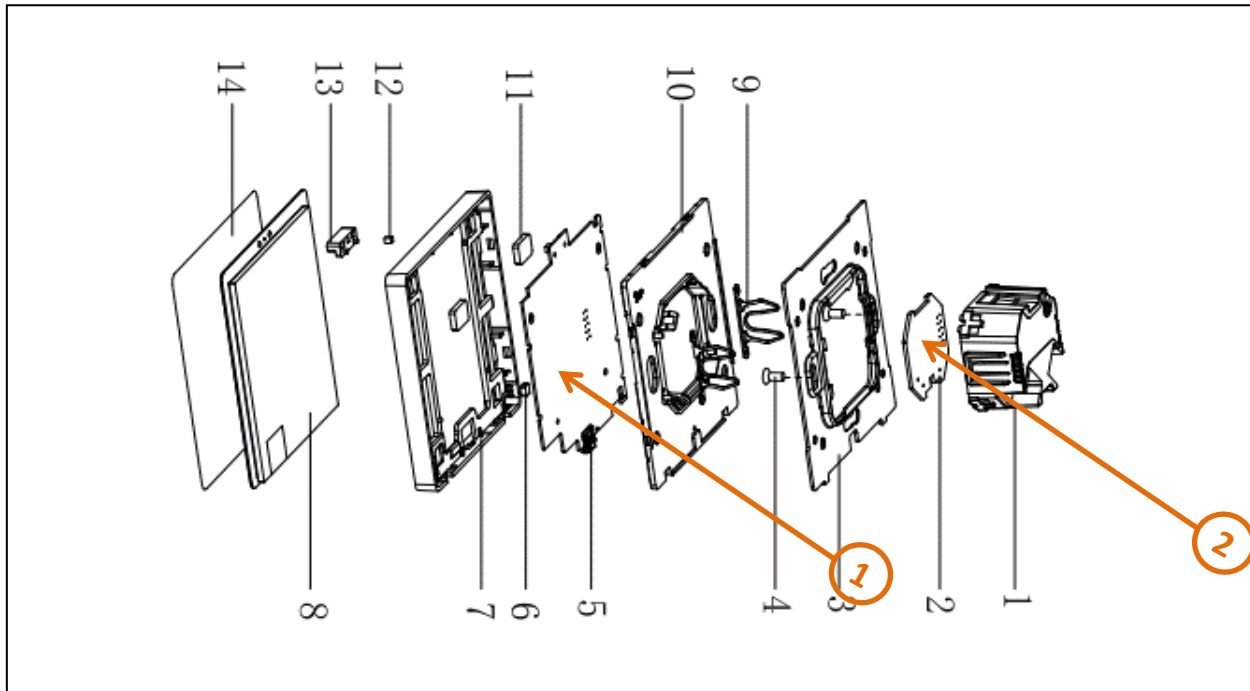

Recommendation	Number on drawing	Component / Material	Weight (in g)	Comment
To be depolluted	1	Electronic Board (Communication) > 10cm ²	16.2	Including all soldering parts
To be depolluted	2	Electronic Board (Power) > 10cm ²	9.0	Including all soldering parts



Product description

Manufacturer identification	Schneider Electric Industries SAS
Brand name	Schneider Electric
Product function	Unica KNX touch unit is a KNX programmable control unit.
Product reference	NP16260_0104
Additional similar product references	NP16260_0104
Total representative product mass	143 g
Representative product dimensions	86mm x 86mm x 32mm
Accessories	No
Date of information release	04/2022



Additional information

Legal information	This product family is in the scope of European Union directive 2012/19/EU on Waste Electrical and Electronic Equipment (WEEE). The product family must be disposed according to the legislation of the country. This document is intended for use by end of life recyclers or treatment facilities. It provides the basic information to assure an appropriate end of life treatment for the components and materials of the product.
-------------------	--

In case of special transportation: transportation method	No	
Recyclability potential	30%	Based on “ECO'DEEE recyclability and recoverability calculation method” (version V1, 20 Sep. 2008 presented to the French Agency for Environment and Energy Management: ADEME).

Schneider Electric Industries SAS
Country Customer Care Center
<http://www.schneider-electric.com/contact>
35, rue Joseph Monier

CS 30323

F- 92506 Rueil Malmaison Cedex

RCS Nanterre 954 503 439

Capital social 896 313 776 €

www.schneider-electric.com

ENVEOLI2204007_V1

Published by Schneider Electric

© 2019 - Schneider Electric – All rights reserved

04/2022