

Product End of Life Instructions

EXW-TREND IP65 LMR/500SA/1LFP

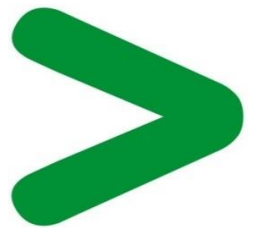



Potential disassembly risks



End of Life Instructions

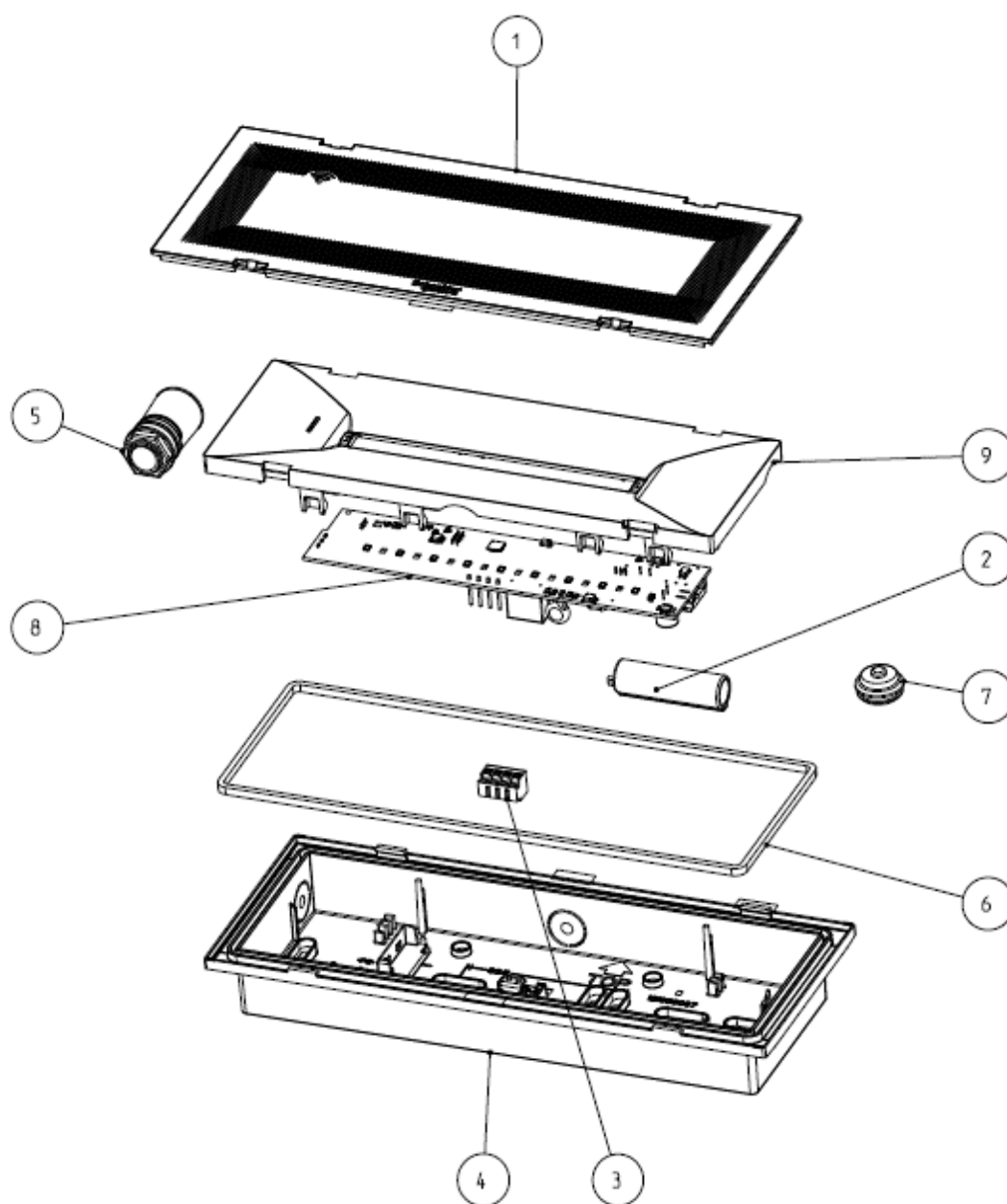

Recommendation	Number on drawing	Component / Material	Weight (in g)	Comment
To be dismantled	1	PC (Transparent screen)	94	
To be depolluted	2	BATT.LFP1IFR14500 BST3,2V0,6AH+N LCF3	97	
To be depolluted	3	Electronic Board (Power) > 10cm ² (Connector)	3	
To be dismantled	4	PC (TREND body)	150	
To be dismantled	5	PE (Cable Gland)	0,8	
To be dismantled	6	ABS Acrylonitrile Butadiene Styrene (GASKET)	1	
To be dismantled	7	PE (Cable Gland)	11	
To be depolluted	8	Electronic Board (Power) > 10cm ² (C.COL.LIGHT STD-LMR/110SA)	53	
To be dismantled	9	PC (Reflective body to fix PCBA)	74	



Product description

Manufacturer identification	Schneider Electric Industries SAS
Brand name	Schneider Electric
Product function	Maintained emergency luminaire (EN 60598-2-22) luminaire in which the emergency lighting lamps are energized at all times when normal or emergency lighting is required
Product reference	OVA47015
Additional similar product references	OVA47015 OVA47010 OVA47011 OVA47012 OVA47013 OVA47014 OVA47015 OVA47019
Total representative product mass	500 g
Representative product dimensions	292mm x 116mm x 37mm
Accessories	0
Date of information release	04/2022



Additional information

Legal information	This product family is in the scope of European Union directive 2012/19/EU on Waste Electrical and Electronic Equipment (WEEE). The product family must be disposed according to the legislation of the country. This document is intended for use by end of life recyclers or treatment facilities. It provides the basic information to assure an appropriate end of life treatment for the components and materials of the product.	
In case of special transportation: transportation method	0	
Recyclability potential	73%	Based on "ECO'DEEE recyclability and recoverability calculation method" (version V1, 20 Sep. 2008 presented to the French Agency for Environment and Energy Management: ADEME).

Schneider Electric Industries SAS

Country Customer Care Center
<http://www.schneider-electric.com/contact>

35, rue Joseph Monier
 CS 30323
 F- 92506 Rueil Malmaison Cedex
 RCS Nanterre 954 503 439
 Capital social 896 313 776 €

www.schneider-electric.com

ENVEOLI2203014_V1

Published by Schneider Electric

© 2019 - Schneider Electric – All rights reserved

04/2022