

Product End of Life Instructions

Wiser Heat Hub





Potential disassembly risks



End of Life Instructions

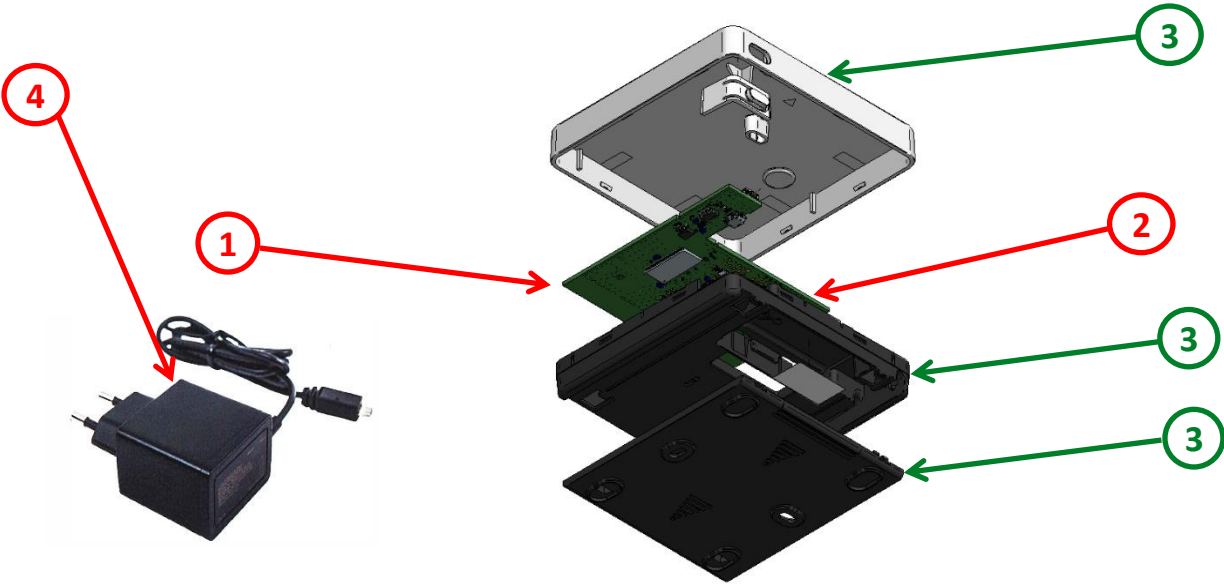

Recommendation	Number on drawing	Component / Material	Weight (in g)	Comment
To be depolluted	1	Electronic Board (Communication) > 10cm²	26.1928	
To be depolluted	1	Button Cell Battery	0.6	
Other	3	Plastics	89.8901	
To be dismantled	4	Power Supply	62.28	

Other				



Product description

Manufacturer identification	Schneider Electric Industries SAS
Brand name	Schneider Electric
Product function	Wiser Heat Hub serves as two products in one; (1) it is the brain of the Wiser Heat system, managing the system's heating zones and schedules and relays information between Wiser cloud and the various heating devices (2) It is a wireless Internet gateway, connecting a Wiser system to the Internet, via a home Wi-Fi router, and thereby enabling cloud and mobile app access.
Product reference	CCTFR6300
Additional similar product references	CCTFR6300 WT704R1S1804
Total representative product mass	261.1075 g
Representative product dimensions	102mm x 102mm x 23mm
Accessories	0
Date of information release	04/2019



Additional information

Legal information	This product family is in the scope of European Union directive 2012/19/EU on Waste Electrical and Electronic Equipment (WEEE). The product family must be disposed according to the legislation of the country. This document is intended for use by end of life recyclers or treatment facilities. It provides the basic information to assure an appropriate end of life treatment for the components and materials of the product.	
In case of special transportation: transportation method	0	
Recyclability potential	7%	Based on "ECO'DEEE recyclability and recoverability calculation method" (version V1, 20 Sep. 2008 presented to the French Agency for Environment and Energy Management: ADEME).

Schneider Electric Industries SAS

Country Customer Care Center
<http://www.schneider-electric.com/contact>

35, rue Joseph Monier
 CS 30323

*F- 92506 Rueil Malmaison Cedex
RCS Nanterre 954 503 439
Capital social 896 313 776 €*

www.schneider-electric.com

Published by Schneider Electric

ENVEOLI1807002

© 2017 - Schneider Electric – All rights reserved

04/2019