

Product End of Life Instructions

VAYU DM3110 EASY LOGIC





Potential disassembly risks

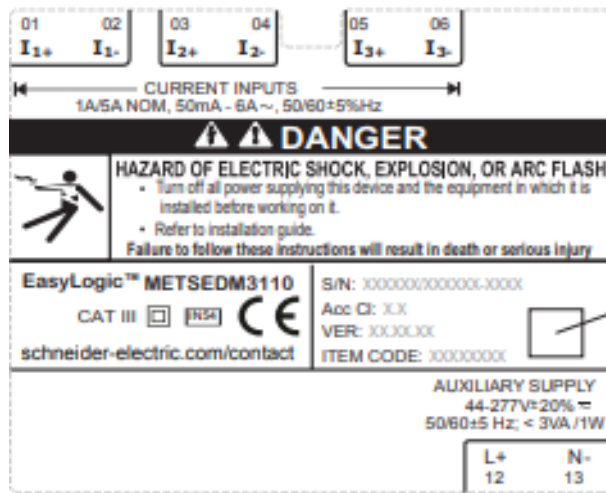

End of Life Instructions

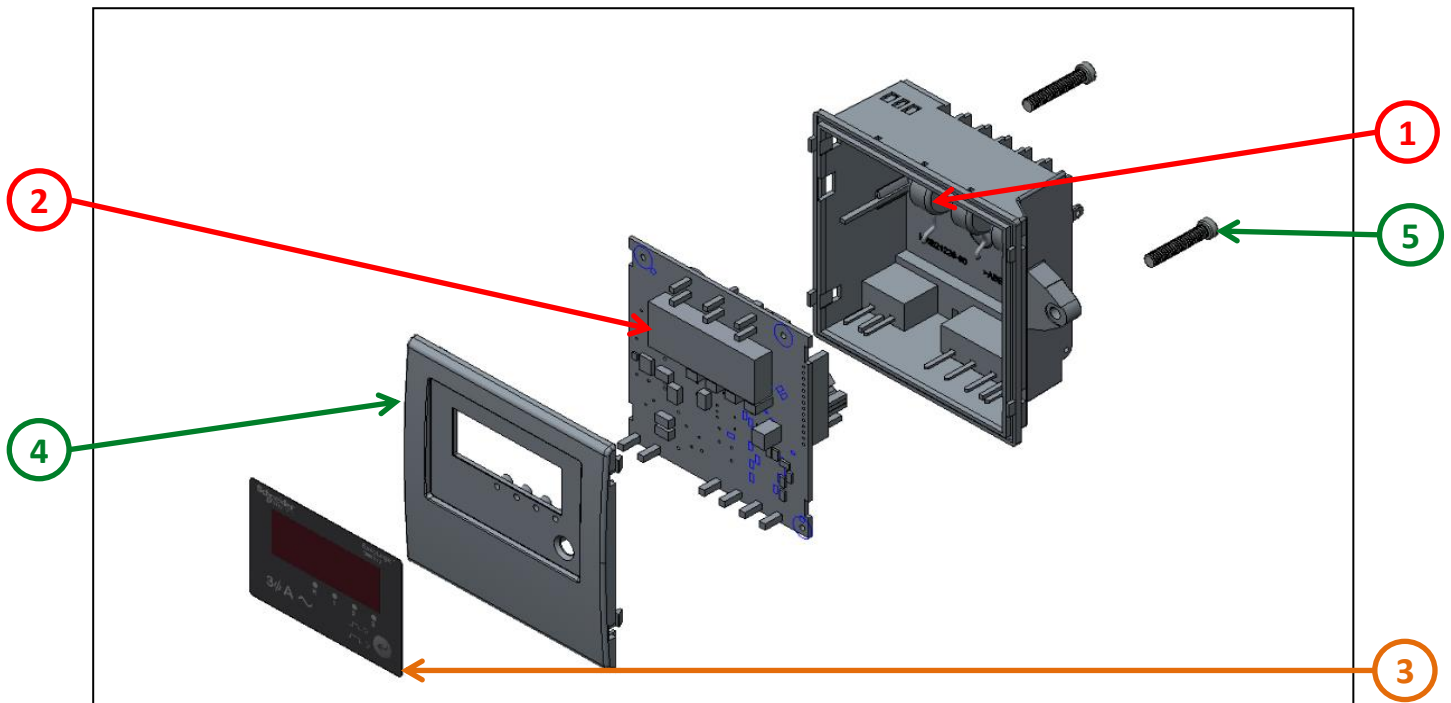

Recommendation	Number on drawing	Component / Material	Weight (in g)	Comment
To be depolluted	1	CURRENT TRANSFORMER T18 VAYU EASYLOGIC	40.5	
To be depolluted	2	DISPLAY 4 DIGIT 7 SEG	8	
To be depolluted	3	Electronic Board (Power) > 10cm ²	43.41	
To be dismantled	4	BEZEL VAYU EASYLOGIC	24.47	
To be dismantled	5	M5 X 30 MILD STEEL SLT PH HD SC DIN 84	4.2	



Product description

Manufacturer identification	Schneider Electric Industries SAS
Brand name	Schneider Electric
Product function	The main function of the EASYLOGIC DM3110 Digital panel meters is to measure the 3 phase Current (Ampere) with class 0.5 accuracy. It has large 7 segment numeric LED display, intuitive navigation for CT ratio setting & 3 phase navigation with self-guided 1 button. Bright red colour LEDs of 14.2 mm (0.55 in) height with 4 LEDs for indicating the phase unit.
Product reference	METSEDM3110
Additional similar product references	METSEDM3110
Total representative product mass	240 g
Representative product dimensions	96mm x 96mm x 52mm
Date of information release	06/2018



Additional information

Legal information	This product family is in the scope of European Union directive 2012/19/EU on Waste Electrical and Electronic Equipment (WEEE). The product family must be disposed according to the legislation of the country. This document is intended for use by end of life recyclers or treatment facilities. It provides the basic information to assure an appropriate end of life treatment for the components and materials of the product.	
Recyclability potential	13%	Based on "ECO'DEEE recyclability and recoverability calculation method" (version V1, 20 Sep. 2008 presented to the French Agency for Environment and Energy Management: ADEME).

Schneider Electric Industries SAS

Country Customer Care Center
<http://www.schneider-electric.com/contact>
 35, rue Joseph Monier
 CS 30323
 F- 92506 Rueil Malmaison Cedex
 RCS Nanterre 954 503 439
 Capital social 896 313 776 €

www.schneider-electric.com

ENVEOLI1805008_V1

Published by Schneider Electric

© 2017 - Schneider Electric – All rights reserved

06/2018