

Product End of Life Instructions

**Lexium P, Delta Robots - Standart, Flat
SH, ILM Motors - rotational, non rotational**





Potential disassembly risks



DANGER

HAZARD OF ELECTRIC SHOCK, EXPLOSION OR ARC FLASH

- Disconnect all power from all equipment including connected devices prior to removing any covers or doors, or installing or removing any accessories, hardware, cables, or wires except under the specific conditions specified in the appropriate hardware guide for this equipment.
 - Wait 5 minutes to allow the internal capacitors to discharge.
 - Always use a properly rated voltage sensing device to confirm the power is off where and when indicated.
- Failure to follow these instructions will result in death or serious injury.



End of Life Instructions

ILM0702P02F0000 – Electronic Module

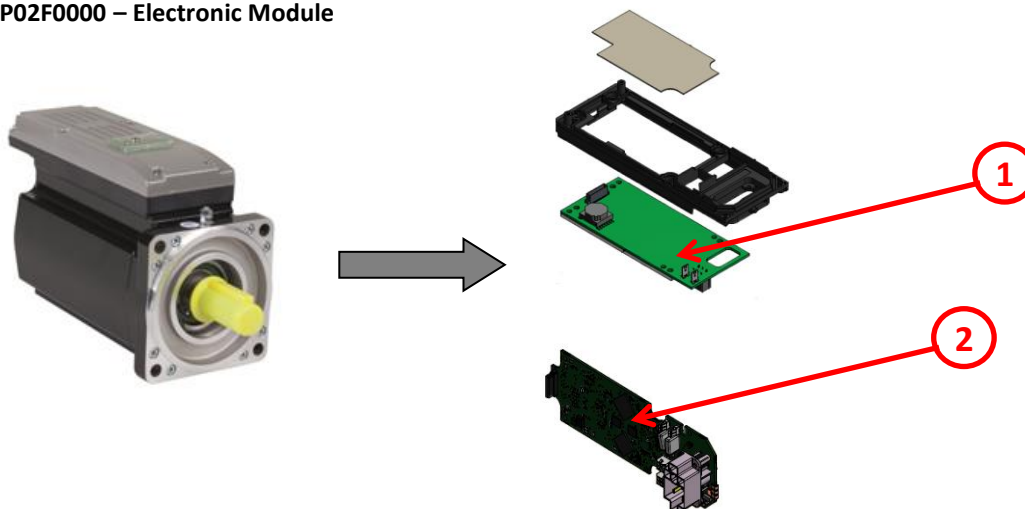

ILM62DB4A000

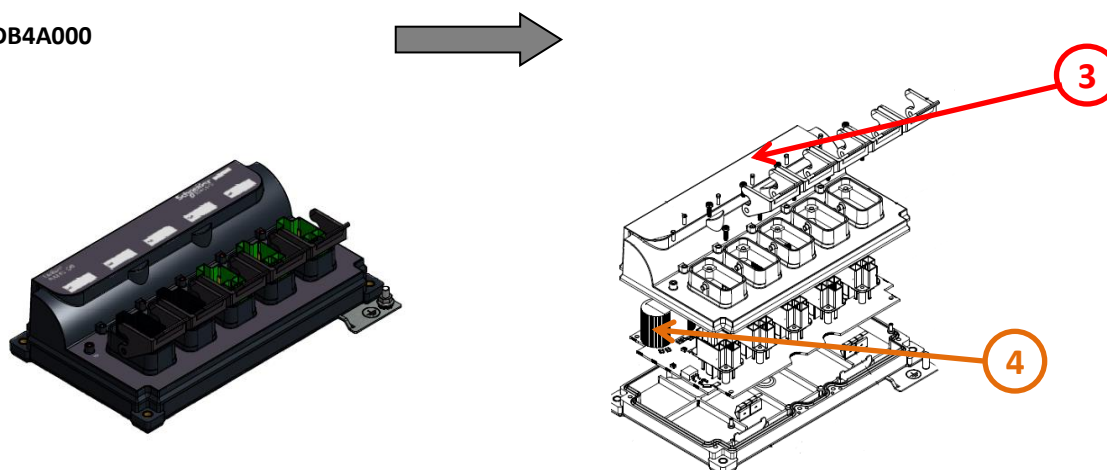

HYBRID CABLE iLM

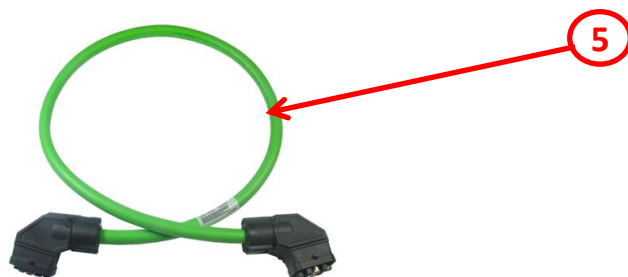

| Recommendation | Number on drawing | Component / Material | Weight (in g) | Comment |
|------------------|-------------------|---|---------------|---------|
| To be depolluted | 1 | Electronic Board (Power) > 10cm ² | 46.5 | x3 |
| To be depolluted | 2 | Electronic Board (Power) > 10cm ² | 79.2 | x3 |
| To be depolluted | 3 | Electronic Board (Power) > 10cm ² | 285 | x1 |
| To be depolluted | 4 | Electrolyte capacitors which size: height > 25 mm, diameter > 25 mm or proportionately similar volume | 19.2 | x4 |
| To be depolluted | 5 | Hybrid Cable | 483 | x3 |



Product description

| | |
|-----------------------------------|--|
| Manufacturer identification | Schneider Electric Industries SAS |
| Brand name | Schneider Electric |
| Product function | Delta 3 robot, P4, 3-5 axis, 15 kg permissible load, 0-1200 mm, non rotational, Standard |
| Product reference | VRKP4L0FNO00000 |
| Total representative product mass | 105 kg |
| Date of information release | 11/2020 |



Additional information

| | | |
|-------------------------|--|---|
| Legal information | This product family is in the scope of European Union directive 2012/19/EU on Waste Electrical and Electronic Equipment (WEEE). The product family must be disposed according to the legislation of the country. This document is intended for use by end of life recyclers or treatment facilities. It provides the basic information to assure an appropriate end of life treatment for the components and materials of the product. | |
| Recyclability potential | 77% | Based on "ECO'DEEE recyclability and recoverability calculation method" (version V1, 20 Sep. 2008 presented to the French Agency for Environment and Energy Management: ADEME). |

Schneider Electric Industries SAS

Country Customer Care Center
<http://www.schneider-electric.com/contact>

35, rue Joseph Monier

CS 30323

F- 92506 Rueil Malmaison Cedex

RCS Nanterre 954 503 439

Capital social 896 313 776 €

www.schneider-electric.com

ENVEOLI1602014_V2

Published by Schneider Electric

© 2020 - Schneider Electric – All rights reserved

11/2020