

Product End-of-Life Instructions

Logic Motion Controller (LMC)

Product Range

Logic Motion Controller LMC078 to LMC216 C

Marketing Model

LMC078CECS20T, LMC100CAA10000, LMC101CAA100000, LMC101CAA150RC, LMC106CAA10000,
LMC201CAA10000, LMC201CAA150RC, LMC201CAA170RC, LMC212CAA10000, LMC216CAA10000

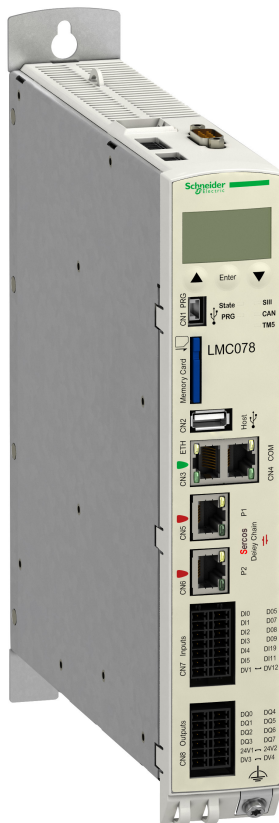

Size in

H x L x D : 222 x 270 x 44

Weight (including packaging) in g:

1975

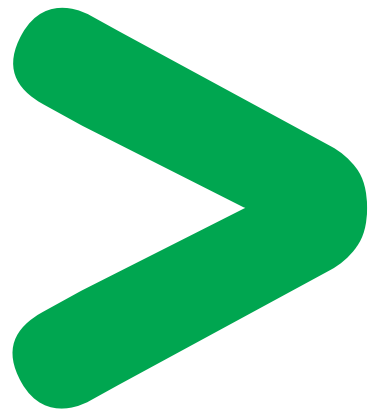

Operations recommended for the end of life treatment

There are several steps to process the products at the end of life so as to recover components, materials or energy :

Reuse ⇒ Separation for special treatment ⇒ Other Dismantling ⇒ Shredding

The components of the products that optimize the recycling performances are listed, identified and located hereunder.

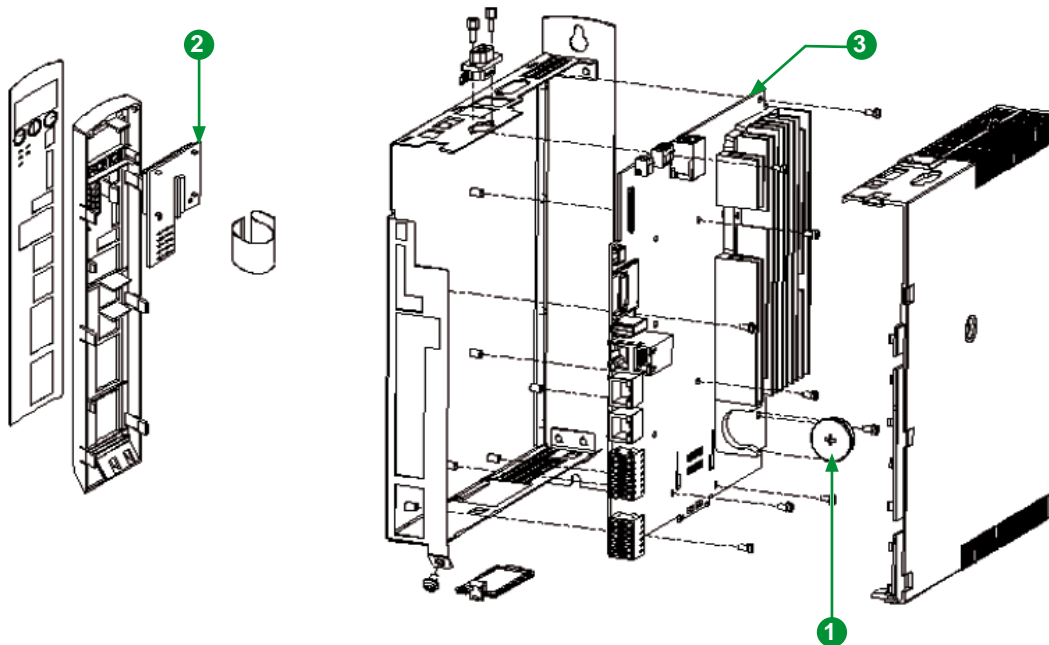

Recommendation	Number on drawing	Components	Weight (g)	Comment
Depollution	1	Battery	2.6	Electrical shock
	2	Printed Circuit Board Assembly (PCBA)	30	–
	3	Printed Circuit Board Assembly (PCBA)	308	–

Schneider Electric Industries SAS

35, rue Joseph Monier
CS30323
F - 92506 Rueil Malmaison Cedex

RCS Nanterre 954 503 439
Capital social 896 313 776 €
www.schneider-electric.com

The version of the Guide used to create the document: End of Life Instruction Drafting Guide of Schneider Electric version V1.

Publication : Schneider Electric