

SECTION A-A

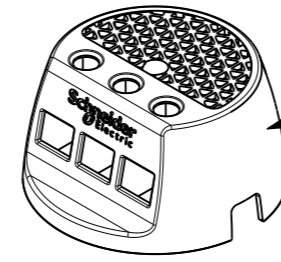

Terminal Cover

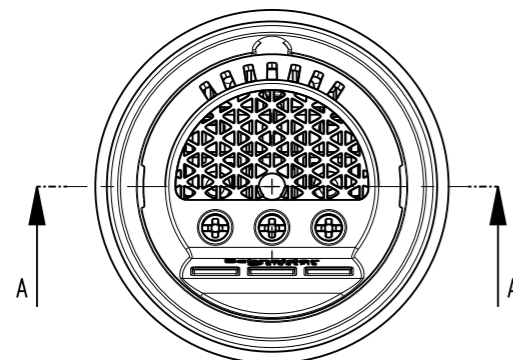
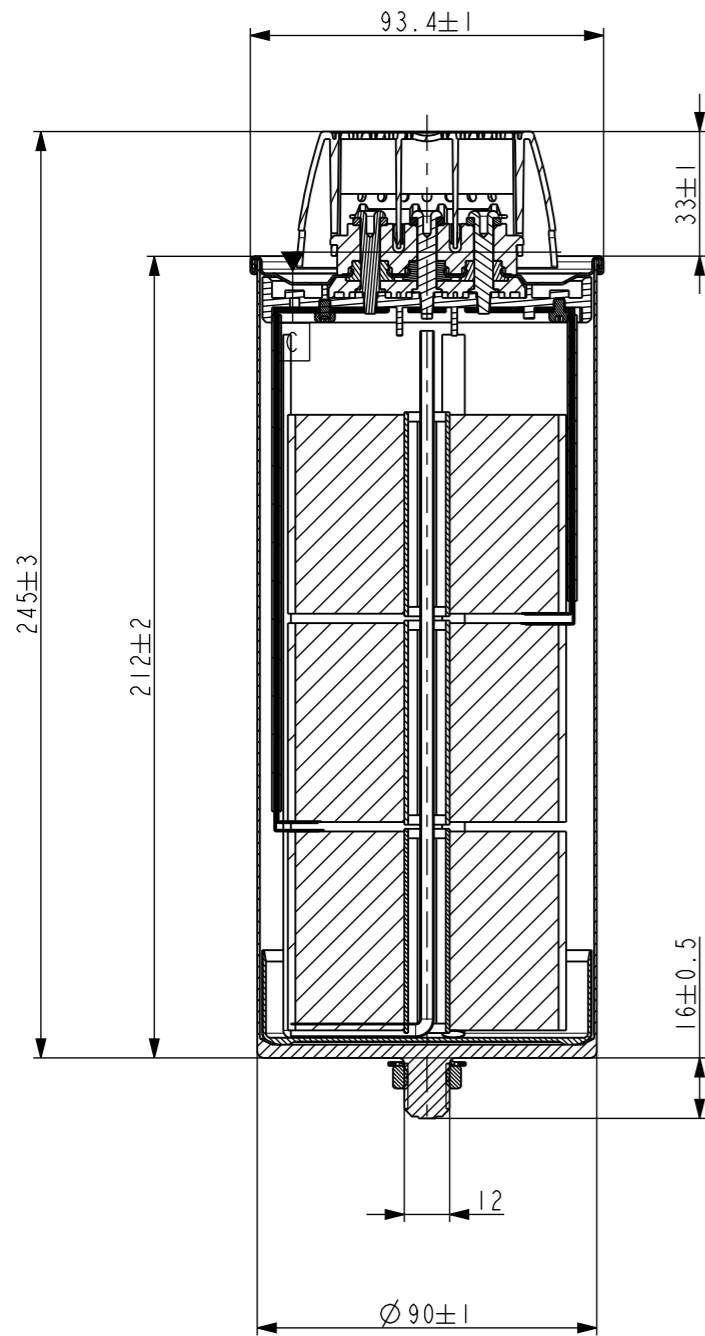

Resistor Assembly

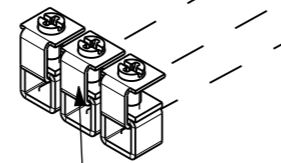

Box Clamp Assembly

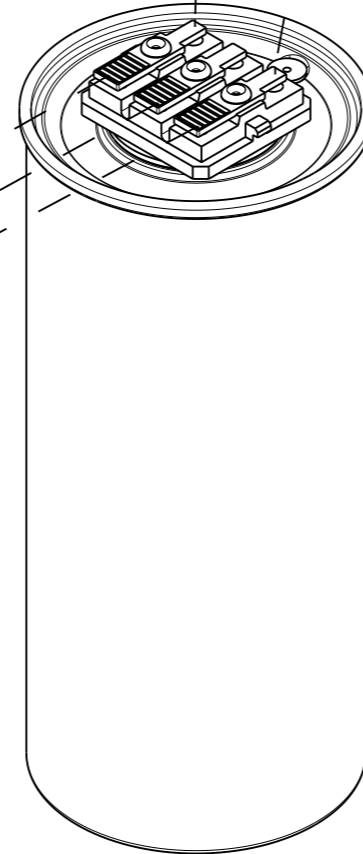

Cell Assembly



Tooth Washer



M12 Hex Nut

Creepage Distance 13mm  
 Clearance 13mm  
 Expansion (A) Max. 12mm  
 Mounting Details  
 (For M12 mounting stud)  
 Torque - 10 Nm  
 Tooth Washer M12  
 Hex Nut M12  
 Terminal screw M5  
 Terminal Assembly T = 33mm

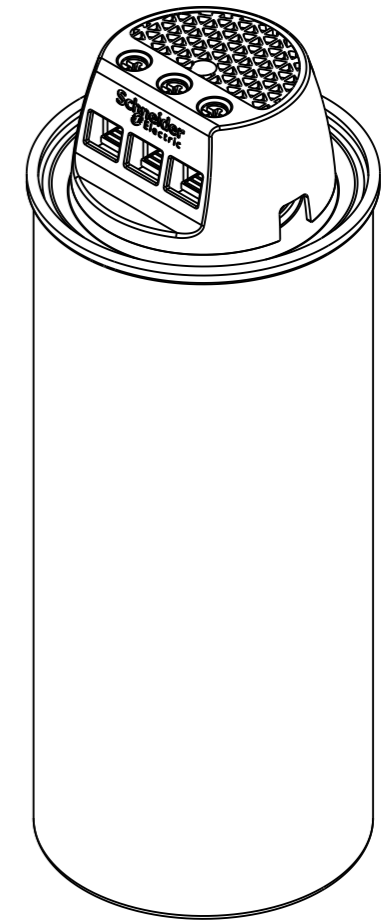

	Scale: 0.50 Tolerancing Standard :	Units of measure : millimeter
	CLAMPTITE - CAN 90X212 CLAMPTITE - CAN 90X212 Number:	HRB8566300 Revision: 01 Sheet: 1/1
The information is highly confidential and is the exclusive property of Schneider Electric copyright reserved. This drawing must not be used for any purpose other than that expressly permitted in writing by the owners and must not be disclosed or reproduced in any way without permission from the owners in writing. This drawing must be returned to the owners when the purpose has ceased.		State: Released for Manufacturing Printed on 2017/09/29