

CATALOG NUMBER	
INDOOR	OUTDOOR
SA26PS	SA26PSR

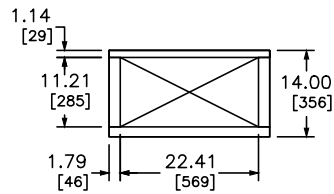
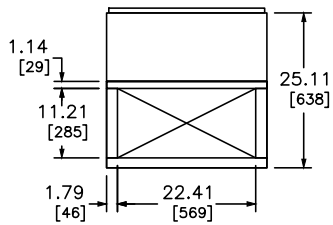
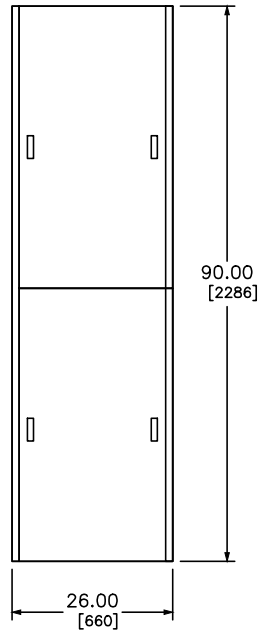
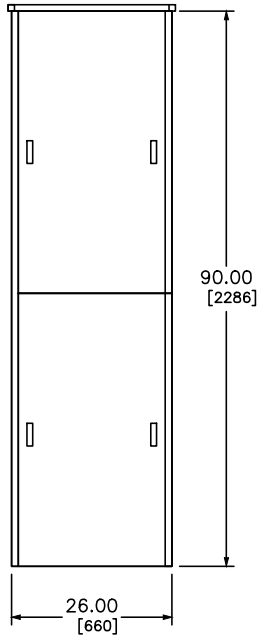

TYPE 3R ENCLOSURE

TYPE 1 ENCLOSURE

SPECIFICATIONS:

- 1: UNDERGROUND PULL SECTION IS PROVIDED FOR BOTTOM ENTRY OF INCOMING CABLES AND/OR TERMINATION OF UNDERGROUND UTILITY CABLES. UNDERGROUND PULL SECTION CAN BE PROVIDED WITH OR WITHOUT A EUSERC APPROVED LUG LANDING. WHEN PROVIDED WITH A LUG LANDING, MAXIMUM AMPACITY IS 800 AMPS.
- 2: UNDERGROUND PULL SECTION IS THE SAME DEPTH AS SERVICE SECTION AND CAN BE PLACED ON THE RIGHT OR LEFT HAND SIDE OF THE SERVICE SECTION.
- 3: FINISH: ANSI #49 GRAY ENAMEL. BAKED ENAMEL OVER CLEANED AND PHOSPHATED GALVANEALD STEEL.

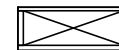

INDICATES RECOMMENDED
CONDUIT AREA

TYPE 1 & 3R UNDERGROUND PULL SECTION
SPEED D SWITCHBOARD
ELEVATION



DWG# SPEED-D10
NO.