

A B C D E F G H

REVISIONS				
ZONE	REV.	DESCRIPTION	DATE	APPROVED
	01	RELEASED TO PRODUCTION	17 SEPT 2014	W STEWART

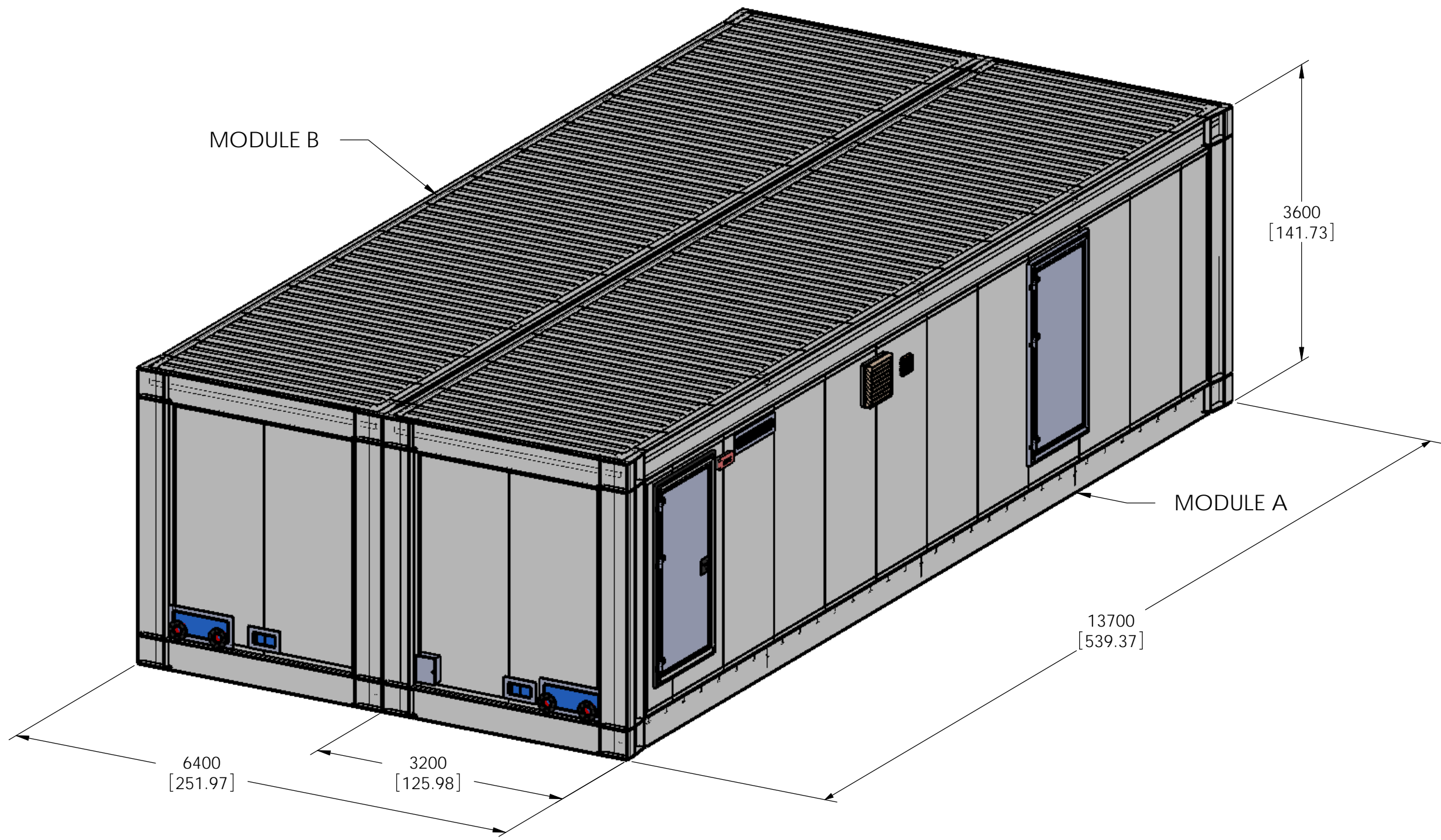

- NOTES
1. ALL DATA CABLE POWER CABLE, COOLING PIPING AND COOLING POWER INTERFACES ARE THROUGH ROXTEC CABLE ENTRY SEALS
  2. CHILLED WATER CONNECTIONS ARE PROVIDED ON BOTH ENDS OF EACH MODULE. MODULES MAY BE CONNECTED TO COMMON HEADER ON ONE OR BOTH ENDS BASED ON TIER REQUIREMENT

THIS DRAWING AND SPECIFICATIONS HEREIN ARE THE PROPERTY OF SCHNEIDER ELECTRIC AND SHALL NOT BE COPIED, REPRODUCED OR USED IN WHOLE OR IN PART, AS THE BASIS FOR THE MANUFACTURE OR SALE OF ITEMS WITHOUT WRITTEN PERMISSION FROM SCHNEIDER ELECTRIC. THIS DRAWING IS BASED UPON LATEST AVAILABLE INFORMATION AND IS SUBJECT TO CHANGE WITHOUT NOTICE.

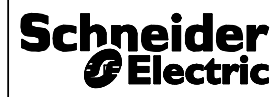

TITLE:	240KW CW NAM WITH MODULAR PDU		DWG NO.	PFMIEA240C1N22A	REV	01
PROJECT:	PRE-FABRICATED SOLUTIONS	SHEET 1 OF 11	ENGINEER:	W STEWART	5 SEPT 2014	SIZE
			DRAWN:	K SCHALLER	5 SEPT 2014	B
			APPROVED:	W STEWART	5 SEPT 2014	

A B C D E F G H

A B C D E F G H

1

2

3

4

1

2

3

4

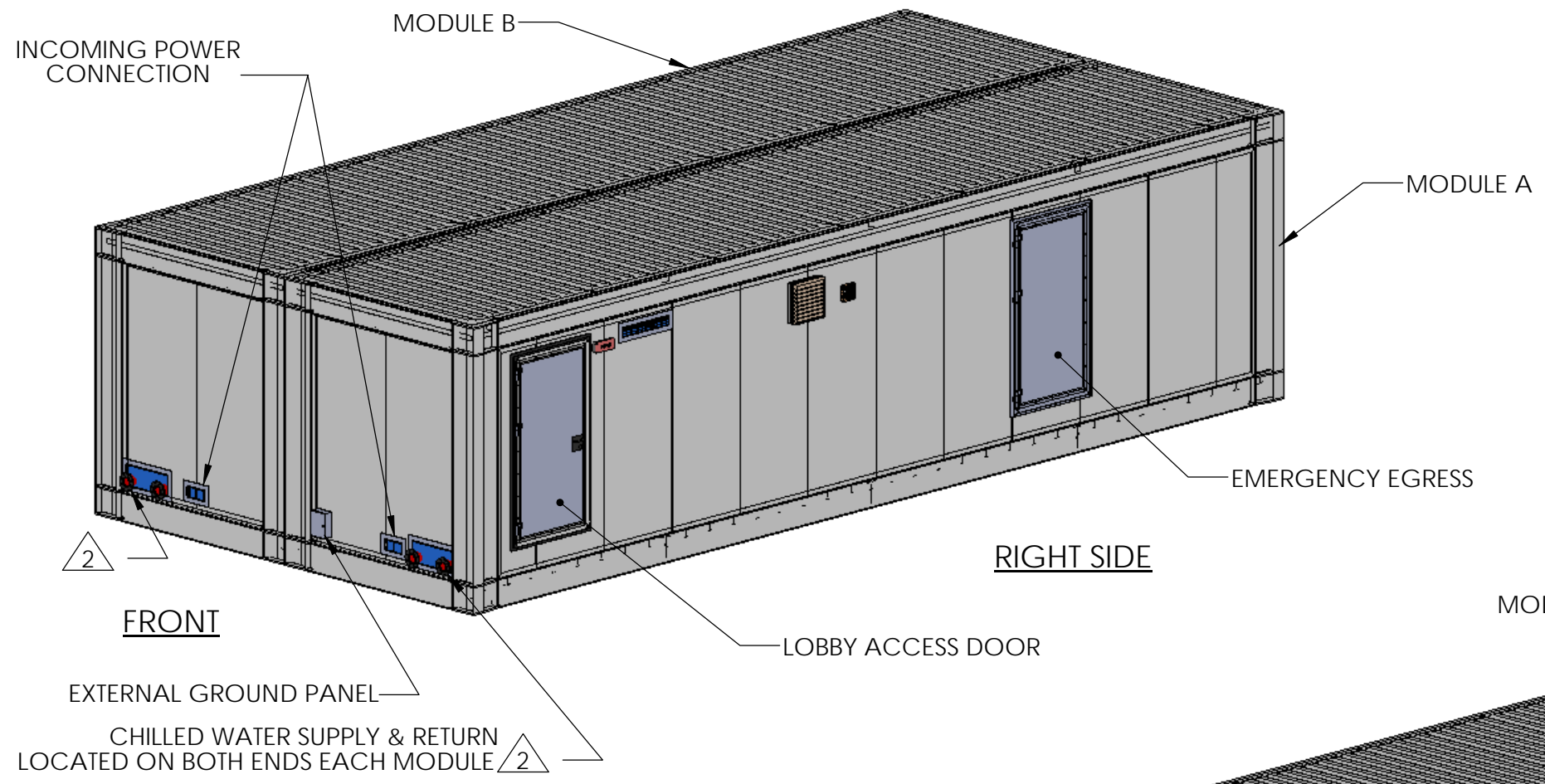

RIGHT SIDE

LOBBY ACCESS DOOR

FRONT

EXTERNAL GROUND PANEL

CHILLED WATER SUPPLY & RETURN LOCATED ON BOTH ENDS EACH MODULE

MODULE A MODULE B

AIR RENOVATION SYSTEM (FIELD MOUNTED)

REAR

2X UTILITY WATER SUPPLY & DRAIN

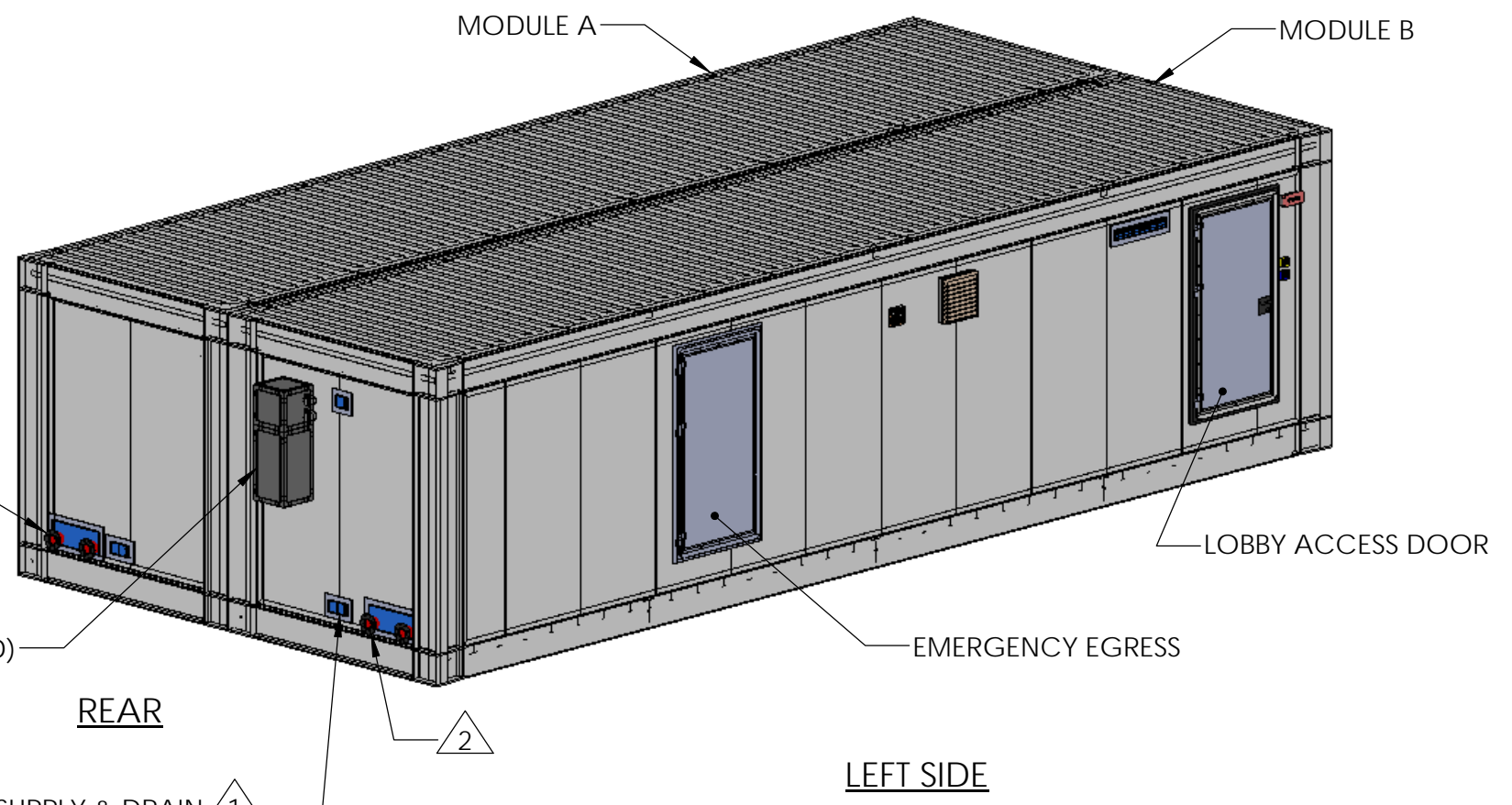

LEFT SIDE

LOBBY ACCESS DOOR

EMERGENCY EGRESS

THIS DRAWING AND SPECIFICATIONS HEREIN ARE THE PROPERTY OF SCHNEIDER ELECTRIC AND SHALL NOT BE COPIED, REPRODUCED OR USED IN WHOLE OR IN PART, AS THE BASIS FOR THE MANUFACTURE OR SALE OF ITEMS WITHOUT WRITTEN PERMISSION FROM SCHNEIDER ELECTRIC. THIS DRAWING IS BASED UPON LATEST AVAILABLE INFORMATION AND IS SUBJECT TO CHANGE WITHOUT NOTICE.

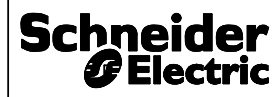

TITLE: 240KW CW NAM WITH MODULAR PDU  
 PROJECT: PRE-FABRICATED SOLUTIONS SHEET 2 OF 11

DWG NO.	PFMIEA240C1N22A		REV	01
ENGINEER:	W STEWART	5 SEPT 2014	SIZE	B
DRAWN:	K SCHALLER	5 SEPT 2014		
APPROVED:	W STEWART	5 SEPT 2014		

A B C D E F G H

A B C D E F G H

1  
2  
3  
4

1  
2  
3  
4

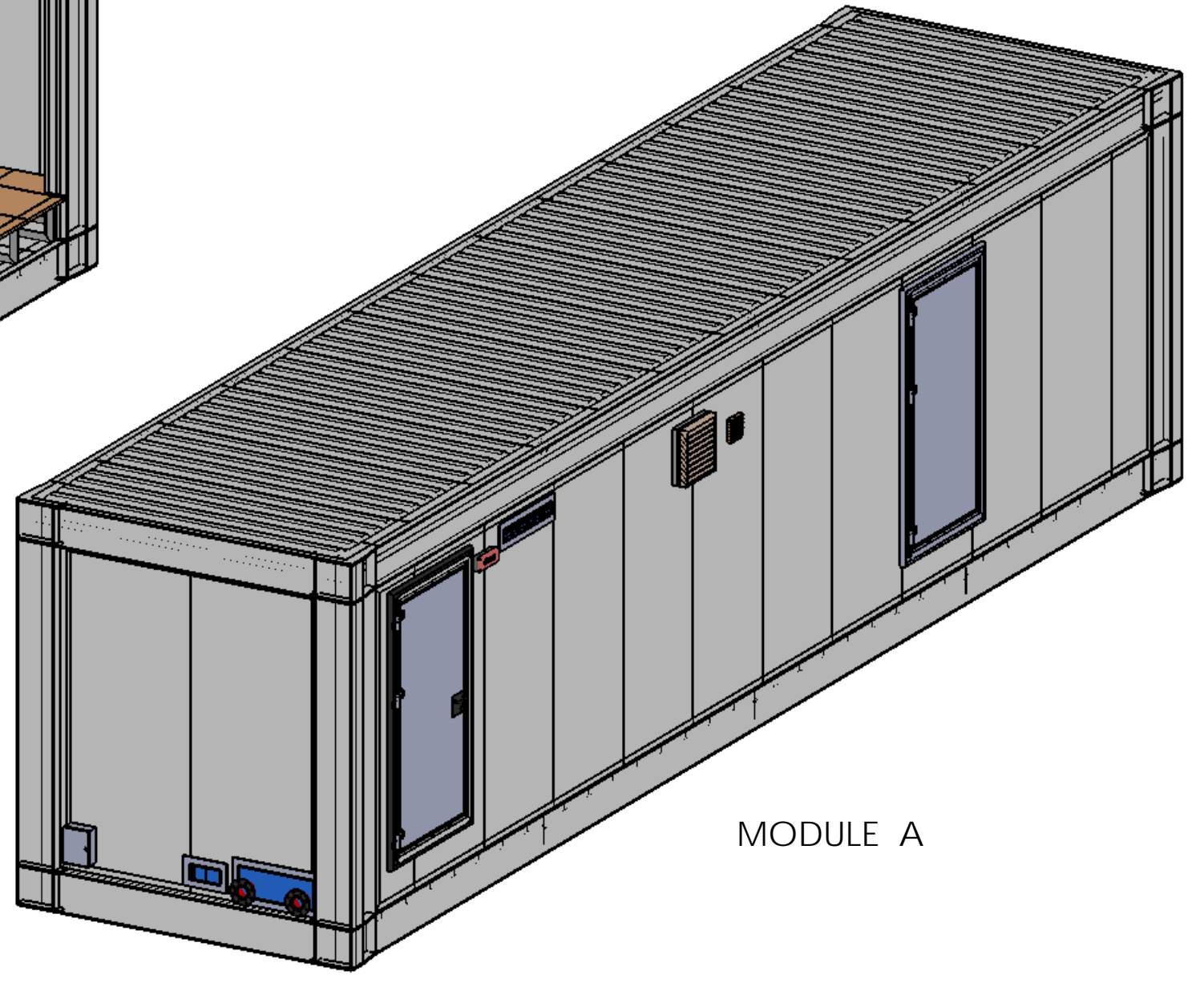
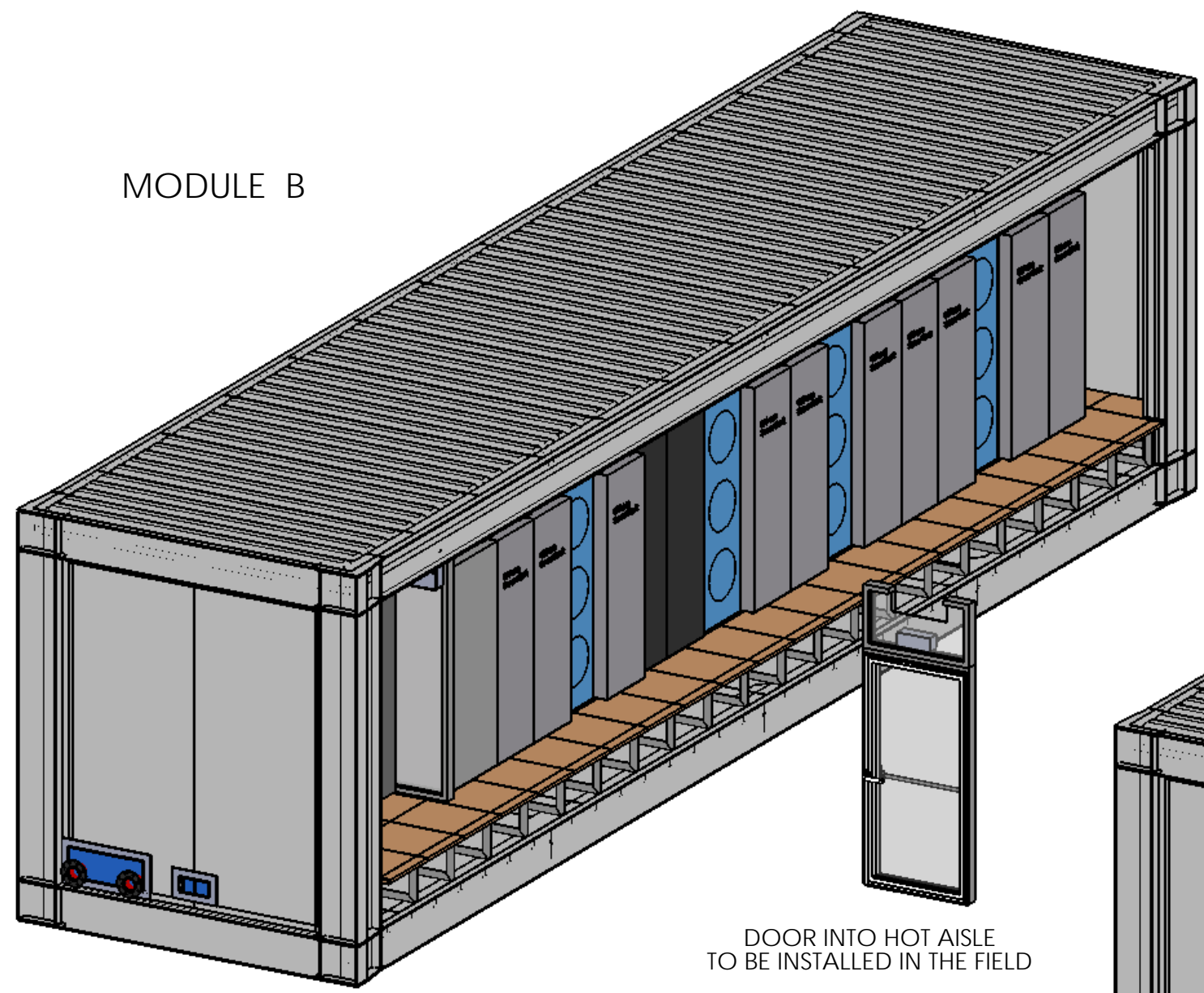

DOOR INTO HOT AISLE  
TO BE INSTALLED IN THE FIELD

DATA CENTER TO BE BUILT AS TWO DISCRETE  
MODULES AND JOINED ON SITE

A B C D E F G H

THIS DRAWING AND SPECIFICATIONS HEREIN ARE THE PROPERTY OF SCHNEIDER ELECTRIC AND SHALL NOT BE COPIED, REPRODUCED OR USED IN WHOLE OR IN PART, AS THE BASIS FOR THE MANUFACTURE OR SALE OF ITEMS WITHOUT WRITTEN PERMISSION FROM SCHNEIDER ELECTRIC. THIS DRAWING IS BASED UPON LATEST AVAILABLE INFORMATION AND IS SUBJECT TO CHANGE WITHOUT NOTICE.

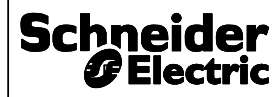

TITLE: 240KW CW NAM WITH MODULAR PDU

DWG NO.	PFMIEA240C1N22A		REV	01
ENGINEER:	W STEWART	5 SEPT 2014	SIZE	B
DRAWN:	K SCHALLER	5 SEPT 2014		
APPROVED:	W STEWART	5 SEPT 2014		

PROJECT: PRE-FABRICATED SOLUTIONS SHEET 3 OF 11

A B C D E F G H

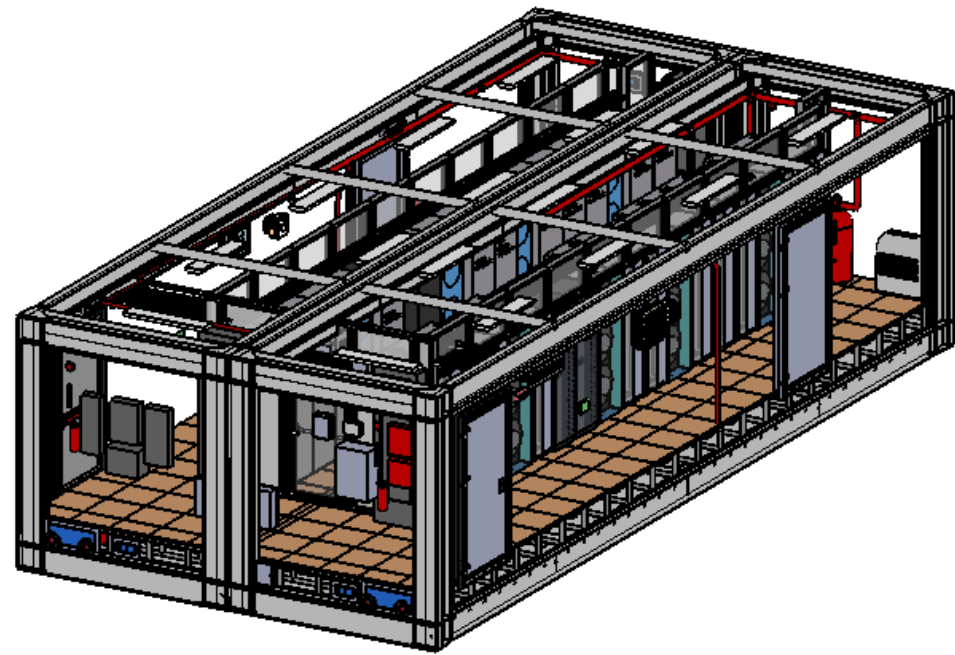

INTERIOR OF ASSEMBLED MODULE  
SIDES REMOVED FOR CLARITY

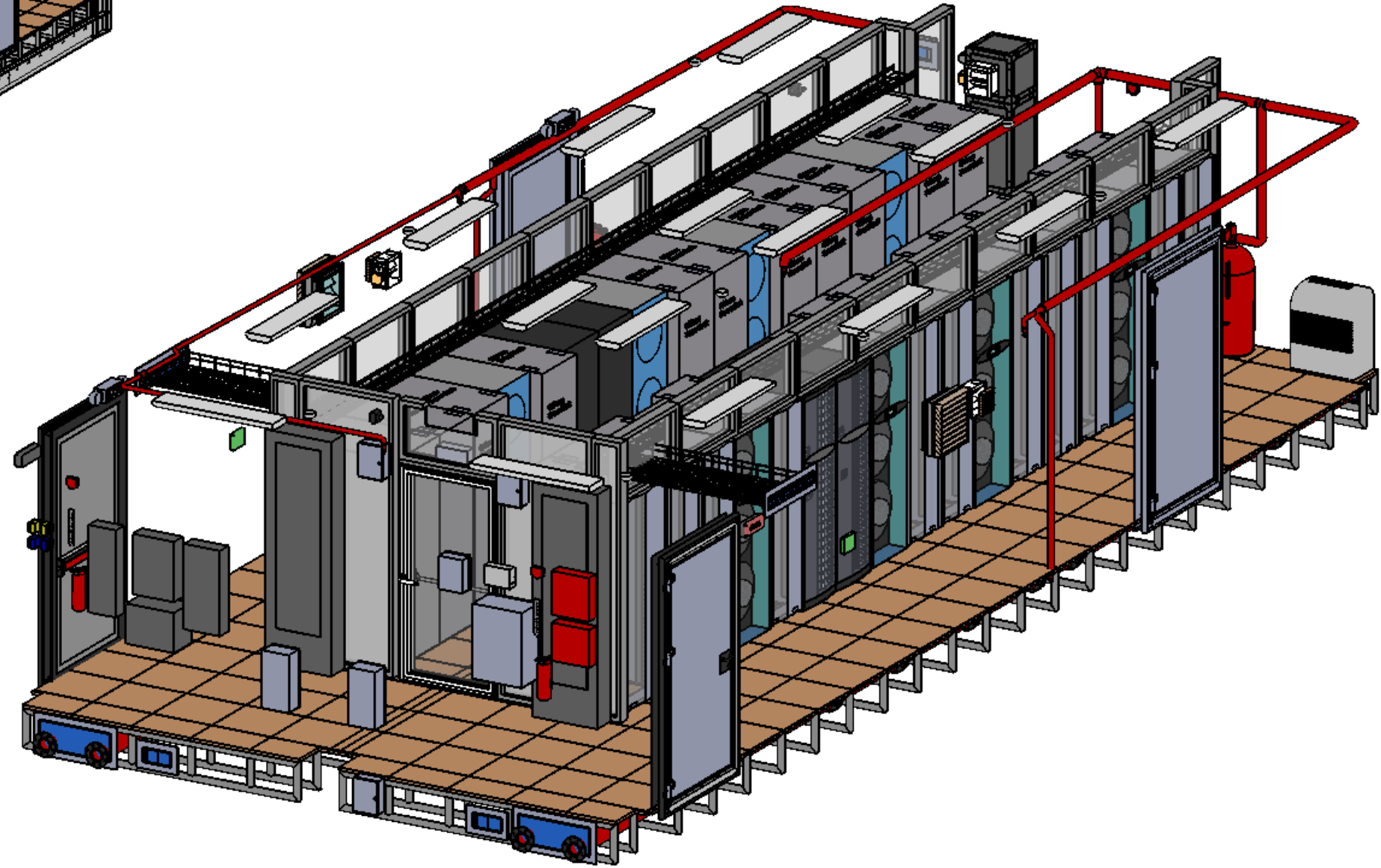

STRUCTURE REMOVED FOR CLARITY

THIS DRAWING AND SPECIFICATIONS HEREIN ARE THE PROPERTY OF SCHNEIDER ELECTRIC AND SHALL NOT BE COPIED, REPRODUCED OR USED IN WHOLE OR IN PART, AS THE BASIS FOR THE MANUFACTURE OR SALE OF ITEMS WITHOUT WRITTEN PERMISSION FROM SCHNEIDER ELECTRIC. THIS DRAWING IS BASED UPON LATEST AVAILABLE INFORMATION AND IS SUBJECT TO CHANGE WITHOUT NOTICE.



TITLE: 240kW CW NAM WITH MODULAR PDU

PROJECT: PRE-FABRICATED SOLUTIONS SHEET 4 OF 11

DWG NO.	PFMIEA240C1N22A		REV	01
ENGINEER:	W STEWART	5 SEPT 2014	SIZE	B
DRAWN:	K SCHALLER	5 SEPT 2014		
APPROVED:	W STEWART	5 SEPT 2014		

A B C D E F G H

1  
2  
3  
4

1  
2  
3  
4

A B C D E F G H

1

2

3

4

1

2

3

4

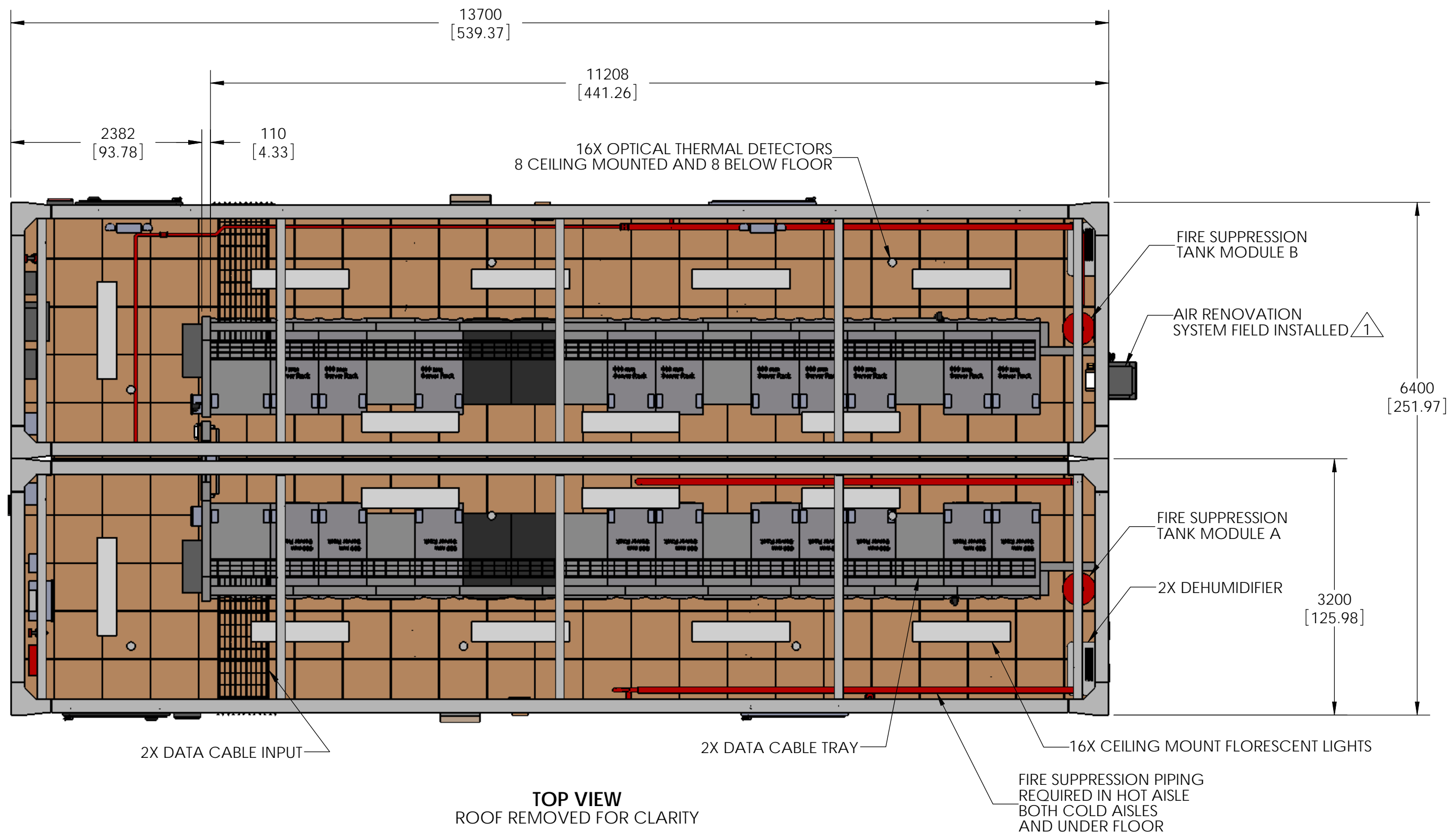

**TOP VIEW**  
ROOF REMOVED FOR CLARITY

THIS DRAWING AND SPECIFICATIONS HEREIN ARE THE PROPERTY OF SCHNEIDER ELECTRIC AND SHALL NOT BE COPIED, REPRODUCED OR USED IN WHOLE OR IN PART, AS THE BASIS FOR THE MANUFACTURE OR SALE OF ITEMS WITHOUT WRITTEN PERMISSION FROM SCHNEIDER ELECTRIC. THIS DRAWING IS BASED UPON LATEST AVAILABLE INFORMATION AND IS SUBJECT TO CHANGE WITHOUT NOTICE.

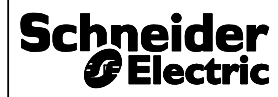

TITLE:	240KW CW NAM WITH MODULAR PDU		DWG NO.	PFMIEA240C1N22A	REV	01
PROJECT:	PRE-FABRICATED SOLUTIONS	SHEET 5 OF 11	ENGINEER:	W STEWART	5 SEPT 2014	SIZE
			DRAWN:	K SCHALLER	5 SEPT 2014	B
			APPROVED:	W STEWART	5 SEPT 2014	

A B C D E F G H

A B C D E F G H

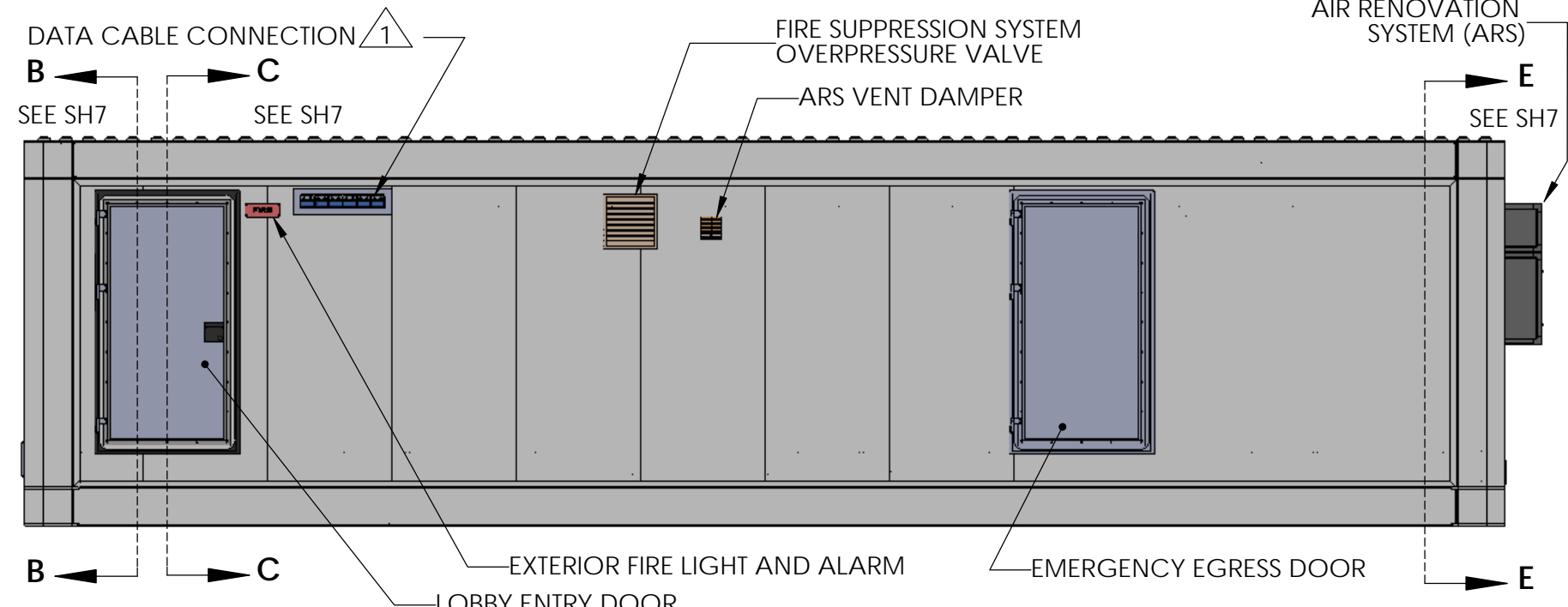
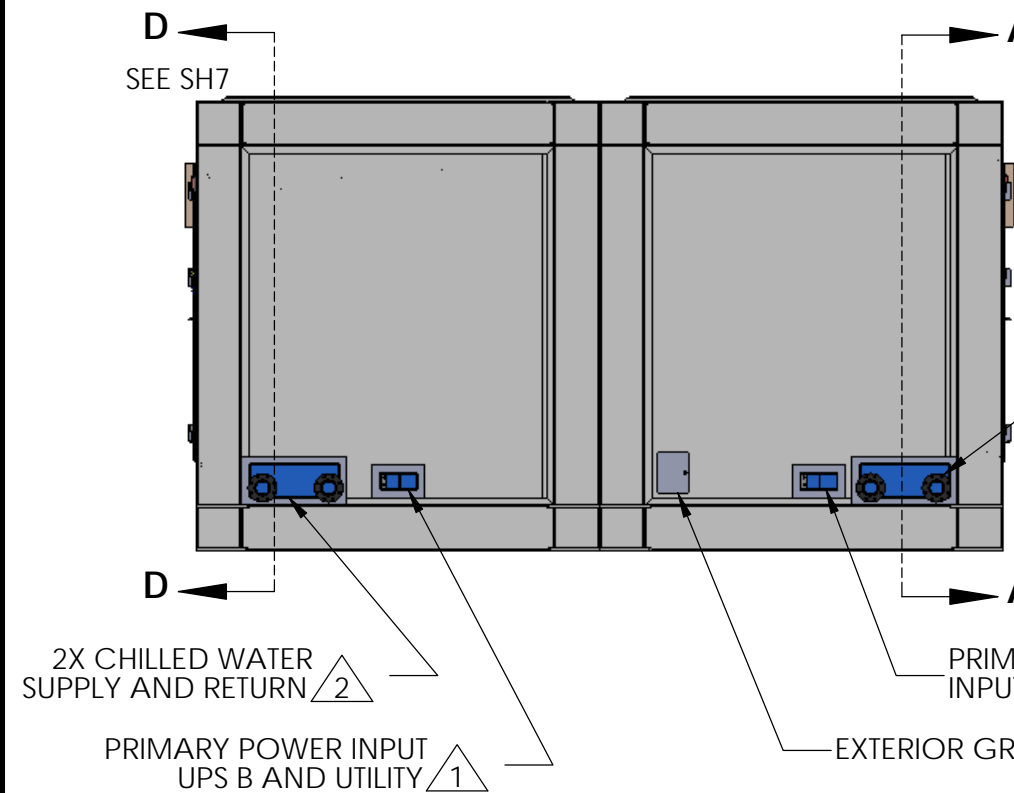

RIGHT SIDE VIEW

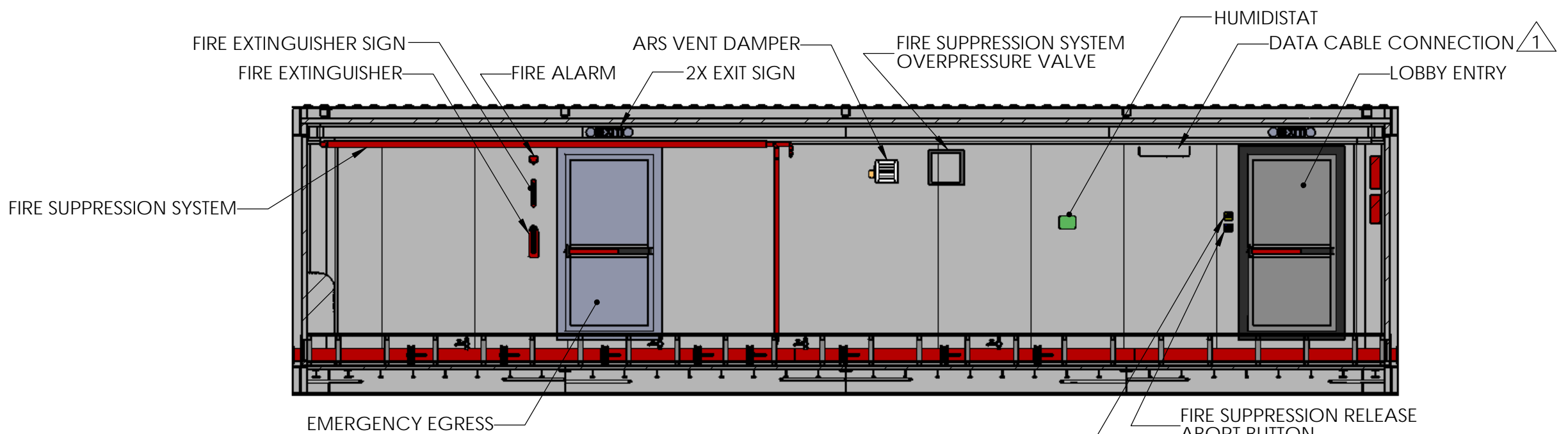

SECTION A-A  
SCALE 1 : 60  
MODULE A INTERIOR WALL

THIS DRAWING AND SPECIFICATIONS HEREIN ARE THE PROPERTY OF SCHNEIDER ELECTRIC AND SHALL NOT BE COPIED, REPRODUCED OR USED IN WHOLE OR IN PART, AS THE BASIS FOR THE MANUFACTURE OR SALE OF ITEMS WITHOUT WRITTEN PERMISSION FROM SCHNEIDER ELECTRIC. THIS DRAWING IS BASED UPON LATEST AVAILABLE INFORMATION AND IS SUBJECT TO CHANGE WITHOUT NOTICE.



TITLE: 240KW CW NAM WITH MODULAR PDU

PROJECT: PRE-FABRICATED SOLUTIONS

SHEET 6 OF 11

DWG NO.	PFMIEA240C1N22A		REV	01
ENGINEER:	W STEWART	5 SEPT 2014	SIZE	B
DRAWN:	K SCHALLER	5 SEPT 2014		
APPROVED:	W STEWART	5 SEPT 2014		

A B C D E F G H

A B C D E F G H

1

2

1

2

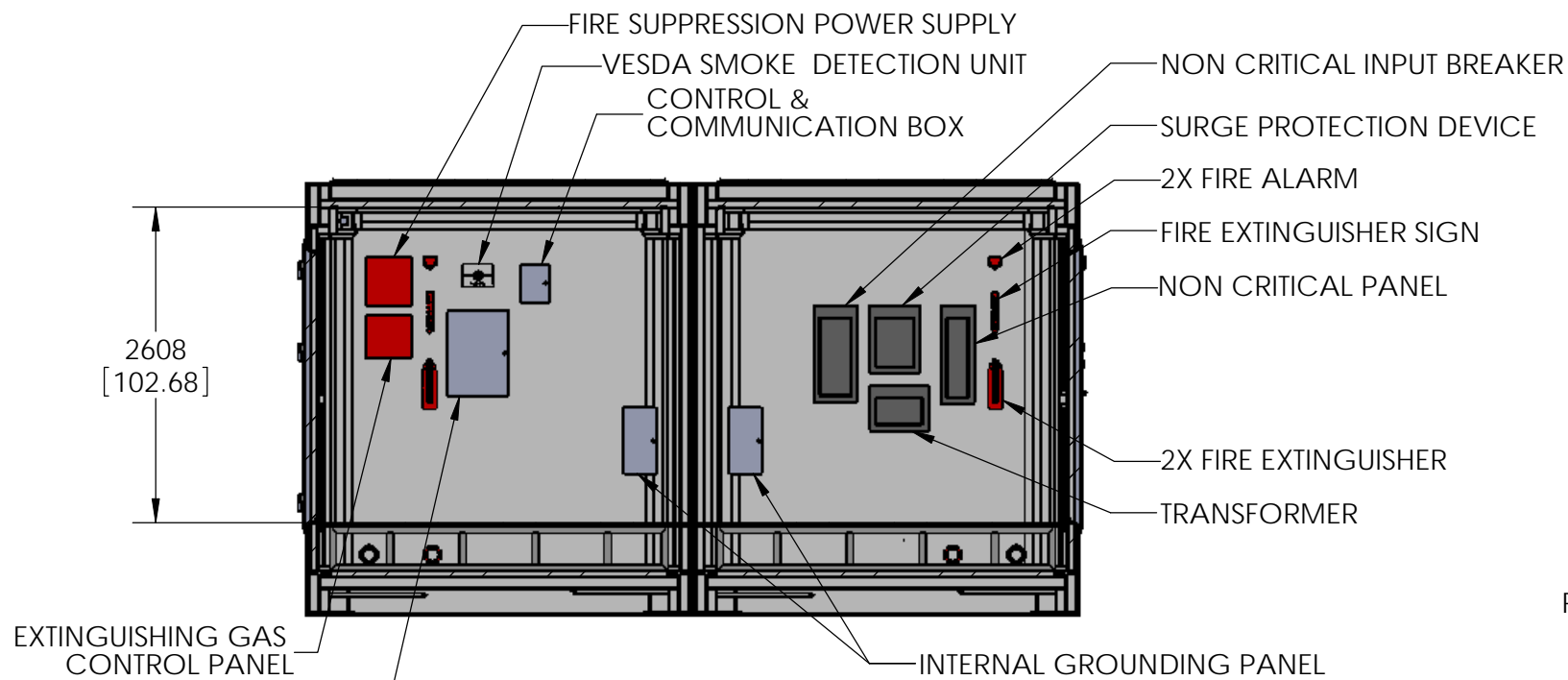

**SECTION B-B**  
SCALE 1 : 60  
SEE SHEET 6; ZONE D1

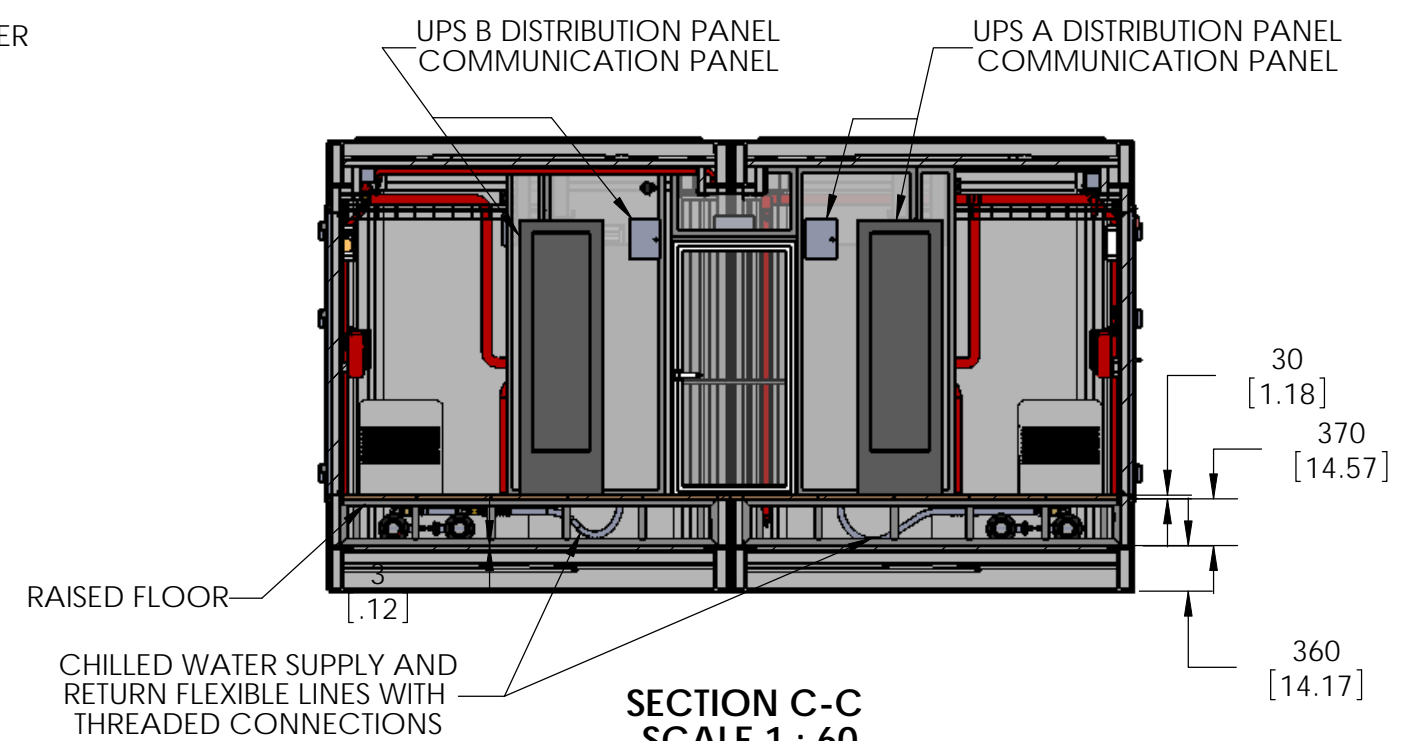

**SECTION C-C**  
SCALE 1 : 60  
SEE SHEET 6, ZONE D1

3

4

3

4

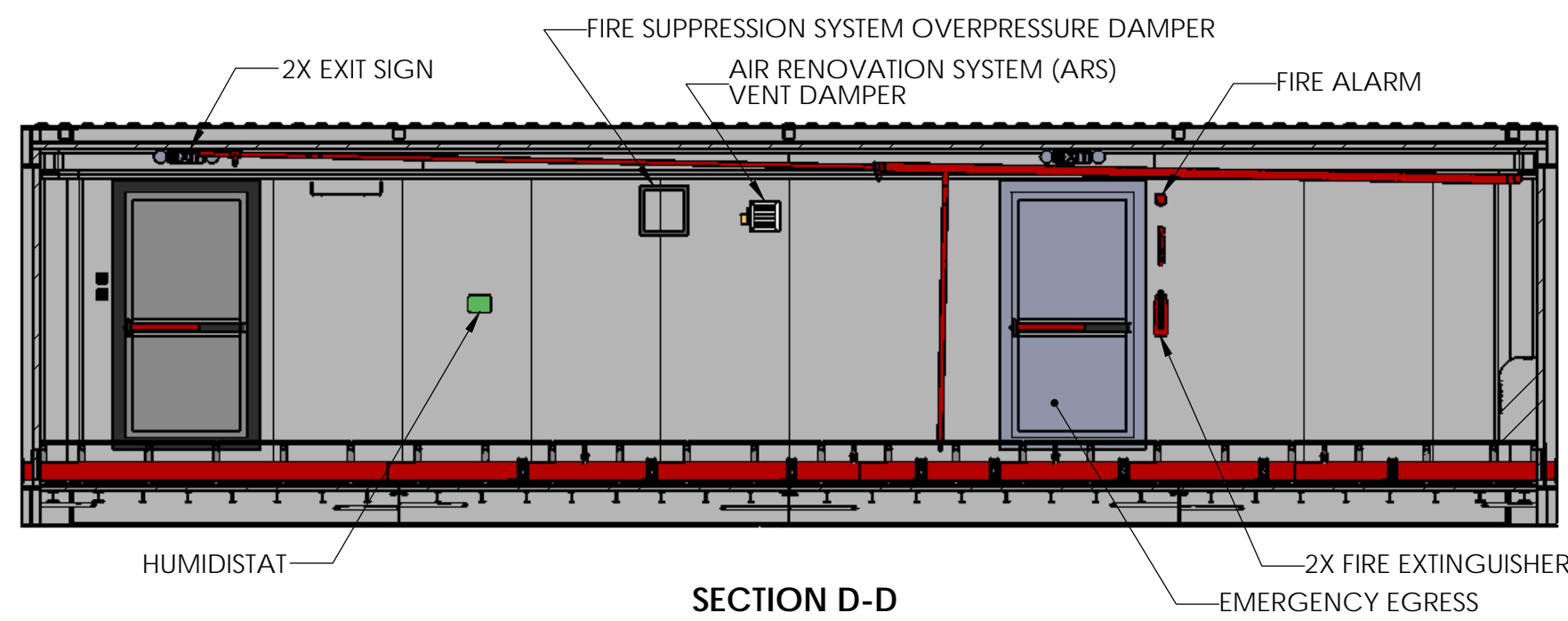

**SECTION D-D**  
SCALE 1 : 60  
MODULE B INTERIOR WALL  
SEE SHEET 6, ZONE A1

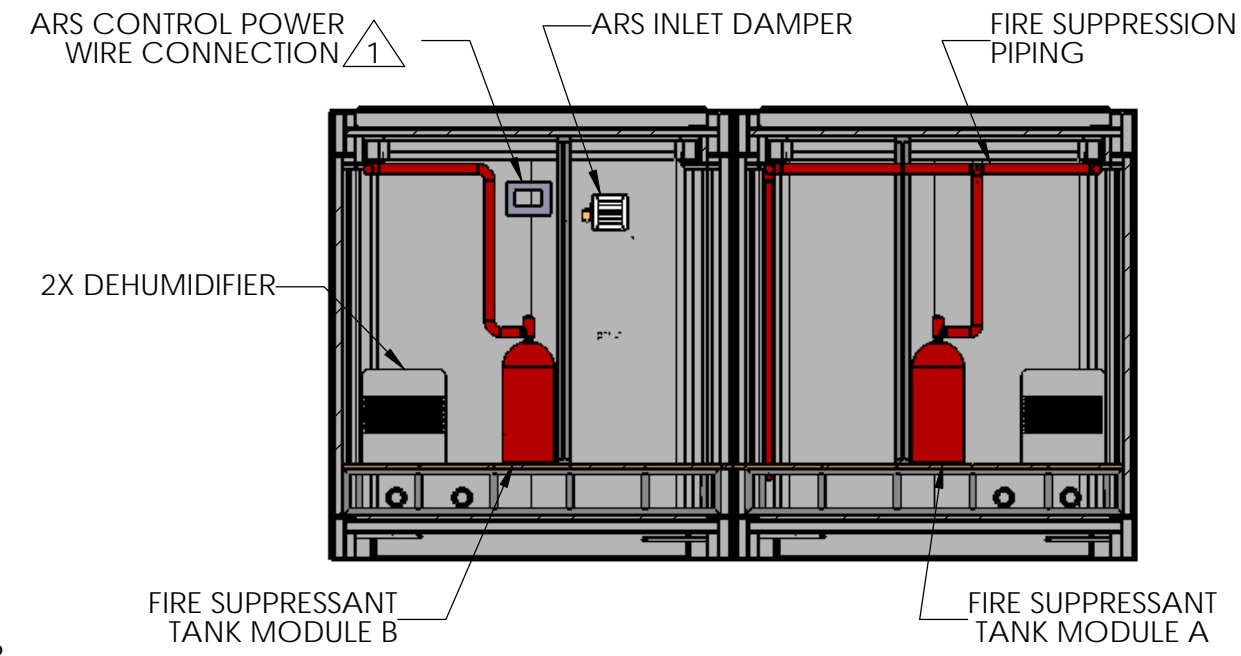

**SECTION E-E**  
SCALE 1 : 60  
SEE SHEET 6, ZONE H1

THIS DRAWING AND SPECIFICATIONS HEREIN ARE THE PROPERTY OF SCHNEIDER ELECTRIC AND SHALL NOT BE COPIED, REPRODUCED OR USED IN WHOLE OR IN PART, AS THE BASIS FOR THE MANUFACTURE OR SALE OF ITEMS WITHOUT WRITTEN PERMISSION FROM SCHNEIDER ELECTRIC. THIS DRAWING IS BASED UPON LATEST AVAILABLE INFORMATION AND IS SUBJECT TO CHANGE WITHOUT NOTICE.



TITLE: 240KW CW NAM WITH MODULAR PDU  
PROJECT: PRE-FABRICATED SOLUTIONS SHEET 7 OF 11

DWG NO.	PFMIEA240C1N22A		REV	01
ENGINEER:	W STEWART	5 SEPT 2014	SIZE	B
DRAWN:	K SCHALLER	5 SEPT 2014		
APPROVED:	W STEWART	5 SEPT 2014		

A B C D E F G H

A B C D E F G H

**MODULE A**

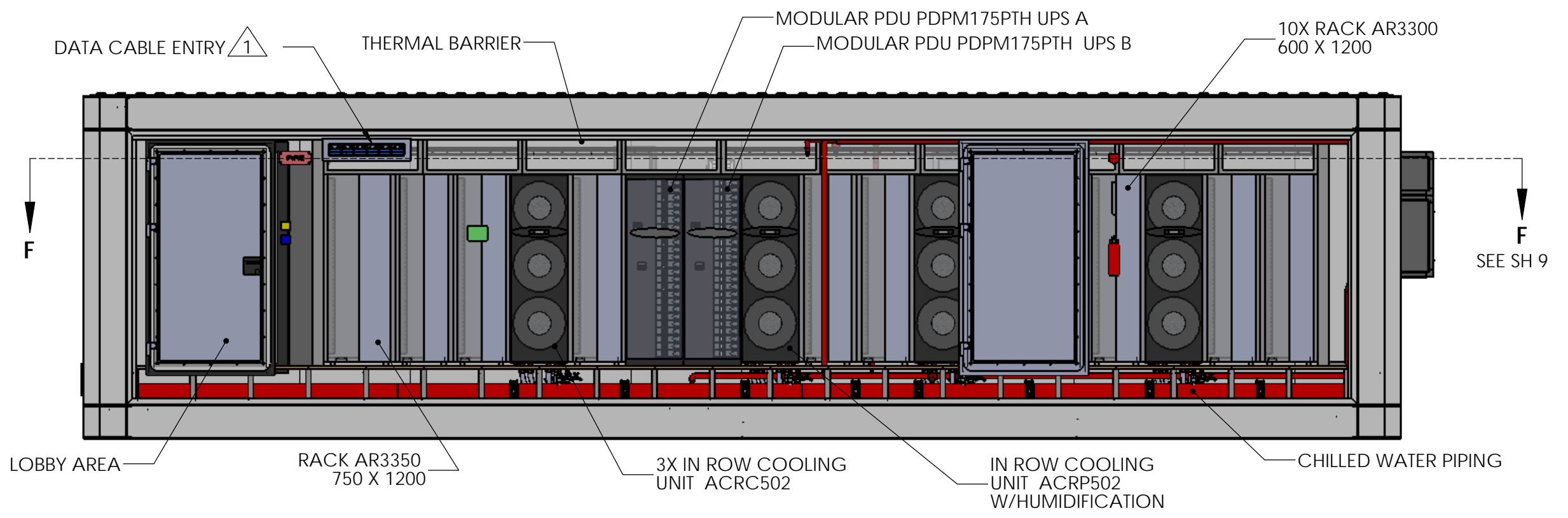

**RIGHT SIDE VIEW**  
WALLS REMOVED

**MODULE B**

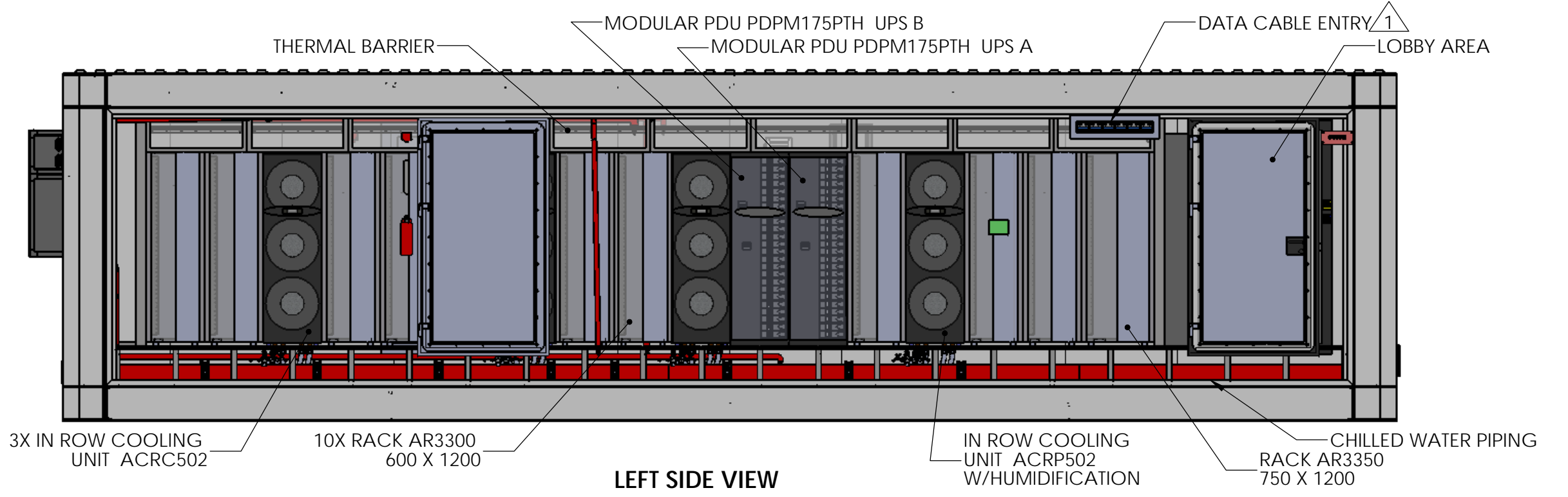

**LEFT SIDE VIEW**  
WALLS REMOVED

THIS DRAWING AND SPECIFICATIONS HEREIN ARE THE PROPERTY OF SCHNEIDER ELECTRIC AND SHALL NOT BE COPIED, REPRODUCED OR USED IN WHOLE OR IN PART, AS THE BASIS FOR THE MANUFACTURE OR SALE OF ITEMS WITHOUT WRITTEN PERMISSION FROM SCHNEIDER ELECTRIC. THIS DRAWING IS BASED UPON LATEST AVAILABLE INFORMATION AND IS SUBJECT TO CHANGE WITHOUT NOTICE.



TITLE: 240KW CW NAM WITH MODULAR PDU  
PROJECT: PRE-FABRICATED SOLUTIONS SHEET 8 OF 11

DWG NO.	PFMIEA240C1N22A		REV	01
ENGINEER:	W STEWART	5 SEPT 2014	SIZE	B
DRAWN:	K SCHALLER	5 SEPT 2014		
APPROVED:	W STEWART	5 SEPT 2014		

A B C D E F G H



A B C D E F G H

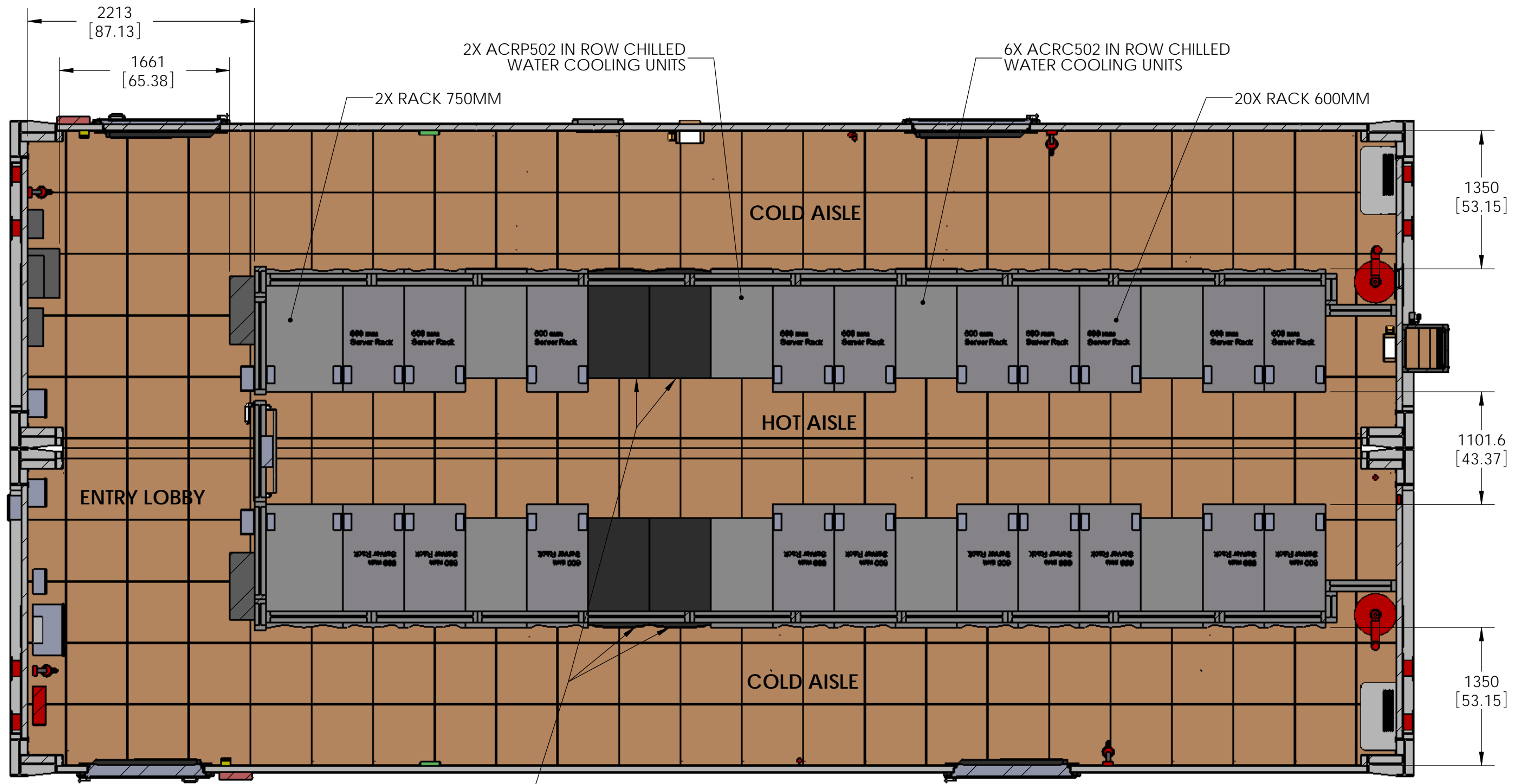

4X MODULAR UPS PDPM175PTH  
1 UPS A; 1 UPS B; EACH MODULE

**SECTION F-F**  
**SCALE 1 : 40**  
SEE SHEET 8; ZONE H1

THIS DRAWING AND SPECIFICATIONS HEREIN ARE THE PROPERTY OF SCHNEIDER ELECTRIC AND SHALL NOT BE COPIED, REPRODUCED OR USED IN WHOLE OR IN PART, AS THE BASIS FOR THE MANUFACTURE OR SALE OF ITEMS WITHOUT WRITTEN PERMISSION FROM SCHNEIDER ELECTRIC. THIS DRAWING IS BASED UPON LATEST AVAILABLE INFORMATION AND IS SUBJECT TO CHANGE WITHOUT NOTICE.



TITLE: 240KW CW NAM WITH MODULAR PDU  
PROJECT: PRE-FABRICATED SOLUTIONS SHEET 9 OF 11

DWG NO.	PFMIEA240C1N22A		REV	01
ENGINEER:	W STEWART	5 SEPT 2014	SIZE	B
DRAWN:	K SCHALLER	5 SEPT 2014		
APPROVED:	W STEWART	5 SEPT 2014		

A B C D E F G H

1  
2  
3  
4

1  
2  
3  
4

A B C D E F G H

1

2

3

4

1

2

3

4

MODULE B

FIRE SUPPRESSION LINES

FIRE SUPPRESSION TANK B

FIRE SUPPRESSION TANK A

MODULE A

FIRE SUPPRESSION CONTROLS WITH VESDA LOCATED IN MODULE A

PRIMARY ENTRY THIS END

UNDER FLOOR FIRE SUPPRESSANT DELIVERY

THIS DRAWING AND SPECIFICATIONS HEREIN ARE THE PROPERTY OF SCHNEIDER ELECTRIC AND SHALL NOT BE COPIED, REPRODUCED OR USED IN WHOLE OR IN PART, AS THE BASIS FOR THE MANUFACTURE OR SALE OF ITEMS WITHOUT WRITTEN PERMISSION FROM SCHNEIDER ELECTRIC. THIS DRAWING IS BASED UPON LATEST AVAILABLE INFORMATION AND IS SUBJECT TO CHANGE WITHOUT NOTICE.



TITLE: 240KW CW NAM WITH MODULAR PDU

DWG NO. PFMIEA240C1N22A

REV 01

ENGINEER: W STEWART 5 SEPT 2014

DRAWN: K SCHALLER 5 SEPT 2014

APPROVED: W STEWART 5 SEPT 2014

SIZE B

PROJECT: PRE-FABRICATED SOLUTIONS SHEET 10 OF 11

A B C D E F G H

A B C D E F G H

1  
2  
3  
4

1  
2  
3  
4

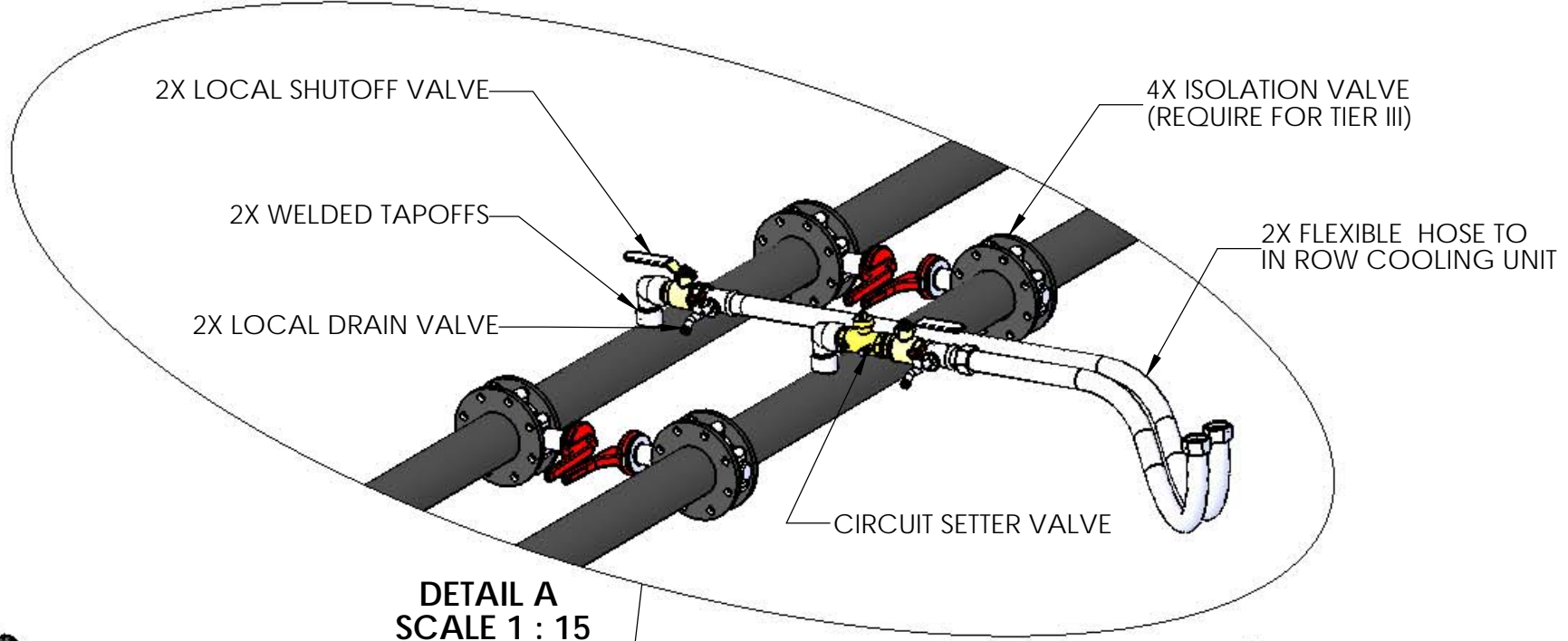

DETAIL A  
SCALE 1 : 15

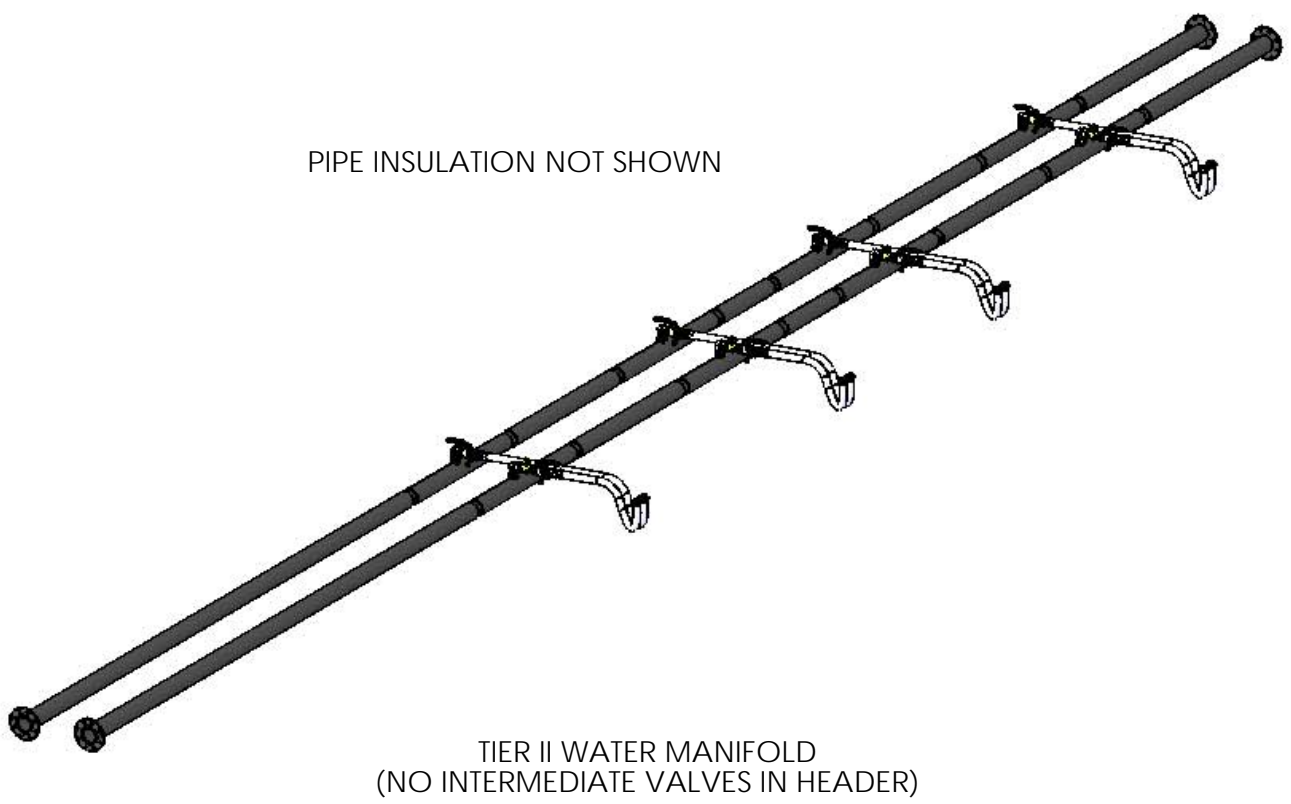

PIPE INSULATION NOT SHOWN

TIER II WATER MANIFOLD  
(NO INTERMEDIATE VALVES IN HEADER)

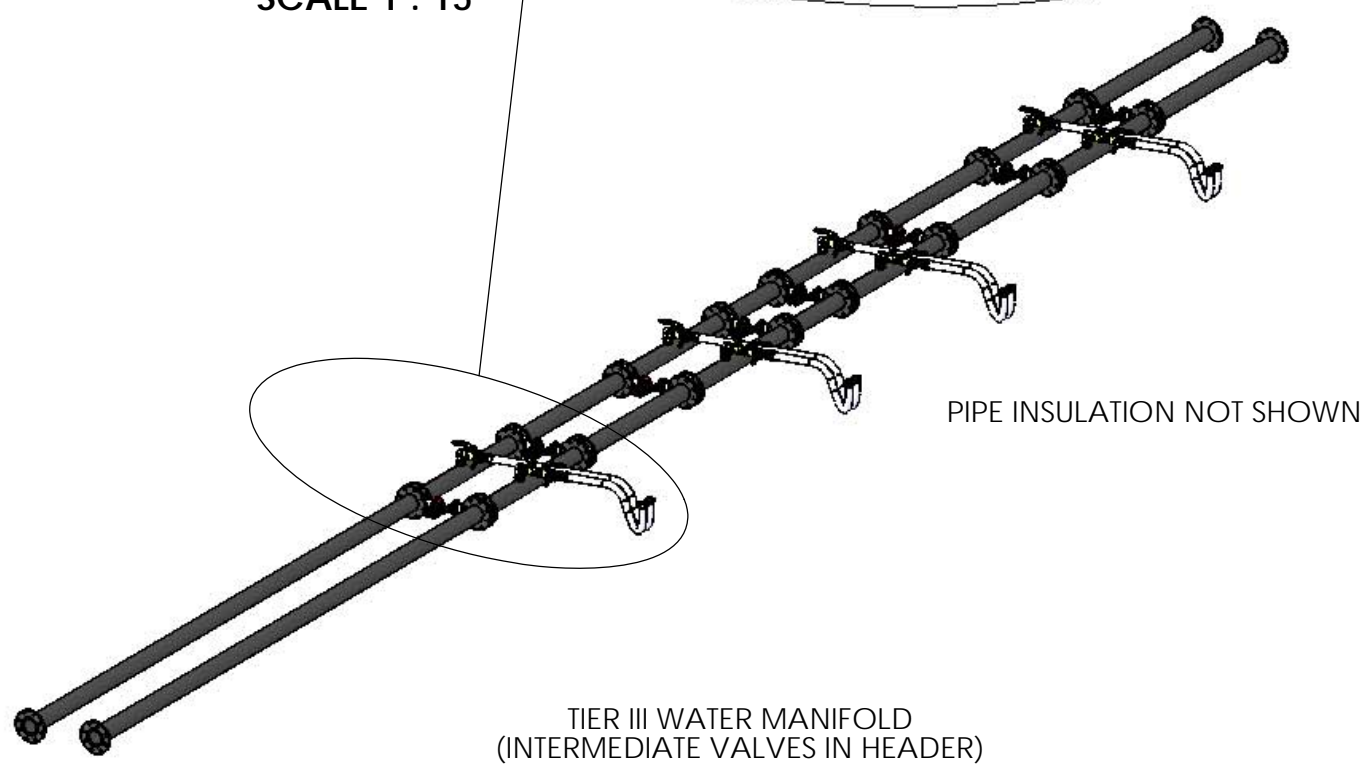

PIPE INSULATION NOT SHOWN

TIER III WATER MANIFOLD  
(INTERMEDIATE VALVES IN HEADER)

THIS DRAWING AND SPECIFICATIONS HEREIN ARE THE PROPERTY OF SCHNEIDER ELECTRIC AND SHALL NOT BE COPIED, REPRODUCED OR USED IN WHOLE OR IN PART, AS THE BASIS FOR THE MANUFACTURE OR SALE OF ITEMS WITHOUT WRITTEN PERMISSION FROM SCHNEIDER ELECTRIC. THIS DRAWING IS BASED UPON LATEST AVAILABLE INFORMATION AND IS SUBJECT TO CHANGE WITHOUT NOTICE.

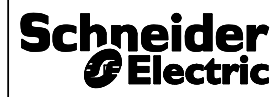

TITLE: 240KW CW NAM WITH MODULAR PDU

DWG NO. PFMIEA240C1N22A

REV 01

ENGINEER: W STEWART 5 SEPT 2014

DRAWN: K SCHALLER 5 SEPT 2014

APPROVED: W STEWART 5 SEPT 2014

PROJECT: PRE-FABRICATED SOLUTIONS

SHEET 11 OF 11

SIZE B

A B C D E F G H