

FRONT VIEW

LEFT SIDE VIEW

REAR VIEW

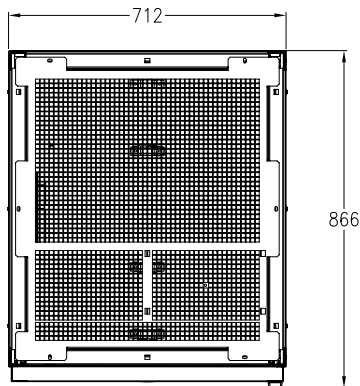

TOP VIEW

NOTES:

1. INSTALLATION MUST COMPLY ALL APPLICABLE NATIONAL AND LOCAL ELECTRICAL REGULATIONS
2. PLEASE REFER TO PRODUCT MANUAL FOR DETAILED INFORMATION.
3. ALL DIMENSIONS ARE IN MILLIMETERS. UNLESS OTHERWISE SPECIFIED.
4. CABLE ENTRY IS FROM THE BOTTOM OF THE CABINET.
5. NET WEIGHT OF THE ENCLOSURE IS 135 kg.
- △ 6. COG DETAILS.

CENTER OF GRAVITY	WITHOUT BATTERIES
X DISTANCE	356 mm
Y DISTANCE	950 mm
Z DISTANCE	360 mm

THIS DRAWING AND SPECIFICATIONS HEREIN ARE THE PROPERTY OF SCHNEIDER ELECTRIC AND SHALL NOT BE COPIED, REPRODUCED OR USED IN WHOLE OR IN PART, AS THE BASIS FOR THE MANUFACTURE OR SALE OF ITEMS WITHOUT WRITTEN PERMISSION FROM SCHNEIDER ELECTRIC. THIS DRAWING IS BASED UPON LATEST AVAILABLE INFORMATION AND IS SUBJECT TO CHANGE WITHOUT NOTICE.



TITLE:  
SYMMETRA PX ET 160  
BATTERY CABINET  
FOR THIRD-PARTY BATTERIES  
MAIN MECHANICAL

DWG NO: SYPBV96K160H REV. 0

DRAWN: C KRISHNA 18-MAR-14 FIRST ANGLE PROJECTION

ENGINEER: BIN-COMPPELL BAI 18-MAR-14

APPROVED: MATTHIEU SAAS 18-MAR-14

PROJECT: SUBMITTAL DRAWINGS SHEET 1 OF 4

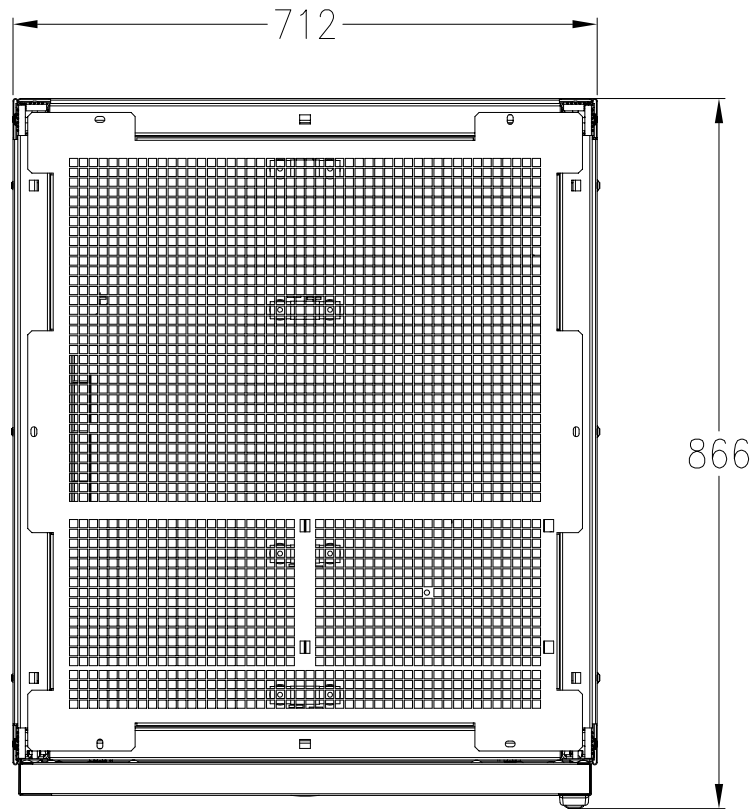

TOP VIEW

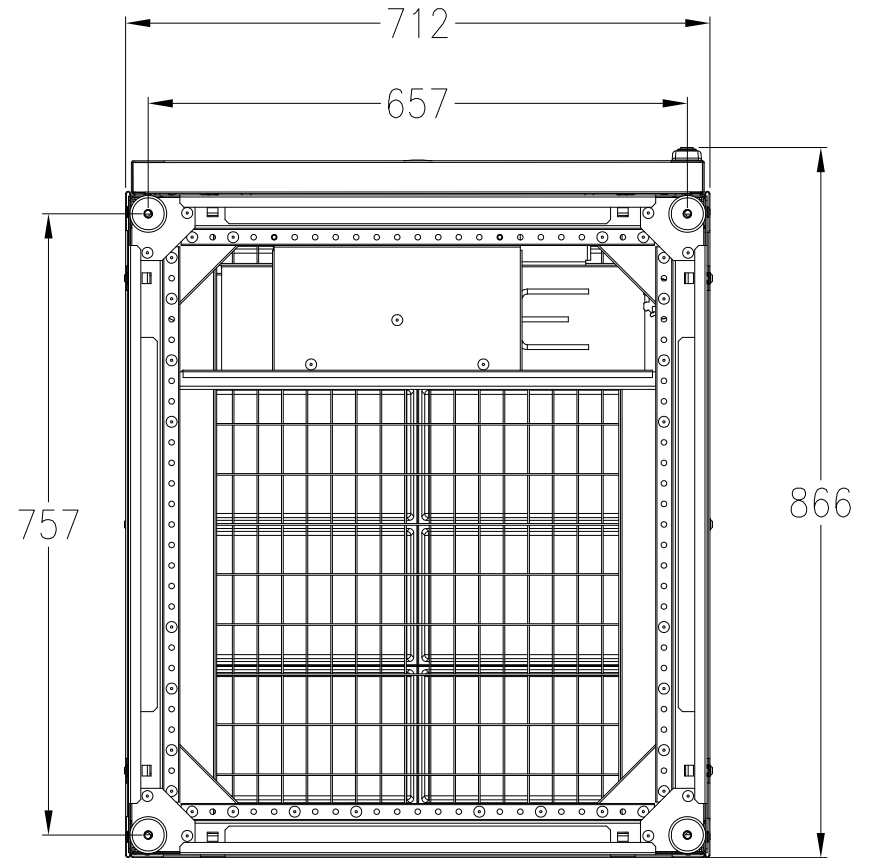

BOTTOM VIEW

NOTES:

1. INSTALLATION MUST COMPLY ALL APPLICABLE NATIONAL AND LOCAL ELECTRICAL REGULATIONS
2. PLEASE REFER TO PRODUCT MANUAL FOR DETAILED INFORMATION.
3. ALL DIMENSIONS ARE IN MILLIMETERS. UNLESS OTHERWISE SPECIFIED.
4. FOR BOTTOM CABLE ENTRY REMOVE BOTTOM CONDUIT PLATES, DRILL/PUNCH HOLES WITH-IN PROVIDED CABLE ENTRY AREA. REFIT COVER AND INSTALL CONDUITS.

THIS DRAWING AND SPECIFICATIONS HEREIN ARE THE PROPERTY OF SCHNEIDER ELECTRIC AND SHALL NOT BE COPIED, REPRODUCED OR USED IN WHOLE OR IN PART, AS THE BASIS FOR THE MANUFACTURE OR SALE OF ITEMS WITHOUT WRITTEN PERMISSION FROM SCHNEIDER ELECTRIC. THIS DRAWING IS BASED UPON LATEST AVAILABLE INFORMATION AND IS SUBJECT TO CHANGE WITHOUT NOTICE.



TITLE:  
 SYMMETRA PX ET 160  
 BATTERY CABINET  
 FOR THIRD-PARTY BATTERIES  
 TOP AND BOTTOM VIEW

DWG NO: SYPBV96K160H REV. 0

DRAWN: C KRISHNA 18-MAR-14 FIRST ANGLE PROJECTION

ENGINEER: BIN-COMPPELL BAI 18-MAR-14

PROJECT: SUBMITTAL DRAWINGS SHEET 2 OF 4

APPROVED: BIN-COMPPELL BAI 18-MAR-14

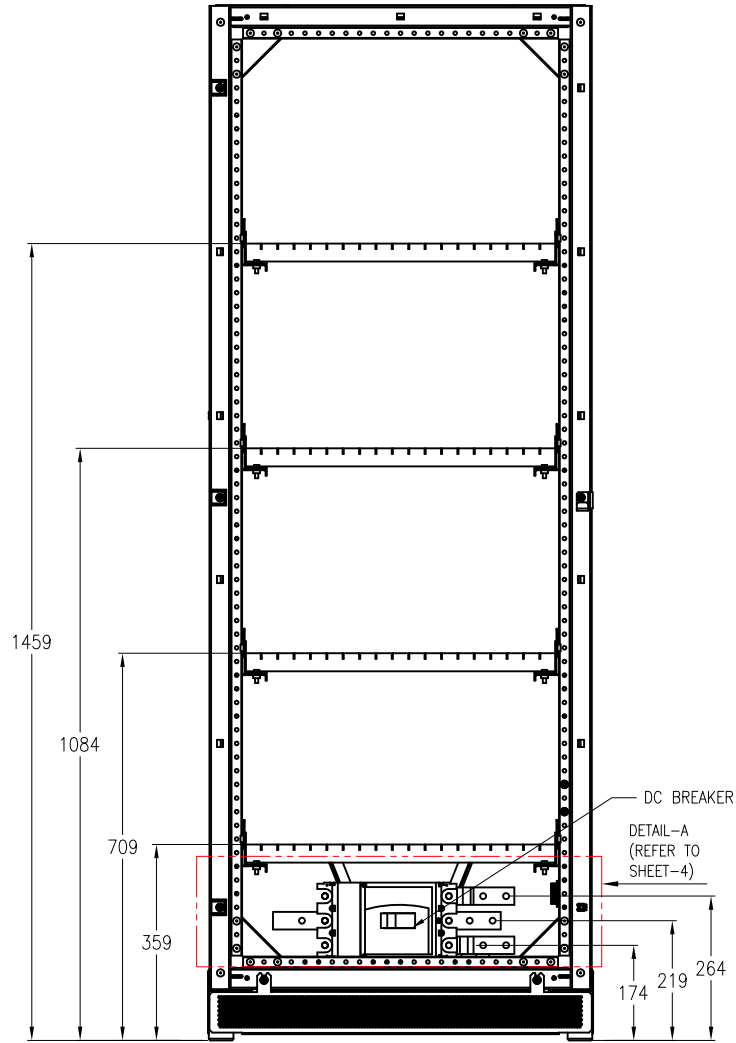

FRONT VIEW

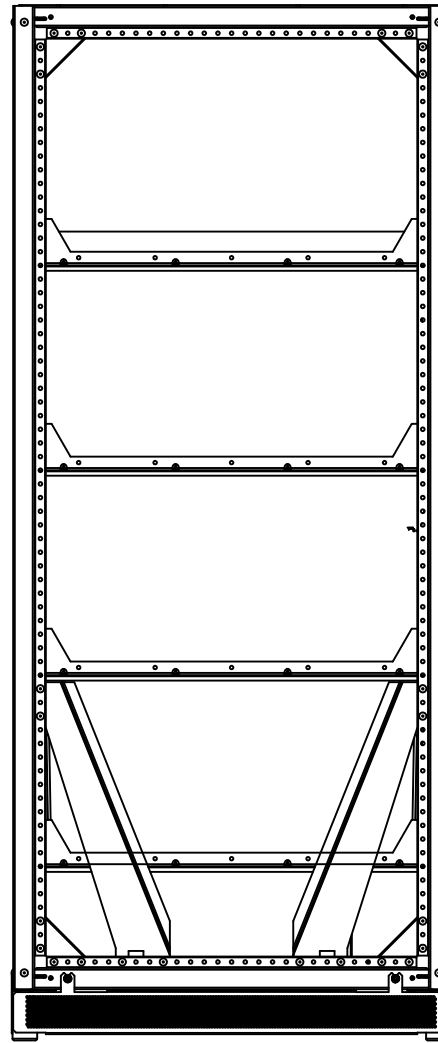

LEFT SIDE VIEW

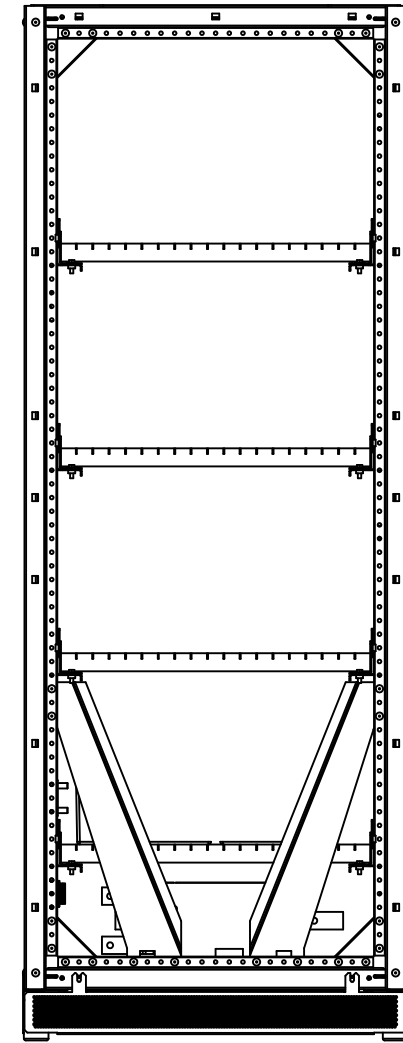

REAR VIEW

NOTES:

1. INSTALLATION MUST COMPLY ALL APPLICABLE NATIONAL AND LOCAL ELECTRICAL REGULATIONS
2. PLEASE REFER TO PRODUCT MANUAL FOR DETAILED INFORMATION.
3. ALL DIMENSIONS ARE IN MILLIMETERS. UNLESS OTHERWISE SPECIFIED.
4. 32 BATTERY BLOCKS ARE NEEDED (8 PER SHELF), MAXIMUM RECOMMENDED BATTERY BLOCK SIZE - 262(W) x 175(D) x 240(H)

THIS DRAWING AND SPECIFICATIONS HEREIN ARE THE PROPERTY OF SCHNEIDER ELECTRIC AND SHALL NOT BE COPIED, REPRODUCED OR USED IN WHOLE OR IN PART, AS THE BASIS FOR THE MANUFACTURE OR SALE OF ITEMS WITHOUT WRITTEN PERMISSION FROM SCHNEIDER ELECTRIC. THIS DRAWING IS BASED UPON LATEST AVAILABLE INFORMATION AND IS SUBJECT TO CHANGE WITHOUT NOTICE.



TITLE:

SYMMETRA PX ET 160  
BATTERY CABINET  
FOR THIRD-PARTY BATTERIES  
INTERNAL VIEW

DWG NO:

SYPBV96K160H

REV. 1

DRAWN:

C KRISHNA

10-OCT-14

ENGINEER:

BIN-COMPPELL BAI

10-OCT-14

APPROVED:

MATTHIEU SAAS

10-OCT-14

PROJECT: SUBMITTAL DRAWINGS SHEET 3 OF 4

FIRST ANGLE PROJECTION

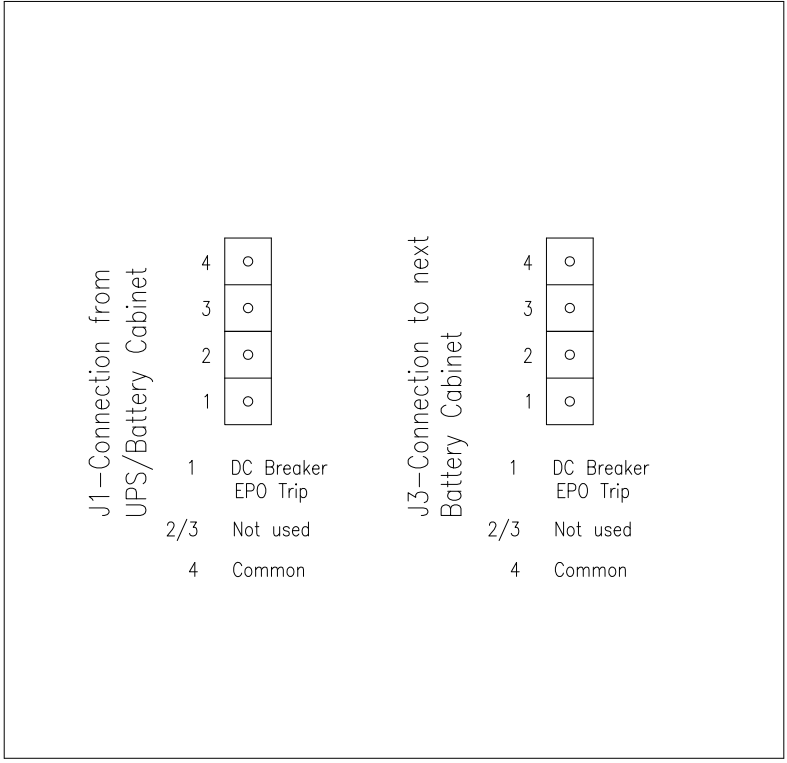

EPO INTERFACE FOR DC BREAKER TRIP

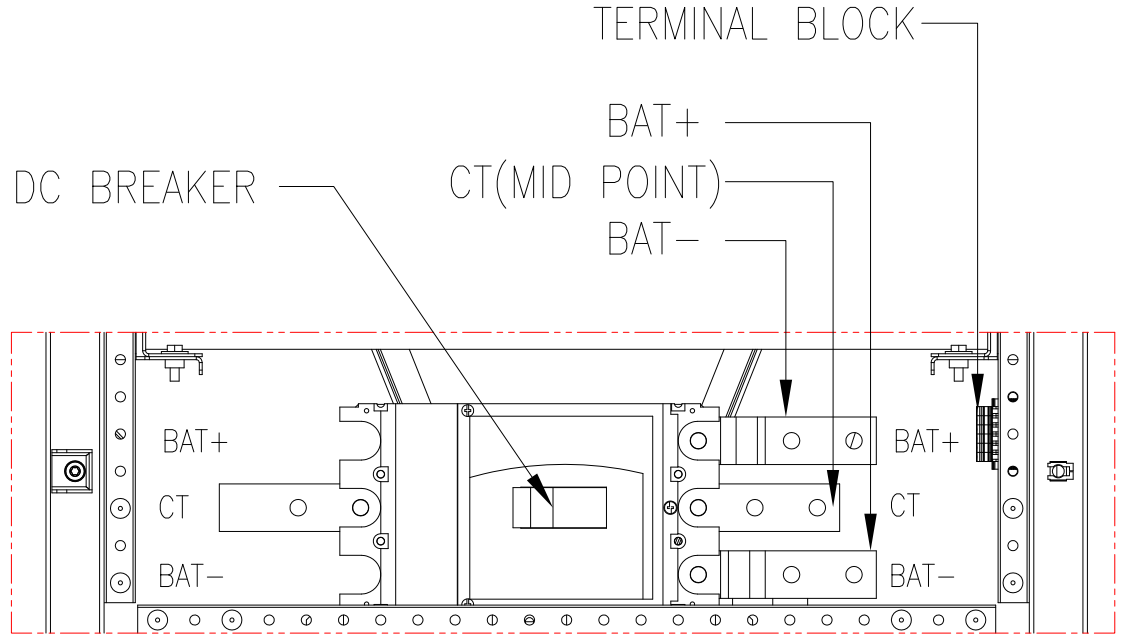

DETAIL-A  
(CIRCUIT BREAKER AND INPUT/OUTPUT DETAILS—ENLARGED VIEW)

NOTES:  
1. INSTALLATION MUST COMPLY ALL APPLICABLE NATIONAL AND LOCAL ELECTRICAL REGULATIONS  
2. PLEASE REFER TO PRODUCT MANUAL FOR DETAILED INFORMATION.  
3. ALL DIMENSIONS ARE IN MILLIMETERS. UNLESS OTHERWISE SPECIFIED.

THIS DRAWING AND SPECIFICATIONS HEREIN ARE THE PROPERTY OF SCHNEIDER ELECTRIC AND SHALL NOT BE COPIED, REPRODUCED OR USED IN WHOLE OR IN PART, AS THE BASIS FOR THE MANUFACTURE OR SALE OF ITEMS WITHOUT WRITTEN PERMISSION FROM SCHNEIDER ELECTRIC. THIS DRAWING IS BASED UPON LATEST AVAILABLE INFORMATION AND IS SUBJECT TO CHANGE WITHOUT NOTICE.



TITLE:  
SYMMETRA PX ET 160  
BATTERY CABINET  
FOR THIRD-PARTY BATTERIES  
WIRING DETAILS

PROJECT: SUBMITTAL DRAWINGS SHEET 4 OF 4

DWG NO: SYPBV96K160H

DRAWN: C KRISHNA	18-MAR-14
ENGINEER: BIN-COMPPELL BAI	18-MAR-14
APPROVED: MATTHIEU SAAS	18-MAR-14

REV: 0

FIRST ANGLE PROJECTION