

NEMA SIZE 2 REVERSING CONTACTOR
 3-POLE POLYPHASE - 600 VAC, 50-60 HZ

COIL VOLTAGE CODE (1)	VOLTAGE	
	60 HZ	50 HZ
V01	24	-
V02	120	110
V08	208	-
V03	240	220
V06	480	440
V07	600	560
V99	SPECIFY	SPECIFY

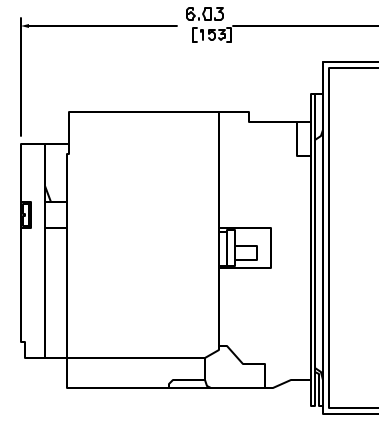
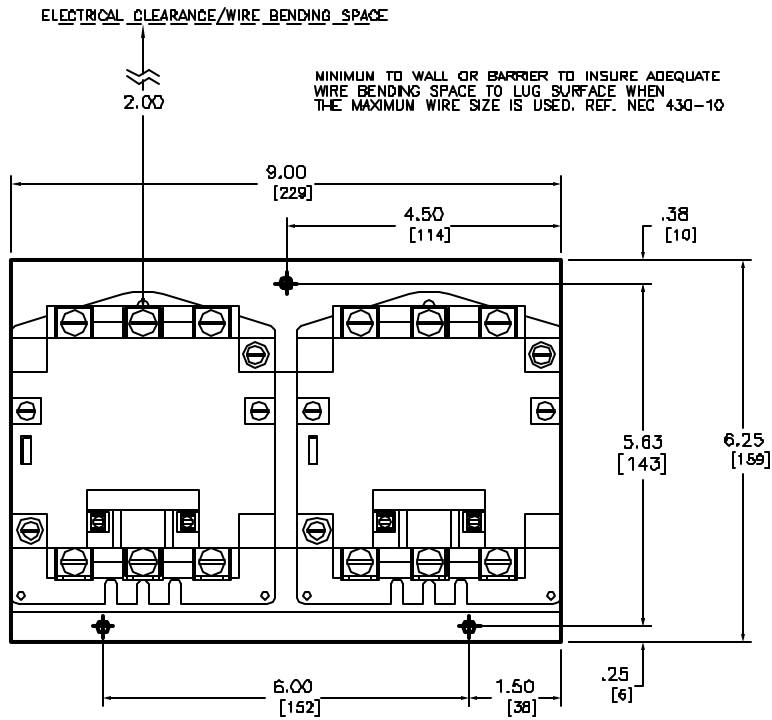

Catalog Number: 8702-SD02(1)
 Ratings: SEE CHART
 UL File/CCN: E78351/NLDX
 CSA File/Class: LR6D905/3211 0
 Meets Standards: -
 Weight: 16 lbs
 Wire Size: POWER - #14-#4, CONTROL - #16-#12
 Terminal torque: 50 LB/IN
 Mounting Hwd.: (3) #10 screws

DUAL DIMENSIONS: INCHES
 MILLIMETERS

NEMA SIZE 2 REVERSING CONTACTOR
 CLASS 8702 TYPE SD02(1)



DWG# E0301301-01
 NO.