

SYMBOL	KNOCKOUTS	
	CONDUIT SIZE	
A	.50	13
B	.75	19
C	1.00	25
D	1.25	32
E	1.50	38
F	2.00	51
G	2.50	64

COMBINATION SERVICE ENTRANCE DEVICES  
 RAINPROOF ALL-IN-ONE  
 RAINPROOF NEMA TYPE 3R ENCLOSURE  
 SURFACE MOUNT ONLY

DMG# 3213  
**Square D**  
 Schneider Electric

NOTES:  
 FINISH - GRAY BAKED ENAMEL  
 POWDER COAT PAINT OVER  
 CLEANED GALVANNEALED STEEL.  
 MAXIMUM SYSTEM VOLTAGE:  
 120/240VAC, 1 Ø 3W, 50-60HZ  
 208Y/120VAC, 1 Ø 3W, 50-60HZ  
 (FROM A 3 Ø 4W SYSTEM)  
 UL LISTED - FILE E-6294, VOL. M  
 SUITABLE ONLY FOR USE AS  
 SERVICE EQUIPMENT.  
 SUITABLE FOR UNDERGROUND/  
 OVERHEAD SERVICE.

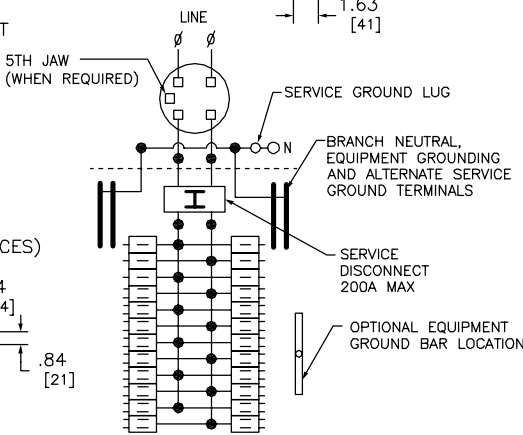
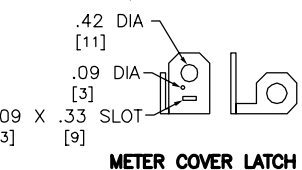
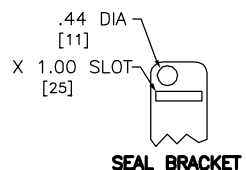
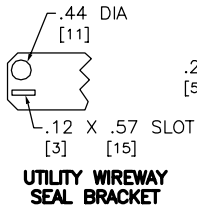

ONE SINGLE POLE, ONE PLUG-ON SPACE TYPE QO. TWO POLE TYPES QO OR QOA (10-100A) MAY PLUG-ON TWO ADJACENT SPACES. TWO POLE TYPE QOC (150-200A) MAY PLUG ON FOUR ADJACENT SPACES. **USE 10-100A AND 150-200A BRANCH BREAKERS ONLY.**

TWO SINGLE POLE, ONE PLUG-ON SPACE TYPE QOT OR ONE SINGLE POLE TYPE QO. TWO POLE TYPE QO OR QOA (10-100A) MAY PLUG-ON TWO ADJACENT SPACES. TWO POLE TYPE QOC (150-200A) MAY PLUG ON FOUR ADJACENT SPACES. **USE 10-100A AND 150-200A BRANCH BREAKERS ONLY.**

A SQUARE D UL LISTED SECONDARY SURGE ARRESTER MAY PLUG ON TWO ADJACENT SPACES. ORDER CATALOG NO. Q021755B.

DUAL DIMENSIONS: INCHES  
 MILLIMETERS

MAINS AMPERE RATING	FACTORY INSTALLED BYPASS TYPE	SHORT CIRCUIT CURRENT RATING	CATALOG NUMBER	SERIES	SPACES	MAXIMUM NUMBER OF SINGLE POLE QO CIRCUITS	LINE SIDE PHASE & NEUTRAL LUGS AWG/KCMIL	SERVICE GROUND LUG
150	HORN	22K	QC2442M150CH	M01	24	42	#6-350 CU/AL	#8-2/0 CU/AL
200	NONE		QC2442M200C					
	HORN		QC2442M200CH					