

Medium voltage NEX switchgear Withdrawable circuit breaker

Quite simply efficient

Web-enabled Power & Control
Transparent
Ready

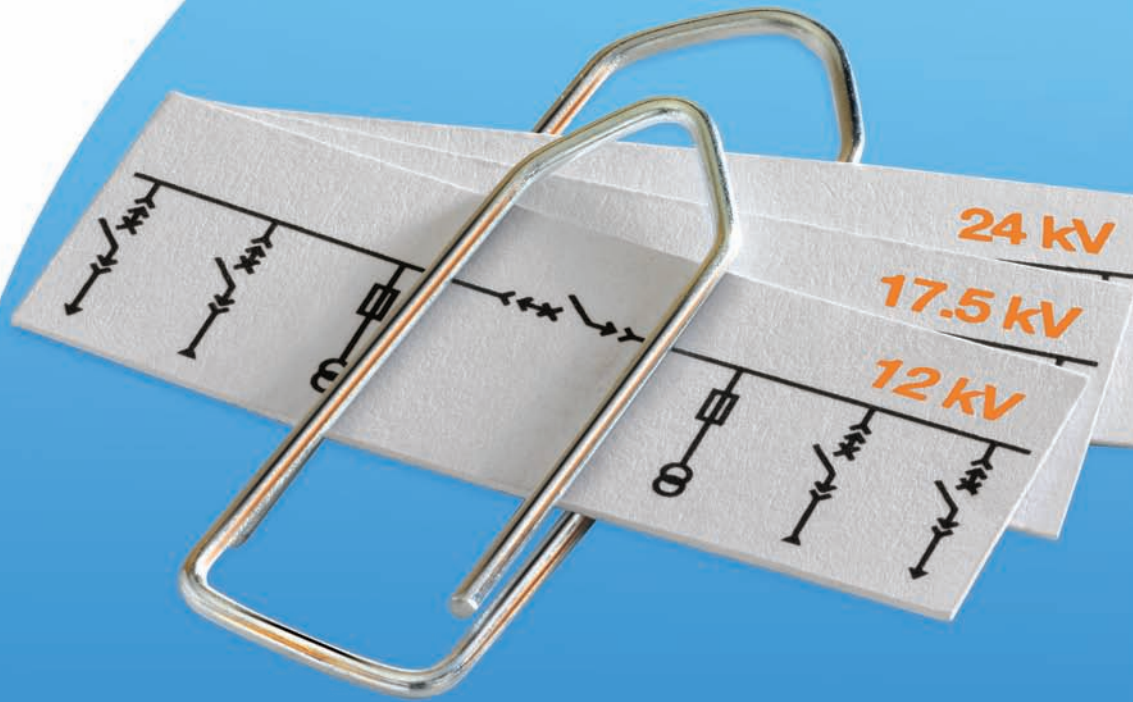

NEX, *a simple and flexible solution*

NEX is the result of worldwide acquired experience and provides you with a high level of safety and reliability. It is particularly suitable for the MV section of HV/MV and MV/MV substations. You will benefit from its simplicity and flexibility.



NEX, *simplicity and robustness*

NEX complies with IEC 62271-200 standard and exists in 3 voltage levels: 12, 17.5 and 24 kV.

The answer for typical HV/MV substations

NEX is the perfect answer for general type applications, thanks to:

- pre-designed solutions,
- easy installation and reduced maintenance,
- robust design.

A design which meets user requirements

NEX design takes into account three categories of user requirements:

- reliability,
- simplicity,
- safety of operators.

NEX is an indoor switchgear assembly intended to meet electrical distribution needs from 1 to 24kV. It incorporates a set of innovative solutions using proven techniques:

- *high-performance breaking devices (Vacuum technology)*
- *digital protection and control system*
- *a range of pre-designed and tested cubicles*



NEX, *main characteristics*

The figures below are given for normal operating conditions, as defined in IEC 62271-200 and 60694 standards. Operating temperature range from -5°C to +40°C, altitude less than or equal to 1 000 m and relative humidity less than or equal to 95%.

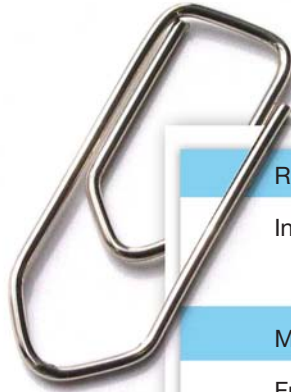

Rated voltage (kV)		12	17.5	24
Insulation level	50 Hz/ 1 mn (kV rms)	28	38	50
	1.2/ 50 μs (kV peak)	75	95	125
Maximum short-time withstand current and nominal current				
Functional unit with vacuum circuit breaker				
	Ith max (kA/3s)	31.5	31.5	25
	In max (A)	2 500	2 500	2 000
Internal arc withstand				
	IAC-AFLR (kA/s)	25/ 0.5	25/ 0.5	25/ 1
Protection index				
	IP3X			
	IP4X			



Evolis circuit breaker: *the very best of vacuum technology*

NEX is equipped with Evolis, withdrawable, vacuum technology circuit breaker.

The Schneider Electric guarantee

All components of Evolis circuit breaker are produced by Schneider Electric, including the vacuum interrupters, manufactured in an ultra-modern production unit in France. From design to production, our industrial process expertise guarantees a product that meets standards of quality and reliability.

In compliance with standards

At every stage of development and production, Evolis has been subjected to a series of tests to guarantee its performance levels. Evolis is in conformity with IEC 62271-100 standard.

Development and production sites are certified according to ISO 9000: 2000 and ISO 14000.

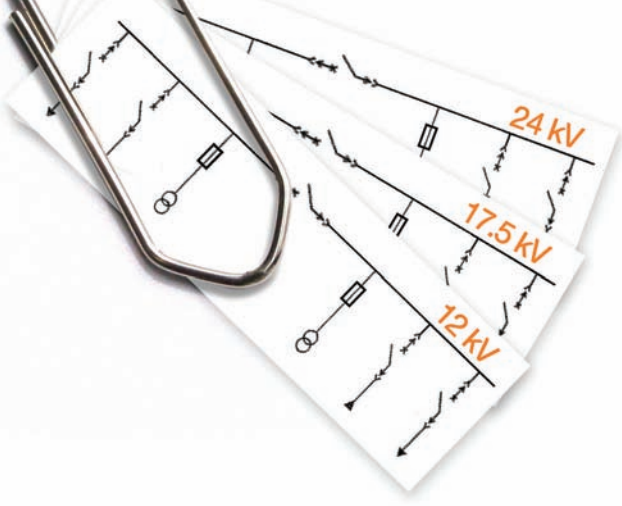

NEX, *a simple design*

Busbar compartment

This section connects the switchboard cubicles via busbars

Low voltage cabinet

This section includes:

- the Sepam protection and control unit
- the low voltage components

Switchgear compartment

This section contains the MV protection devices:

- vacuum breaking devices (circuit breakers)
- lever-type propulsion mechanism for racking in-out
- interlocks to anchor the withdrawable part.

Cable compartment

This compartment, located in the lower part of the cubicle, includes:

- the earthing switch
- the current sensors and voltage transformers.

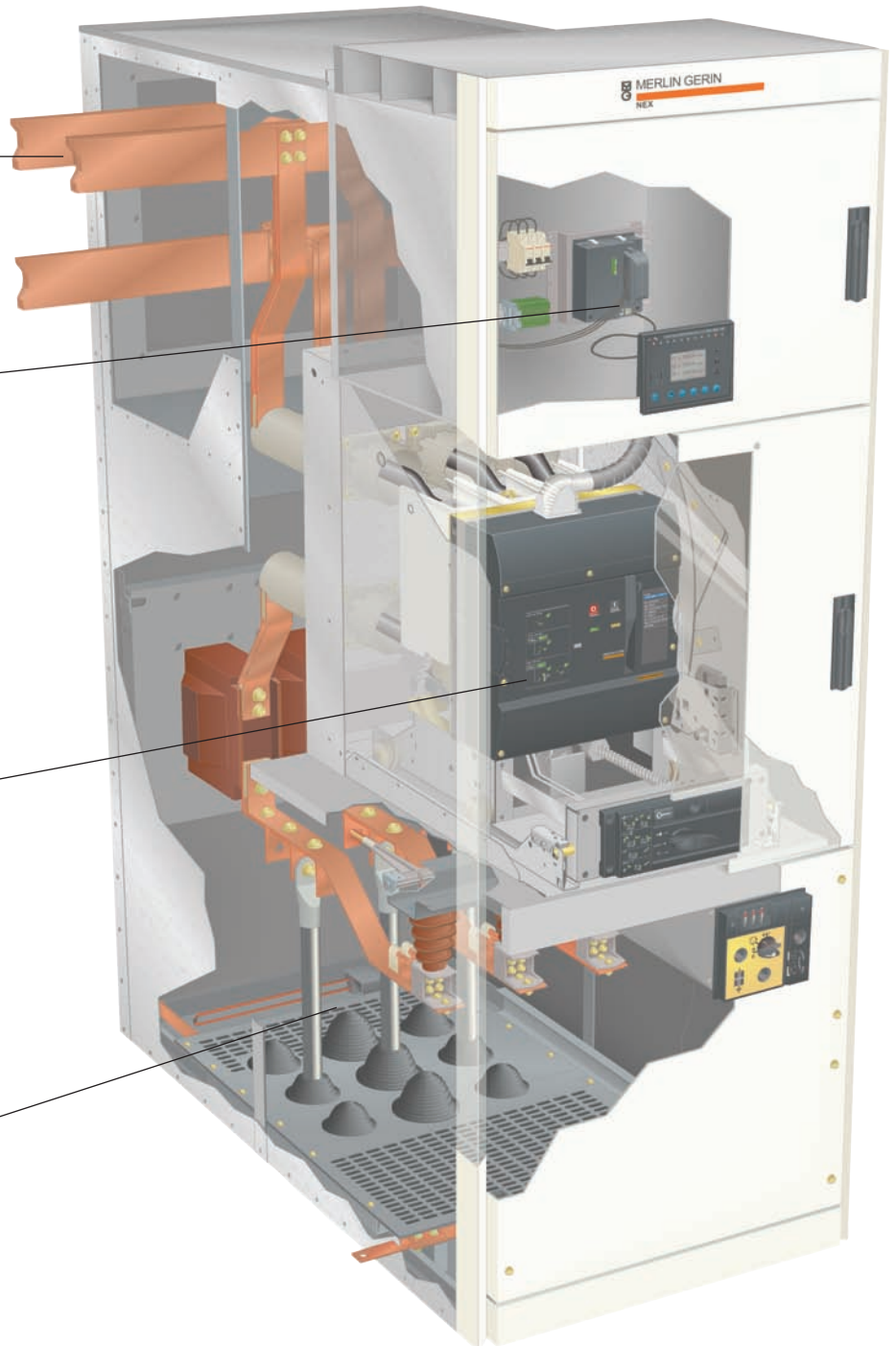



NEX, *flexibility*

A complete offer

NEX is a medium voltage offer comprising cubicles with Evolis vacuum circuit breaker, sensors, MV connections, etc., easy to select and implement.

Adaptability

NEX offers you flexible and adapted solutions:

- NEX can take into account technical needs (medium voltage, low voltage cabinet) according to customer exploitation habits.

Closer to you

NEX allows a quick response to requests for quotes and tenders, and gives you the benefit of local support centres all over the world:

- NEX is produced in 44 plants, distributed in 17 countries in the world (in 2006),
- you have the guarantee of a Merlin Gerin product, thanks to training, technical assistance, regular quality audits...

Ask for validation certificates.



NEX, a range of functional units

NEX, a complete offer based on 4 functions.

Incomer/ Feeder (IF)

- Line (LI-B, LF-B)
- Transformer (TI-B, TF-B)
- Generator (GI-B)

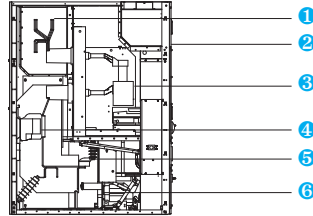
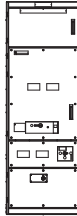

- 1 busbar
- 2 LV cabinet
- 3 withdrawable part
- 4 current sensors
- 5 earthing switch
- 6 voltage transformers

Feeder (motor, capacitor) (IF)

- Motor (MF-B)
- Capacitor (CB-B)

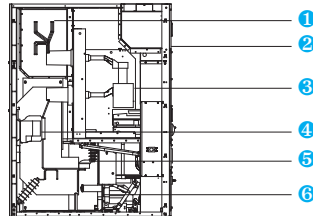
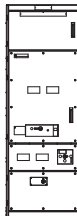

- 1 busbar
- 2 LV cabinet
- 3 withdrawable part
- 4 current sensors
- 5 earthing switch
- 6 voltage transformers

Bus coupler/ riser (BC – RF – RW)

- Switchboard (BS-B)
- Substation (SS-B)

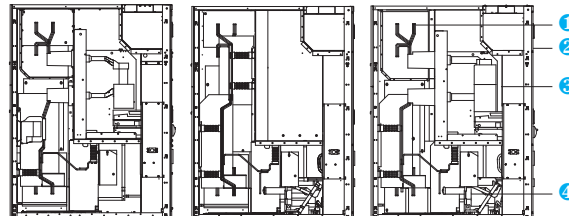
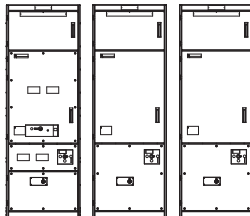

- 1 busbar
- 2 LV cabinet
- 3 withdrawable part
- 4 voltage transformers

Metering and busbar earthing (VT – BM)

- Switchboard (BB-V)

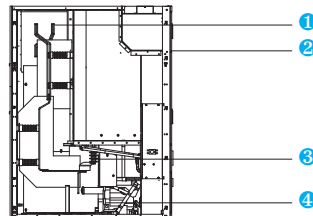
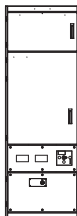

- 1 busbar
- 2 LV cabinet
- 3 earthing switch
- 4 voltage transformers

Schneider Electric Industries SAS

Head Office
89, bd Franklin Roosevelt
92506 Rueil-Malmaison Cedex
FRANCE

www.schneider-electric.com

As standards, specifications and designs change from time to time, please ask for confirmation of the information given in this publication.

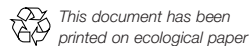

Design: www.adncom.fr
Photos: Schneider Electric - adncom - Artechnique
Printing: