

(1) = Bus Base
 (2) = Module
 (3) = Terminal Block

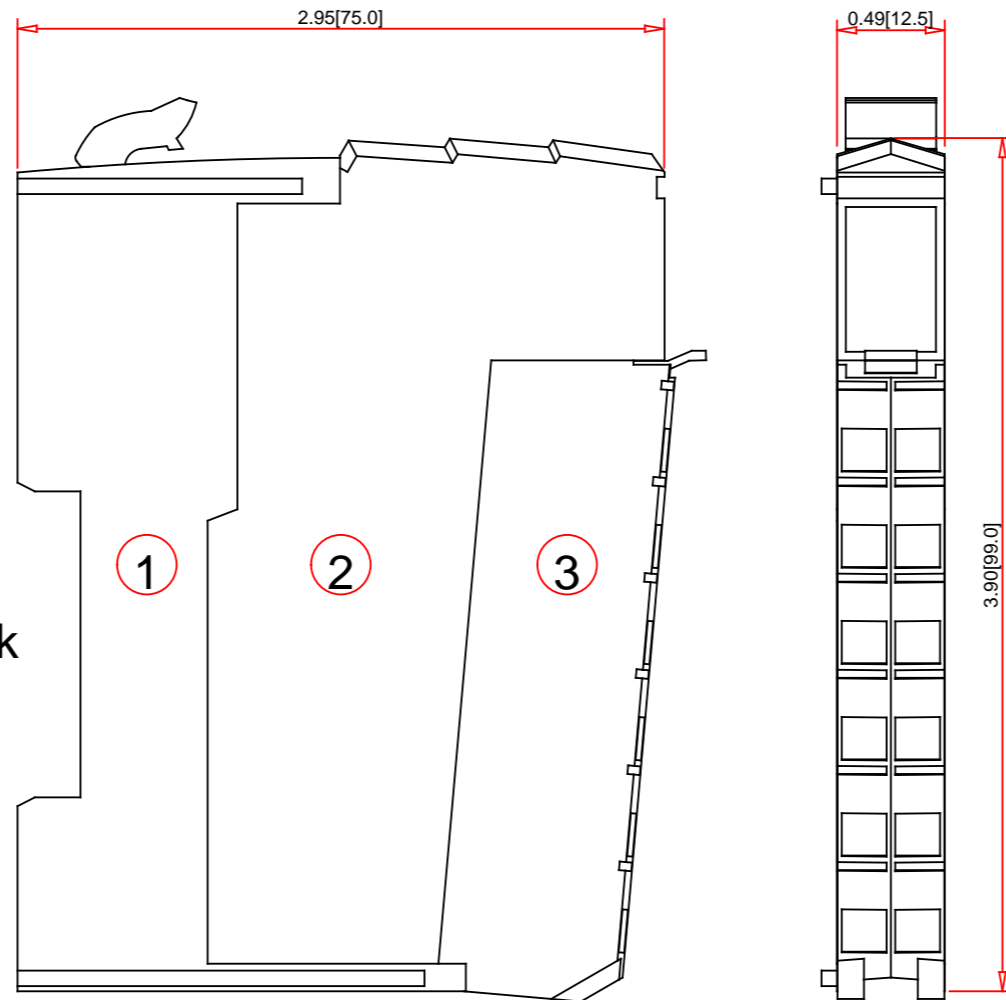

Note:
 - Drawings Not To Scale
 - Drawings Subject to Change Without Notice
 - Dimensions are inches next to [Millimeters]

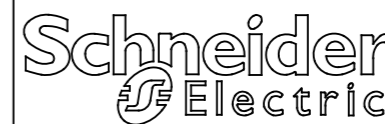

Schneider Electric United States
 North American Division
 Boston One Campus
 800 Federal Street
 Andover, MA 01810, USA
 Phone: +1 8773425173
 Email: CCC@us.schneider-electric.com

Technical Information:
 Associated Bus Base: TM5ACBM11 or TM5ACBM15
 Associated Terminal Block: TM5ACTB12
 IEC/EN61131-2 conformity: Type 1
 Type of Input: 1-, 2-, or 3-wire
 Functions: Event counting, Interval Measurement
 Connection Type: Removable Spring Terminal Blocks
 Mounting: 35mm DIN Rail
 RoHS: Yes
 Weight [kg]: 0.025

Selection:
 Number of Counter Channels: 2
 Type of Signal: Sink
 Nominal Input Voltage: 24V DC
 Voltage limit values: 20.4 to 28.8V DC
 Frequency per channel: 50 kHz
 Resolution:

Counter Expansion Module
 2
 Sink
 24V DC
 20.4 to 28.8V DC
 50 kHz