

(1) = Bus Base
 (2) = Module
 (3) = Terminal Block

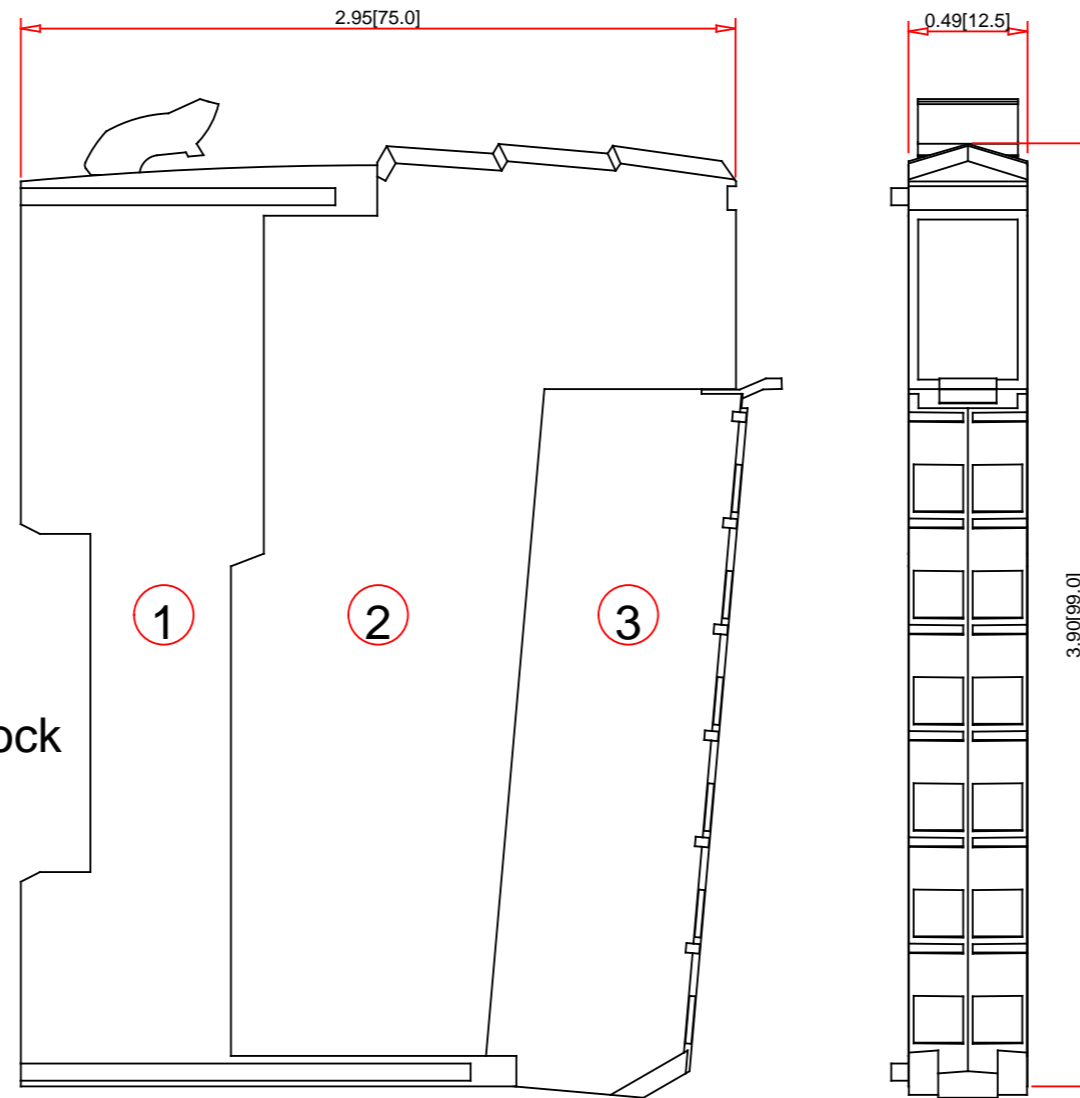

Note:
 - Drawings Not To Scale
 - Drawings Subject to Change Without Notice
 - Dimensions are inches next to [Millimeters]

Part No.:

TM5SBET7

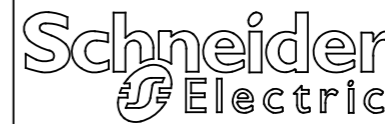

Schneider Electric United States
 North American Division
 Boston One Campus
 800 Federal Street
 Andover, MA 01810, USA
 Phone: +1 8773425173
 Email: CCC@us.schneider-electric.com

Technical Information:

Associated Bus Base: TM5ACBM11 or TM5ACBM15
 Associated Terminal Block: TM5ACTB12
 Mounting: 35mm DIN Rail
 Technical Specs: see www.schneider-electric.com
 RoHS: Yes
 Weight [kg]: 0.025

Specification:

Description: Remote Transmitter Module - IP20 I/O & IP67
 Selection: LMC058 / M258
 Range Compatibility: Communication between remote I/O
 Application: 24V DC
 Power Supply: