

Product End of Life Instructions

Harmony XA2 Pilot Light





Potential disassembly risks

The information provided in this document assumes that the product is completely de-energized and uninstalled (refer to the instructions provided in the appropriate product manuals).

Dismantling/disassembling the product may entail hazards caused by, for example, sharp edges, chemical aggression or ejected parts.

⚠ WARNING

HAZARD DUE TO INSUFFICIENT PROTECTION

- Implement all safety measures required by the applicable regulations and by the processes used to dismantle/disassemble and dispose of the product.
- Use all necessary personal protective equipment such as gloves and goggles.

Failure to follow these instructions can result in death or serious injury.



End of Life Instructions

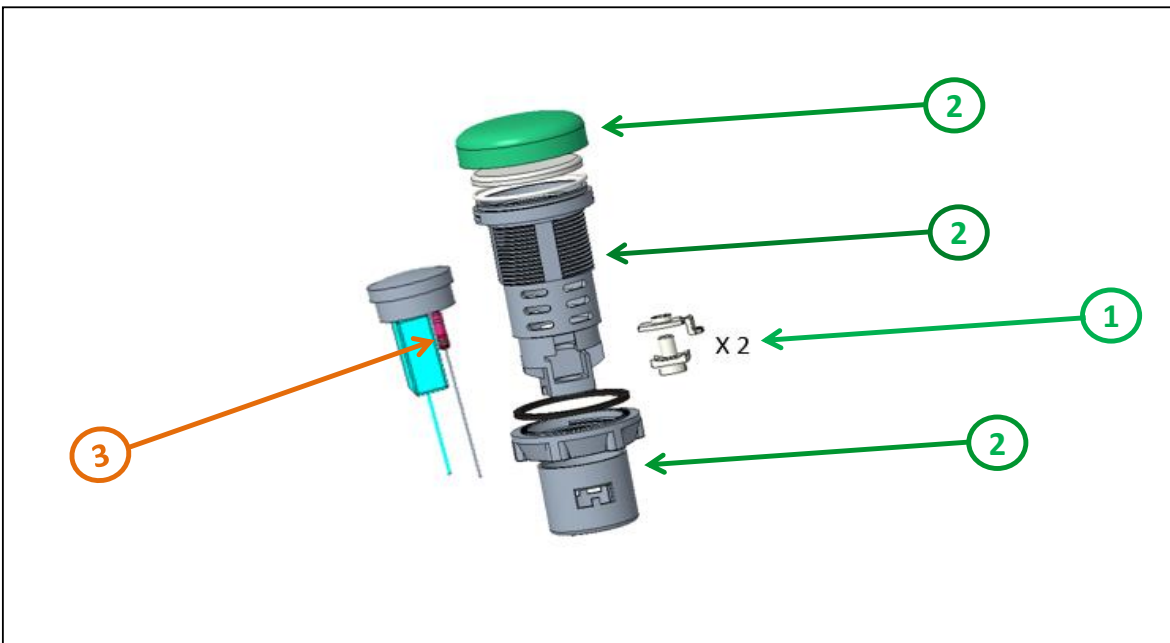

Recommendation	Number on drawing	Component / Material	Weight (in g)	Comment
To be dismantled	1	Screw, Plate	3.96	Metal Parts
To be dismantled	2	Cap, Diffuser, Cover	12.88	Plastic Parts
To be depolluted	3	Light Emitting Diode (LED)	3	Electronic Component

Product description

Manufacturer identification	Schneider Electric Industries SAS
Brand name	Schneider Electric
Product function	Pilot light is also used for an electrical indicator light that illuminates to show that electrical power is available or that an electrical device is operating.
Product reference	XA2EVM3LC
Additional similar product references	XA2EVB1LC XA2EVB3LC XA2EVB4LC XA2EVB5LC XA2EVB6LC XA2EVB8L XA2EVFD3LC XA2EVM5LC XA2EVF3LC XA2EVM6LC XA2EVFD4LC XA2EVFD5LC ZA2BV053 XA2EVF5LC XA2EVF6LC XA2EVF8LC XA2EVFD1LC XA2EVFD6LC XA2EVF1LC XA2EVFD8LC ZA2BV03 XA2EVM4LC XA2EVM8LC ZA2BV01ZA2BV033 ZA2BV04 ZA2BV043 ZA2BV05 XA2EVF4LC ZA2BV06 ZA2BV03 XA2EVM1LC XA2EVM3LC
Total representative product mass	20 g
Representative product dimensions	H 29 mm x L 53 mm x D 29 mm
Accessories	No accessories needed
Date of information release	10/2023

Additional information

Legal information	This product family is in the scope of European Union directive 2012/19/EU on Waste Electrical and Electronic Equipment (WEEE). The product family must be disposed according to the legislation of the country. This document is intended for use by end of life recyclers or treatment facilities. It provides the basic information to assure an appropriate end of life treatment for the components and materials of the product.	
In case of special transportation: transportation method	No special transportation required	
Recyclability potential	20%	Recyclability rate has been calculated based on REEECY'LAB tool developed by Ecosystem, for components/materials not covered by the tool, data from the "ECO'DEEE recyclability and recoverability calculation method" was taken. If no data was found a conservative assumption was used (0% recyclability).

Schneider Electric Industries SAS
Country Customer Care Center
<http://www.schneider-electric.com/contact>
35, rue Joseph Monier
CS 30323
F- 92500 Rueil Malmaison Cedex
RCS Nanterre 954 503 439
Capital social 928 298 512 €

www.se.com

ENVEOLI2308019_V1

Published by Schneider Electric

© 2023 - Schneider Electric – All rights reserved

10/2023