



Switched Rack Power Distribution Unit (AP8641)

Overview

The APC Switched Rack Power Distribution Unit (PDU) distributes power to devices in a rack. The PDU measures total load plus phase, bank, and outlet load. In addition, configured users can control the state of the outlets. You can access the PDU through Web, Telnet, SNMP, SSH, or EcoStruxure™ interfaces for comprehensive control and monitoring functionality.

Outlets. The Rack PDU has twenty-one (21) IEC-320-C13 and three (3) IEC-320-C19 locking outlets **2**. (The locking feature is compatible with APC by Schneider Electric locking input cords and APC by Schneider Electric locking jumper cords.)

Overcurrent protection. The Rack PDU has two (2) 20 A, 1-pole hydraulic-magnetic circuit breakers **1**.

Display interface. The liquid crystal display (LCD) **3** and input buttons **4** allow you to monitor current, power, and voltage measurements of the Rack PDU. Local communication can be established through the serial port **8**, and remote communication through the network port **5**. The USB **9** port allows for firmware upgrades, and the CAN **7** ports enable data transfer for future expansion options. The environmental sensor port **6** allows for monitoring of the temperature and humidity of the room or enclosure.

Power cord. The 3.0-m (10-ft) power cord terminates with a NEMA L6-30P connector **10**.

Toolless mounting: The Rack PDU has two toolless mounting pegs; for 0 U mounting capability in a rack or enclosure.

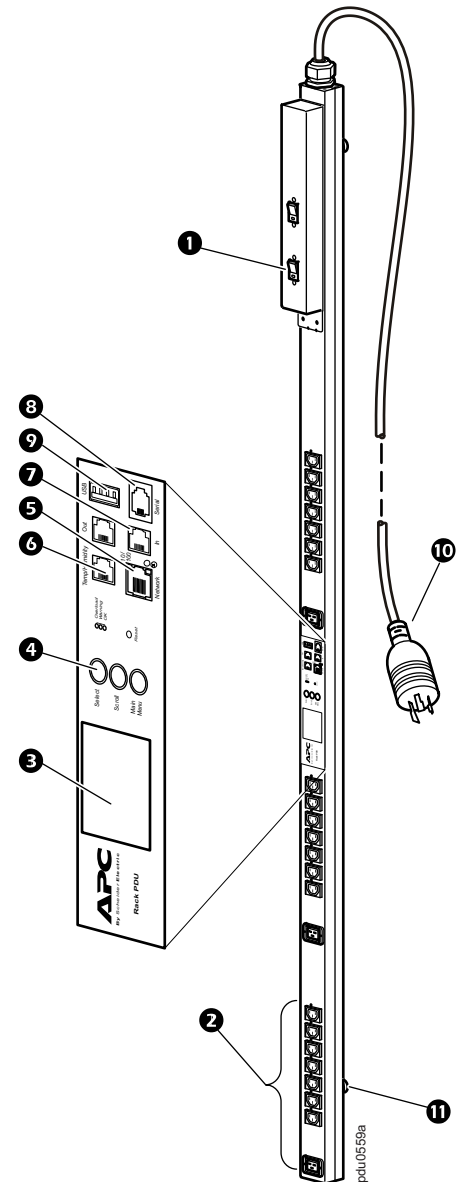

Specifications

Electrical

Acceptable input voltage	100–240/208 VAC
Maximum input current (phase)	24A cULus 30A PSE
Input frequency	50/60 Hz
Input connection	NEMA L6-30P
Input power	4.8 - 5.8 kVA
Output voltage	200–240 VAC
Maximum output current (outlet)	IEC-320-C13: 12 A; IEC-320-C19: 16 A
Maximum output current (phase)	24A cULus 30A PSE
Maximum output current (bank)	16 A
Output connections	Twenty-one (21) IEC-320-C13; three (3) IEC-320-C19
Overload protection (internal)	Two (2) 20 A, 2-pole hydraulic-magnetic circuit breakers

Physical

Dimensions (H x W x D) (depth does not include toolless pegs)	182.9 x 5.6 x 5.1 cm (72.0 x 2.2 x 2.0 in)
Power cord length	3.0 m (10 ft)
Shipping dimensions (H x W x D)	203.8 x 16.2 x 11.8 cm (80.25 x 6.38 x 4.63 in)
Weight/shipping weight	8.2 kg (18.1 lb) / 10.5kg (23.1 lb)

Environmental

Maximum elevation (above MSL) Operating/Storage	0–3 000 m (0–10,000 ft) / 0–15 000 m (0–50,000 ft)
Temperature Operating/Storage	–5 to 60 °C (23 to 140 °F) / –25 to 65 °C (–13 to 149 °F)
Humidity Operating/Storage	5–95% RH, non-condensing

Compliance

EMC verification	FCC Part 15, ICES-003, VCCI-CISPR 32
Safety verification	UL, cUL, PSE