

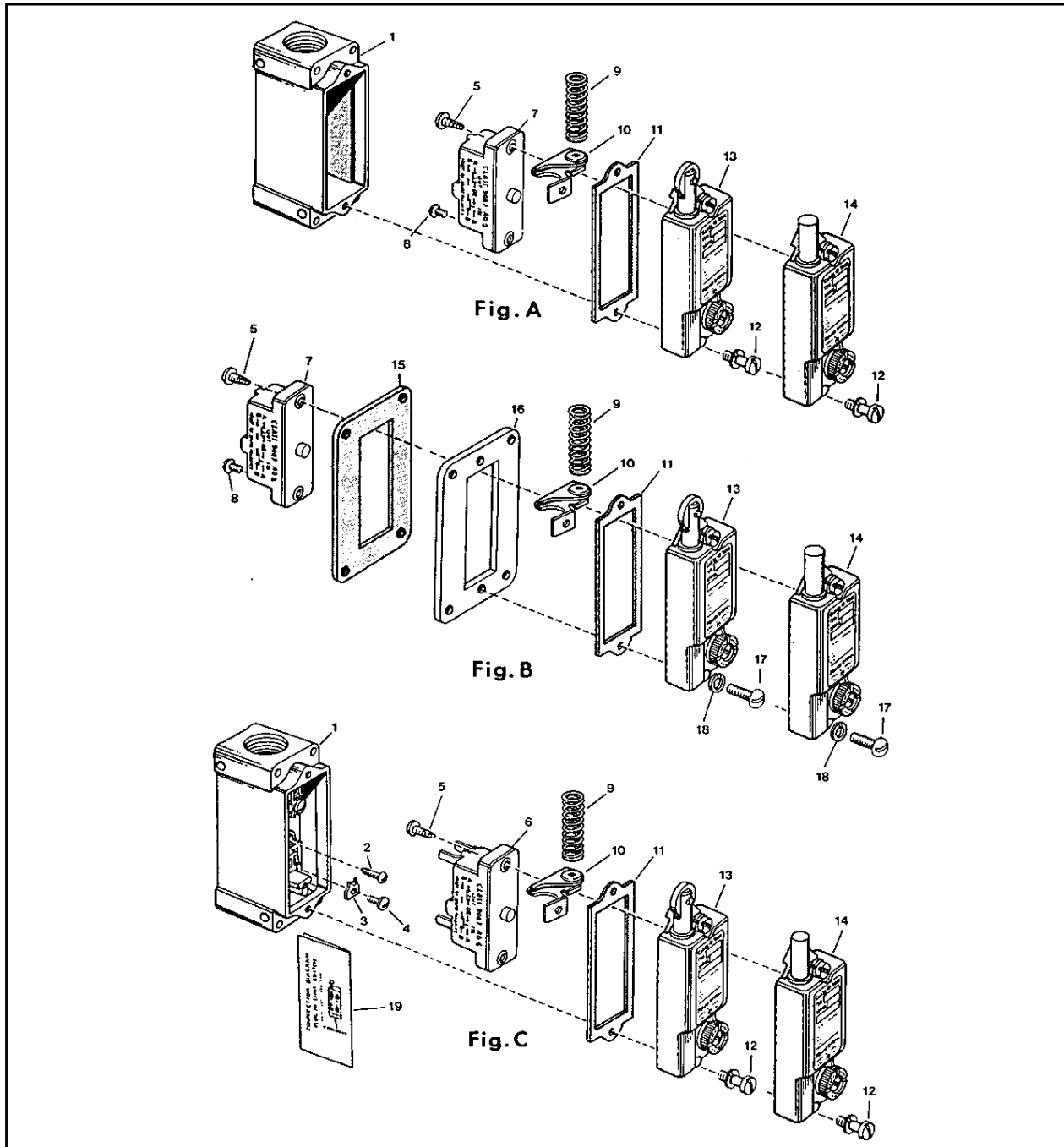

Class 9007 — Types AW and AF — Limit Switches Plunger Operated — Series A



Basic Contact Mechanism — The Class 9007 Type AO or Type CO snap switch (6), (7) serves as the contact mechanism and should be replaced as a complete unit.

Roller Adjustment — The initial position of the roller can be adjusted through a range of $\frac{1}{8}$ ". This is accomplished by turning the knurled knob until the desired roller position is located. The adjusting knob can then be locked in position by tightening the screw at the center of the knob.



Roller Direction — The roller operating direction can be easily changed from its normal direction of parallel to the bottom of the box to perpendicular to the bottom of the box as follows:

- A. Remove the limit switch from the box.
- B. Referring to Figure D depress the roller plunger (A) and hold it down.
- C. Push in on the snap switch operating tab (B) and hold it in this position.
- D. Release roller plunger (A) and pull it outward until it is free to turn. Rotate the roller plunger (A) 90° and again depress it fully. Release the operating tab (B) and the roller plunger (A).

Repeating the above sequence with the exception of rotating the roller plunger (A) 90° and in the opposite direction will return the roller to its normal operating position.

Ordering Instructions — Specify part number, quantity and description of part, giving complete nameplate data of the device. For example: 1—2441-S41-G1 Box and Liner Assembly for a Class 9007 Type AW-34 limit switch.

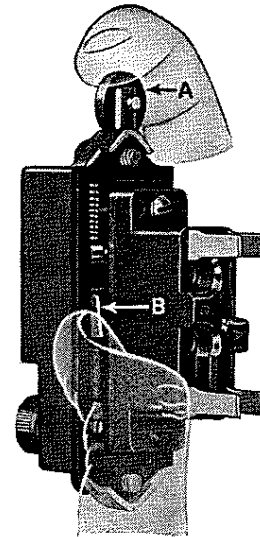

Figure D

PARTS LIST												
Item No.	Description	Part Number	AW-32 AW-34 Fig. A	AW-36 Fig. C	AW-38 Fig. A	AW-39 Fig. C	AW-42 AW-44 Fig. A	AW-46 Fig. C	AW-48 Fig. A	AW-49 Fig. C	AF-32 AF-38 Fig. B	AF-42 AF-48 Fig. B
1	Box and Liner Assembly	2441-S41-G1	1*	...	1	...	1*	...	1
1	Box and Liner Assembly	2441-S41-G2	1*	1*
1	Box and Liner Assembly with Terminal Block (includes item 19)	4475-C3-G1	...	1	1
1	Box and Liner Assembly with Terminal Block (includes item 19)	4475-C3-G4	1	1
2	Thread Cutting Screw #6-32 x 3/8	21014-12120	...	1	...	1	...	1	...	1
3	Wire Retainer	4475-D14-X1	...	4	...	4	...	4	...	4
4	Terminal Screw #6-32 x 5/16	214-X14	...	4	...	4	...	4	...	4
5	Thread Cutting Screw #6-32 x 3/8	21508-12200	2	2	2	2	2	2	2	2	2	2
6	Snap Switch (includes stabs)	Class 9007 Type AO-6	...	1	1
6	Snap Switch (includes stabs)	Class 9007 Type CO-6	1	1
7	Snap Switch (includes item 8)	Class 9007 Type AO-2	1	1	1*	1*
7	Snap Switch (includes item 8)	Class 9007 Type CO-3	1	1	...	1*	1*
8	Terminal Screw	21501-12081	4	...	8	...	4	...	8	...	4*	4*
9	Operating Spring	4475-D5-X1	1	1	1	1	1	1	1	1	1	1
10	Snap Switch Operator	4475-C7-X1	1	1	1	1	1	1	1	1	1	1
11	Gasket	2441-D86-X1	1	1	1	1	1	1	1	1	1	1
12	Captive Screw #10-24 x 1/2	214-D48-G1	2	2	2	2	2	2	2	2
13	Limit Switch Mechanism (includes items 5, 7, 8, 9, 10, 11, 12)	Class 9007 Type AO-32	...	1
13	Limit Switch Mechanism (includes items 5, 6, 8, 9, 10, 11, 12)	Class 9007 Type AO-36
13	Limit Switch Mechanism (includes items 5, 7, 8, 9, 10, 11, 12)	Class 9007 Type AO-38	1
13	Limit Switch Mechanism (includes items 5, 6, 8, 9, 10, 11, 12)	Class 9007 Type AO-39	1
14	Limit Switch Mechanism (includes items 5, 7, 8, 9, 10, 11, 12)	Class 9007 Type AO-42	1	†
14	Limit Switch Mechanism (includes items 5, 6, 8, 9, 10, 11, 12)	Class 9007 Type AO-46	1
14	Limit Switch Mechanism (includes items 5, 7, 8, 9, 10, 11, 12)	Class 9007 Type AO-48	1
14	Limit Switch Mechanism (includes items 5, 6, 8, 9, 10, 11, 12)	Class 9007 Type AO-49	1
15	Gasket	2441-D8-X1	1	1
16	Mounting Plate	2441-D7-X1	1	1
17	R.I.M.S. #10-24 x 7/16	21001-16140	2	2
18	L.W. #10	23701-00160	2	2
19	Connection Diagram	65013-005-18	...	1	1
19	Connection Diagram	65013-005-20	1	1

* AW-34 and AW-44 use box No. 2441-S41-G1.

* AF-32 and AF-42 use Type AO-2 snap switch and 4 item 8. AF-38 and AF-48 use Type CO-3 snap switch and 8 item 8.

† Order complete Type AF-32, 38, 42 or 48 for replacement limit switch mechanism.