

SpaceLogic Room Controllers

SE8650 Application Guide Roof Top Unit (RTU), Heat Pump and Indoor Air Quality (IAQ)

Firmware release version 2.6



TABLE OF CONTENTS

1. OVERVIEW..... 3

2. 2 HEATING / 2 COOLING FOR ROOFTOP UNIT AND INDOOR AIR QUALITY..... 5

3. 2 COOLING / MODULATING HEAT FOR ROOFTOP UNIT AND INDOOR AIR QUALITY..... 7

4. FRESH AIR DAMPER CONTROL SEQUENCES..... 9

APPENDIX A. OPTIONAL NETWORK SET-UP..... 14

APPENDIX B. WIRELESS SENSORS..... 14

APPENDIX C. SCHEMATIC OF CONTROLLERS OCCUPANCY SEQUENCE OF OPERATION WITHOUT DOOR SENSOR..... 15

APPENDIX D. DEPLOYMENT..... 16

APPENDIX E. TERMINAL CORRESPONDENCE..... 19

1. OVERVIEW



The SpaceLogic SE8650 Rooftop and Indoor Air Quality Controller is a new, cost-effective solution for upgrading rooftop unit thermostats. This solution allows existing wiring between the rooftop unit and the temperature controller to be re-used, reducing overall costs and installation time. The SE8650 can also add new features like CO2 and fresh air monitoring to the existing functions of a rooftop unit.

The SE8650 Rooftop and Indoor Air Quality Controller can be configured to handle a broad variety of applications covering all the standard implementations necessary for rooftop HVAC systems.

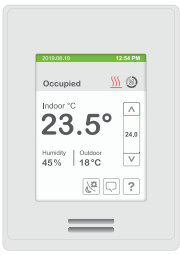

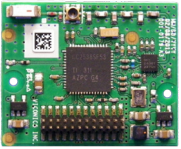
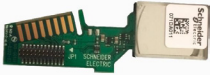

In addition to controlling heating, cooling and air quality, depending on the model and accessories, the SE8650 can handle wireless networking and switches, Passive Infrared (PIR) occupancy detection using either onboard or remote sensors, and can have custom programs implemented to fulfill specific user requirements. The applications described here cover all these features, and in combination with the SE8650's advanced scheduling and occupancy controls can provide the functionality for any required rooftop HVAC implementation.

Commercial and Hospitality Interface (Local Override and Degrees C/F Selection)						
	Part Number	Description	Humidity	PIR Sensor	ZigBee onboard	Communication
	SE8650U0BXX	RTU/HPU terminal equipment controller	Yes	No	No*	BACnet® / Modbus®
	SE8650U5BXX	RTU/HPU terminal equipment controller	Yes	Yes	No*	BACnet® / Modbus®
	SE8650U5BXXP	RTU/HPU terminal equipment controller	Yes	Yes	Yes	BACnet® / Modbus®
	SE8650U0NXX	RTU/HPU terminal equipment controller	Yes	No	No*	No
	SE8650U5NXX	RTU/HPU terminal equipment controller	Yes	Yes	No*	No

*Note: ZigBee Pro plug-in module is available.

Communication Modules for SE8650		
	Part Number	Description
	VCM8000V5045P* Release 24	ZigBee Pro extended profile retrofit communication module.
	VCM8001V5045*	CO2 detection sensor retrofit communication module.
	VCM8002V5031* Release 1	Wi-Fi extended profile retrofit communication module.

* Note: Only one of the three communication modules can be plugged in at one time.

Wireless Accessories for SE8650*		
	Part Number	Description
	SED-CO2-G-5045	Wireless CO2 sensor with room temperature and humidity
	SED-TRH-G-5045	Wireless sensor with room temperature and humidity
	SED-WMS-P-5045	Wireless wall mounted motion sensor
	SED-WDC-G-5045	Wireless window/door sensor
	SED-MTH-G-5045	Wireless motion/temperature/humidity sensor
	SED-WLS-G-5045	Wireless water leakage sensor

* **Note:** Requires embedded ZigBee or a VCM8000V5045P.

2. 2 HEATING / 2 COOLING FOR ROOFTOP UNIT AND INDOOR AIR QUALITY

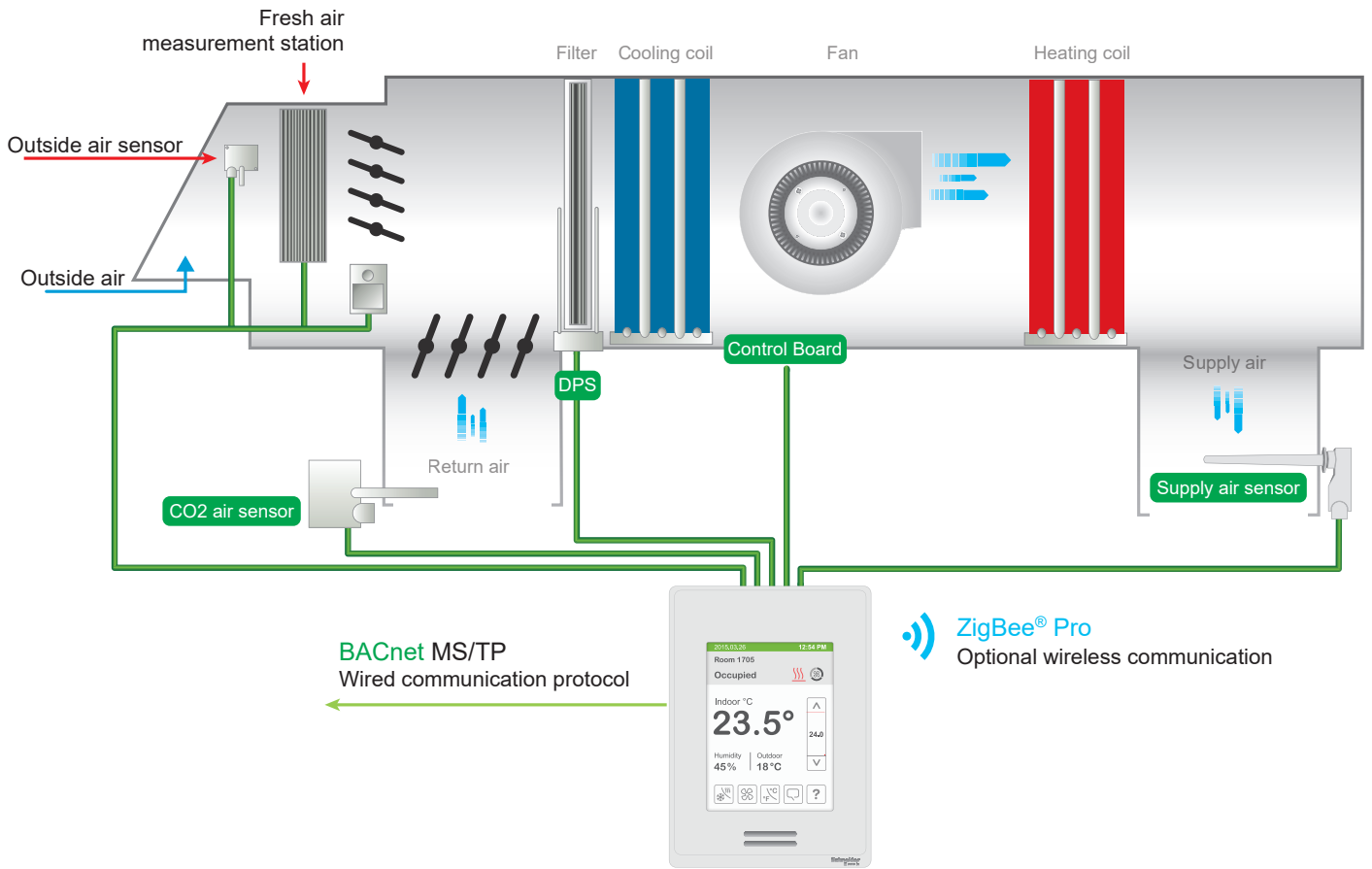

Configuration Parameter Name	Configuration Settings
UI17	Filter
UI19	CO2
Econo. Config	On
FA Range	Set Max CFM, cannot be zero
Min fresh air	Set Min CFM, cannot be zero
Max fresh air	Set Max CFM, cannot be zero
Min CO2	Set Min CO2, cannot be zero
Max CO2	Set Max CO2, cannot be zero

Note: Only required configuration parameters are listed. Other settings are configurable as needed by user.

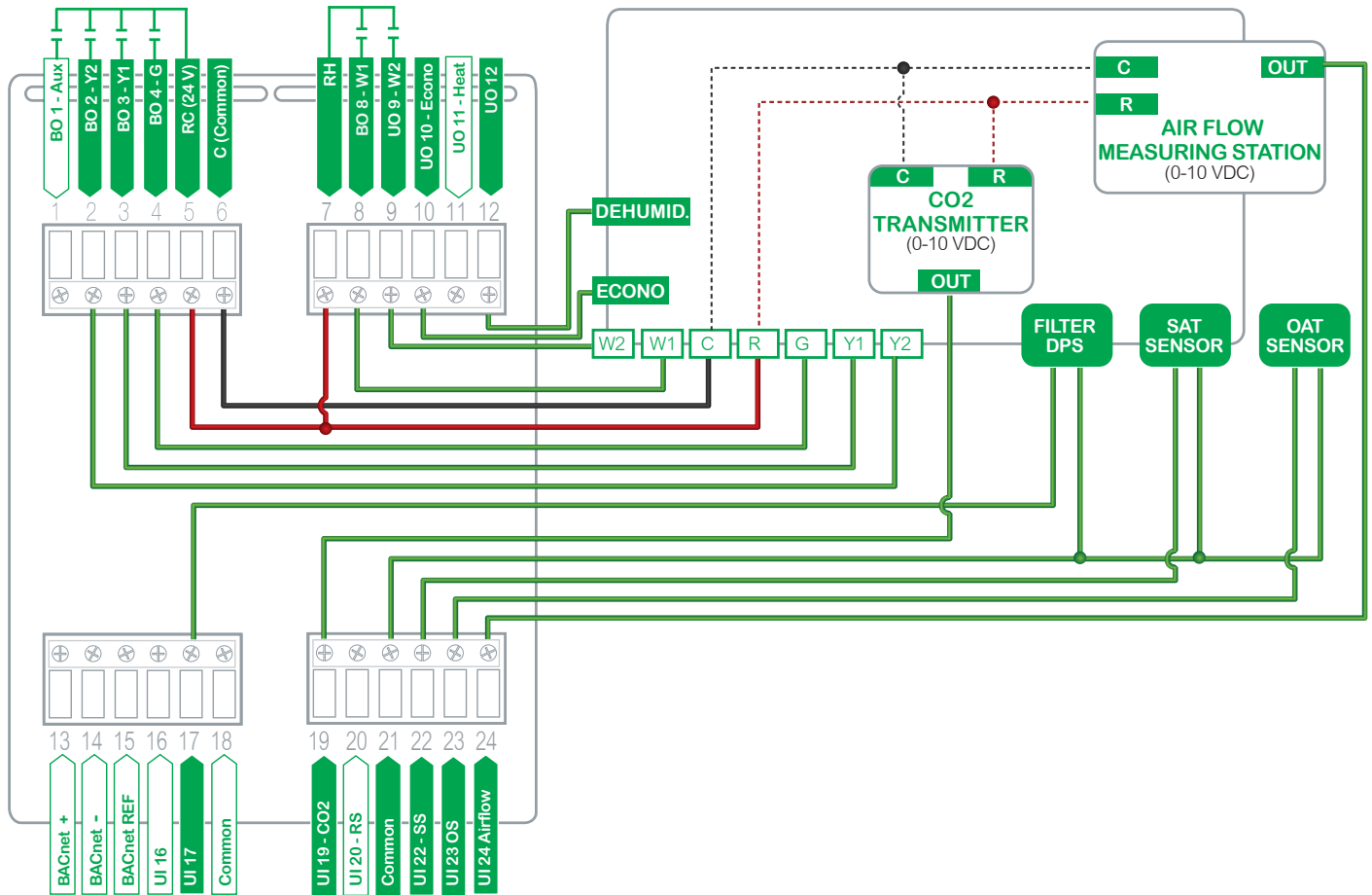

Sequence of Operation and Wiring

Occupied Mode

Setpoints revert to those defined by occupied cooling and heating.

Stand-by Mode (only available when PIR motion detector sensor is used)

Setpoints revert to those defined by stand-by cooling and heating.

Unoccupied Mode

Setpoints revert to those defined by unoccupied heating and cooling.

Occupied Override Mode

System reverts to occupied mode for duration determined by "ToccTime" parameter.

In all occupancy Modes

If a room relative humidity is higher than the user-defined Dehumidification setpoint, both Dehum. (UO12) and Fan (BO4) outputs are energized to reach the setpoint and the thermostat's Cooling and Heating outputs will not trigger.

*A multi-pole relay may be required to activate Cooling and Heating stage(s).

Options

- SE8650 Room Controllers that do not have a built-in wireless adapter module may be fitted with a plug-in wireless adapter module. (see Appendix A for network wiring).
- 3 universal inputs can be used and configured for advanced functionality as required by the application.

3. 2 COOLING / MODULATING HEAT FOR ROOFTOP UNIT AND INDOOR AIR QUALITY

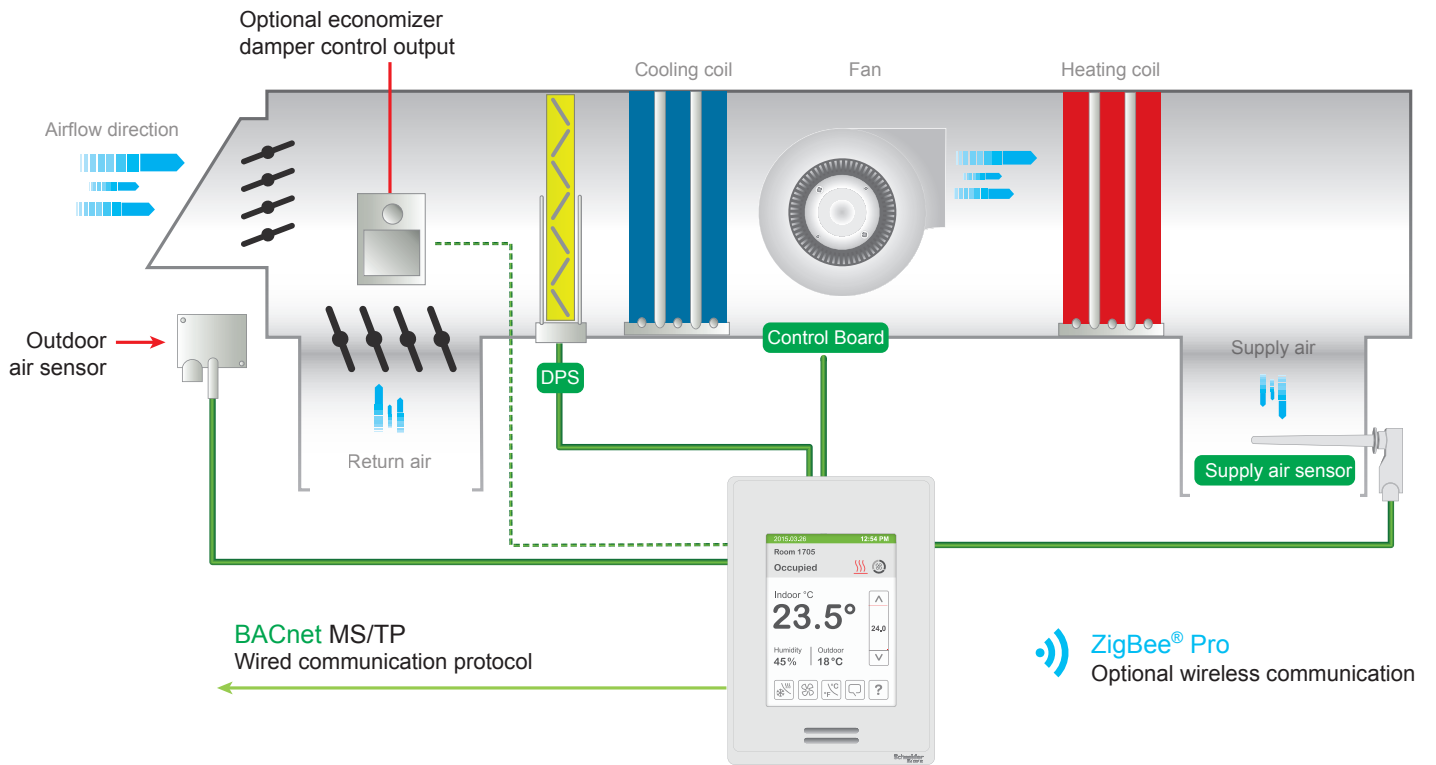

Configuration Parameter Name	Configuration Settings
UI17	Filter
UI19	CO2
Econo. Config	On
FA Range	Set Max CFM, cannot be zero
Min fresh air	Set Min CFM, cannot be zero
Max fresh air	Set Max CFM, cannot be zero
Min CO2	Set Min CO2, cannot be zero
Max CO2	Set Max CO2, cannot be zero

Note: Only required configuration parameters are listed. Other settings are configurable as needed by user.

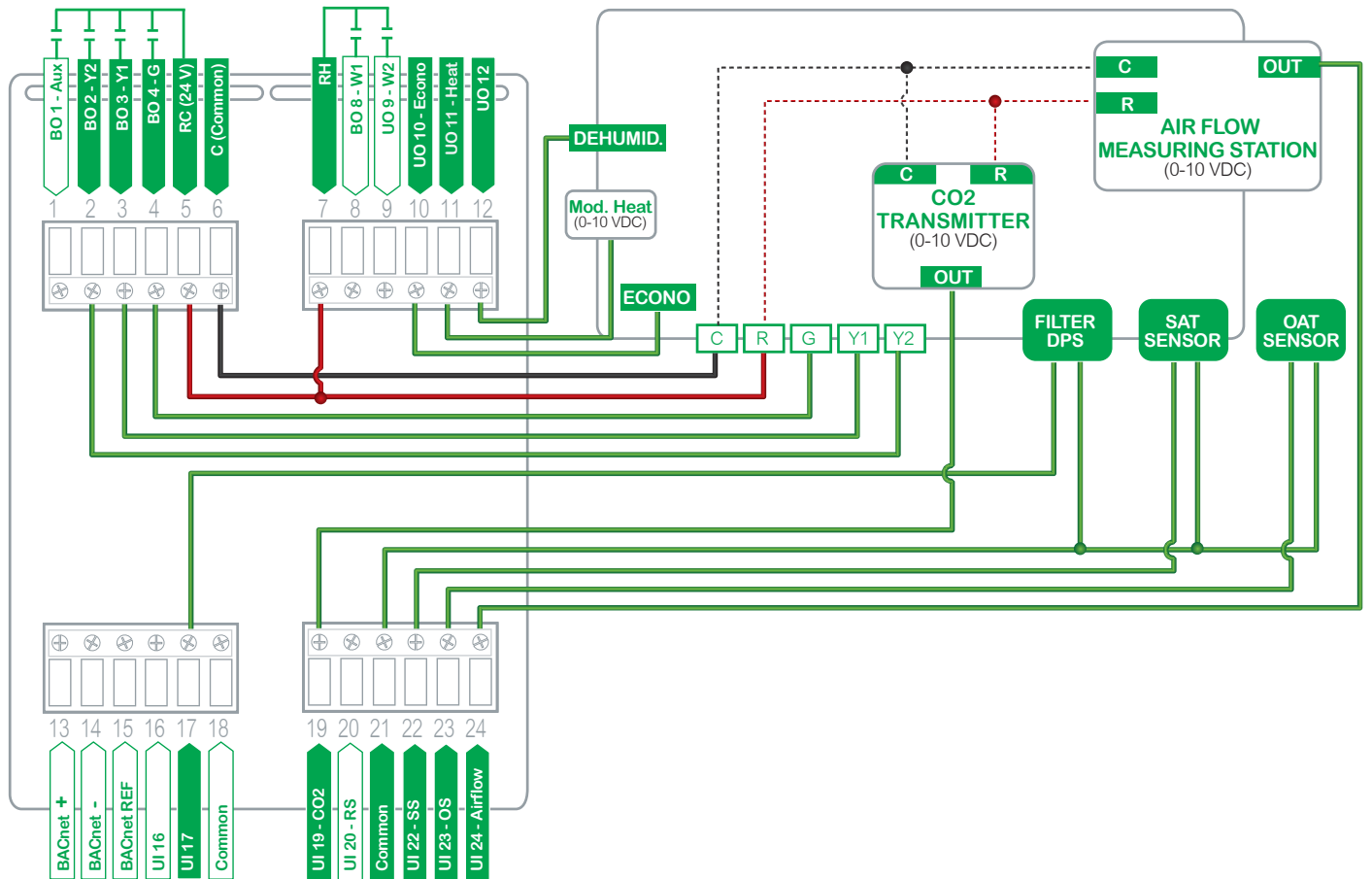

Sequence of Operation and Wiring

Occupied Mode

Setpoints revert to those defined by occupied cooling and heating.

Stand-by Mode (only available when PIR motion detector sensor is used)

Setpoints revert to those defined by stand-by cooling and heating.

Unoccupied Mode

Setpoints revert to those defined by unoccupied heating and cooling.

Occupied Override Mode

System reverts to occupied mode for duration determined by "ToccTime" parameter.

In all occupancy Modes

If a room relative humidity is higher than the user-defined Dehumidification setpoint, both Dehum. (UO12) and Fan (BO4) outputs are energized to reach the setpoint and the thermostat's Cooling and Heating outputs will not trigger.

*A multi-pole relay may be required to activate Cooling and Heating stage(s).

Options

- SE8650 Room Controllers that do not have a built-in wireless adapter module may be fitted with a plug-in wireless adapter module. (see Appendix A for network wiring).
- 3 universal inputs can be used and configured for advanced functionality as required by the application.

4. FRESH AIR DAMPER CONTROL SEQUENCES

4.1 PRESSURE INDEPENDENT (PI)

The fresh air damper can be controlled through more than one sequence to achieve different control strategies such as free cooling (economizer mode), minimum fresh air control and CO2 level control. Here are the control sequences available:

Note: For the sequences mentioned below, the following conditions must be met in order for the sequences to be performed as stated:

- Max Pos parameter value must be greater than Min Pos Parameter value.
- Mac CO2 parameter value must be greater than Min CO2 Parameter value.
- Max FA parameter value must be greater than Min FA Parameter value.

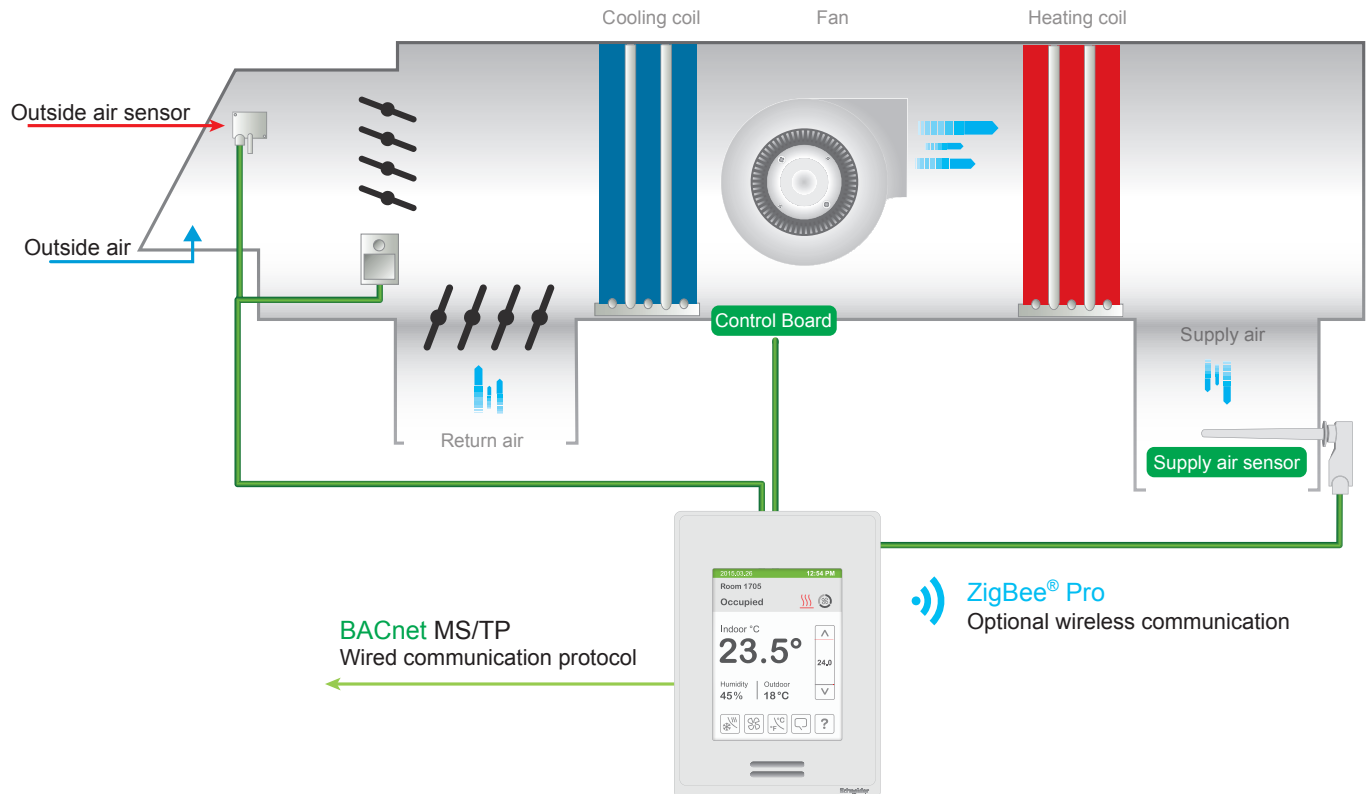

ECONOMIZER CONTROL MODE ONLY

If the fresh air damper is to be used only for free cooling purposes (economizer mode, without fresh air measurement station or CO2 control), only the Min Pos parameter and the free cooling sequence will be active.

- The FA Range parameter should be set to 0 CFM. (Default Value = 0 CFM)
- Set the Chngstpt parameter to desired value which free cooling is enabled. (Default Value = 55°F)

If the outside air temperature is greater than the changeover setpoint, then normal mechanical cooling will be used. If the outside air temperature is less than or equal to the changeover setpoint, then free cooling will be enabled and mechanical cooling stages will be locked out.

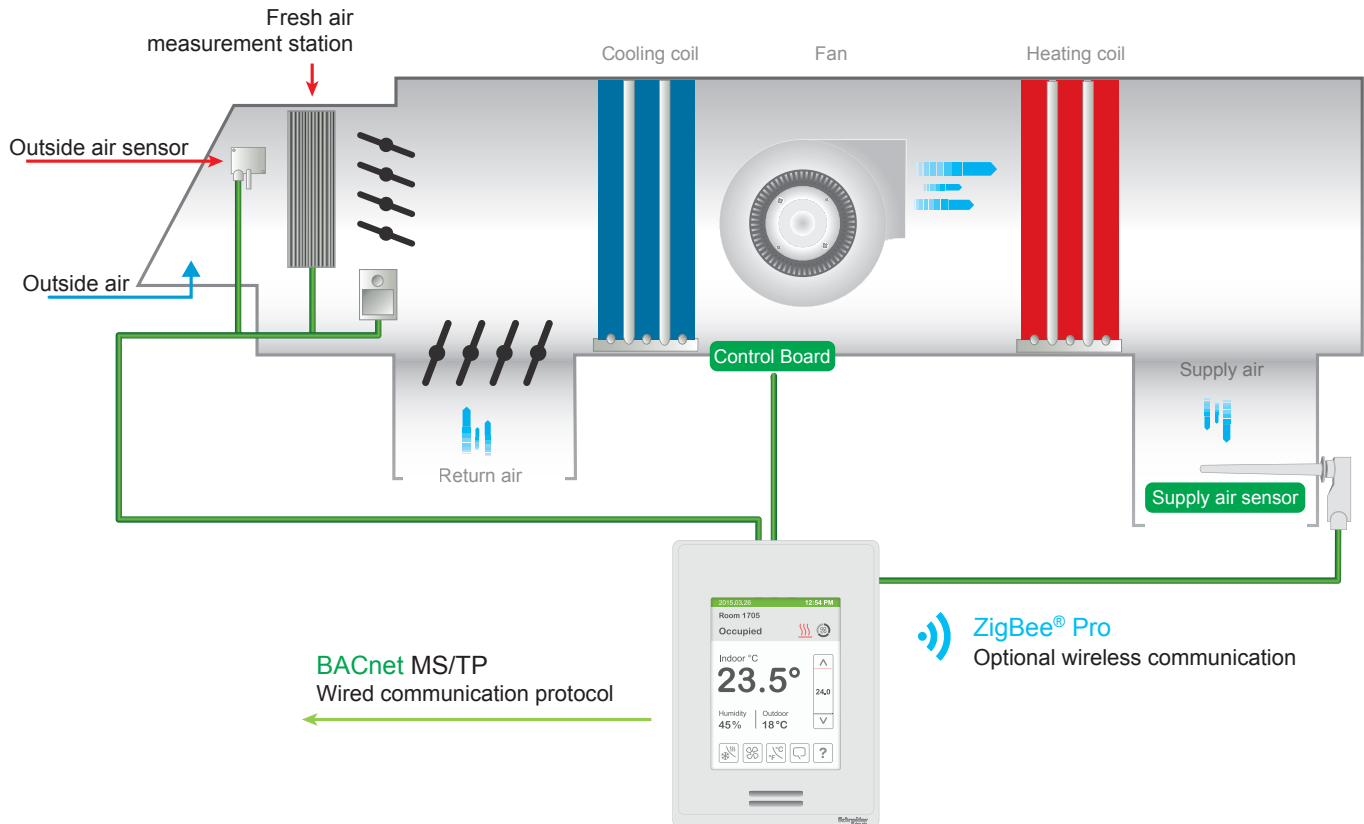

ECONOMIZER CONTROL MODE AND FRESH AIR MEASUREMENT STATION

If the fresh air damper is to be used for both free cooling and minimum fresh air volume control (economizer mode and fresh air measurement station, but without CO2 level control), only the Min FA parameter and the free cooling sequence will be active.

- The FA Range parameter should be set to a value higher than 0 CFM (0 CFM disables the fresh air control).
- Min FA (minimum fresh air) parameter should be set to the desired level.

The FA Range parameter value should be set to the maximum capacity of the fresh air measurement station. Therefore the relationship between air volumes and input signals can be established. For example, if the fresh air station capacity is 10000 CFM, set FA Range to 10000.

This will set the relationship of 0 VDC = 0 CFM and 10VDC = 10000 CFM.

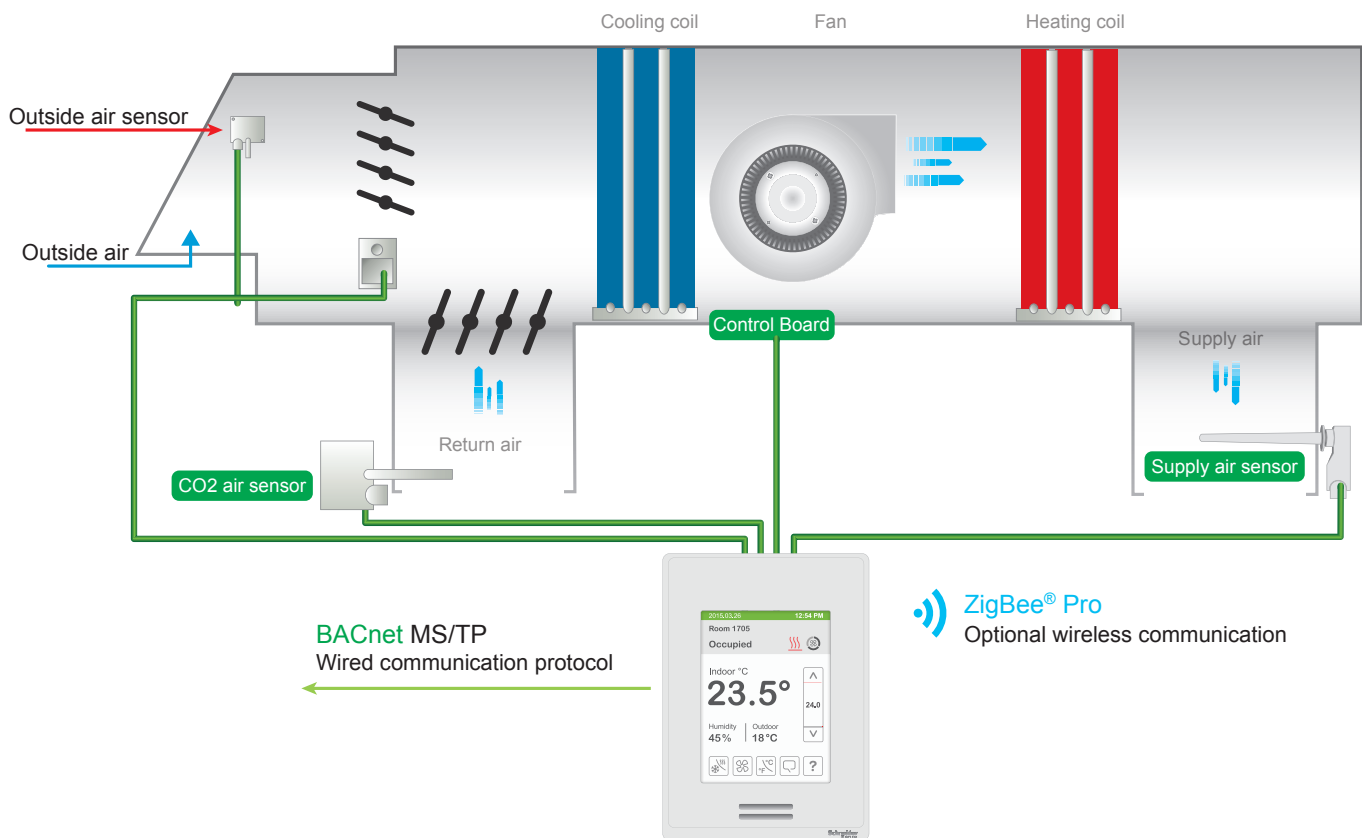

ECONOMIZER CONTROL MODE AND CO2 LEVEL CONTROL

If the fresh air damper is to be used for both free cooling and CO2 level control (economizer mode and CO2 level control, but without fresh air measurement station), only the Min Pos, Max Pos, Min CO2 and Max CO2 parameters as well as the free cooling sequence will be active.

- The FA Range parameter should be set to 0 CFM.
- Set AI1 parameter to CO2 (0 VDC = 0ppm ; 10VDC = 2000ppm)
- Min Pos, Max Pos, Min CO2 and Max CO2 parameters should be set according to the required setting.

The highest value between free cooling demand output and interpolation output for the fresh air setpoint will be the output to the fresh air damper.

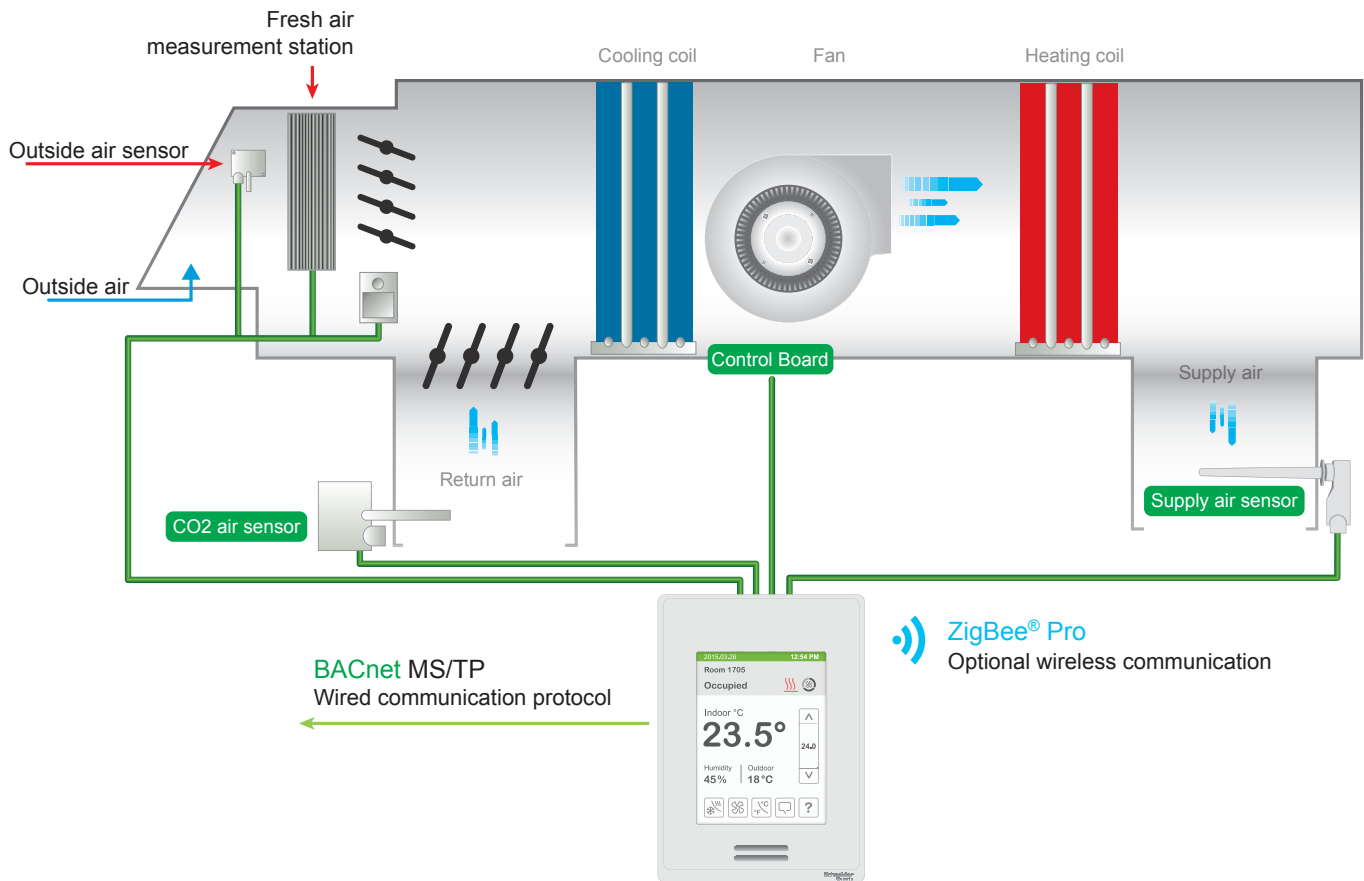
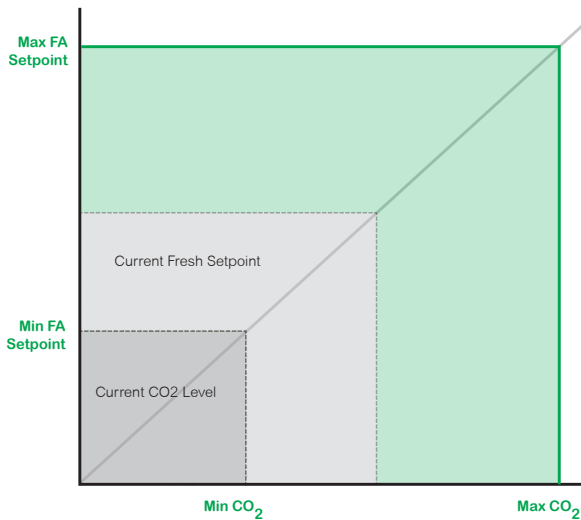

ECONOMIZER CONTROL MODE, CO₂ LEVEL CONTROL AND FRESH AIR MEASUREMENT STATION

If the fresh air damper is to be used for both free cooling and CO₂ level control with a fresh air measurement station, only the Min FA, Max FA, Min CO₂ and Max CO₂ parameters as well as the free cooling sequence will be active.

- The FA Range parameter should be set to something other than 0 CFM.
- Use an air flow transmitter to read fresh air level with AI2 input (0-5 VDC input)
- Min FA, Max FA, Min CO₂ and Max CO₂ parameters should be set according to the required setting.

The highest value between free cooling demand output and interpolation output for the fresh air setpoint based on the CO₂ level will be the output to the fresh air damper.

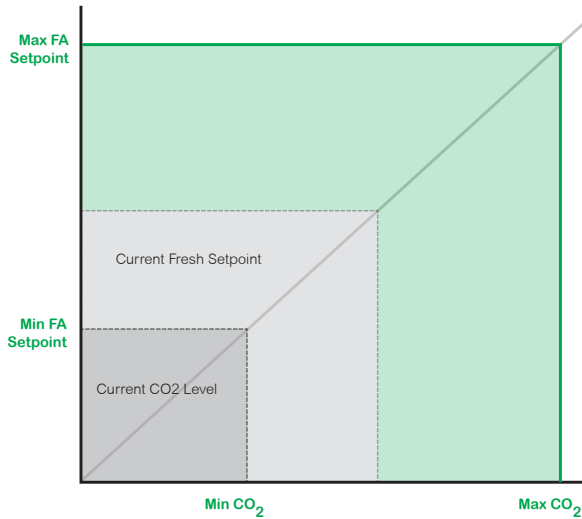

APPENDIX A. OPTIONAL NETWORK SET-UP

BACnet communication wiring:

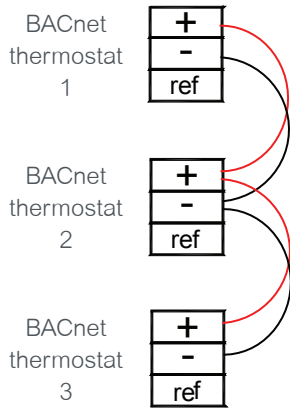

Wireless communication:



No communication wires required

Notes:

- Wiring should be daisy chained
- Respect polarity
- If using 2 conductors shielded wires, connect the shield of each feed together on the back of the controller. ONLY ground the shield at one location. DO NOT connect the shield to the ref terminal.

APPENDIX B. WIRELESS SENSORS

B.1 WIRELESS ZIGBEE® PRO MOTION SENSORS

Room Controllers with SED Series ZigBee® Pro wireless switches can be used in stand-alone mode, or with integration to a central management system, to allow for advanced functions such as central reservation and occupancy functions. Up to twenty different ZigBee motion sensors and switches (SED-WDC, SED-WMS, SED-MTH, or SED-WLS) can be used with a Room Controller

Note that if a ZigBee wireless window switch is used, the Room Controller cannot also use a remote PIR motion sensor, whether wired or wireless. Using one or more wireless remote PIR motion sensors means that a wired PIR motion sensor cannot be used, and vice versa.

The SED Series sensors are factory delivered with batteries and are ready to be installed, configured, and used right out of the box. Due to the extremely small current consumption of the sensors, the expected battery life is approximately 10 years, which is equivalent to the battery shelf life.

B.2 MODEL SELECTION

Window Switch	Door Switch
Wireless window/door sensor	SED-WDC-G-5045
Wireless wall mounted motion sensor	SED-WMS-P-5045
Wireless motion/temperature/humidity sensor	SED-MTH-G-5045
Wireless water leakage sensor	SED-WLS-G-5045

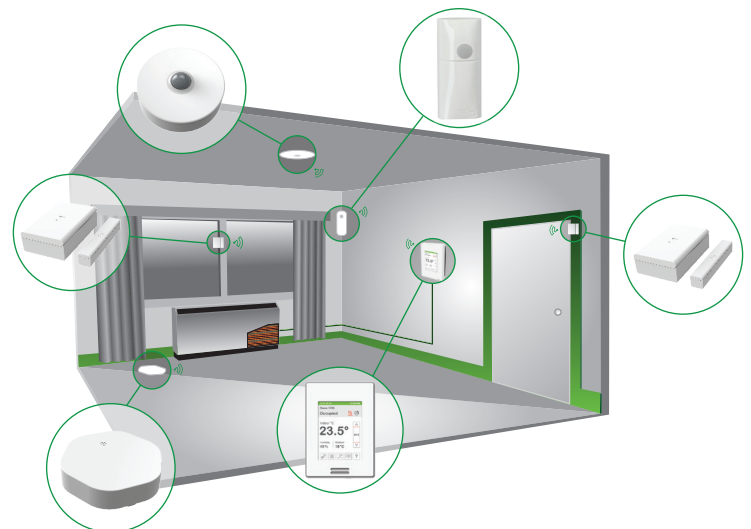

APPENDIX C. SCHEMATIC OF CONTROLLERS OCCUPANCY SEQUENCE OF OPERATION WITHOUT DOOR SENSOR

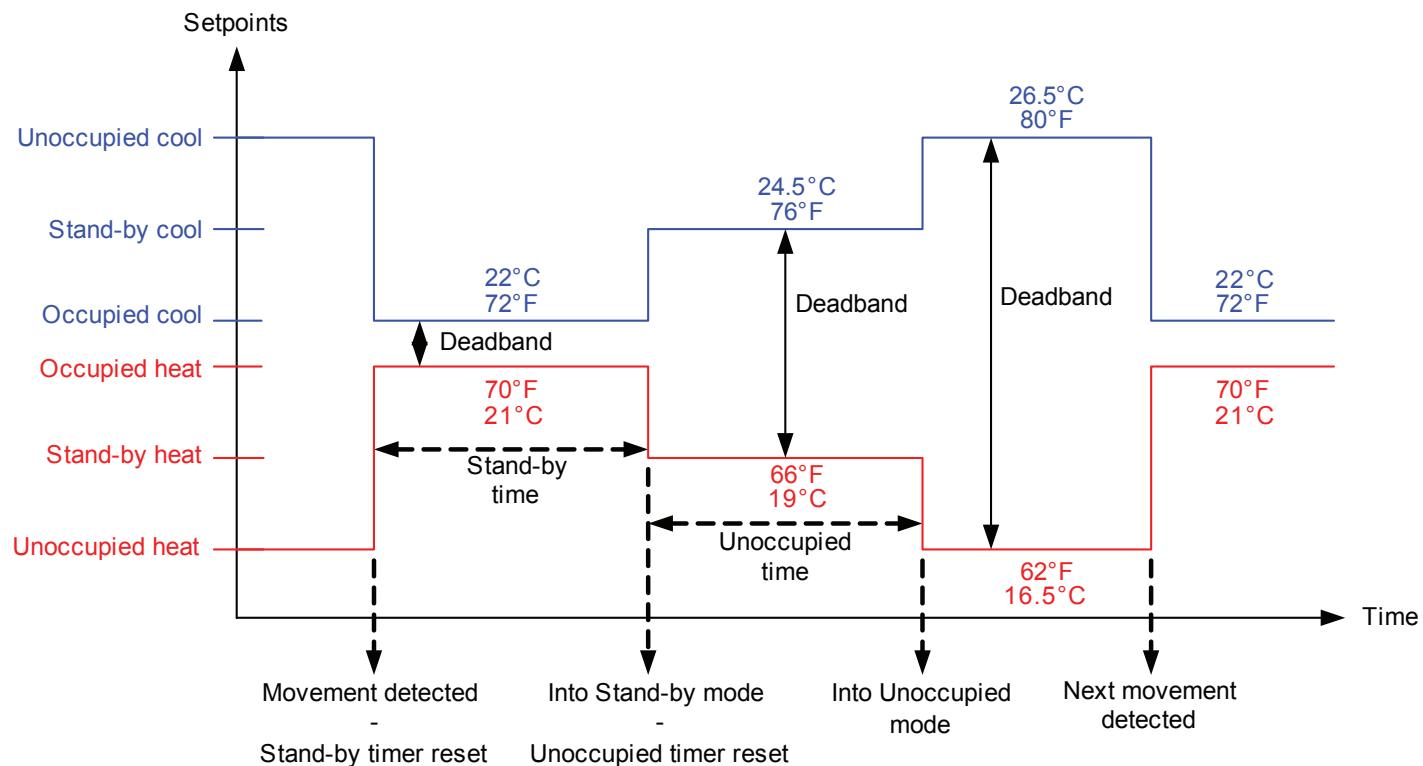

APPENDIX D. DEPLOYMENT

Placement of the Room Controller must be given consideration. It is recommended to install the Room Controller as close to a door as possible (but not so as to be blocked by the door), or in an area with high occupant movement.

Ideally the Room Controller should be installed 5 feet (1.5 meters) above the floor surface to ensure maximum detection range is achieved. As well, Room Controller placement should ensure the occupant crosses the lens beam in a perpendicular path within the prescribed detection zone.

D.1 EXAMPLE OF RECOMMENDED DEPLOYMENT

The below shows Room Controllers installed in ideal locations for two rooms.

The examination room shows one Room Controller installed adjacent to the door. In this area of the room, occupant traffic is high and ensures the occupant will almost always cross the PIR detection path laterally and within the detection range.

The waiting room shows one Room Controller installed beside a door in the middle of the room. As shown in the diagram below, occupant traffic is high in several areas of the room including the entrance, waiting room, access to the door and activity around the reception desk. Moreover, for each case aforementioned, occupant movement almost always moves lateral to the PIR, which ensures detection by the PIR, as well as respecting the PIR detection range of 20 feet (6 meters) at 140°, and 16 feet (5 meters) between 15° to 30° laterally.

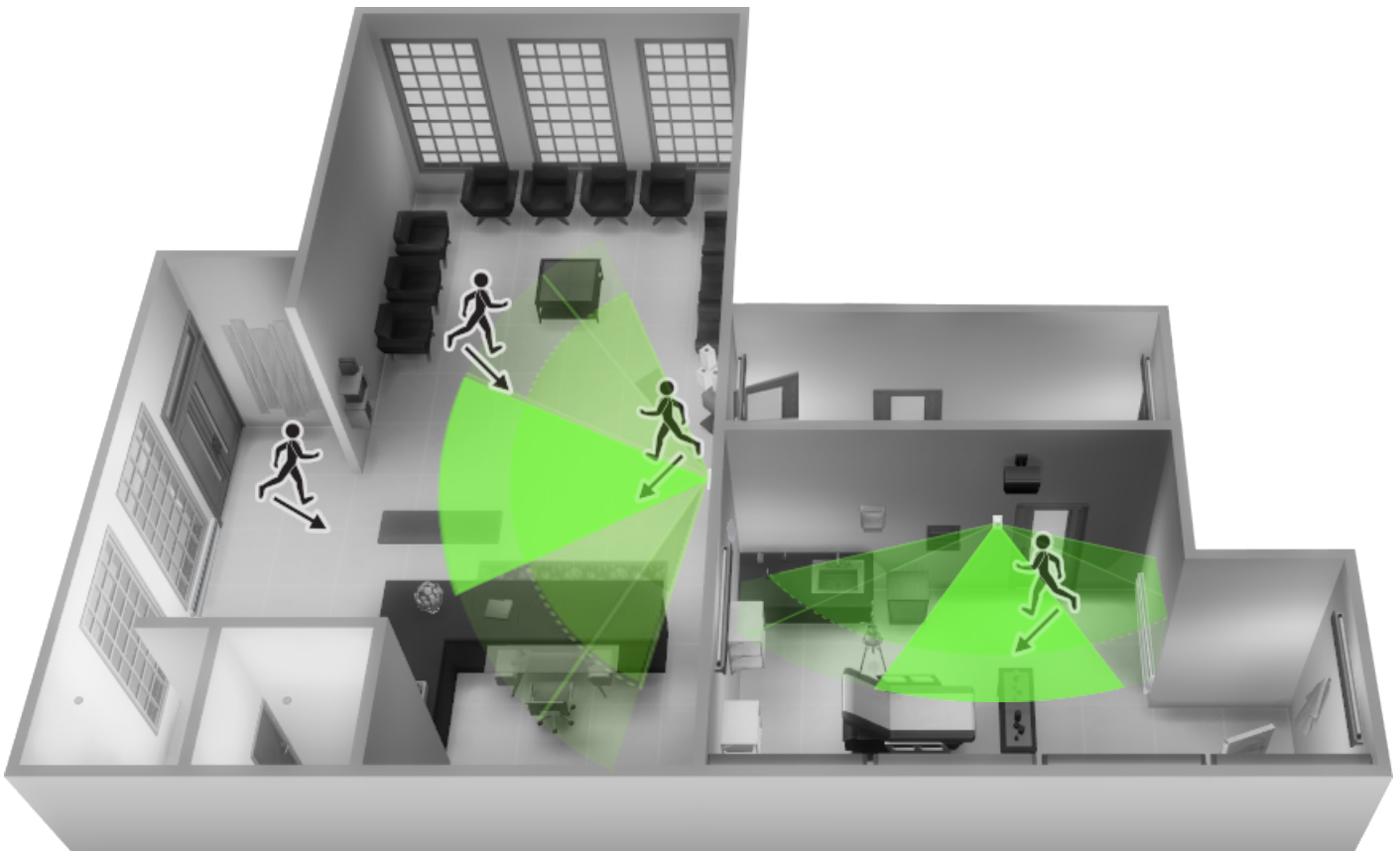

Recommended Installation

D.2 EXAMPLE OF NON-RECOMMENDED DEPLOYMENT

The below shows four Room Controllers (two for each room) installed in non-ideal locations for the two rooms.

The examination room shows one Room Controller installed in a low traffic area near the door, and a second Room Controller installed on the wall directly opposite the door. For the Room Controller installed in the corner wall, the PIR could be blocked by the opened door, while occupant traffic could also be minimal in this area of the room. For the second Room Controller installed opposite the door, the PIR detection could fall outside the specified detection zone, while at the same time most occupant movement would be not be lateral to the PIR, thereby not respecting optimal crossing patterns for PIR detection.

The waiting room shows one Room Controller installed in the corner of the room, and a second Room Controller installed beside the reception area. For the Room Controller installed in the corner, the opening/closing of the door creates high probability that the PIR would get blocked, and therefore, occupancy going undetected. For the Room Controller installed beside the reception area, occupant traffic could fall outside the detection zone, and the receptionist would often be below the 5 foot recommended installation height for the Room Controller.

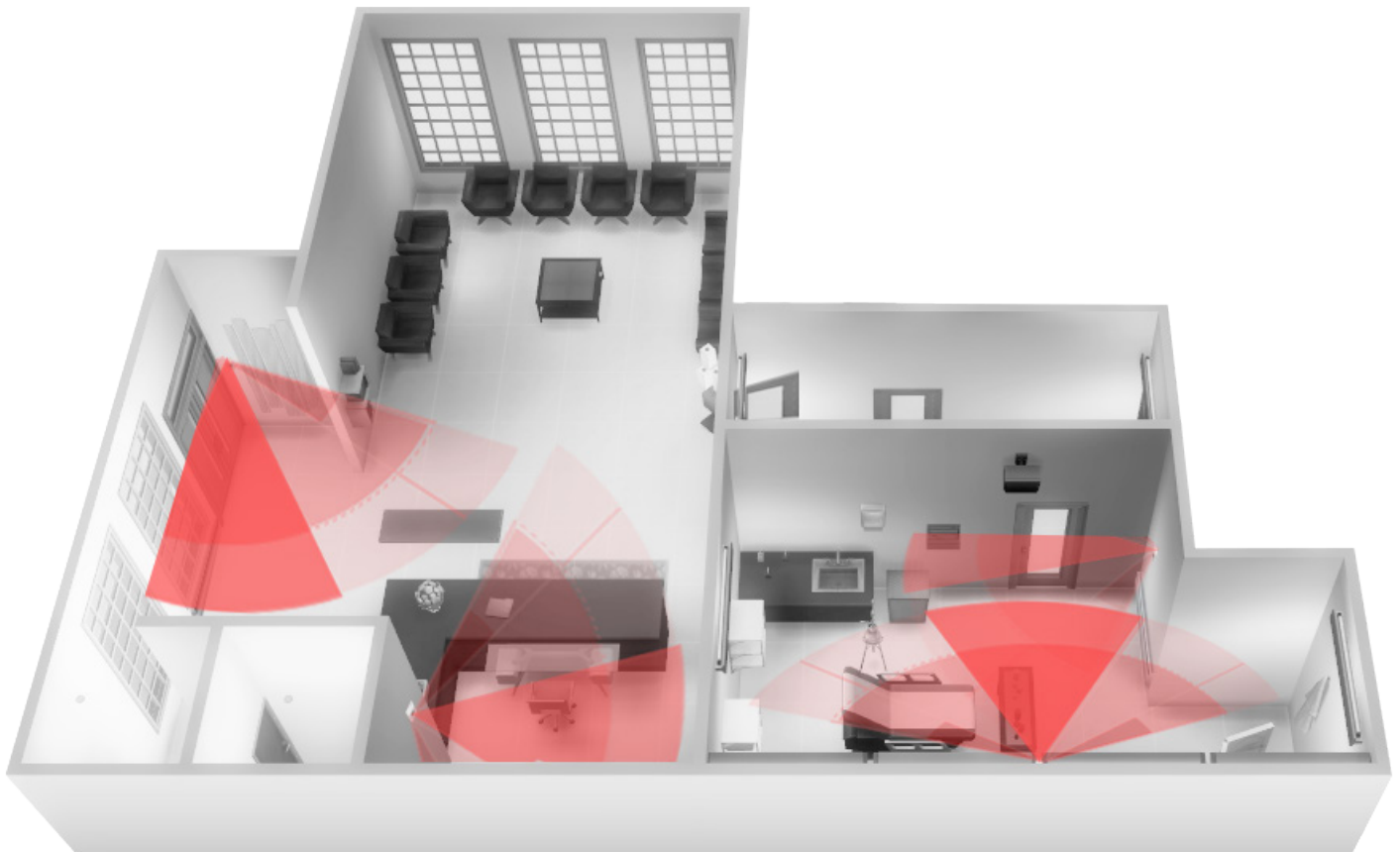

Non-Recommended Installation

D.3 ROOM CONTROLLER PIR SENSOR DETAILS

The internal Room Controller PIR sensor only detect lateral movement. It cannot detect movement when a person is moving toward it. It will not detect someone seating on a chair and/or lying on the bed.

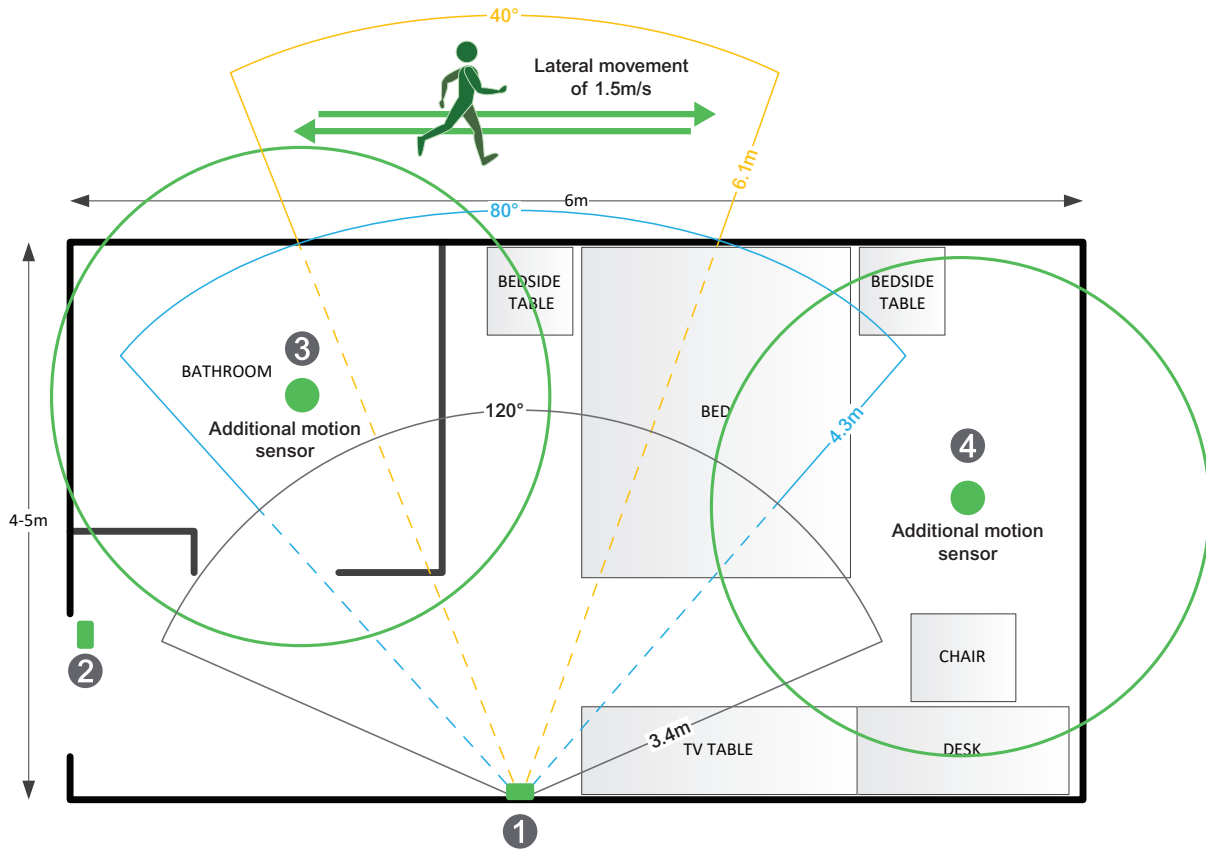

D.4 RECOMMENDATIONS FOR INSTALLATIONS

1. Install the Room Controller to cover more lateral movement.
2. Install a door sensor, the internal Room Controller occupancy logic works better with a door sensor. Once a motion is detected after a door is opened, the room stays in occupied state until the door is opened again which put the Room Controller in stand-by mode and if there is a motion then it goes back in occupied mode. It is also recommended to disable the unoccupied mode, set the unoccupied time to 0, so there is only 2 modes in the Room Controller: stand-by and occupied for a stand-alone solution. Please refer to the two(2) diagrams below for the Room Controller internal occupancy states transition.

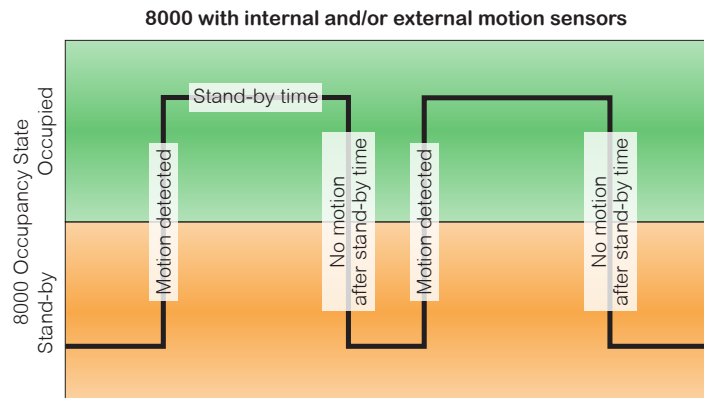

More aggressive energy savings logic but may cause bad guest experience (when guest is sleeping or not moving)

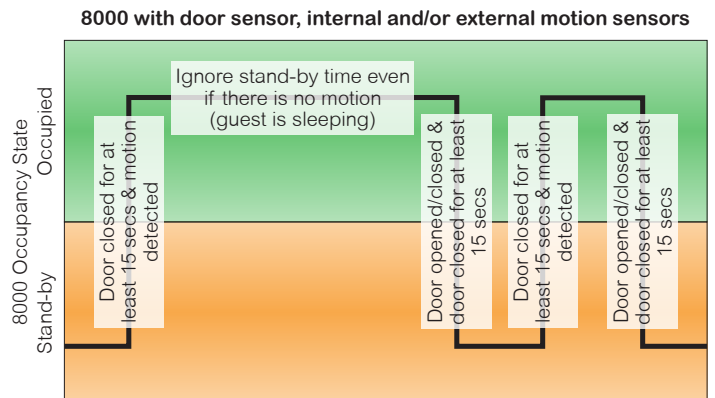

Good energy savings logic and better guest experience even when the guest is sleeping or not moving

3. Install additional motion sensor in the bathroom.
4. Install additional motion sensor for better motion detection in the entire room.

D.5 ENERGY SAVINGS

PIR can maximize your energy saving from 10-30% by adjusting temperature set points in unoccupied zones during scheduled periods.

PIR can maximize your energy saving from 10-30% by adjusting temperature set points in unoccupied zones during scheduled periods.

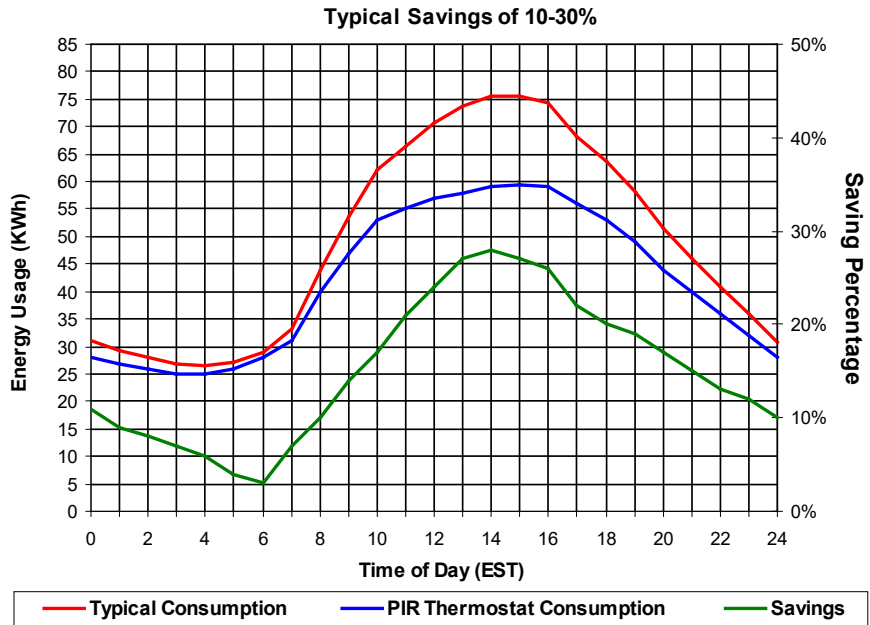

APPENDIX E. TERMINAL CORRESPONDENCE

The terminals of an SE8650 are identified differently and have a wider range of possible functions compared to those of any of the SE7000 Room Controllers. Nonetheless, there is a direct correspondence of functions between the terminals of the SE7000 and the SE8650. Consult the table below to verify the appropriate terminal when replacing a SE7000 Room Controller with a SE8650 Room Controller.

SE7000		SE8650	
Terminal name	Terminal ID	Terminal name	Terminal ID
Binary Input 1	BI1	Universal Input 16	UI16
Binary Input 2	BI2	Universal Input 17	UI17
Universal Input 3	UI3	Universal Input 19	UI19
Sensor Common	Scom	Terminal 18 Common	COM
Remote Sensor	RS	Universal Input 20	UI20 - RS
Sensor Common	Scom	Terminal 21 Common	COM
Mix/Supply Sensor	MS	Universal Input 22	UI22 - SS

Technical Support



For any issues with SmartStruxure Solution or SmartStruxure Lite, contact Schneider Electric Technical Support according to your region.

North America (NAM) Product Support
Building Management Systems (BMS): www.nampss.com

Global Product Support
Building Management Systems (BMS): productsupport.BMS@schneider-electric.com

Schneider Electric
CS 30323
F-92506 Rueil-Malmaison Cedex
France

Schneider Electric is leading the Digital Transformation of Energy Management and Automation in Homes, Buildings, Data Centers, Infrastructure and Industries.

With global presence in over 100 countries, Schneider is the undisputable leader in Power Management – Medium Voltage, Low Voltage and Secure Power, and in Automation Systems. We provide integrated efficiency solutions, combining energy, automation and software.

In our global Ecosystem, we collaborate with the largest Partner, Integrator and Developer Community on our Open Platform to deliver real-time control and operational efficiency.

We believe that great people and partners make Schneider a great company and that our commitment to Innovation, Diversity and Sustainability ensures that Life Is On everywhere, for everyone and at every moment.

www.schneider-electric.com