



Z208152-0J

**i** The PowerLogic™ HDPM6000 series Low-Voltage Current Transducers (LVCT) provide secondary AC voltage proportional to the primary (sensed) alternating current. For use with the HDPM6000 platform only, these current transducers provide a means to transform electrical service amperages to a voltage compatible with monitoring equipment.

Refer to the following installation guides (part number):

HDPM6000B (Z208131), HDPM6000 Head Unit (Z208128), HDPM6000 I/O Module (Z208142),

HDPM6000R (Z208129), HDPM6000S24 (Z208449) and HDPM6000S (Z208130).

[www.se.com](http://www.se.com)  
HDPM6000 Series Current Transducer Models



## 1 Safety information

### Important Information

Read these instructions carefully and look at the equipment to become familiar with the device before trying to install, operate, service or maintain it. The following special messages may appear throughout this bulletin or on the equipment to warn of potential hazards or to call attention to information that clarifies or simplifies a procedure.



The addition of either symbol to a “Danger” or “Warning” safety label indicates that an electrical hazard exists which will result in personal injury if the instructions are not followed.



This is the safety alert symbol. It is used to alert you to potential personal injury hazards. Obey all safety messages that follow this symbol to avoid possible injury or death.

### **⚠ ⚠ DANGER**

**DANGER** indicates a hazardous situation which, if not avoided, **will result in death or serious injury**.

### **⚠ WARNING**

**WARNING** indicates a hazardous situation which, if not avoided, **could result in death or serious injury**.

### **⚠ CAUTION**

**CAUTION** indicates a hazardous situation which, if not avoided, **could result in minor or moderate injury**.

### **NOTICE**

**NOTICE** is used to address practices not related to physical injury.

### Please Note

Electrical equipment should be installed, operated, serviced and maintained only by qualified personnel. No responsibility is assumed by Schneider Electric for any consequences arising out of the use of this material. A qualified person is one who has skills and knowledge related to the construction, installation and operation of electrical equipment and has received safety training to recognize and avoid the hazards involved.

Installation, wiring, testing and service must be performed in accordance with all local and national electrical codes.

**Schneider Electric assumes no responsibility for damage of equipment or personal injury caused by products operated on circuits above their published ratings.**

## 2 Safety precautions

### **⚠ ⚠ DANGER**

#### **HAZARD OF ELECTRIC SHOCK, EXPLOSION, OR ARC FLASH**

- Apply appropriate Personal Protective Equipment (PPE) and follow safe electrical work practices. See NFPA 70E in the USA or applicable local standards.
- The equipment must be installed and serviced only by qualified electrical personnel.
- Turn off all power supplying the equipment before working on or inside the equipment.
- Product may use multiple voltage/power sources. Disconnect all sources of power before servicing.
- Always use a properly rated voltage sensing device to confirm power is off.
- Do not use data from this device to confirm power is off.
- Read, understand, and follow the instructions before installing this product.
- Products rated for basic insulation must be installed on insulated conductors only.
- Replace all doors, covers and protective devices before powering the equipment.
- Install the device in an appropriate electrical and fire-rated enclosure as per local regulations.
- To reduce the risk of electric shock, always disconnect the circuit from the power-distribution system (or service) before installing or servicing current transformers.
- Do not use this device for critical control or protection applications where human or equipment safety relies on the operation of the control circuit.

**Failure to follow these instructions will result in death or serious injury.**

### **⚠ WARNING**

#### **UNINTENDED OPERATION**

Do not use this device for critical control or protection of persons, animals, property, or equipment.

**Failure to follow these instructions may result in death, serious injury, or equipment damage.**

## 2 Safety precautions

### ⚠ WARNING

#### RISK OF INJURY OR EQUIPMENT DAMAGE

- Do not apply current transducer to circuits with phase-to-phase voltage exceeding their rated voltage unless additional insulation is applied between the primary conductor and the transducer.
- Do not install current transducers in a panel where they exceed more than 75% of the wiring space in any cross-sectional area.
- Do not install current transducers near breaker arc venting areas.
- Do not use Class 2 wiring methods or connect current transducers to Class 2 equipment (NFPA 70E in the USA or applicable local standards).
- Do not exceed 120% of the rated primary current.
- Always use a current transducer with an appropriate rating for the application.
- Do not install the current transducers where they may obstruct ventilation openings.
- Secure current transducer and route its lead wires to prevent contact with live terminals or busbars.
- Do not strip insulation from the current transducer lead wires connected to the retrofit module.

**Failure to follow these instructions may result in injury, fire or equipment damage.**

## 3 Ordering information

The connectors for the CTs compatible with HDPM6000 Head Unit, Retrofit module, IO module, and Busway module are provided with the meter. The CTs for these modules are not terminated with any connectors. If the lead length is too long, they can be cut to the desired length without affecting the CT accuracy. Refer to the Installation section for more details.

CTs specifically designed for the HDPM6000S24 and HDPM6000S have a connector pre-installed at the end of the lead wires. Due to the different connector form factor between the HDPM6000S24 and HDPM6000S, a CT designed for the HDPM6000S24 is not compatible with the HDPM6000S, and vice versa. Any HDPM6000 CT that is not factory terminated with a connector can be used with the HDPM6000S24 by using the connectors from METSEHDPMS24CTCON kit.

#### Difference in connector between the HDPM6000S24 and HDPM6000S:

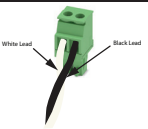
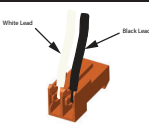
HDPM6000S24		HDPM6000S	
			
HDPM6000S24	✓	HDPM6000S24	✗
HDPM6000S	✗	HDPM6000S	✓
HDPM6000S CTs are provided with factory-terminated connector.			

#### CTs compatible with HDPM6000 Head Unit, HDPM6000R Retrofit Module and I/O Module

Commercial reference / model	Lead length	Weight	Form factor	Accuracy	Description	Type of CT	
METSEHDPM20A12H	12 ft (3.66 m)	1.088 lb (0.494 kg)	SUN2	0.2%	20 A CT	Split-core	
METSEHDPM20A30H	30 ft (9.14 m)	1.946 lb (0.883 kg)					
METSEHDPM75A12	12 ft (3.66 m)	0.350 lb (0.159 kg)	CTMF	1.0%	75 A CT		
METSEHD75A12	12 ft (3.66 m)	0.373 lb (0.169 kg)	CTSR	0.5%			
METSEHDPM75A12H	12 ft (3.66 m)	1.137 lb (0.516 kg)	SUN3	0.2%			
METSEHDPM75A30	30 ft (9.14 m)	0.710 lb (0.322 kg)	CTMF	1.0%			
METSEHD75A30	30 ft (9.14 m)	0.649 lb (0.294 kg)	CTSR	0.5%			
METSEHDPM75A30H	30 ft (9.14 m)	1.996 lb (0.905 kg)	SUN3	0.2%			
METSEHDPM75A60H	60 ft (18.29 m)	2.596 lb (1.177 kg)					
METSEHDPM75A60	60 ft (18.29 m)	2.305 lb (1.046 kg)	CTMF	1.0%			
METSEHD75A60	60 ft (18.29 m)	1.120 lb (0.508 kg)	CTSR	0.5%			
METSEHDPM125A12	12 ft (3.66 m)	0.350 lb (0.159 kg)	CTTG	0.1%	125 A CT		Solid-core
METSEHDPM125A30	30 ft (9.14 m)	0.710 lb (0.322 kg)					
METSEHDP150A30H	30 ft (9.14 m)	2.046 lb (0.928 kg)	SUN3	0.2%	150 A CT	Split-core	
METSEHDP150A60H	60 ft (18.29 m)	2.646 lb (1.200 kg)					
METSEHDPM150A12	12 ft (3.66 m)	1.137 lb (0.516 kg)	SUS4	0.5%			
METSEHDPM150A30	30 ft (9.14 m)	1.996 lb (0.905 kg)					
METSEHDPM150A60	60 ft (18.29 m)	2.595 lb (1.177 kg)					
METSEHD150A12	12 ft (3.66 m)	1.167 lb (0.529 kg)	SUSF (Small)	1.0%			150 A CT, 1 in x 1 in (25.4 mm x 25.4 mm)
METSEHD150A30	30 ft (9.14 m)	2.026 lb (0.919 kg)					
METSEHD150A60	60 ft (18.29 m)	2.625 lb (1.190 kg)					
METSEHDPM250A2T12	12 ft (3.66 m)	0.551 lb (0.250 kg)	SUST2	0.5%	250 A CT		Solid-core
METSEHDP300A12H	12 ft (3.66 m)	1.287 lb (0.584 kg)	SUN4	0.2%	300 A CT		Split-core
METSEHDPM300A12	12 ft (3.66 m)	1.187 lb (0.538 kg)	SUS4	0.5%			
METSEHDPM300A30	30 ft (9.14 m)	2.046 lb (0.928 kg)					
METSEHDPM300A30H	30 ft (9.14 m)	2.146 lb (0.973 kg)	SUN4	0.2%			
METSEHDPM300A60H	60 ft (18.29 m)	2.746 lb (1.245 kg)					
METSEHDPM300A60	60 ft (18.29 m)	2.645 lb (1.200 kg)	SUS4	0.5%			

## CTs compatible with HDPM6000 Head Unit, HDPM6000R Retrofit Module and I/O Module

Commercial reference / model	Lead length	Weight	Form factor	Accuracy	Description	Type of CT
METSEHD300A12	12 ft (3.66 m)	0.727 lb (0.229 kg)	SUSF (Small)	1.0%	300 A CT, 1 in x 1 in (25.4 mm x 25.4 mm)	Split-core
METSEHD300A30	30 ft (9.14 m)	1.069 lb (0.484 kg)				
METSEHD300A60	60 ft (18.29 m)	1.620 lb (0.734 kg)				
METSEHD300A12L	12 ft (3.66 m)	1.646 lb (0.747 kg)				
METSEHD300A30L	30 ft (9.14 m)	2.505 lb (1.136 kg)				
METSEHD300A60L	60 ft (18.29 m)	3.104 lb (1.408 kg)				
METSEHD300A08H	8 ft (2.44 m)	1.996 lb (0.905 kg)	CTTB	0.2%	300 A CT	Solid-core
METSEHDPM400A12	12 ft (3.66 m)	1.287 lb (0.584 kg)	SUS4	0.5%	400 A CT	Split-core
METSEHDPM400A30	30 ft (9.14 m)	2.146 lb (0.973 kg)				
METSEHDPM400A60	60 ft (18.29 m)	2.744 lb (1.245 kg)				
METSEHDPM400A12H	12 ft (3.66 m)	1.387 lb (0.629 kg)	SUN4	0.2%		
METSEHDPM400A30H	30 ft (9.14 m)	2.245 lb (1.018 kg)				
METSEHDPM400A60H	60 ft (18.29 m)	2.945 lb (1.290 kg)	SUSF (Small)	1.0%	400 A CT, 2.5 in x 2.5 in (63.5 mm x 63.5 mm)	
METSEHD400A30L	30 ft (9.14 m)	2.714 lb (1.231 kg)				
METSEHD400A60L	60 ft (18.29 m)	3.313 lb (1.503 kg)				
METSEHDPM500A2T12	12 ft (3.66 m)	0.639 lb (0.290 kg)	SUST2	0.5%	500 A CT	Solid-core
METSEHDPM600A12	12 ft (3.66 m)	0.771 lb (0.350 kg)	SUS4	0.5%	600 A CT	Split-core
METSEHDPM600A30	30 ft (9.14 m)	1.124 lb (0.509 kg)				
METSEHDPM600A60	60 ft (18.29 m)	1.675 lb (0.759 kg)				
METSEHD600A12	12 ft (3.66 m)	1.676 lb (0.760 kg)	SUSF (Small)	1.0%	600 A CT, 3 in x 3 in (76.2 mm x 76.2 mm)	
METSEHD600A30	30 ft (9.14 m)	2.535 lb (1.150 kg)				
METSEHD600A60	60 ft (18.29 m)	3.133 lb (1.421 kg)				
METSEHD800A12	12 ft (3.66 m)	2.075 lb (0.941 kg)				
METSEHD800A30	30 ft (9.14 m)	2.934 lb (1.331 kg)				
METSEHD800A60	60 ft (18.29 m)	3.533 lb (1.603 kg)				
METSEHD1000A30	30 ft (9.14 m)	2.934 lb (1.330 kg)	SUSF (Medium)	1.0%	800 A CT, 4 in x 4 in (101.6 mm x 101.6 mm)	
METSEHD1000A60	60 ft (18.29 m)	3.534 lb (1.602 kg)				
METSEHD1200A30	30 ft (9.14 m)	3.054 lb (1.385 kg)				
METSEHD1200A60	60 ft (18.29 m)	3.654 lb (1.657 kg)				
METSEHD1600A30	30 ft (9.14 m)	3.173 lb (1.439 kg)				
METSEHD1600A60	60 ft (18.29 m)	3.773 lb (1.711 kg)				
METSEHD1600A30L	30 ft (9.14 m)	3.173 lb (1.439 kg)	SUSF (Medium)	1.0%	1000 A CT, 4 in x 4 in (101.6 mm x 101.6 mm)	
METSEHD2000A30	30 ft (9.14 m)	4.650 lb (2.109 kg)				
METSEHD2000A60	60 ft (18.29 m)	5.250 lb (2.380 kg)				
METSEHD2000A30L	30 ft (9.14 m)	4.480 lb (2.032 kg)				
METSEHD3000A30	30 ft (9.14 m)	4.271 lb (1.937 kg)				
METSEHD3000A30L	30 ft (9.14 m)	4.430 lb (2.009 kg)				
METSEHD4000A30	30 ft (9.14 m)	5.289 lb (2.399 kg)	SUSF (Large)	1.0%	4000 A CT, 5 in x 12 in (127 mm x 304.8 mm)	

## CTs compatible with HDPM6000B Busway Module

Commercial reference / model	Lead length	Weight	Form factor	Accuracy	Description	Type of CT
METSEHDPM75A16	16 in (406.4 mm)	0.639 lb (0.290 kg)	CTMF	1.0%	75 A CT	Split-core
METSEHD75A16	16 in (406.4 mm)	0.201 lb (0.091 kg)	CTSR	0.5%		
METSEHDPM125A16	16 in (406.4 mm)	0.140 lb (0.064 kg)	CTTG	0.1%	125 A CT	Solid-core
METSEHDPM150A16	16 in (406.4 mm)	0.928 lb (0.421 kg)	SUS4	0.5%	150 A CT	Split-core
METSEHDPM300A16	16 in (406.4 mm)	0.978 lb (0.444 kg)				
METSEHDPM400A16	16 in (406.4 mm)	1.078 lb (0.489 kg)				
METSEHDPM600A16	16 in (406.4 mm)	1.177 lb (0.534 kg)				

## CTs compatible with HDPM6000S 21 Circuit Strip Module

Commercial reference / model	Lead length	Weight	Form factor	Accuracy	Description	Type of CT
METSEHDPM75A4	4 in (101.6 mm)	0.629 lb (0.285 kg)	CTMF	1.0%	75 A CT terminated with 21 circuit strip module connector	Split-core
METSEHDPM125A10	10 in (254 mm)	0.130 lb (0.059 kg)	CTTG	0.1%	125 A CT terminated with 21 circuit strip module connector	Solid-core
METSEHDPM125A4	4 in (101.6 mm)	0.130 lb (0.059 kg)				
METSEHDPM125A12P	12 in (304.8 mm)	0.130 lb (0.059 kg)				
METSEHDPM150A5	5 in (127 mm)	0.918 lb (0.416 kg)	SUS4	0.5%	150 A CT terminated with 21 circuit strip module connector	Split-core
METSEHDPM300A5	5 in (127 mm)	0.968 lb (0.439 kg)	SUS4	0.5%	300 A CT terminated with 21 circuit strip module connector	Split-core
METSEHDPM400A5	5 in (127 mm)	1.068 lb (0.484 kg)				
METSEHDPM600A5	5 in (127 mm)	1.167 lb (0.529 kg)	SUS4	0.5%	600 A CT terminated with 21 circuit strip module connector	Split-core

### 3 Ordering information

CTs compatible with HDPM600S24 24 Circuit Strip Module						
Commercial reference / model	Lead length	Weight	Form factor	Accuracy	Description	Type of CT
METSEHDPM50A18P	18 in (457.2 mm)	0.104 lb (0.047 kg)	CTTA	0.2%	50 A CT terminated with 24 circuit strip module connector	Solid-core
METSEHD75A4P	4 in (101.6 mm)	0.187 lb (0.085 kg)	CTSR	0.5%	75 A CT terminated with 24 circuit strip module connector	Split-core
METSEHD75A12P	12 in (3.66 m)	0.377 lb (0.171 kg)				
METSEHD75A18P	18 in (457.2 mm)	0.205 lb (0.093 kg)				
METSEHD75A24P	24 in (600 mm)	0.215 lb (0.097 kg)				
METSEHD75A80P	80 in (2.03 m)	0.287 lb (0.130 kg)				
METSEHDPM75A24P	24 in (600 mm)	0.137 lb (0.062 kg)	CTMF	1%		

CTs connector kit for using any CT without connector with the HDPM600S24 Strip Module	
Commercial reference / model	Description
METSEHDPM24CTCON	6 Nos, CT connectors for HDPM600S24 (screw type)

### 4 Application diagram

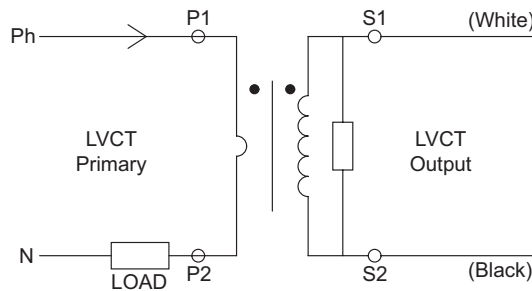

### 5 Specifications

Form factor	Accuracy	Operating temperature range	Storage temperature range	Leads	Altitude of operation	Installation category	Agency approvals
SUN2	0.2%	-40 °F to 131 °F (-40 °C to 55 °C)	-40 °F to 167 °F (-40 °C to 75 °C)	Black and white twisted pair 18 AWG, AWM, UL1015, 600 V, 221 °F (105 °C)	6562 ft (2000 m) max	Cat III, Pollution degree 2	UL2808, CE
SUN3						Cat III, Pollution degree 3	
SUN4						Cat IV, Pollution degree 3	
SUS4	0.5%	-40 °F to 158 °F (-40 °C to 70 °C)	-40 °F to 176 °F (-40 °C to 80 °C)	Black and white twisted pair 22 AWG, AWM, UL1015, 600 V, 221 °F (105 °C)	IEEE C57.13, CAN / CSA-C61869-1:14, CAN / CSA-C61869-2:14, CE		
SUSF	1%	-40 °F to 158 °F (-40 °C to 70 °C)	-40 °F to 176 °F (-40 °C to 80 °C)	Black and white twisted pair 20 AWG, AWM, UL1015, 600 V, 221 °F (105 °C)	IEEE C57.13, CAN / CSA-C61869-1:14, CAN / CSA-C61869-2:14, CE, China RoHS UL2808		
CTMF	1%	-40 °F to 131 °F (-40 °C to 55 °C)	-58 °F to 140 °F (-50 °C to 60 °C)	Black and white twisted pair 18 AWG, AWM, UL1015, 600 V, 221 °F (105 °C)	Cat III, Pollution degree 2	UL2808, CE	
CTSR	0.5%	-40 °F to 122 °F (-40 °C to 50 °C)	-58 °F to 140 °F (-50 °C to 60 °C)	Black and white twisted pair 22 AWG, AWM, UL1015, 600 V, 221 °F (105 °C)	UL recognized, CE		
CTTG	0.1%	-40 °F to 185 °F (-40 °C to 85 °C)	-58 °F to 221 °F (-50 °C to 105 °C)	Black and white twisted pair 18 AWG, AWM, UL1015, 600 V, 221 °F (105 °C)	UL2808, CE		
CTTA	0.2%	-40 °F to 185 °F (-40 °C to 85 °C)	-40 °F to 185 °F (-40 °C to 85 °C)	Black and white twisted pair 22 AWG, AWM, UL1015, 600 V, 221 °F (105 °C)	UL2808, CE		
CTTB	0.2%			Black and white twisted pair 18 AWG, AWM, UL1015, 600 V, 221 °F (105 °C)	UL recognized, CE		
SUST2	0.5%			Black and white twisted pair 18 AWG, AWM, UL1015, 600 V, 221 °F (105 °C)	UL2808, CE		

Following specifications are common for all form factors:

**Output at rated current:** 0.25 VAC

**Frequency range:** 50/60 Hz

**Humidity range:** 0 to 95% noncondensing

**Continuous current rating factor:** 1

**Max. voltage L-N sensed conductor:** 600 VAC

### SUN2, SUN3, SUN4 and SUS4

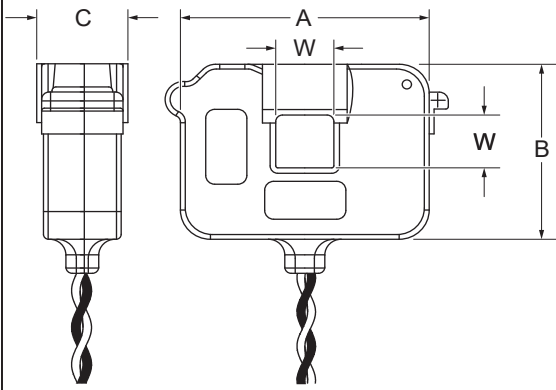

Model	W Window	A Dimension	B Dimension	C Dimension
SUN2	0.4 in (10.17 mm)	2.4 in (60.69 mm)	1.65 in (41.91 mm)	1.15 in (29.21 mm)
SUN3	0.7 in (17.80 mm)	3.0 in (76.19 mm)	2.4 in (60.96 mm)	1.17 in (29.72 mm)
SUN4	1.25 in (31.75 mm)	3.3 in (83.81 mm)	3.1 in (78.74 mm)	1.3 in (31.04 mm)
SUS4	1.25 in (31.75 mm)	3.3 in (83.81 mm)	3.1 in (78.74 mm)	1.3 in (31.04 mm)

### SUSF

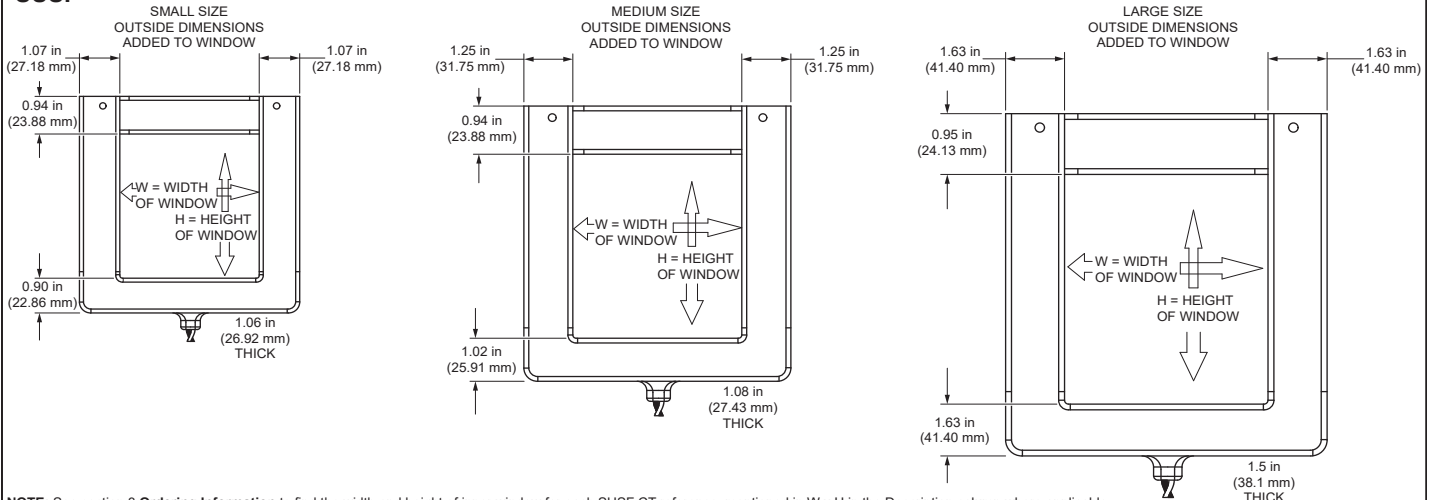

NOTE: See section 3 **Ordering Information** to find the width and height of inner window for each SUSF CT reference, mentioned in W x H in the Description column where applicable.

### CTMF

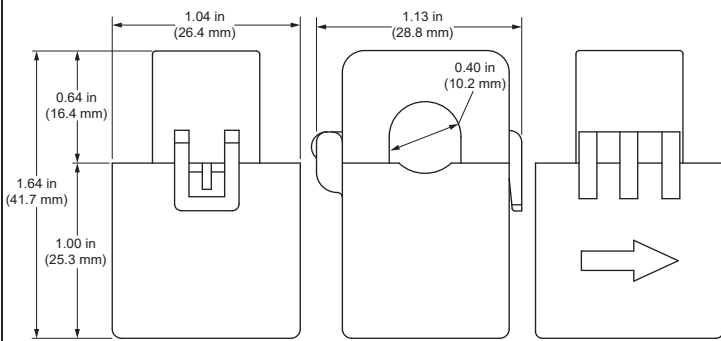

### CTTG

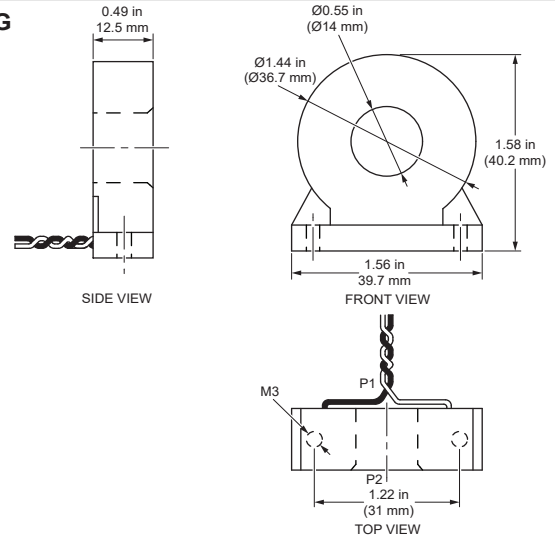

### CTTA

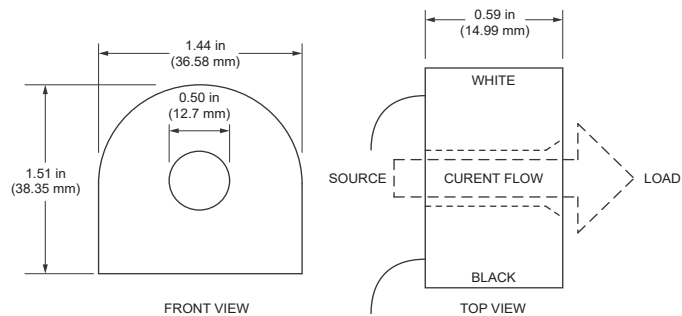

### CTTB

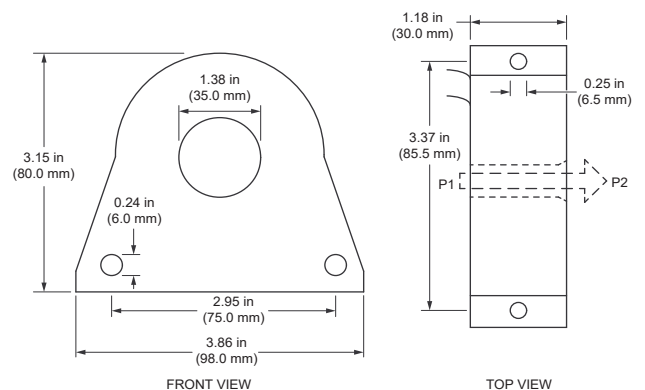

# 6 Dimensions

## SUST2

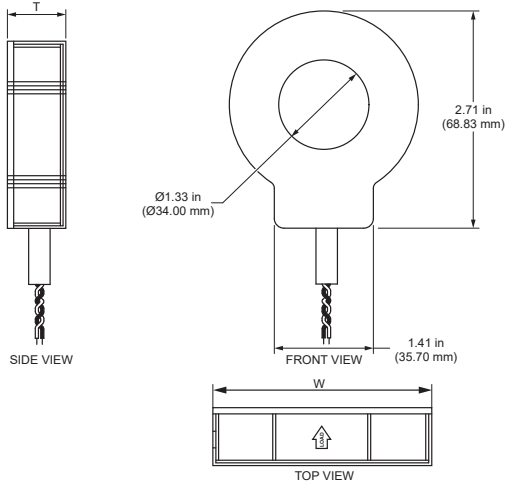

Amperage	T	W
250 A	0.70 in (18.00 mm)	2.52 in (64.00 mm)
500 A	1.37 in (35.00 mm)	2.40 in (61.00 mm)

## CTSR

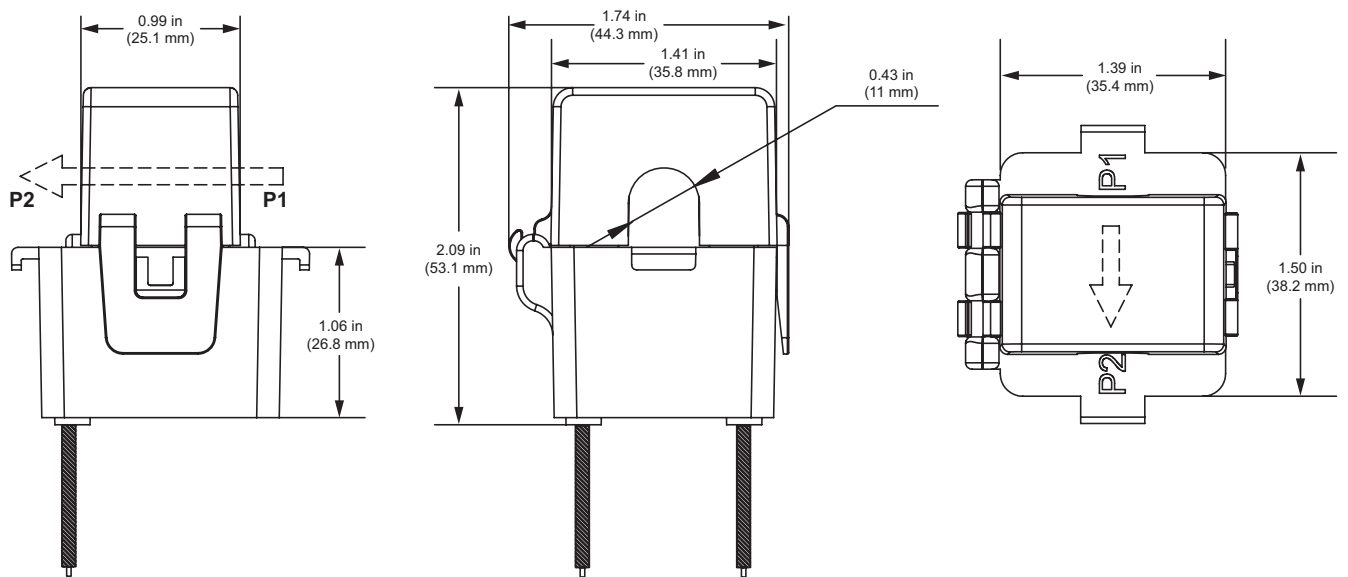

# 7 Installation

## Installation of CTs with HDPM6000

### NOTICE

#### INCORRECT POLARITY OR CT WIRE MISCONNECTION

- Always align the CT so that the arrow points in the direction of power flow. The white lead indicates the positive terminal, and the black lead indicates the negative terminal.

**Failure to follow these instructions may result in incorrect readings or data loss.**

#### Prerequisites

1. Turn off and lock out power to the primary circuit before installing the CTs. Use a properly rated voltage sensing device to confirm that the power is off.
2. Connect CT outputs only to the HDPM6000 meter without connecting either wire to ground or neutral.

**NOTE:** HDPM6000 CTs are LVCTs. A shorting block is not required for their CT secondary outputs. Turn off and lock out power to the primary circuit before installing these CTs. Use a properly rated voltage sensing device to confirm that power is off.

#### Installing the CTs with a Head Unit, IO Module or Busway Module

1. Cut the CT lead wires to the desired length without affecting the accuracy.
2. Strip the CT lead ends to 0.28 in (7 mm) using a wire stripping tool.
 

**NOTE:** Make sure all metal strands are fully inserted into the connector socket.
3. Tighten the connector screws to a torque between 0.22 Nm and 0.25 Nm (1.95 lb-in to 2.21 lb-in).

### Installing the CTs with a Retrofit Module

1. The retrofit module contains insulation displacement CT terminals. Before installation, trim the CT lead wires to remove the stripped and tinned ends. Ensure the insulation is flush with the end of each wire.

**NOTE:** The CTs provided with the module do not include pre-installed connectors.

2. Cut the CT lead wires to the desired length without affecting the accuracy. Do not strip the insulation from the CT lead wires that connect to the retrofit module.

3. Insert each unstripped CT lead wire into the corresponding connector slot. Use a 1/8-inch screwdriver to fully rotate and secure the connector. Refer to the ANSI and IEC wiring diagrams in the HDPM6000R Installation Guide to identify the correct terminal locations and polarity for each channel.

### Installing the CTs with a HDPM6000S 21 Circuit Strip Module

1. The CTs provided for this strip are factory-terminated with connectors. Plug each CT connector into the corresponding CT connector slot on the HDPM6000S 21 Circuit Strip Module.

### Installing the CTs with a HDPM6000S24 24 Circuit Strip Module

1. Plug the factory-terminated CT connector directly into the CT connector slot of the HDPM6000S24 24 Circuit Strip Module.

2. Use connectors from the METSEHDPMS24CTCON kit to complete the following steps:

- Strip the CT lead ends to 0.28 in (7 mm) using a wire stripping tool.

**NOTE:** Make sure all metal strands are fully inserted into the connector socket.

- Tighten the connector screws to a torque between 0.22 Nm and 0.25 Nm (1.95 lb-in to 2.21 lb-in).

### SUN2, SUN3, SUN4, SUS4, and SUSF installation

#### Busbar and phase orientation

- Use the white mark to ensure correct orientation when attaching the top.
- Align the white marks on both ends of the U-bar and I-bar.
- When viewing the product label, the white mark should appear on the top right.
- Check the label to verify the correct CT orientation.

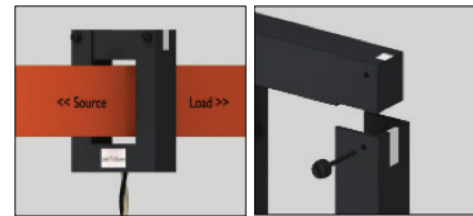

#### Proper size and fitting

- Ensure the CT window is appropriately sized to fit the busbar without excessive space.
- Avoid using an oversized split-core CT, which can result in inaccurate readings.
- Position the busbar at the center of the CT window to allow even coil energization.

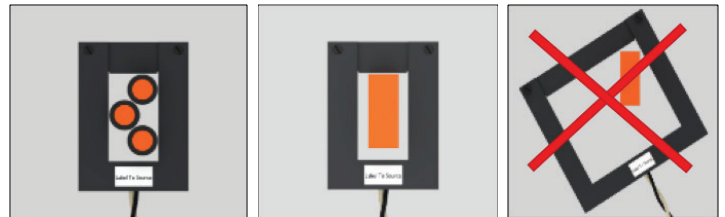

#### Installation

1. Remove the screws or push-pins from the CT, and lift off the top.
2. Slide the CT body over the busbar.
3. Reattach the top to the CT body. Use the white mark to align the top correctly.
4. Secure the top by replacing the screws or push-pins.

**NOTE:** Do not interchange I-bars between CTs.

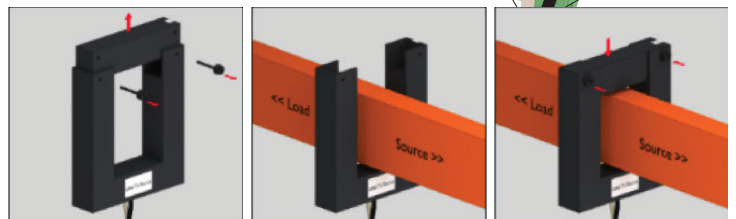

### CTMF, CTSR installation

1. Release the clasp on one side of the CT and open it using the hinge.

**NOTE:** Check the core ends on both sections of the CT to ensure there is no rust or debris in the closure areas. A label on the product indicates the source side. In the illustrated diagram, the arrow shows the direction of current flow (i.e., the label must face away from the circuit breaker).

2. Wrap the CT around the primary lead.

3. Close the CT until the clasp clicks into place to ensure that the contact surfaces are firmly seated.

**NOTE:** You can hang the CT directly on the wire it surrounds. Alternatively, use VELCRO® strips on the bottom or hinged side of the unit for easier mounting and removal. VELCRO is non-conductive.

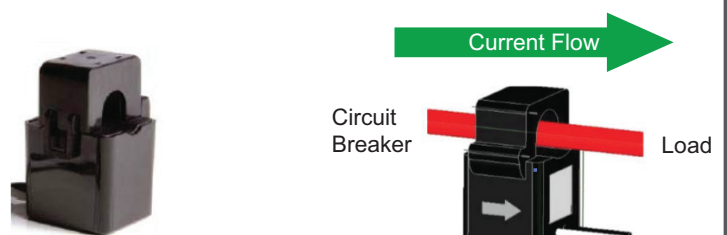

### CTTA, CTTB, CTTG, and SUST2 installation

1. Route the primary conductor through the center of the CT and complete the conductor connections.

**NOTE:** A label on the product indicates the source side. orient all solid-core CT models so that the wire leads face the source.

2. Reconnect power to the panel after you install the CTs and plug in the CT connectors.

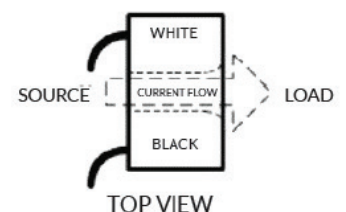

Schneider Electric  
35, rue Joseph Monier  
92500 Rueil Malmaison  
France  
+33 (0) 1 41 29 70 00  
www.se.com

Schneider Electric Limited **UK**  
Stafford Park 5 **CA**  
Telford TF3 3BL  
United Kingdom

**Z208152-0J**  
© 2025 Schneider Electric. All rights reserved.  
**10/2025**