

- NOTES:
1. INSTALLATION MUST COMPLY ALL APPLICABLE NATIONAL AND LOCAL ELECTRICAL REGULATIONS
  2. PLEASE REFER TO PRODUCT MANUAL FOR DETAILED INFORMATION.
  3. ALL DIMENSIONS ARE IN MILLIMETERS. UNLESS OTHERWISE SPECIFIED.
  4. CABLE ENTRY IS FROM THE TOP OR BOTTOM OF THE PANEL.
  5. NET WEIGHT OF THE ENCLOSURE WITHOUT BATTERY UNITS IS 345 kg  
NET WEIGHT OF THE BATTERY UNIT (SYBTU2-PLP) IS 25.2 kg  
NET WEIGHT OF THE ENCLOSURE WITH BATTERY UNITS INSTALLED IS 1252 kg.
- △ 6. COG DETAILS.

CENTER OF GRAVITY	WITH BATTERIES	WITHOUT BATTERIES
X DISTANCE	297.5 mm	299.5 mm
Y DISTANCE	1107.0 mm	1023.6 mm
Z DISTANCE	419.9 mm	545.5 mm

- △ 7. THE FRENCH DOORS ARE EQUIPPED WITH PLEXIGLASS INSERTS FOR THESE UNITS.  
 △ 8. MAXIMUM HEIGHT OF THE UNIT IS 1996mm  
 (INCLUDES TOP PROTRUSIONS, BOLTS AND NUTS THAT ARE MOUNTED ON TOP OF THE UNIT).

THIS DRAWING AND SPECIFICATIONS HEREIN ARE THE PROPERTY OF SCHNEIDER ELECTRIC AND SHALL NOT BE COPIED, REPRODUCED OR USED IN WHOLE OR IN PART, AS THE BASIS FOR THE MANUFACTURE OR SALE OF ITEMS WITHOUT WRITTEN PERMISSION FROM SCHNEIDER ELECTRIC. THIS DRAWING IS BASED UPON LATEST AVAILABLE INFORMATION AND IS SUBJECT TO CHANGE WITHOUT NOTICE.

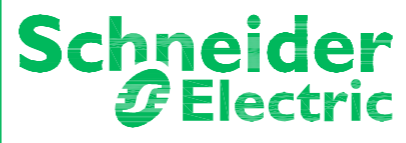

TITLE:  
 SYMMETRA PX 96, 100 AND 160kW  
 EXTENDED RUN BATTERY FRAME  
 WITH 9 BATTERY MODULES  
 MAIN MECHANICAL

PROJECT: SUBMITTAL DRAWINGS SHEET 1 OF 5

DWG NO: SYCFXR9-MM1

DRAWN:	S.CUNHA	03-NOV-10
ENGINEER:	S.LEE	01-SEP-09
APPROVED:	C.LARSEN/S.WAGH/E.SILVA	01-SEP-09

REV. 2  
 FIRST ANGLE PROJECTION

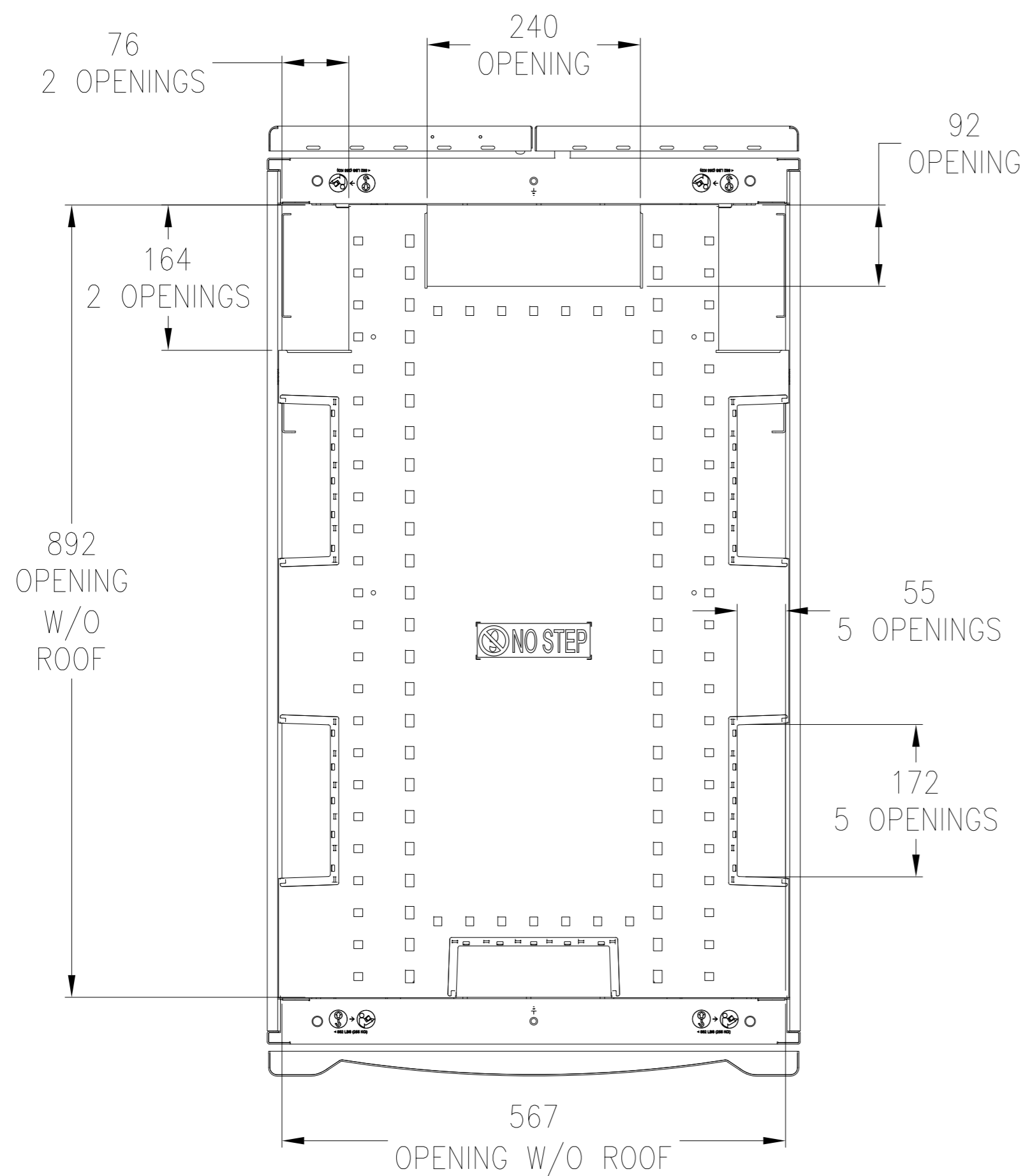

TOP VIEW  
CABLE OPENINGS  
(COVERS REMOVED)

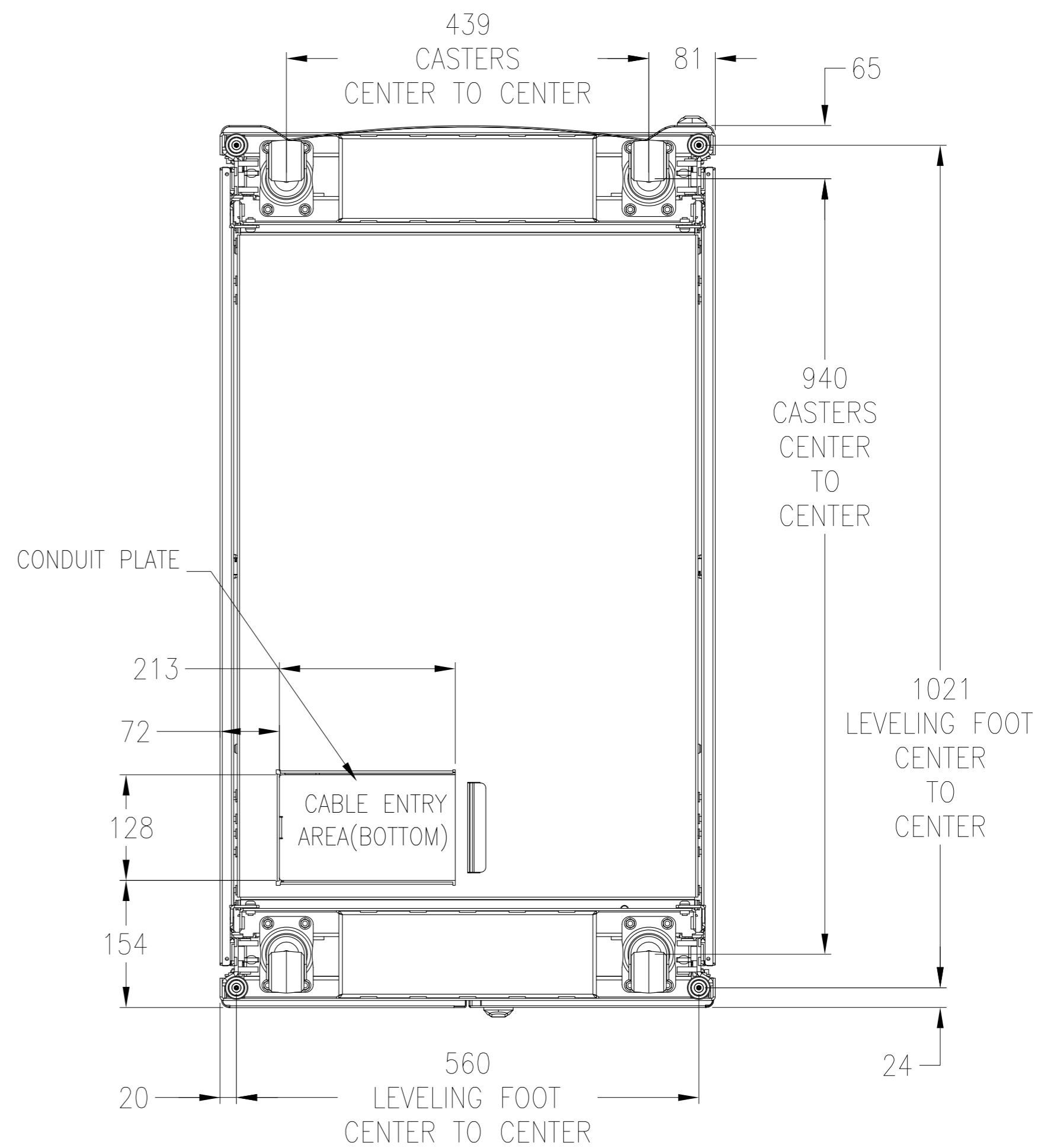

BOTTOM VIEW

- NOTES:
1. INSTALLATION MUST COMPLY ALL APPLICABLE NATIONAL AND LOCAL ELECTRICAL REGULATIONS
  2. PLEASE REFER TO PRODUCT MANUAL FOR DETAILED INFORMATION.
  3. ALL DIMENSIONS ARE IN MILLIMETERS. UNLESS OTHERWISE SPECIFIED.
  4. FOR TOP AND BOTTOM CABLE ENTRY REMOVE TOP OR BOTTOM CONDUIT PLATES, DRILL/PUNCH HOLES WITH-IN PROVIDED CABLE ENTRY AREA. REFIT COVER AND INSTALL CONDUITS.

THIS DRAWING AND SPECIFICATIONS HEREIN ARE THE PROPERTY OF SCHNEIDER ELECTRIC AND SHALL NOT BE COPIED, REPRODUCED OR USED IN WHOLE OR IN PART, AS THE BASIS FOR THE MANUFACTURE OR SALE OF ITEMS WITHOUT WRITTEN PERMISSION FROM SCHNEIDER ELECTRIC. THIS DRAWING IS BASED UPON LATEST AVAILABLE INFORMATION AND IS SUBJECT TO CHANGE WITHOUT NOTICE.



TITLE:  
SYMMETRA PX 96, 100 AND 160kW  
EXTENDED RUN BATTERY FRAME  
WITH 9 BATTERY MODULES  
TOP AND BOTTOM VIEW

DWG NO: SYCFXR9-MM2

DRAWN: S.CUNHA 03-NOV-10

ENGINEER: S.LEE 01-SEP-09

APPROVED: C.LARSEN/S.WAGH/E.SILVA 01-SEP-09

REV. 2

FIRST ANGLE PROJECTION

FRONT

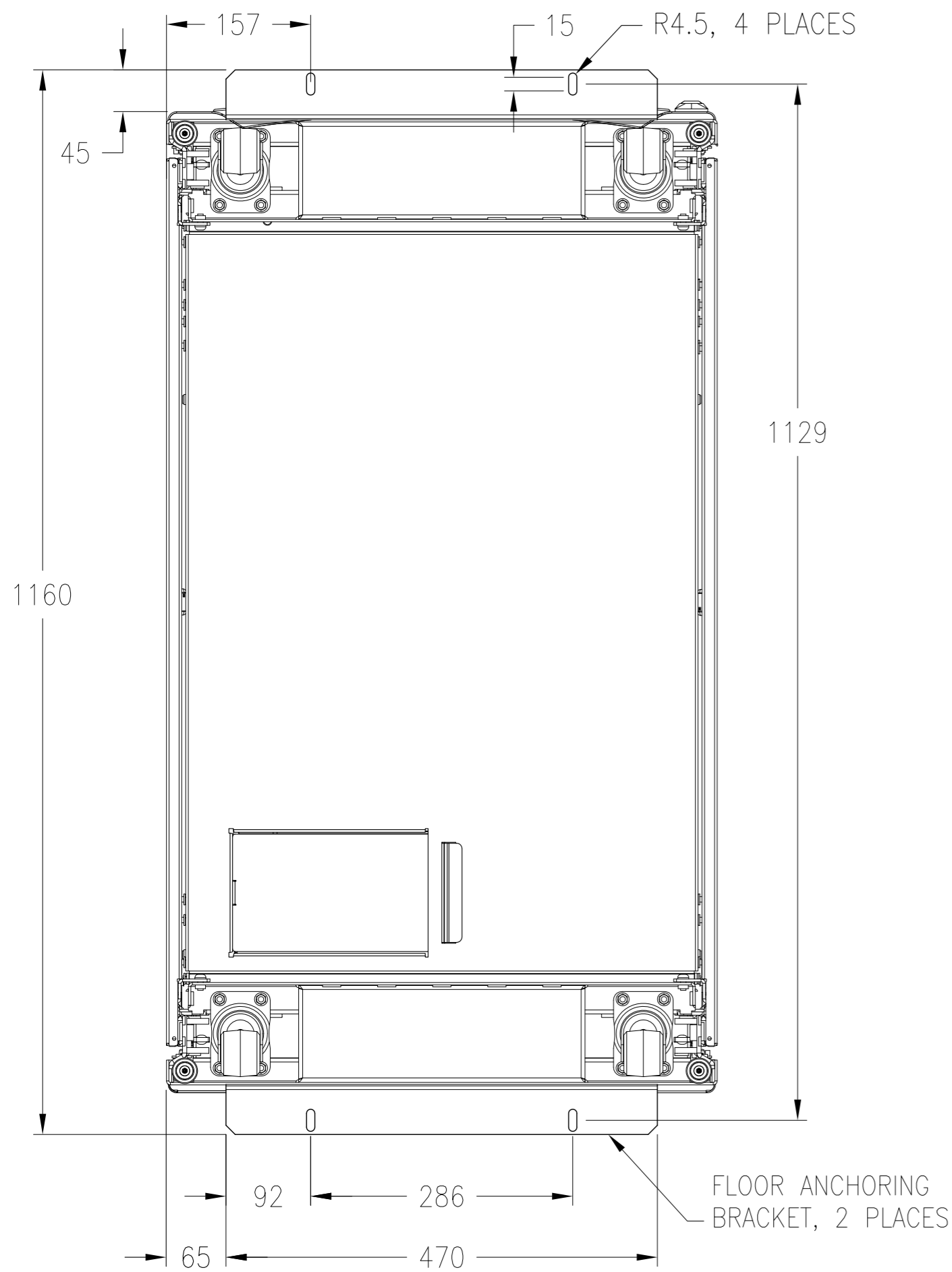

BOTTOM VIEW

(FLOOR ANCHORING BRACKET)

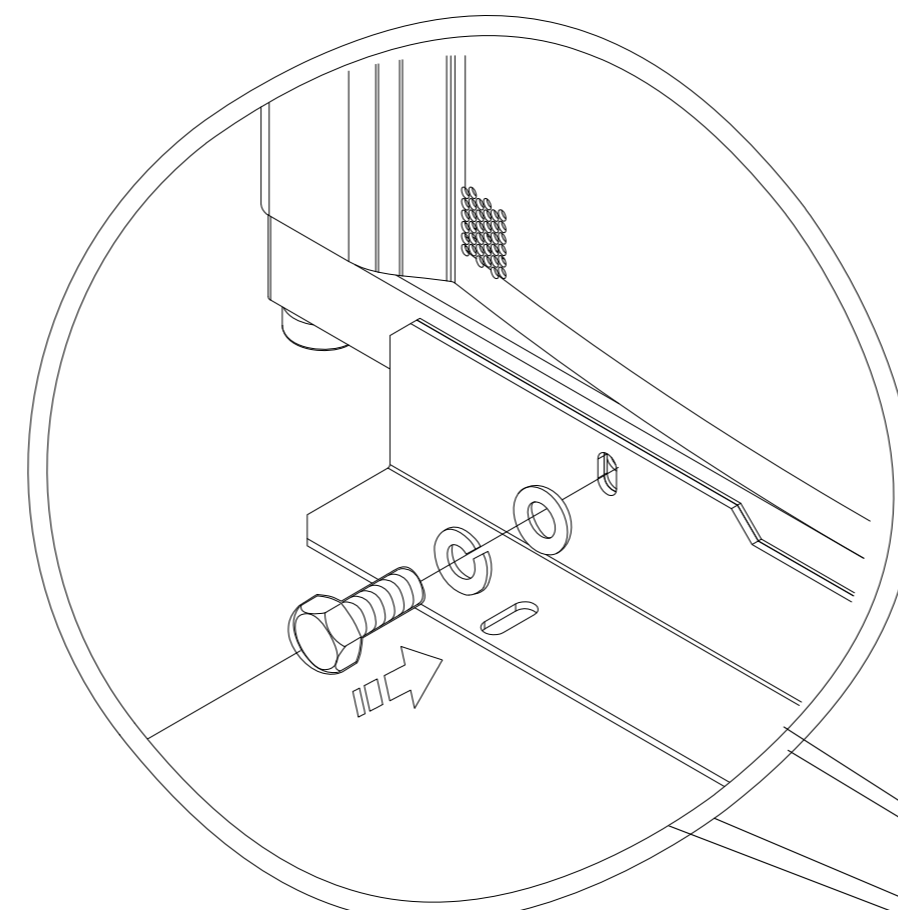

ENLARGED VIEW

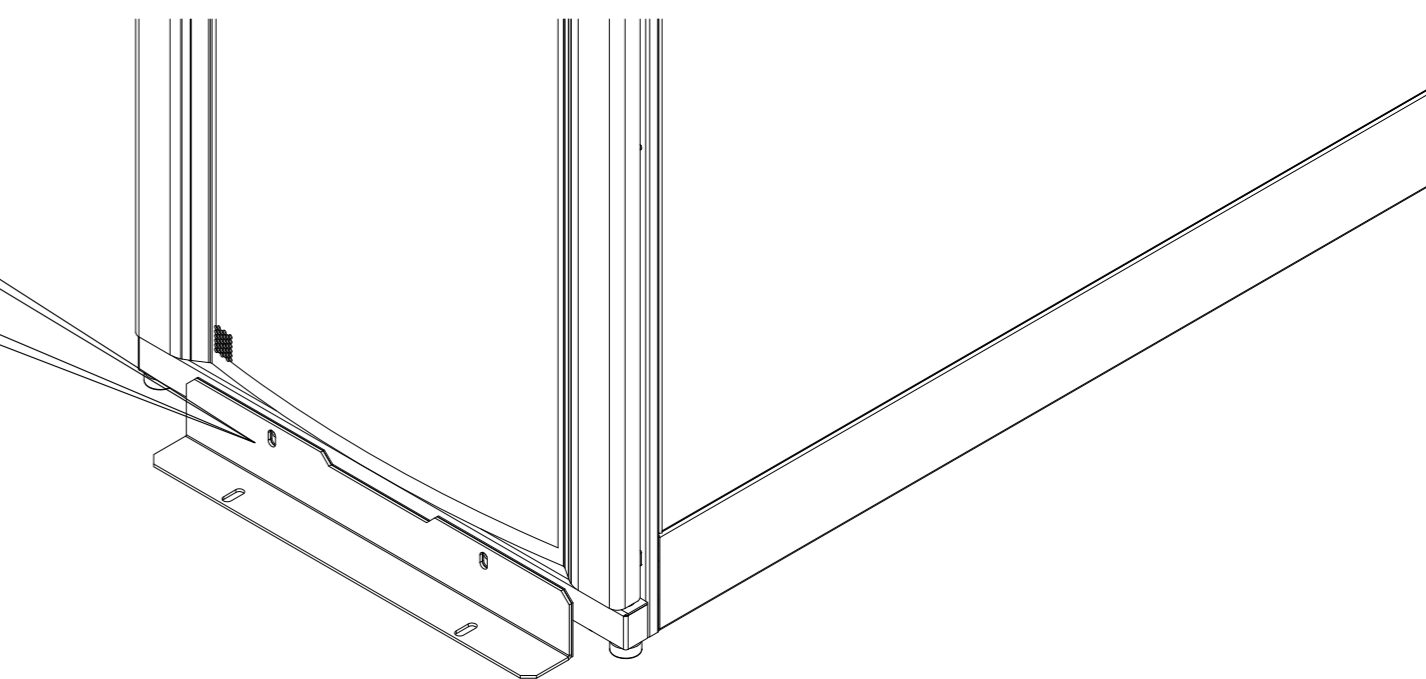

ISOMETRIC VIEW

(FLOOR ANCHORING BRACKET MOUNTING DETAILS)

NOTES:

1. INSTALLATION SHALL COMPLY WITH ALL APPLICABLE NATIONAL, STATE AND LOCAL ELECTRICAL REGULATIONS.
2. SEE PRODUCT DOCUMENTATION FOR FURTHER INFORMATION
3. UNLESS OTHERWISE SPECIFIED, ALL DIMENSIONS ARE IN MILLIMETERS.
4. TO STABILIZE ENCLOSURE IN THE FIELD USE INCLUDED ANCHORING BRACKETS. ATTACH THE BRACKETS TO THE UNIT AS SHOWN. USE CODE COMPLIANT FASTENERS TO SECURE THE UNIT TO THE FLOOR

THIS DRAWING AND SPECIFICATIONS HEREIN ARE THE PROPERTY OF SCHNEIDER ELECTRIC AND SHALL NOT BE COPIED, REPRODUCED OR USED IN WHOLE OR IN PART, AS THE BASIS FOR THE MANUFACTURE OR SALE OF ITEMS WITHOUT WRITTEN PERMISSION FROM SCHNEIDER ELECTRIC. THIS DRAWING IS BASED UPON LATEST AVAILABLE INFORMATION AND IS SUBJECT TO CHANGE WITHOUT NOTICE.



TITLE:  
SYMMETRA PX 96, 100 AND 160kW  
EXTENDED RUN BATTERY FRAME  
WITH 9 BATTERY MODULES  
ANCHORING DETAILS

DWG NO: SYCFXR9-MM3

REV. 2

DRAWN: S.CUNHA 03-NOV-10

ENGINEER: S.LEE 07-SEP-09

PROJECT: SUBMITTAL DRAWINGS SHEET 3 OF 5

APPROVED: C.LARSEN/S.WAGH/E.SILVA 07-SEP-09

FIRST  
ANGLE  
PROJECTION

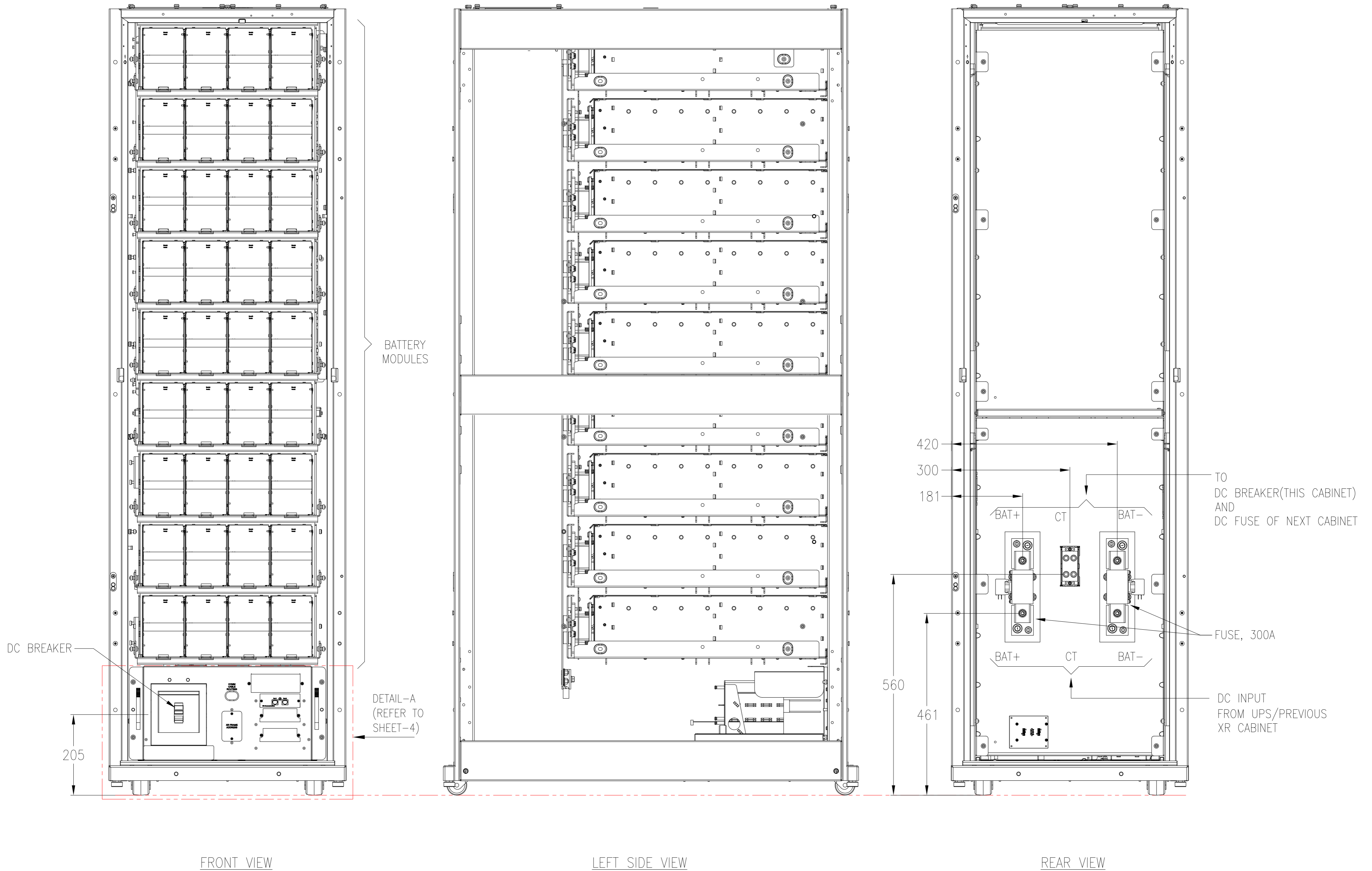

NOTES:

1. INSTALLATION MUST COMPLY ALL APPLICABLE NATIONAL AND LOCAL ELECTRICAL REGULATIONS
2. PLEASE REFER TO PRODUCT MANUAL FOR DETAILED INFORMATION.
3. ALL DIMENSIONS ARE IN MILLIMETERS. UNLESS OTHERWISE SPECIFIED.

THIS DRAWING AND SPECIFICATIONS HEREIN ARE THE PROPERTY OF SCHNEIDER ELECTRIC AND SHALL NOT BE COPIED, REPRODUCED OR USED IN WHOLE OR IN PART, AS THE BASIS FOR THE MANUFACTURE OR SALE OF ITEMS WITHOUT WRITTEN PERMISSION FROM SCHNEIDER ELECTRIC. THIS DRAWING IS BASED UPON LATEST AVAILABLE INFORMATION AND IS SUBJECT TO CHANGE WITHOUT NOTICE.



TITLE:  
 SYMMETRA PX 96, 100 AND 160kW  
 EXTENDED RUN BATTERY FRAME  
 WITH 9 BATTERY MODULES  
 INTERNAL VIEW

DWG NO: SYCFXR9-ME1

REV. 3

DRAWN: S.CUNHA 04-DEC-14

ENGINEER: S.LEE 01-SEP-09

APPROVED: C.LARSEN/S.WAGH/E.SILVA 01-SEP-09

PROJECT: SUBMITTAL DRAWINGS SHEET 4 OF 5

FIRST ANGLE PROJECTION

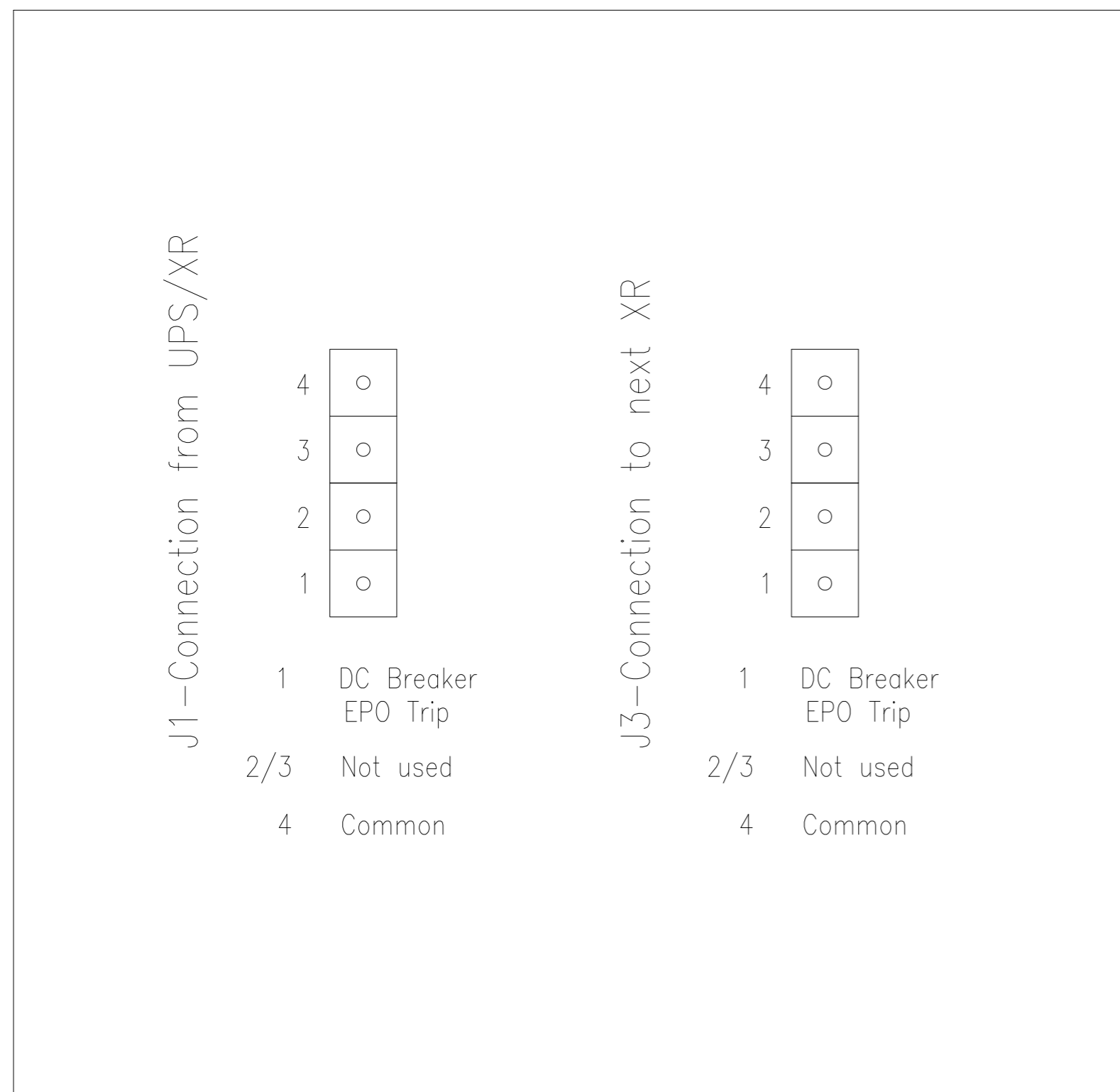

EPO INTERFACE FOR DC BREAKER TRIP

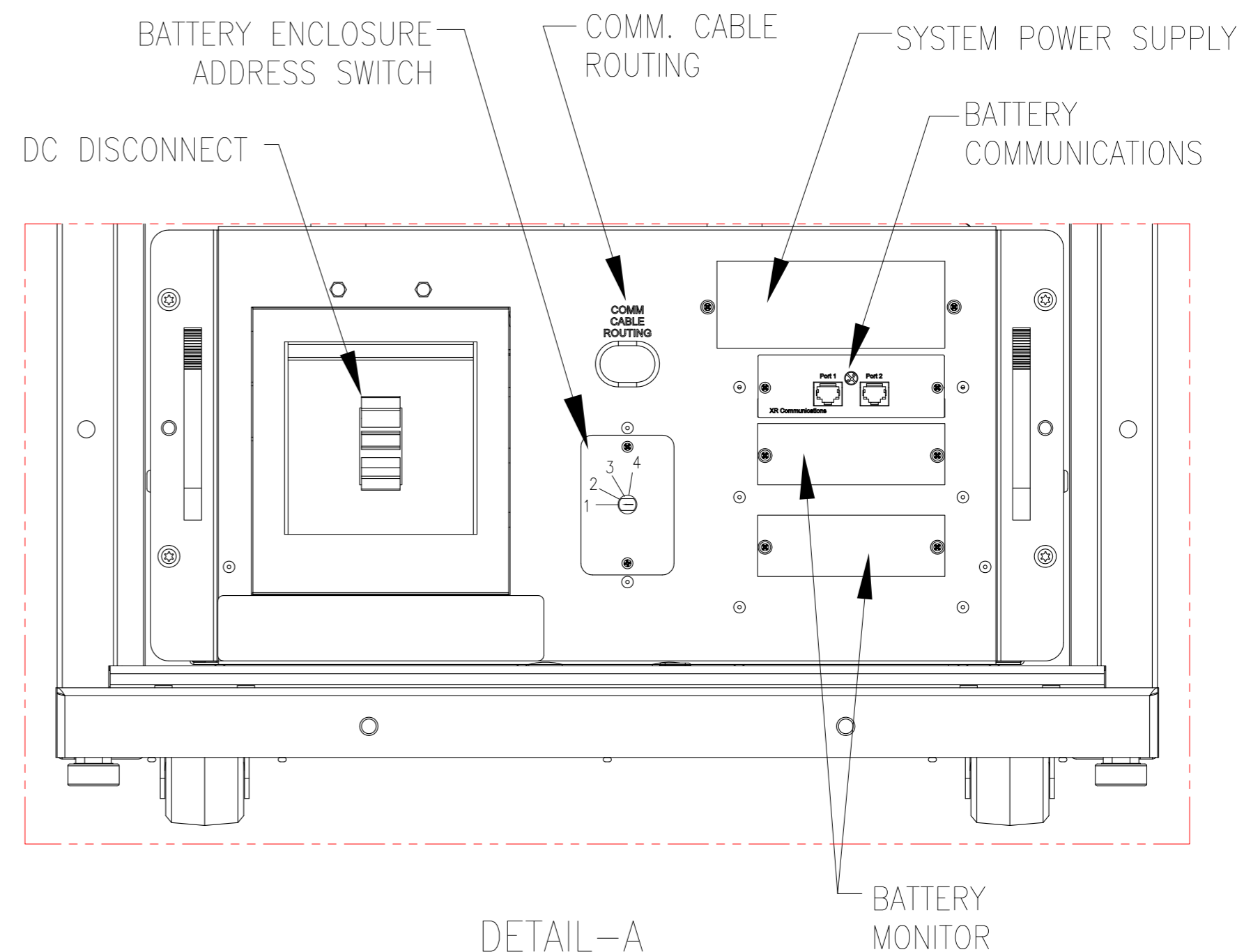

DETAIL-A  
(COMMUNICATION PANEL-ENLARGED VIEW)

NOTES:

1. INSTALLATION MUST COMPLY ALL APPLICABLE NATIONAL AND LOCAL ELECTRICAL REGULATIONS
2. PLEASE REFER TO PRODUCT MANUAL FOR DETAILED INFORMATION.
3. ALL DIMENSIONS ARE IN MILLIMETERS. UNLESS OTHERWISE SPECIFIED.

THIS DRAWING AND SPECIFICATIONS HEREIN ARE THE PROPERTY OF SCHNEIDER ELECTRIC AND SHALL NOT BE COPIED, REPRODUCED OR USED IN WHOLE OR IN PART, AS THE BASIS FOR THE MANUFACTURE OR SALE OF ITEMS WITHOUT WRITTEN PERMISSION FROM SCHNEIDER ELECTRIC. THIS DRAWING IS BASED UPON LATEST AVAILABLE INFORMATION AND IS SUBJECT TO CHANGE WITHOUT NOTICE.



TITLE:  
SYMMETRA PX 96, 100 AND 160kW  
EXTENDED RUN BATTERY FRAME  
WITH 9 BATTERY MODULES  
WIRING DETAILS

PROJECT: SUBMITTAL DRAWINGS SHEET 5 OF 5

DWG NO: SYCFXR9-ME2

DRAWN:	S.CUNHA	03-NOV-10
ENGINEER:	S.LEE	01-SEP-09
APPROVED:	C.LARSEN/S.WAGH/E.SILVA	01-SEP-09

REV. 2

FIRST ANGLE PROJECTION