

HYPERPOD SYSTEM
SHORT FRAME, SINGLE POD, DROP OUT ROOF, Swing Door
WITH RACK AND WITHOUT POWER DISTRIBUTION CABINETS

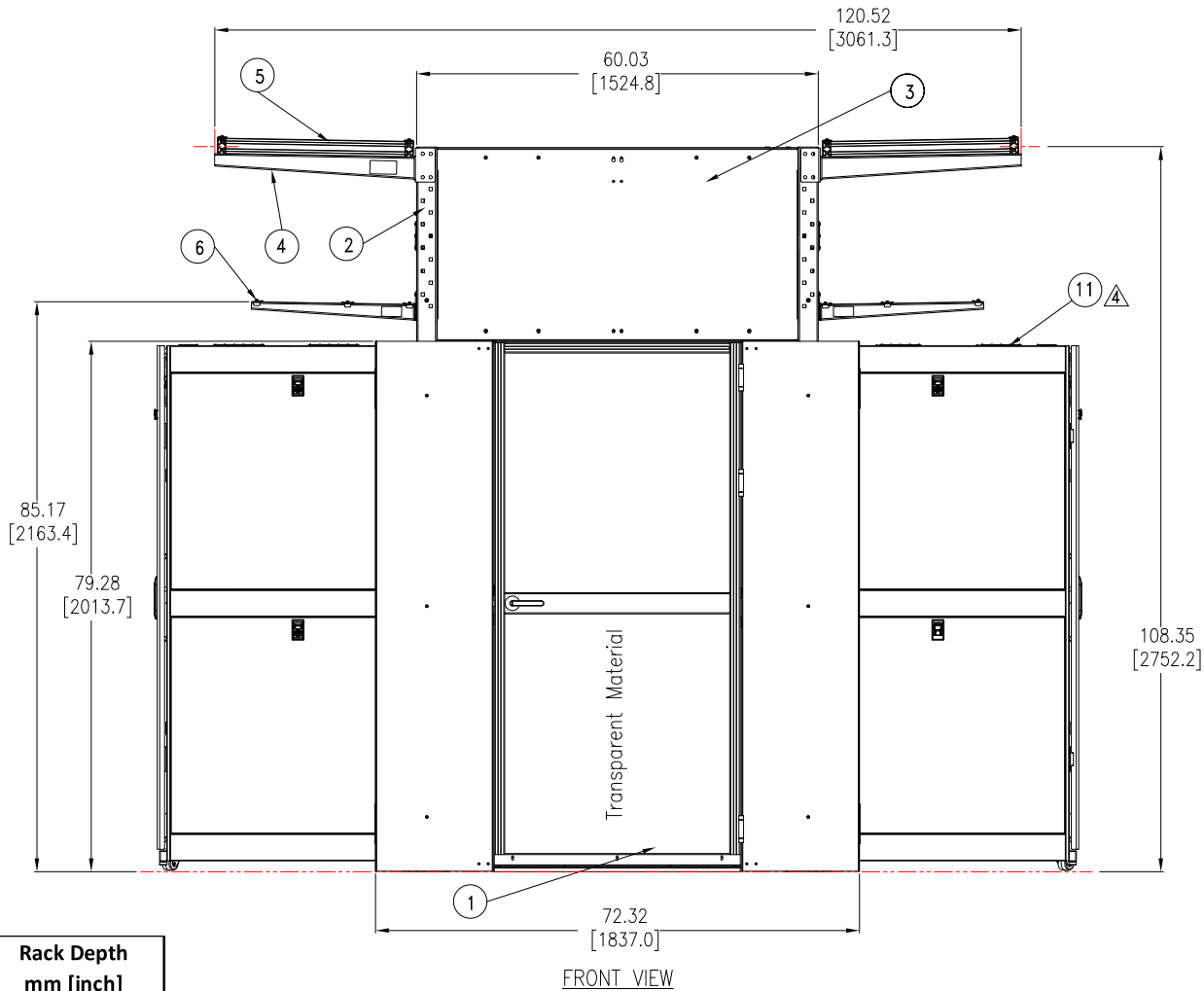

Rack Depth mm [inch]
825 [32.480]
1070 [42.125]
1200 [47.244]

△4

FRONT VIEW

Sl.No.	Description
1	Single Swing Door (Shown in closed position)
2	Vertical Post
3	Aisle-End Cap Assembly
4	Large Cantilever (optional)
5	Overhead support frame
6	Mini Cantilever (optional)
7	Drop out roof
8	Stop rail (bottom)
9	Window Rail assembly
10	Row Length Brush
11	Rack (AR3100)

NOTES:

1. INSTALLATION SHALL COMPLY WITH ALL APPLICABLE NATIONAL, STATE AND LOCAL CODES.
2. REFER TO PRODUCT DOCUMENTATION FOR ADDITIONAL DETAILS PRIOR TO INSTALLATION AND SITE PREPARATION WORK.
3. ALL DIMENSIONS ARE IN INCHES [MILLIMETERS].
- △4. TYPICAL ARRANGEMENT FOR AR3100 RACK SHOWN FOR REFERENCE.
- △5. RACK WIDTH AND HEIGHT MAY VARY AS PER THE REQUIREMENT. FOR RACK DEPTH REFER TO THE TABLE.

THIS DRAWING AND SPECIFICATIONS HEREIN ARE THE PROPERTY OF SCHNEIDER ELECTRIC AND SHALL NOT BE COPIED, REPRODUCED OR USED IN WHOLE OR IN PART, AS THE BASIS FOR THE MANUFACTURE OR SALE OF ITEMS WITHOUT WRITTEN PERMISSION FROM SCHNEIDER ELECTRIC. THIS DRAWING IS BASED UPON LATEST AVAILABLE INFORMATION AND IS SUBJECT TO CHANGE WITHOUT NOTICE.

Schneider Electric

TITLE: HyperPod
 Short Frame, Single Pod, Drop out roof, 4' Aisle
 Swing Door with Rack & w/o Distribution Cabinets
 ASSEMBLY-FRONT VIEW

PROJECT: SUBMITTAL DRAWING **SHEET** 1 OF 3

DWG NO:	REV.
SFSPDRWRSWOD4F	0
DRAWN BY: JAYAPRAKASH	25-JUL-18
ENGINEER: TONG XU	31-JUL-18
APPROVED BY: AARON COTTER	31-JUL-18
	THIRD ANGLE PROJECTION

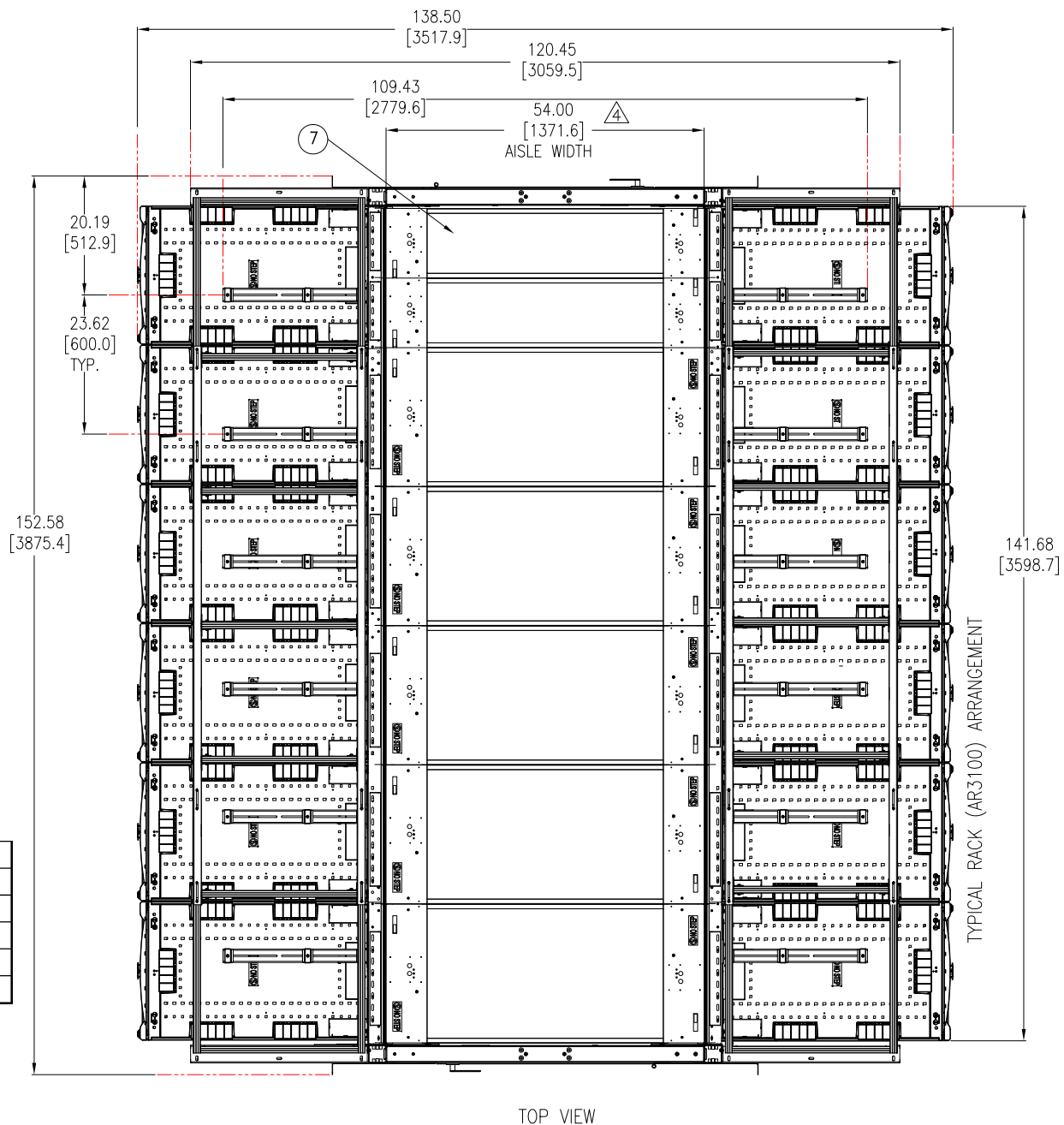

TOP VIEW

4

Aisle Width	
Feet	mm [inch]
3	914.4 [36.0]
4	1371.6 [54.0]
5	1524.0 [60.0]
6	1981.2 [78.0]

NOTES:

1. INSTALLATION SHALL COMPLY WITH ALL APPLICABLE NATIONAL, STATE AND LOCAL CODES.
2. REFER TO PRODUCT DOCUMENTATION FOR ADDITIONAL DETAILS PRIOR TO INSTALLATION AND SITE PREPARATION WORK.
3. ALL DIMENSIONS ARE IN INCHES [MILLIMETERS].
- △ 4. AISLE DIMENSION MAY VARY AS PER THE REQUIREMENT. REFER TO TABLE FOR CONFIGURATIONS.

THIS DRAWING AND SPECIFICATIONS HEREIN ARE THE PROPERTY OF SCHNEIDER ELECTRIC AND SHALL NOT BE COPIED, REPRODUCED OR USED IN WHOLE OR IN PART, AS THE BASIS FOR THE MANUFACTURE OR SALE OF ITEMS WITHOUT WRITTEN PERMISSION FROM SCHNEIDER ELECTRIC. THIS DRAWING IS BASED UPON LATEST AVAILABLE INFORMATION AND IS SUBJECT TO CHANGE WITHOUT NOTICE.



TITLE: HyperPod
Short Frame, Single Pod, Drop out roof, 4' Aisle
Swing Door with Rack & w/o Distribution Cabinets
ASSEMBLY-TOP VIEW

PROJECT: SUBMITTAL DRAWING **SHEET 2 OF 3**

DWG NO: SFSPDRWRSWOD4F	REV. 0
DRAWN BY: JAYAPRAKASH	25-JUL-18
ENGINEER: TONG XU	31-JUL-18
APPROVED BY: AARON COTTER	31-JUL-18
	THIRD ANGLE PROJECTION

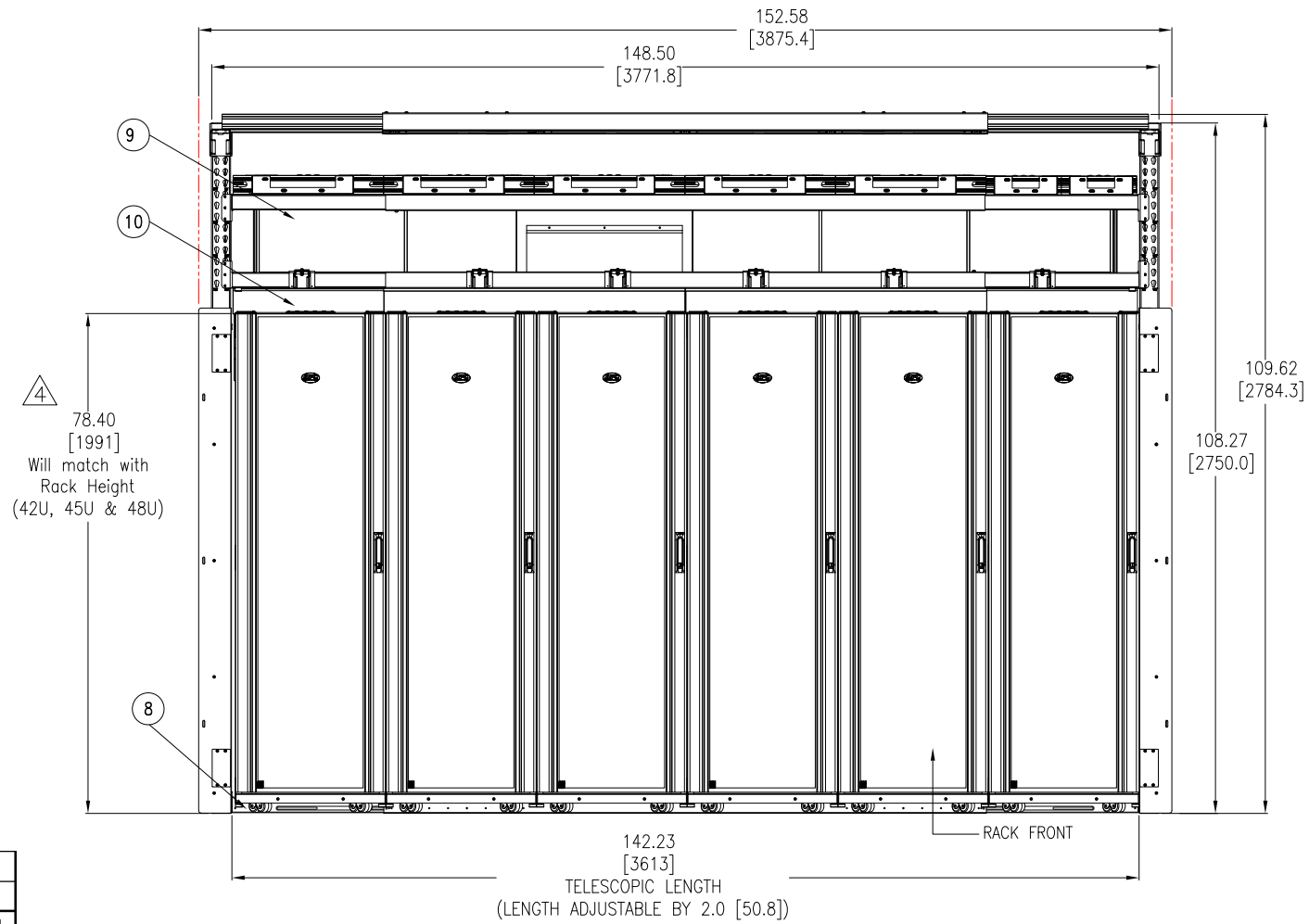

Rack Height	
U	mm [inch]
42U	1991 [78.39]
45U	2124 [83.64]
48U	2258 [88.90]

△4

NOTES:

1. INSTALLATION SHALL COMPLY WITH ALL APPLICABLE NATIONAL, STATE AND LOCAL CODES.
2. REFER TO PRODUCT DOCUMENTATION FOR ADDITIONAL DETAILS PRIOR TO INSTALLATION AND SITE PREPARATION WORK.
3. ALL DIMENSIONS ARE IN INCHES [MILLIMETERS].
- △4. RACK HEIGHT MAY VARY AS PER REQUIREMENT. REFER TO THE TABLE FOR DETAILS.

THIS DRAWING AND SPECIFICATIONS HEREIN ARE THE PROPERTY OF SCHNEIDER ELECTRIC AND SHALL NOT BE COPIED, REPRODUCED OR USED IN WHOLE OR IN PART, AS THE BASIS FOR THE MANUFACTURE OR SALE OF ITEMS WITHOUT WRITTEN PERMISSION FROM SCHNEIDER ELECTRIC. THIS DRAWING IS BASED UPON LATEST AVAILABLE INFORMATION AND IS SUBJECT TO CHANGE WITHOUT NOTICE.



TITLE: HyperPod
Short Frame, Single Pod, Drop out roof, 4' Aisle
Swing Door with Rack & w/o Distribution Cabinets
ASSEMBLY—RIGHT SIDE VIEW

PROJECT: SUBMITTAL DRAWING SHEET 3 OF 3

DWG NO: SFSPDRWRSWOD4F	REV. 0
DRAWN BY: JAYAPRAKASH	25-JUL-18
ENGINEER: TONG XU	31-JUL-18
APPROVED BY: AARON COTTER	31-JUL-18
	THIRD ANGLE PROJECTION