

**SHORT FRAME-SINGLE POD-DUCTED ROOF WITH RACKS AND DISTRIBUTION PANEL**

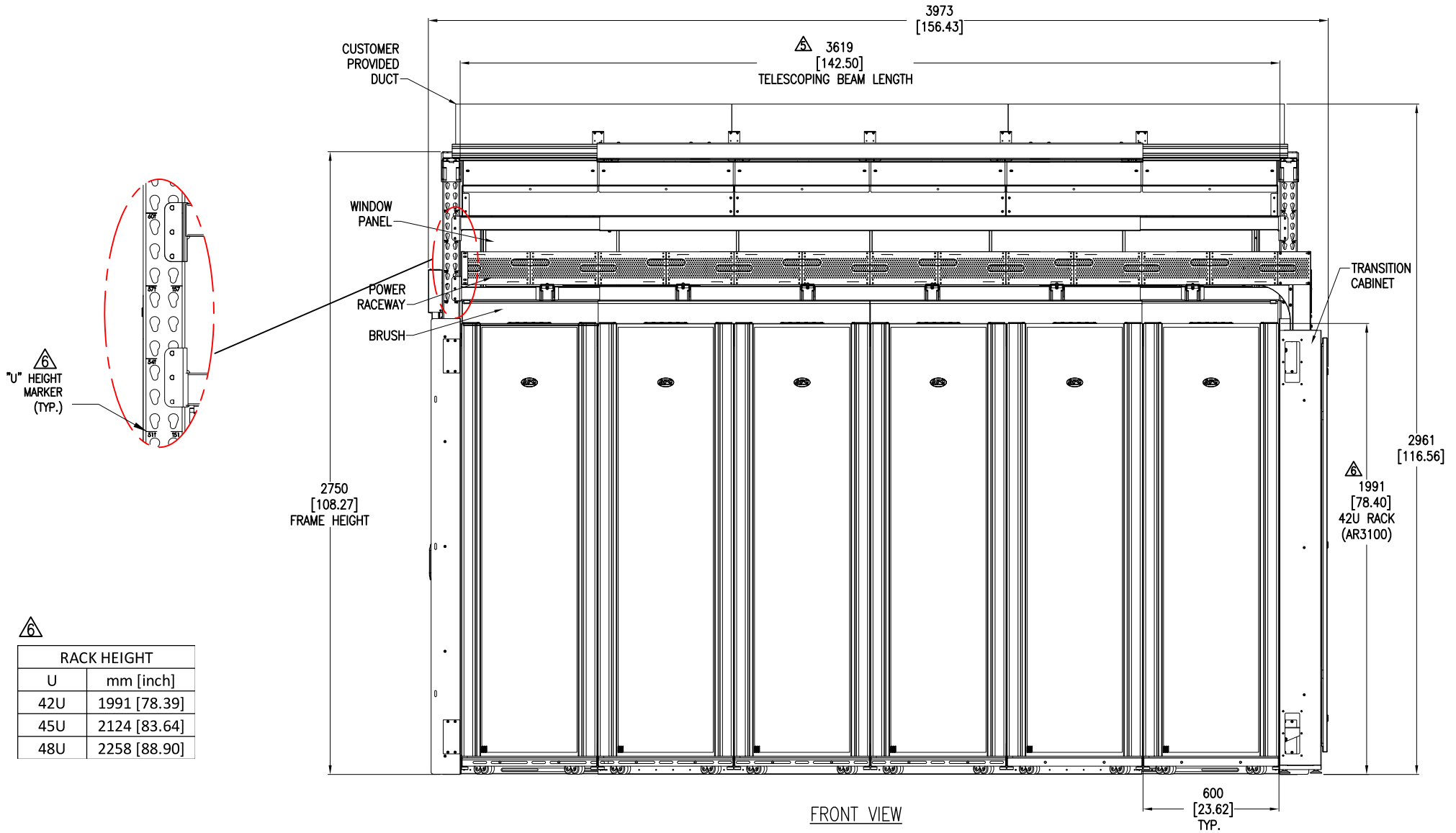

RACK HEIGHT	
U	mm [inch]
42U	1991 [78.39]
45U	2124 [83.64]
48U	2258 [88.90]

**NOTES:**

1. INSTALLATION SHALL COMPLY WITH ALL APPLICABLE NATIONAL, STATE AND LOCAL ELECTRICAL REGULATIONS.
2. REFER TO PRODUCT DOCUMENTATION FOR ADDITIONAL DETAILS PRIOR TO INSTALLATION AND SITE PREPARATION WORK.
3. ALL DIMENSIONS ARE IN MILLIMETERS [INCHES].
4. WEIGHT - REFER TO THE RESPECTIVE SUBMITTALS.
- △ 5. THIS DIMENSION MAY VARY AS PER RACK WIDTH AND NUMBER OF RACK. SHOWN TYPICAL ARRANGEMENT FOR TWELVE 600mm WIDE RACKS. TELESCOPING BEAM CAN ACCOMMODATE ANY COMBINATION OF RACKS FROM 8-12 FEET.
- △ 6. SHORT FRAME CAN ACCOMMODATE UP TO 48U, SHOWN TYPICAL ARRANGEMENT FOR 42U RACKS. REFER TO TABLE FOR DETAILS.
7. THIS DRAWING IS FOR TYPICAL CONFIGURATION.

THIS DRAWING AND SPECIFICATIONS HEREIN ARE THE PROPERTY OF SCHNEIDER ELECTRIC AND SHALL NOT BE COPIED, REPRODUCED OR USED IN WHOLE OR IN PART, AS THE BASIS FOR THE MANUFACTURE OR SALE OF ITEMS WITHOUT WRITTEN PERMISSION FROM SCHNEIDER ELECTRIC. THIS DRAWING IS BASED UPON LATEST AVAILABLE INFORMATION AND IS SUBJECT TO CHANGE WITHOUT NOTICE.



TITLE: HYPERPOD SHORT FRAME, SINGLE POD, DUCTED ROOF WITH RACK AND DISTRIBUTION PANEL FRONT VIEW  
 PROJECT: SUBMITTAL DRAWINGS SHEET 1 OF 3

DWG NO:	SFSPDRWRD	REV.	0
DRAWN BY:	JAYAPRAKASH	18-MAY-17	FIRST
ENGINEER:	A COTTER	19-MAY-17	ANGLE
APPROVED BY:	SYMONS	19-MAY-17	PROJ

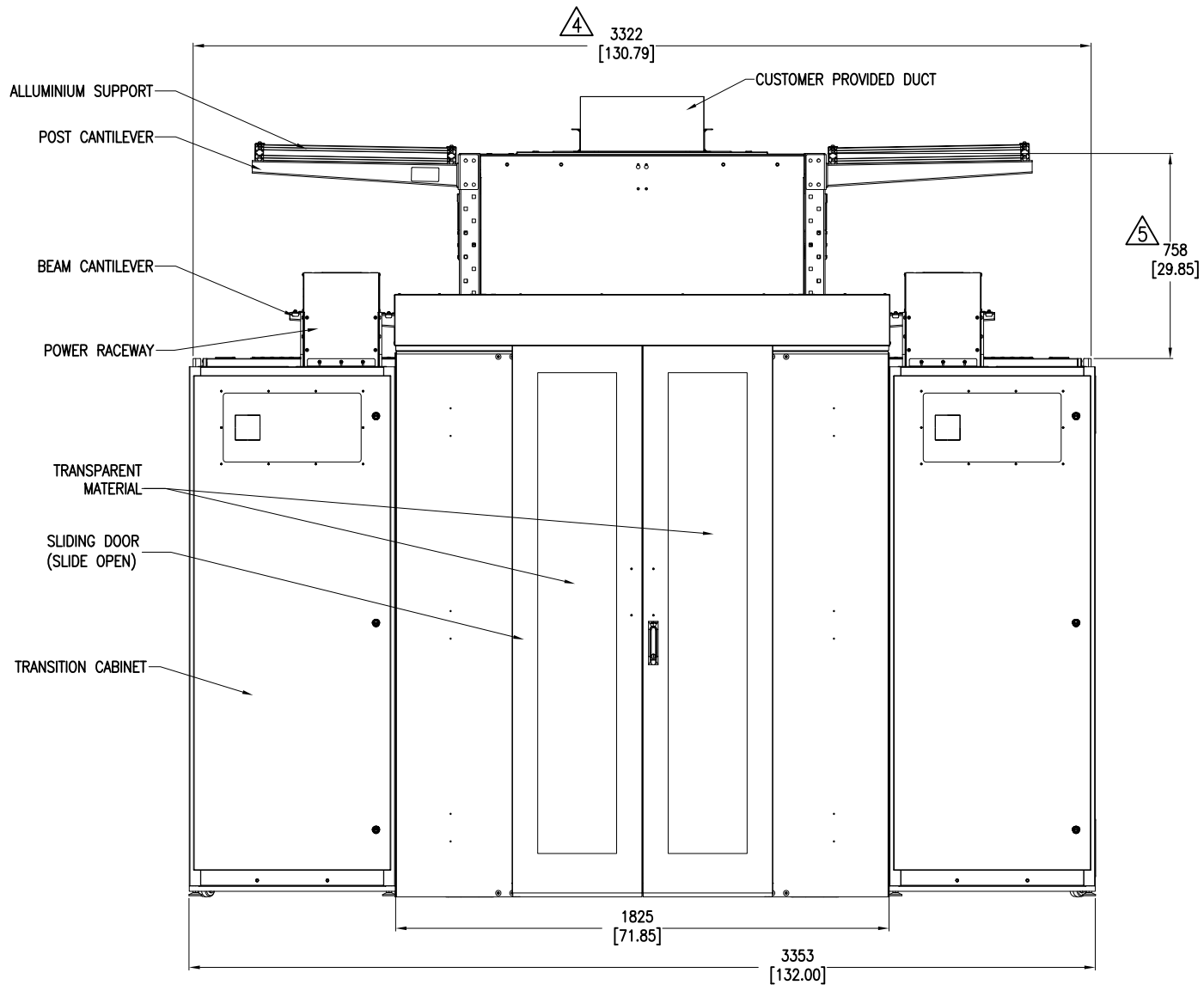

RIGHT SIDE VIEW

4	
RACK DEPTH	
mm [inch]	
825	[32.480]
1070	[42.125]
1200	[47.244]

NOTES:

1. INSTALLATION SHALL COMPLY WITH ALL APPLICABLE NATIONAL, STATE AND LOCAL ELECTRICAL REGULATIONS.
2. REFER TO PRODUCT DOCUMENTATION FOR ADDITIONAL DETAILS PRIOR TO INSTALLATION AND SITE PREPARATION WORK.
3. ALL DIMENSIONS ARE IN MILLIMETERS [INCHES].
4. OVERALL CONTAINMENT POD WIDTH DIMENSION MAY VARY AS PER THE COMPONENT SELECTED.  
1070 [42.13] DEPTH RACK SHOWN FOR TYPICAL ARRANGEMENT. REFER TO TABLE FOR DETAILS.
5. THIS DIMENSION MAY VARY AS PER THE RACK SELECTED. 48U RACK SHOWN FOR TYPICAL ARRANGEMENT.

THIS DRAWING AND SPECIFICATIONS HEREIN ARE THE PROPERTY OF SCHNEIDER ELECTRIC AND SHALL NOT BE COPIED, REPRODUCED OR USED IN WHOLE OR IN PART, AS THE BASIS FOR THE MANUFACTURE OR SALE OF ITEMS WITHOUT WRITTEN PERMISSION FROM SCHNEIDER ELECTRIC. THIS DRAWING IS BASED UPON LATEST AVAILABLE INFORMATION AND IS SUBJECT TO CHANGE WITHOUT NOTICE.



TITLE: HYPERPOD  
SHORT FRAME, SINGLE POD, DUCTED ROOF  
WITH RACK AND DISTRIBUTION PANEL  
RIGHT SIDE VIEW

PROJECT: SUBMITTAL DRAWINGS SHEET 2 OF 3

DWG NO:	SFSPDRWRD	REV.	0
DRAWN BY:	JAYAPRAKASH	18-MAY-17	FIRST
ENGINEER:	A COTTER	19-MAY-17	ANGLE
APPROVED BY:	SYMONS	19-MAY-17	PROJ

TYPICAL 42U RACK (AR3100) ARRANGEMENT

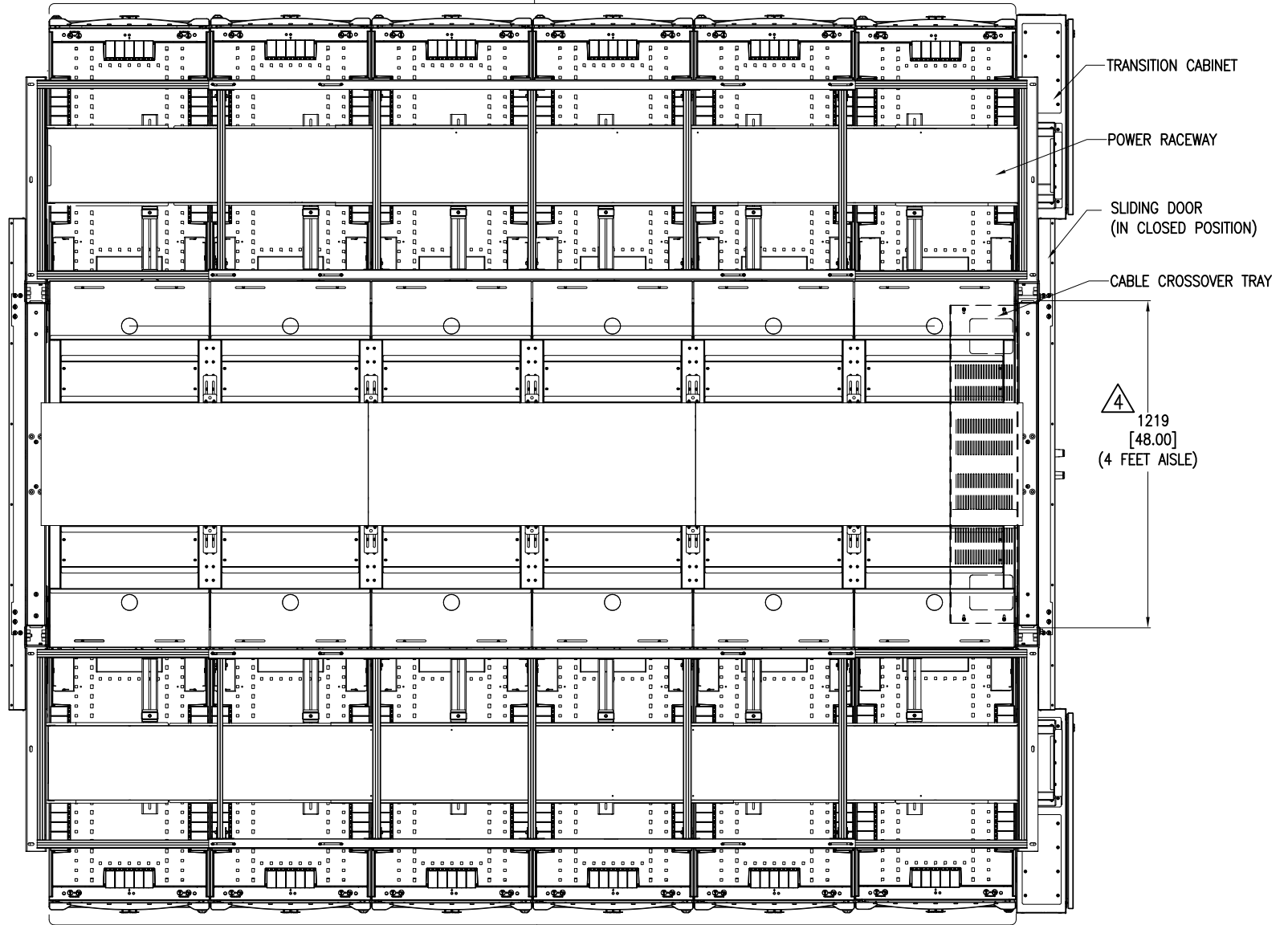

△4

AISLE WIDTH	
Feet	mm [inch]
3	914.4 [36.0]
4	1219.2 [48.0]
5	1524.0 [60.0]
6	1828.8 [72.0]

TYPICAL 42U RACK (AR3100) ARRANGEMENT

TOP VIEW

NOTES:

1. COMPLY WITH ALL APPLICABLE NATIONAL AND LOCAL ELECTRICAL REGULATIONS.
2. REFER TO PRODUCT DOCUMENTATION FOR ADDITIONAL DETAILS PRIOR TO INSTALLATION AND SITE PREPARATION WORK.
3. ALL DIMENSIONS ARE IN MILLIMETERS [INCHES].
- △4. ACROSS AISLE DIMENSION MAY VARY AS PER THE REQUIREMENT. TABLE SHOWS STANDARD CONFIGURATION.

THIS DRAWING AND SPECIFICATIONS HEREIN ARE THE PROPERTY OF SCHNEIDER ELECTRIC AND SHALL NOT BE COPIED, REPRODUCED OR USED IN WHOLE OR IN PART, AS THE BASIS FOR THE MANUFACTURE OR SALE OF ITEMS WITHOUT WRITTEN PERMISSION FROM SCHNEIDER ELECTRIC. THIS DRAWING IS BASED UPON LATEST AVAILABLE INFORMATION AND IS SUBJECT TO CHANGE WITHOUT NOTICE.



TITLE: HYPERPOD SHORT FRAME, SINGLE POD, DUCTED ROOF WITH RACK AND DISTRIBUTION PANEL TOP VIEW  
 PROJECT: SUBMITTAL DRAWINGS SHEET 3 OF 3

DWG NO:	SFSPDRWRD	REV.	0
DRAWN BY:	JAYAPRAKASH	18-MAY-17	FIRST ANGLE PROJ
ENGINEER:	A COTTER	19-MAY-17	
APPROVED BY:	SYMONS	19-MAY-17	