

ISOMETRIC VIEW

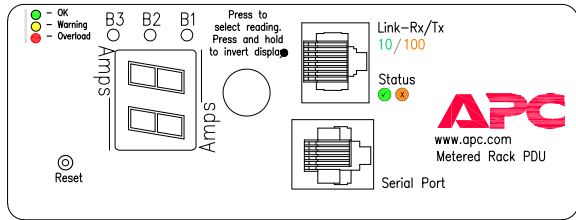

VIEW-A (DISPLAY INTERFACE-ENLARGED VIEW)



VIEW-B
(CONNECTOR FACE VIEW
CS8365L PLUG-ENLARGED)

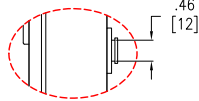

VIEW-D (ENLARGED)

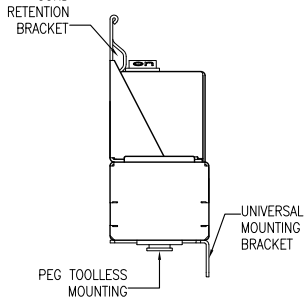

VIEW-C (ENLARGED VIEW)

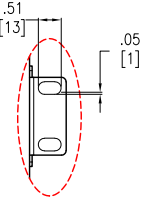

VIEW-E
(MOUNTING BRACKET
ENLARGED VIEW)

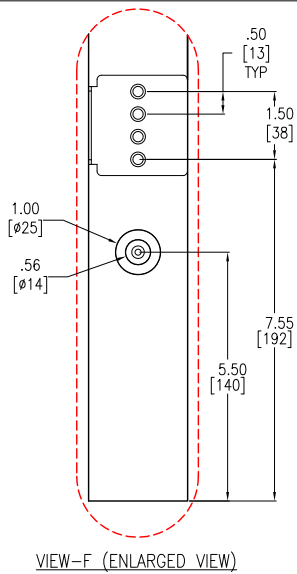

VIEW-F (ENLARGED VIEW)

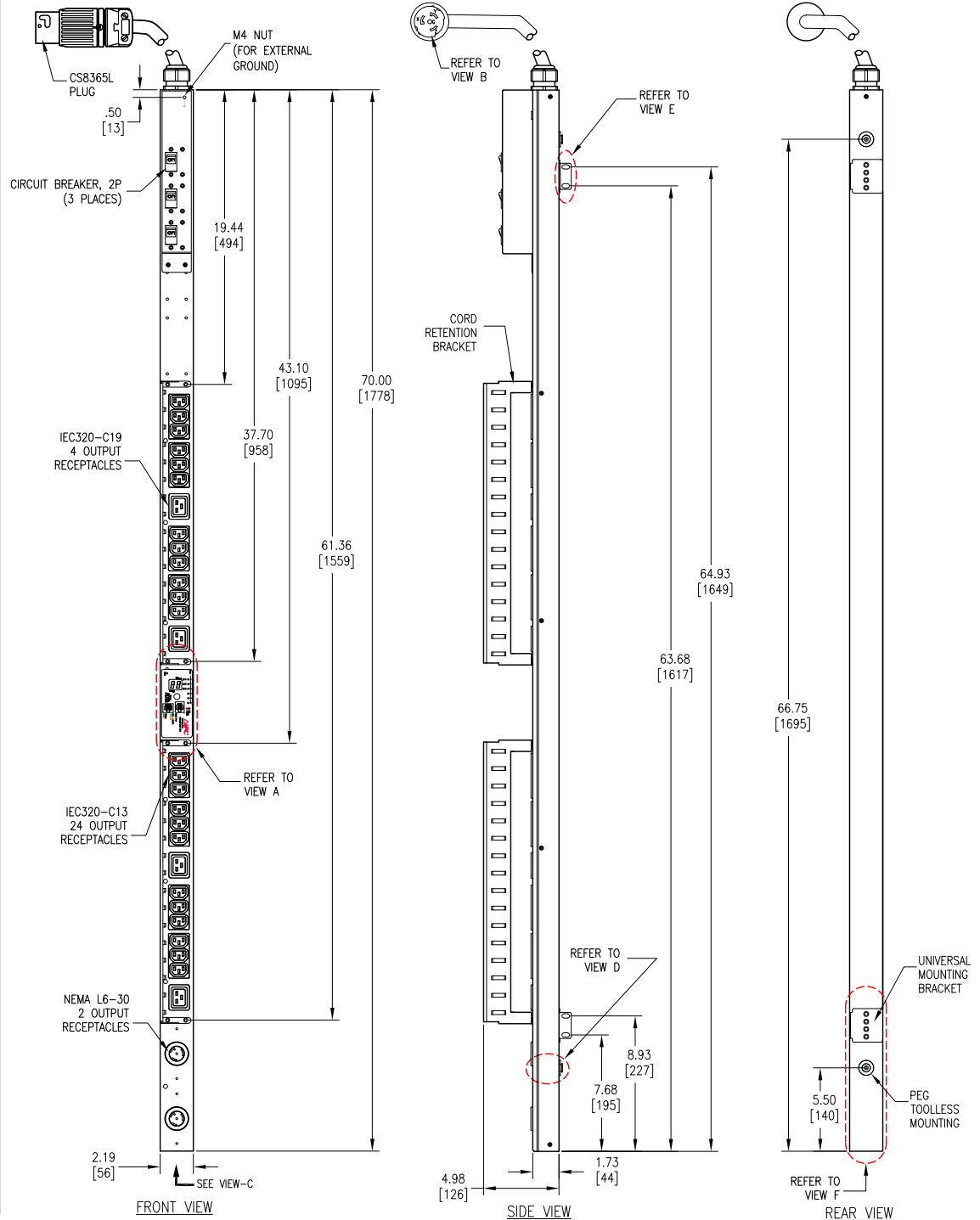

- NOTES:
1. INSTALLATION SHALL COMPLY WITH ALL APPLICABLE NATIONAL, STATE AND LOCAL ELECTRICAL REGULATIONS.
 2. REFER TO PRODUCT DOCUMENTATION FOR ADDITIONAL DETAILS PRIOR TO INSTALLATION AND SITE PREPARATION WORK
 3. ALL DIMENSIONS ARE IN INCHES [MILLIMETERS].
 4. NET WEIGHT OF UNIT IS 22.8 lb [10.34kg].
 5. LENGTH OF INPUT CORD IS 120 inches [3048mm].
 6. UNIVERSAL MOUNTING BRACKET IS AN ALTERNATIVE MOUNTING METHOD TO THE TOOL LESS MOUNT FOR NON APC RACKS.
 7. BRACKET KITS TO MOUNT TO SPECIFIC COMPETITORS RACKS ARE AVAILABLE AS OPTIONS.

THIS DRAWING AND SPECIFICATIONS HEREIN ARE THE PROPERTY OF SCHNEIDER ELECTRIC AND SHALL NOT BE COPIED, REPRODUCED OR USED IN WHOLE OR IN PART, AS THE BASIS FOR THE MANUFACTURE OR SALE OF ITEMS WITHOUT WRITTEN PERMISSION FROM SCHNEIDER ELECTRIC. THIS DRAWING IS BASED UPON LATEST AVAILABLE INFORMATION AND IS SUBJECT TO CHANGE WITHOUT NOTICE.



TITLE: RACK PDU, METERED, ZERO U, 14.4kW, 208V
INPUT: CS8365L, 10ft CORD
OUTPUT: (24)C13, (4)C19, (2)L6-30R
GENERAL ARRANGEMENT

PROJECT: SUBMITTAL DRAWINGS SHEET 1 OF 2

DWG NO: AP7899B REV. 1

DRAWN BY: Jayaprakash 03-DEC-20 THIRD

ENGINEER: Katie Burke 03-DEC-20 ANGLE

APPROVED BY: Katie Burke 03-DEC-20 PROJECTION

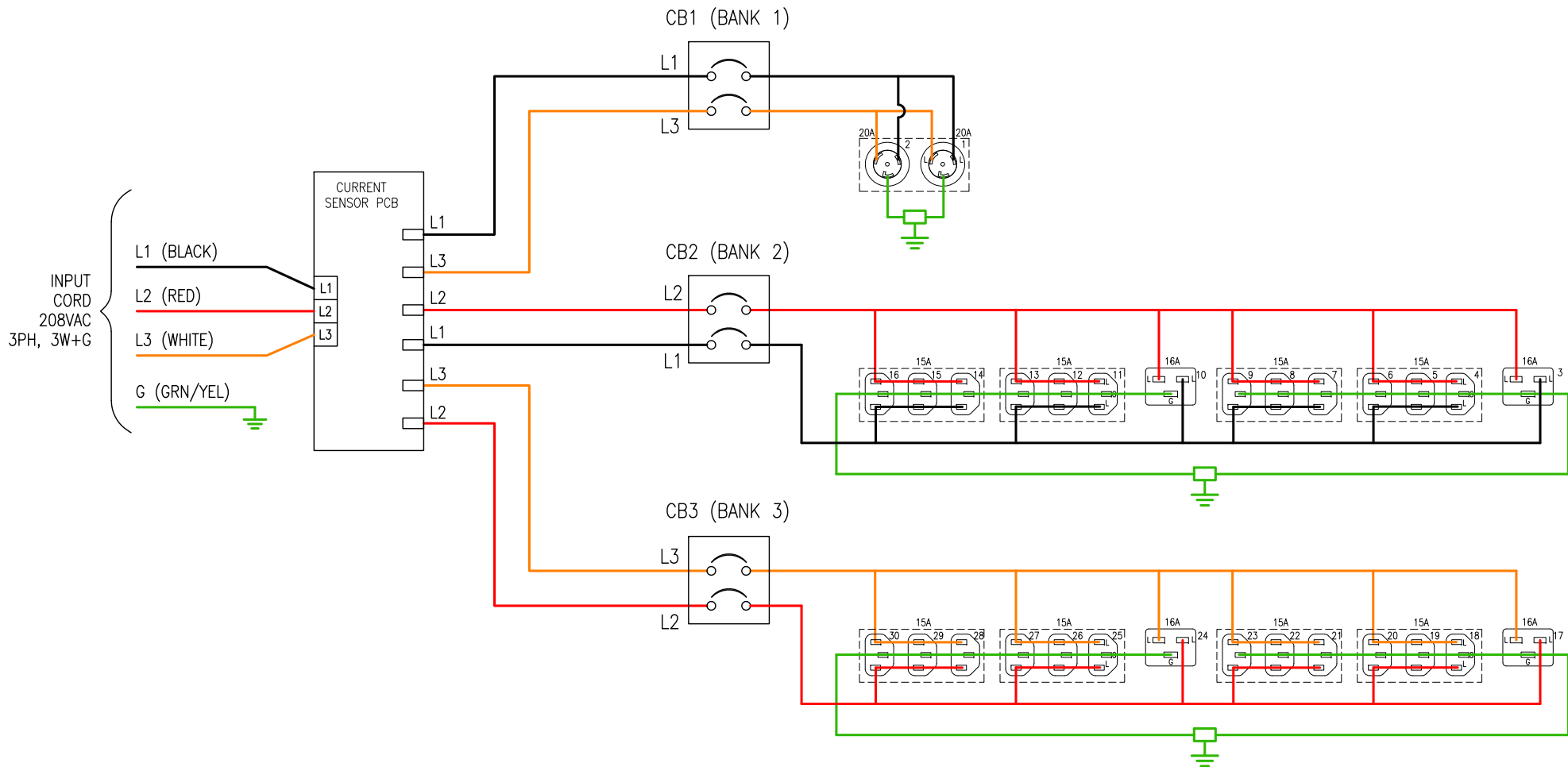

NOTES:

1. INSTALLATION SHALL COMPLY WITH ALL APPLICABLE NATIONAL, STATE AND LOCAL ELECTRICAL REGULATIONS.
2. REFER TO PRODUCT DOCUMENTATION FOR ADDITIONAL DETAILS PRIOR TO INSTALLATION AND PREPARATION WORK.
3. THIS DRAWING DEPICTS THE POWER SYSTEM CONNECTIONS AND IS NOT REPRESENTATIVE OF THE PHYSICAL LAYOUT. PLEASE REFER TO MECHANICAL DRAWINGS FOR PHYSICAL LAYOUT.

THIS DRAWING AND SPECIFICATIONS HEREIN ARE THE PROPERTY OF SCHNEIDER ELECTRIC AND SHALL NOT BE COPIED, REPRODUCED OR USED IN WHOLE OR IN PART, AS THE BASIS FOR THE MANUFACTURE OR SALE OF ITEMS WITHOUT WRITTEN PERMISSION FROM SCHNEIDER ELECTRIC. THIS DRAWING IS BASED UPON LATEST AVAILABLE INFORMATION AND IS SUBJECT TO CHANGE WITHOUT NOTICE.



TITLE: RACK PDU, METERED,
ZERO U, 14.4KW, 208V
INPUT: CS8365L, 10ft CORD
OUTPUT: (24)C13, (4)C19, (2)L6-30R
ELECTRICAL SCHEMATIC

PROJECT: SUBMITTAL DRAWING SHEET 2 OF 2

DWG NO:	AP7899B	REV.	0
DRAWN BY:	Jayaprakash	03-DEC-20	ANGLE
ENGINEER:	Katie Burke	03-DEC-20	PROJECTION
APPROVED BY:	Katie Burke	03-DEC-20	N.A