

ISOMETRIC VIEW

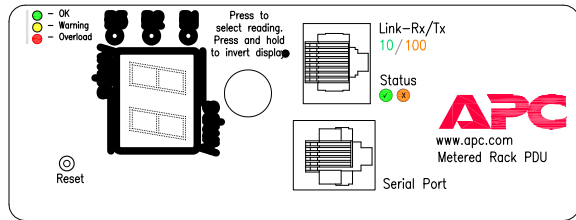

VIEW-A (DISPLAY INTERFACE-ENLARGED VIEW)



VIEW-B  
(CONNECTOR FACE VIEW  
CS8365L PLUG-ENLARGED)

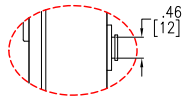

VIEW-D (ENLARGED)

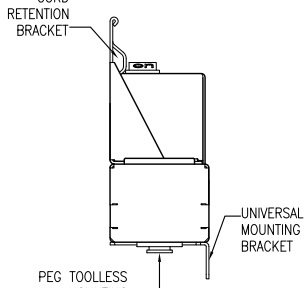

VIEW-C (ENLARGED VIEW)

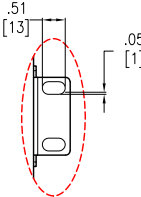

VIEW-E  
(MOUNTING BRACKET  
ENLARGED VIEW)

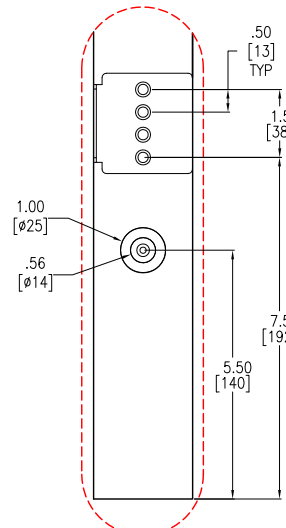

VIEW-F (ENLARGED VIEW)

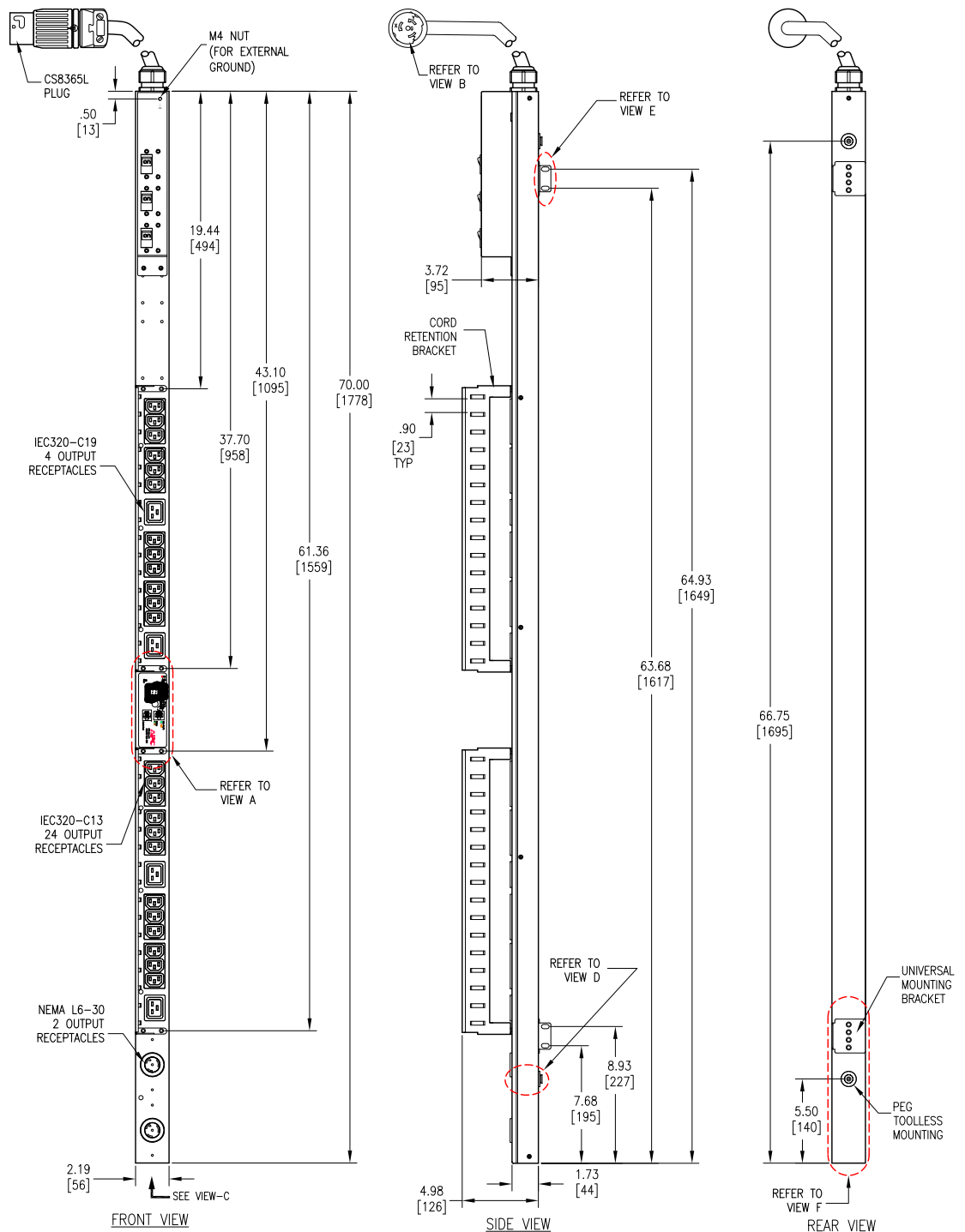

- NOTES:
1. INSTALLATION SHALL COMPLY WITH ALL APPLICABLE NATIONAL, STATE AND LOCAL ELECTRICAL REGULATIONS.
  2. REFER TO PRODUCT DOCUMENTATION FOR ADDITIONAL DETAILS PRIOR TO INSTALLATION AND SITE PREPARATION WORK
  3. ALL DIMENSIONS ARE IN INCHES [MILLIMETERS].
  4. NET WEIGHT OF UNIT IS 22.8 lb [10.34kg].
  5. LENGTH OF INPUT CORD IS 36 Inches [914mm].
  6. UNIVERSAL MOUNTING BRACKET IS AN ALTERNATIVE MOUNTING METHOD TO THE TOOLLESS MOUNT FOR NON APC RACKS.
  7. BRACKET KITS TO MOUNT TO SPECIFIC COMPETITORS RACKS ARE AVAILABLE AS OPTIONS.

THIS DRAWING AND SPECIFICATIONS HEREIN ARE THE PROPERTY OF SCHNEIDER ELECTRIC AND SHALL NOT BE COPIED, REPRODUCED OR USED IN WHOLE OR IN PART, AS THE BASIS FOR THE MANUFACTURE OR SALE OF ITEMS WITHOUT WRITTEN PERMISSION FROM SCHNEIDER ELECTRIC. THIS DRAWING IS BASED UPON LATEST AVAILABLE INFORMATION AND IS SUBJECT TO CHANGE WITHOUT NOTICE.



PROJECT: DRAWINGS	SHEET 1 OF 1	TITLE:	RACK PDU, METERED, ZERO U, 14.4kW, 208V INPUT: CS8365L	DWG NO:	AP7869B	REV:	0
		OUTPUT: (24) C13, (4) C19, (2) L6-30R GENERAL ARRANGEMENT	DRAWN BY:	JAYAPRAKASH	02-DEC-16	THIRD	
			ENGINEER:	KATIE RICK	02-DEC-16	ANGLE	
			APPROVED BY:	KATIE RICK	02-DEC-16	PROJECTION	