

NOTES:

1. INSTALLATION SHALL COMPLY WITH ALL APPLICABLE NATIONAL, STATE AND LOCAL ELECTRICAL REGULATIONS.
2. REFER TO PRODUCT DOCUMENTATION FOR ADDITIONAL DETAILS PRIOR TO INSTALLATION AND SITE PREPARATION WORK.
3. ALL DIMENSIONS ARE IN MILLIMETERS [INCHES].
4. WEIGHT OF BRACKETS:
 SYOPT014 IS 4.14 kg [9.1 lb].
 SYOPT015 IS 1.93 kg [4.25 lb].
5. BRACKETS MUST BE ANCHORED TO THE FLOOR WITH 1/2" GRADE 4, OR M12 8.8 HARDWARE. FLOOR MOUNTING HARDWARE NOT PROVIDED.
6. SEISMIC QUALIFICATION OF NON-STRUCTURAL COMPONENT BY SCHNEIDER ELECTRIC IS JUST ONE LINK IN THE TOTAL CHAIN OF RESPONSIBILITY REQUIRED TO MAXIMIZE THE PROBABILITY THAT THE EQUIPMENT WILL BE INTACT AND FUNCTIONAL AFTER A SEISMIC EVENT. DURING A SEISMIC EVENT THE EQUIPMENT MUST BE ABLE TO TRANSFER THE LOADS THAT ARE CREATED THROUGH THE MOUNTING AND ANCHORAGE TO THE LOAD-BEARING PATH OF THE BUILDING STRUCTURAL SYSTEM. ANCHORAGE OF THE EQUIPMENT TO THE PRIMARY BUILDING STRUCTURE IS REQUIRED TO VALIDATE THE SEISMIC CERTIFICATION. THE STRUCTURAL ENGINEER OR DESIGN ENGINEER OF RECORD IS RESPONSIBLE FOR DETAILING THE EQUIPMENT ANCHORAGE REQUIREMENTS FOR THE GIVEN INSTALLATION. THE INSTALLER AND MANUFACTURERS OF THE ANCHORAGE SYSTEM ARE RESPONSIBLE FOR ASSURING THAT THE MOUNTING REQUIREMENTS ARE MET. SCHNEIDER ELECTRIC IS NOT RESPONSIBLE FOR THE SPECIFICATION AND PERFORMANCE OF THE ANCHORAGE SYSTEMS. ALL FLOOR MOUNTED BRACKETS ARE PROVIDED WITH HOLES FOR 1/2" DIAMETER HARDWARE. FLOOR MOUNTING HARDWARE ARE NOT PROVIDED.

SEISMIC KIT SKUs	APPLICABLE SKUs
<u>SYOPT014:</u> SEISMIC KIT FOR SYMMETRA PX20 BATTERIES	ISX20K20F ISX20KH ISX20K20H
<u>SYOPT015:</u> SEISMIC KIT FOR SYMMETRA PX20 AND 40/60kVA INFRASTRUXURE PDUs	

THIS DRAWING AND SPECIFICATIONS HEREIN ARE THE PROPERTY OF SCHNEIDER ELECTRIC AND SHALL NOT BE COPIED, REPRODUCED OR USED IN WHOLE OR IN PART, AS THE BASIS FOR THE MANUFACTURE OR SALE OF ITEMS WITHOUT WRITTEN PERMISSION FROM SCHNEIDER ELECTRIC. THIS DRAWING IS BASED UPON LATEST AVAILABLE INFORMATION AND IS SUBJECT TO CHANGE WITHOUT NOTICE.



TITLE: SYMMETRA PX
 SYMMETRA PX20
 SEISMIC ANCHORING
 NOTES AND TABLES

PROJECT: SUBMITTAL DRAWINGS SHEET 1 OF 3

DWG NO:	PX20SEISMIC	REV.	0
DRAWN BY:	JAYAPRAKASH	22-SEP-15	ANGLE
ENGINEER:	FARRUKH SYED	24-SEP-15	PROJECTION
APPROVED BY:	ABBY COLLINS	24-SEP-15	N.A.

SYMMETRA PX20

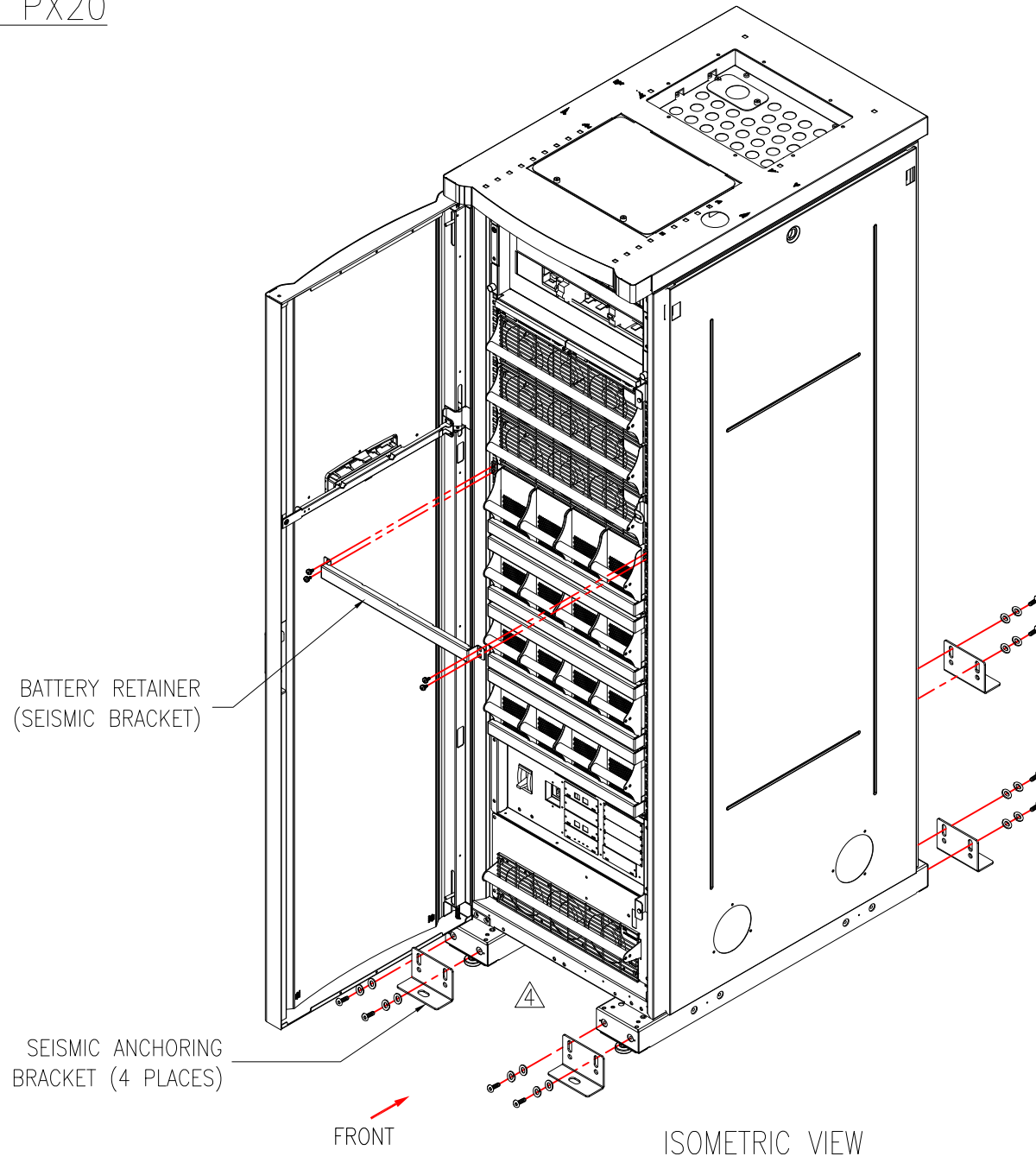

ISOMETRIC VIEW

- NOTES:
1. INSTALLATION SHALL COMPLY WITH ALL APPLICABLE NATIONAL, STATE AND LOCAL ELECTRICAL REGULATIONS.
 2. REFER TO PRODUCT DOCUMENTATION FOR ADDITIONAL DETAILS PRIOR TO INSTALLATION AND SITE PREPARATION WORK.
 3. ALL DIMENSIONS ARE IN MILLIMETERS [INCHES].
- △ 4. THE BRACKET INSTALLATION HOLES ARE BEHIND A COVER THAT NEEDS TO BE REMOVED. REFER TO STEP-A IN INSTALLATION MANUAL:990-5113 FOR DETAILS

THIS DRAWING AND SPECIFICATIONS HEREIN ARE THE PROPERTY OF SCHNEIDER ELECTRIC AND SHALL NOT BE COPIED, REPRODUCED OR USED IN WHOLE OR IN PART, AS THE BASIS FOR THE MANUFACTURE OR SALE OF ITEMS WITHOUT WRITTEN PERMISSION FROM SCHNEIDER ELECTRIC. THIS DRAWING IS BASED UPON LATEST AVAILABLE INFORMATION AND IS SUBJECT TO CHANGE WITHOUT NOTICE.



TITLE:	SYMMETRA PX SYMMETRA PX20 SEISMIC ANCHORING ISOMETRIC VIEWS	DWG NO:	PX20SEISMIC	REV.	0
PROJECT: SUBMITTAL DRAWINGS	SHEET 2 OF 3	APPROVED BY:	ABBY COLLINS	24-SEP-15	ANGLE PROJECTION
		ENGINEER:	FARRUKH SYED	24-SEP-15	FIRST
		DRAWN BY:	JAYAPRAKASH	22-SEP-15	

SEISMIC ANCHORING
BRACKET (4 PLACES)

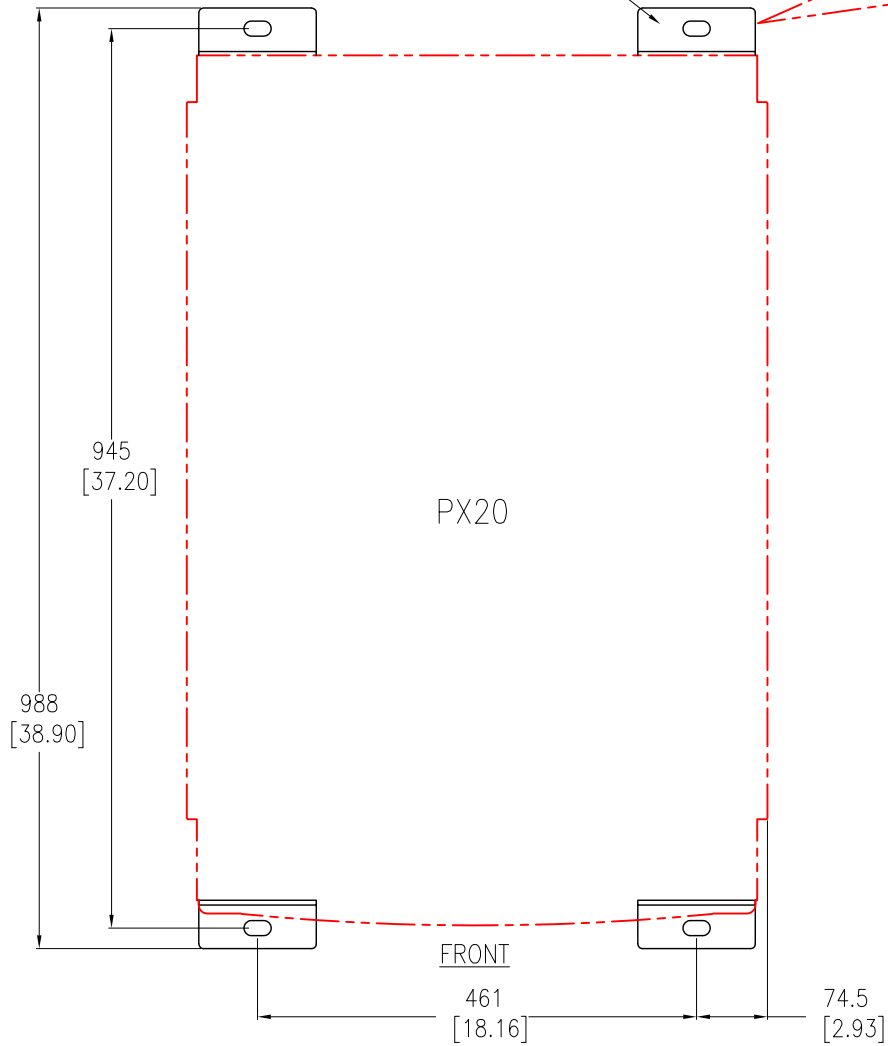

MOUNTING HOLE LOCATIONS
FOR ANCHORING BRACKETS

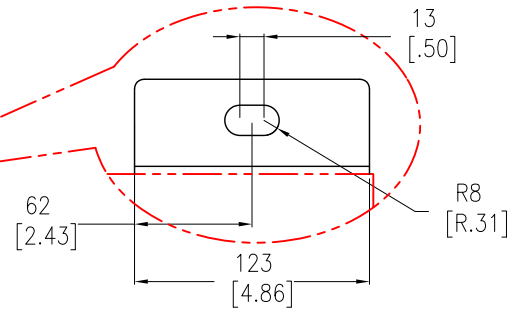

ENLARGED VIEW

BATTERY RETAINER (SEISMIC BRACKET)

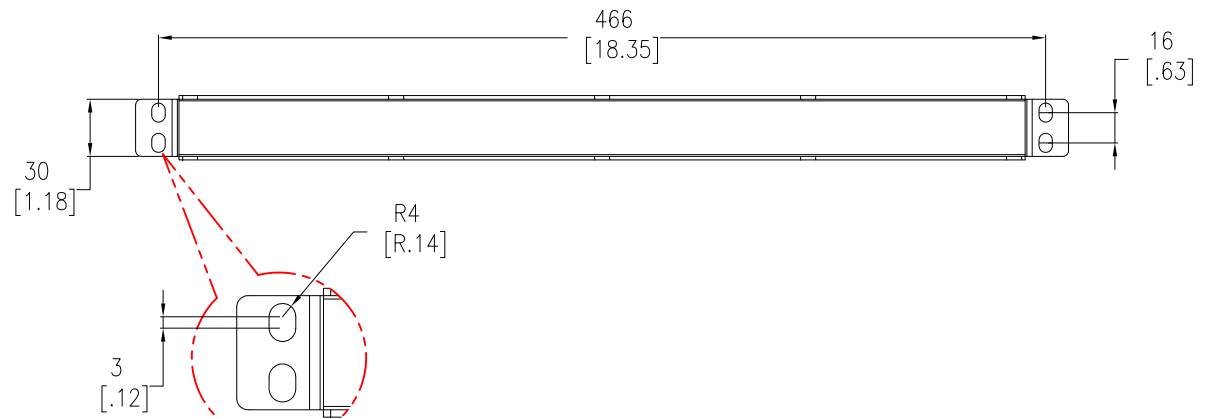

ENLARGED VIEW

- NOTES:
1. INSTALLATION SHALL COMPLY WITH ALL APPLICABLE NATIONAL, STATE AND LOCAL ELECTRICAL REGULATIONS.
 2. REFER TO PRODUCT DOCUMENTATION FOR ADDITIONAL DETAILS PRIOR TO INSTALLATION AND SITE PREPARATION WORK.
 3. ALL DIMENSIONS ARE IN MILLIMETERS [INCHES].

THIS DRAWING AND SPECIFICATIONS HEREIN ARE THE PROPERTY OF SCHNEIDER ELECTRIC AND SHALL NOT BE COPIED, REPRODUCED OR USED IN WHOLE OR IN PART, AS THE BASIS FOR THE MANUFACTURE OR SALE OF ITEMS WITHOUT WRITTEN PERMISSION FROM SCHNEIDER ELECTRIC. THIS DRAWING IS BASED UPON LATEST AVAILABLE INFORMATION AND IS SUBJECT TO CHANGE WITHOUT NOTICE.



TITLE:
SYMMETRA PX
SYMMETRA PX20
SEISMIC ANCHORING
BRACKET DETAILS

PROJECT: SUBMITTAL DRAWINGS SHEET 3 OF 3

DWG NO: PX20SEISMIC REV 0

DRAWN BY: JAYAPRAKASH 22-SEP-15

ENGINEER: FARRUKH SYED 24-SEP-15

APPROVED BY: ABBY COLLINS 24-SEP-15

FIRST
ANGLE
PROJECTION